



Datasheet Bigtwist Nail

ENGLISH



Features

A 20mm headed twist nail made from Grade 8.8 steel. Suitable for fixing composite panels to wooden battens. Hammer driven fixing for securing composite panels and plywood sheets to timber joists.

- No Drilling required
- No need for screws
- Quick installation
- Rotates during installation to reduce risk of splitting timber
- Large 20mm head
- Unique one piece stress free fixing
- Grade 8.8 High Tensile steel, Zinc Plated and Passivated

RANGE DATA

RANGE DATA		
Part Number	Length	Maximum Fixture Thickness
	mm	mm
1776978	165	130
1776991	195	160

INSTALLATION INSTRUCTIONS

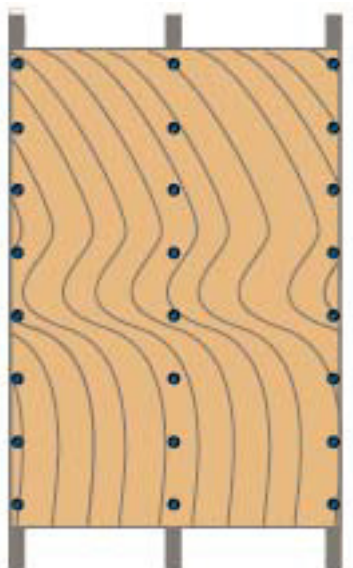

600mm Rafter Spacing requires
300mm Axial Spacing

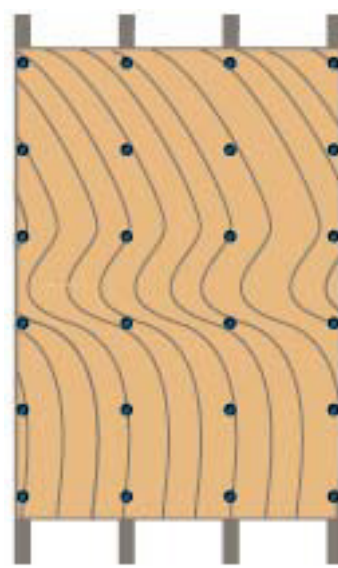

400mm Rafter Spacing requires
400mm Axial Spacing

Datasheet

ENGLISH

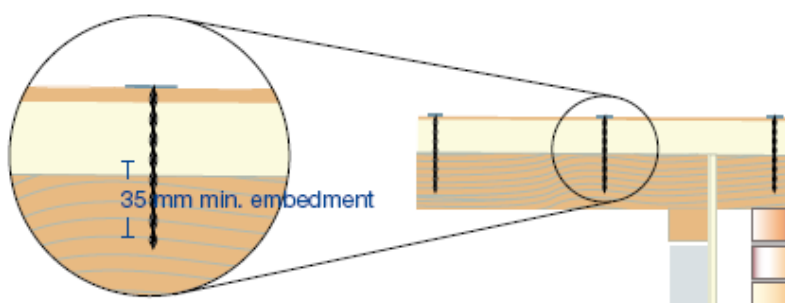
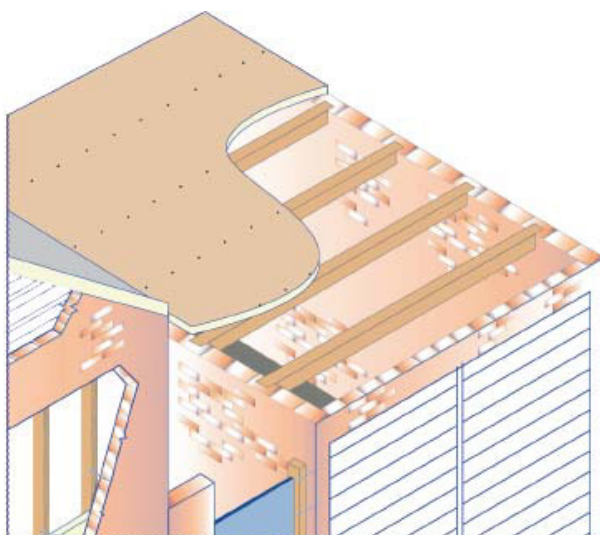

Average Ultimate Load at 35mm embedment in softwood = 1090N (approx 109kg)
(Independently tested at Imperial College, London)