

## Pipe-mounting Kit Installation

### 1 Introduction

This document describes how to mount the instrument using the optional pipe-mounting kit.

The Pipe-mounting Kit (SM500/0703) comprises the following:

Description	Part No.	Qty
Adaptor Plate	SM500/0130	1
Pipe Clamp Plate	SM500/0131	2
M6 x 50 Hexagon-head Screw	B12476	2
M6 Spring Lock Washer	0225734	4
M6 Hexagonal Nut	0224172	2
M6 x 8 Hexagon-head Screw	B12478	2
M5 x 8 Pozidriv Screw	B12479	2
9.50/D x 4.3 I/D Plain Washer	B12408	2
Information Sheet – Pipe-mounting Kit	INF06/96	1

Table. 1.1 Pipe-mounting Kit Contents

### 2 Tools Required

- No.2 Pozidriv screwdriver
- 10mm spanner (x2)

### 3 Pipe-mounting the Instrument

Referring to Fig. 3.1 overleaf, secure the instrument to a pipe as follows:

- ① Fit the two M6 x 50mm long hexagon-head screws through one clamp plate as shown.
- ② Using the appropriate holes to suit vertical or horizontal pipe, secure the clamp plate to the pipe-mounting bracket using the two M6 x 8mm long hexagon-head screws and and two of the spring lock washers.
- ③ Position the pipe mounting bracket into the recesses on the rear of the instrument as shown and secure with the two bracket securing screws. Ensure the plastic washers remain in the positions fitted.
- ④ Secure the instrument to the pipe using the remaining clamp plate, spring lock washers and nuts.

# SM500F

## Pipe-mounting Kit Installation

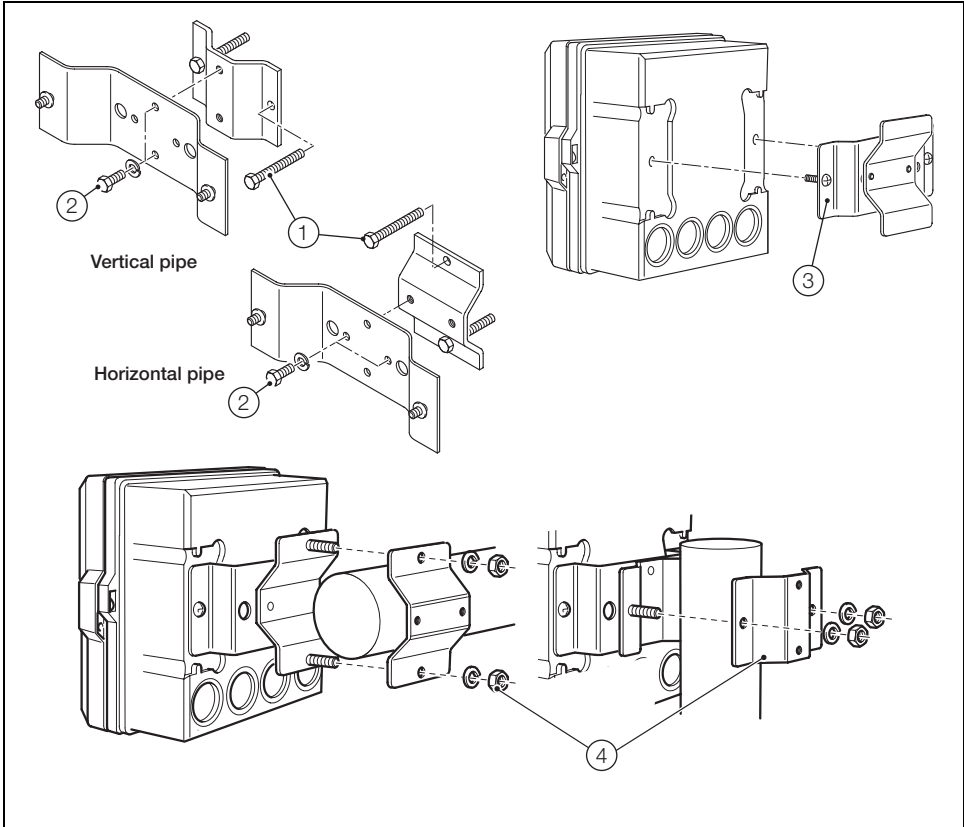

Fig. 3.1 Pipe-mounting the Instrument

ABB has Sales & Customer Support expertise  
in over 100 countries worldwide  
[www.abb.com](http://www.abb.com)

The Company's policy is one of continuous product  
improvement and the right is reserved to modify the  
information contained herein without notice.

Printed in UK (04.06)  
© ABB 2006

# ABB

**ABB Limited**  
Howard Road, St. Neots  
Cambridgeshire  
PE19 8EU  
UK  
Tel: +44 (0)1480 475321  
Fax: +44 (0)1480 217948

**ABB Inc.**  
125 E. County Line Road  
Warminster  
PA 18974  
USA  
Tel: +1 215 674 6000  
Fax: +1 215 674 7183