

VOLTAGE RELEASE, AC 210...240V,  
50/60HZ,100% ED, AC 190...330V,50/60HZ,  
5SEC ED, DC 190...330V, 5SEC ED,  
WITH RING CABLE LUG CONNECTION,

**General technical data:**

<b>Product brand name</b>		SIRIUS
<b>Product designation</b>		shunt release
<b>Size of the circuit-breaker</b>		S00, S0
<b>Acceptability for application</b>		motor circuit breaker
<b>Protection class IP / frontal/front side</b>		IP20
<b>Design of the short-circuit protection</b>		fuse
<b>Degree of pollution</b>		3
<b>Insulation voltage / rated value</b>	V	690
<b>Insulation voltage / with degree of pollution 3 / rated value</b>	V	690
<b>Ambient temperature</b>		
• during storage	°C	-50 ... 80
• during the operating phase	°C	-20 ... 60
<b>Item designation</b>		
• according to DIN 40719 extendable after IEC 204-2 / according to IEC 750		F
• according to DIN EN 61346-2		F

**Auxiliary circuit:**

<b>Number of NC contacts / for auxiliary contacts</b>		
• instantaneous switching		0
<b>Number of NO contacts / for auxiliary contacts</b>		
• instantaneous switching		0
<b>Number of changeover contacts / of the auxiliary contacts</b>		
• non-delayed		0

**Control circuit:**

<b>Type of voltage / of the controlled supply voltage</b>		AC
<b>control supply voltage frequency</b>		
• 1 / initial rated value	Hz	50
• 1 / final rated value	Hz	60
<b>Control supply voltage</b>		

- 1 / at 50 Hz / for AC / initial rated value
- 1 / at 50 Hz / for AC / final rated value
- 1 / at 60 Hz / for AC / final rated value
- 1 / at 60 Hz / for AC / initial rated value

V	210
V	240
V	240
V	210

#### Installation/mounting/dimensions:

**Type of fixing/fixation**

snap-on mounting

**Width**

mm 18.5

**Height**

mm 90

**Depth**

mm 68

#### Certificates/approvals:

**verification of suitability**

CE / UL / CSA / CCC

#### Further information:

**Information- and Downloadcenter (Catalogs, Brochures,...)**

<http://www.siemens.com/industrial-controls/catalogs>

**Global Industry Mall (Online ordering system)**

<http://www.siemens.com/industrial-controls/mall>

**Service&Support (Manuals, Certificates, Characteristics, FAQs,...)**

<http://support.automation.siemens.com/WW/view/en/3RV2902-4DP0/all>

**Image database (product images, 2D dimension drawings, 3D models, device circuit diagrams, ...)**

[http://www.automation.siemens.com/bilddb/cax\\_en.aspx?mlfb=3RV2902-4DP0](http://www.automation.siemens.com/bilddb/cax_en.aspx?mlfb=3RV2902-4DP0)

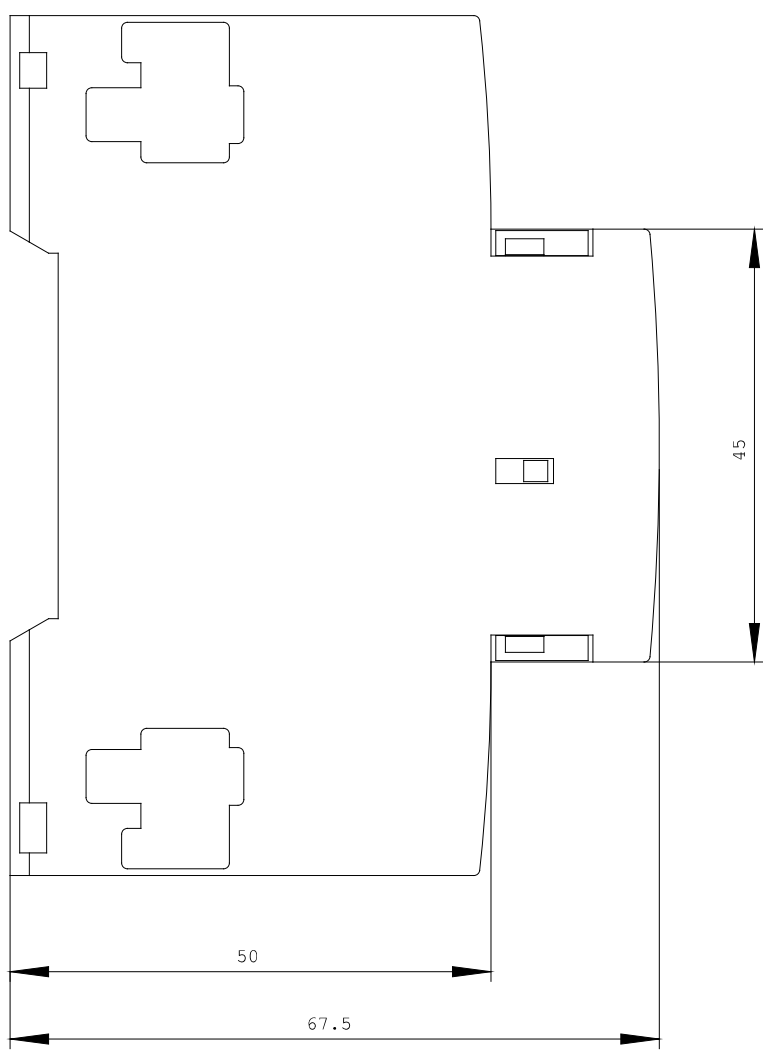
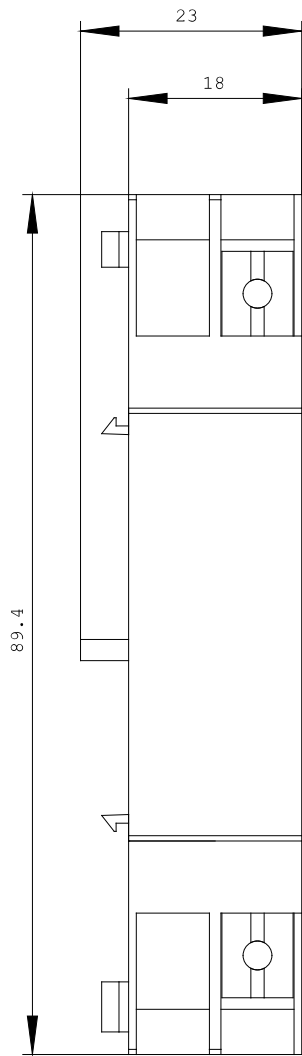

last change:

Apr 26, 2010