

Stainless Steel IGS Cabinets with Hinges Product Drawings Last Updated 4/15/2008

Rose+Bopla Enclosures
7330 Executive Way
Frederick, MD 21704
www.rose-bopla.com
rbinfo@rose-bopla.com

Rose+Bopla offers high-quality stainless steel boxes to meet the needs for metal enclosures in highly corrosive environments and for food industry applications. Our stainless steel design features

IGS Stainless Steel Cabinets with Hinges

stainless steel hinges, precise edging, clean soldered seams, and an evenly polished brush finish on the outside. This enclosure comes standard with a foamed-in-place, non-removable polyurethane gasket in the lid. The lid screws are located outside the gasketed area and thread into closed sleeves in the base. Internal mounting support bars are built into the base.

Rose+Bopla's Stainless Steel Watertight Enclosure comes standard with captive stainless steel lid screws, polyurethane gasket and specially designed watertight hardware for sealing mounting holes in back. Optional external mounting brackets are available.

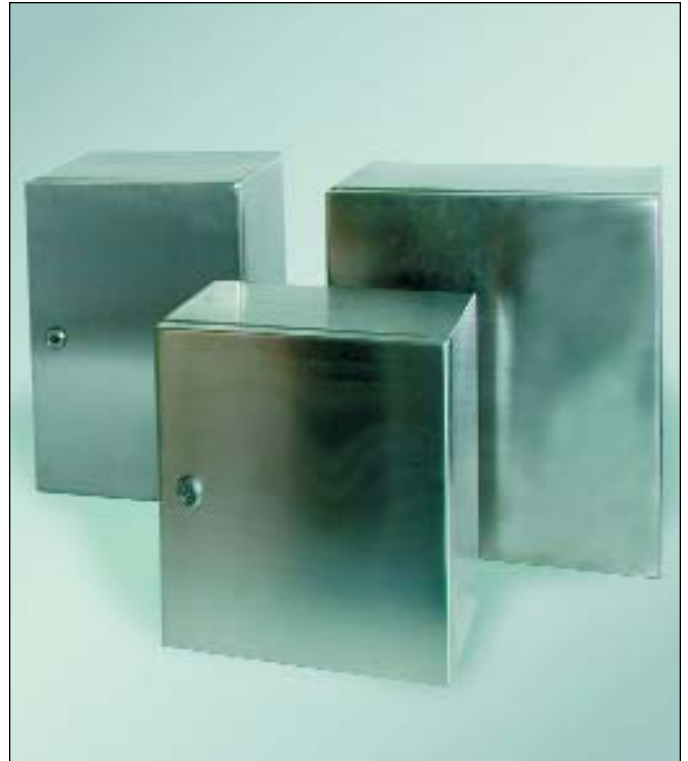

Stainless Steel IGS Cabinets w/Hinges

Part Number	Length (Inches/mm)	Width (Inches/mm)	Height (Inches/mm)	Weight lbs.	Drawing Page #
37002209 00	7.88 / 200	9.84 / 250	3.82 / 97	6.30	17-96
37002215 00	7.88 / 200	9.84 / 250	6.18 / 157	7.72	17-96
37003209 00	13.78 / 350	9.84 / 250	3.82 / 97	9.35	17-96
37003316 00	11.81 / 300	11.81 / 300	6.57 / 167	11.68	17-96
37004416 00	14.96 / 380	14.96 / 380	6.57 / 167	16.29	17-96
37004421 00	14.96 / 380	14.96 / 380	8.54 / 217	18.27	17-96
37005316 00	19.68 / 500	11.81 / 300	6.57 / 167	17.01	17-96
37006316 00	23.12 / 600	11.81 / 300	6.57 / 167	19.29	17-96
37006421 00	23.12 / 600	14.96 / 380	8.54 / 217	25.18	17-96

Note: Dimensions are external. Metric is the primary dimension. Inch conversions and weights are for the user's convenience and are for reference only. Accessories shown on drawing page.

TECHNICAL DATA:

- Surface Finish: 240 grain polished finish
- Material: 304 Stainless Steel (1.4301), 1.25mm thick.
- Temperature Range: -40°F to +176°F
- Gasket Material:
Polyurethane
Silicone
EMC on request.
- Ingress Protection:
Up to Nema 4X
IP 65 to EN 60529
- Approvals:
UL Listed File # E206630
CSA File # 091319-0-00

Stainless Steel Watertight

<p>Standard Features</p> <p>Cabinet with door, hinges, locking system. 4 x M6 threaded stud bolts in lid. 4 x M6 threaded weld nuts in base.</p>
<p>Accessories</p> <ul style="list-style-type: none"> • 37019901 00 Mounting plate for 37012315 00. • 37019902 00 Mounting plate for 37013421 00. • 37019903 00 Mounting plate for 37014315 00. • 37019904 00 Mounting plate for 37014621 00. • 37019905 00 Mounting plate for 37015521 00. • 37019906 00 Mounting plate for 37016415 00. • 37019907 00 Mounting plate for 37016821 00.

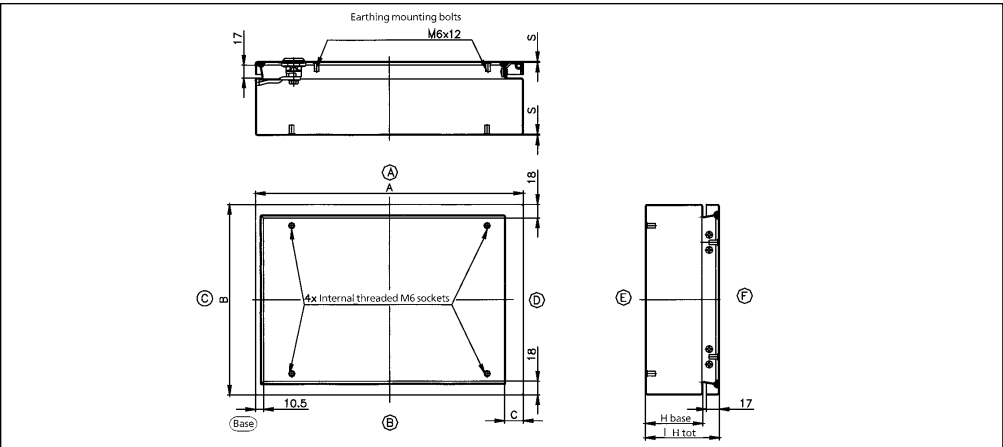

Part Number	A Length Inches/mm	B Width Inches/mm	C Inches/mm	S Inches/mm	HB Inches/mm	H tot. Height Inches/mm
37012315 00	7.87 / 200	11.81 / 300	.98 / 25	.05 / 1.25	5.24 / 133	6.10 / 155
37013421 00	11.81 / 300	14.96 / 380	.98 / 25	.05 / 1.25	7.40 / 188	8.27 / 210
37014315 00	15.75 / 400	11.81 / 300	.98 / 25	.05 / 1.25	5.24 / 133	6.10 / 155
37014621 00	14.96 / 380	23.62 / 600	.98 / 25	.06 / 1.50	7.40 / 188	8.27 / 210
37015521 00	19.68 / 500	19.68 / 500	.98 / 25	.05 / 1.25	7.40 / 188	8.27 / 210
37016415 00	23.62 / 600	15.75 / 400	.98 / 25	.06 / 1.50	5.24 / 133	6.10 / 155
37016821 00	23.62 / 600	29.92 / 760	.98 / 25	.06 / 1.50	7.40 / 188	8.24 / 210

<p>Standard Features</p> <p>Cabinet with door, hinges, locking system. 4 x M6 threaded stud bolts in lid. 4 x M6 threaded weld nuts in base.</p>
<p>Accessories</p> <ul style="list-style-type: none"> • 10011066 00 Mounting plate for 37002209 00 and 37002215 00. • 10111067 00 Mounting plate for 37003209 00. • 10011045 00 Mounting plate for 37004416 00. • 10011068 00 Mounting plate for 37006316 00. • 10011069 00 Mounting plate for 37006421 00.

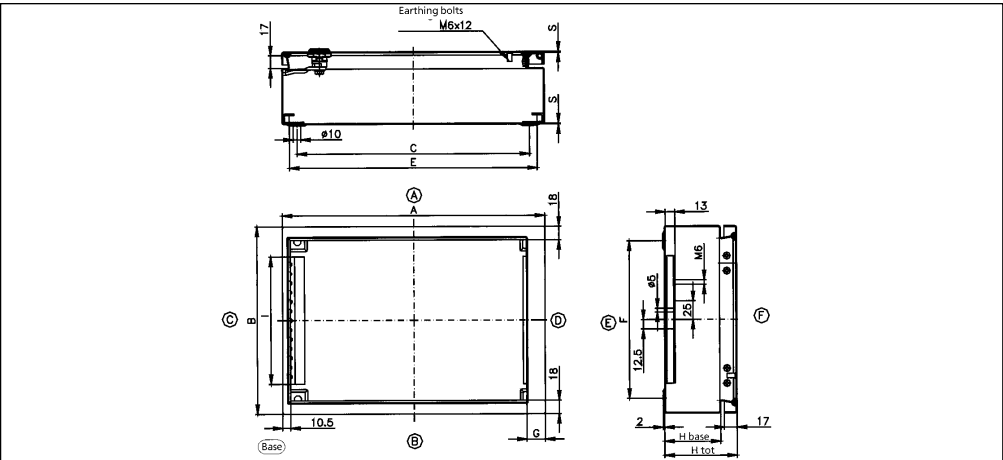

Part Number	A Length Inches/mm	B Width Inches/mm	C Inches/mm	E Inches/mm	F Inches/mm	I Inches/mm	G Inches/mm	S Inches/mm	HB Inches/mm	H tot. Height Inches/mm
37002209 00	7.88 / 200	9.84 / 250	6.30 / 160	7.12 / 181	8.27 / 210	6.69 / 170	.98 / 25	4.92 / 1.25	2.95 / 75	3.82 / 97
37002215 00	7.88 / 200	9.84 / 250	6.30 / 160	7.12 / 181	8.27 / 210	6.69 / 170	.98 / 25	4.92 / 1.25	5.31 / 135	6.18 / 157
37003209 00	13.78 / 350	9.84 / 250	12.20 / 310	13.03 / 331	8.27 / 210	8.27 / 210	.98 / 25	4.92 / 1.25	2.95 / 75	3.82 / 97
37003316 00	11.81 / 300	11.81 / 300	10.24 / 260	11.06 / 281	10.23 / 260	8.66 / 220	.98 / 25	4.92 / 1.25	5.71 / 145	6.57 / 167
37004416 00	14.96 / 380	14.96 / 380	13.38 / 340	14.21 / 361	13.39 / 340	11.81 / 300	.98 / 25	4.92 / 1.25	5.71 / 145	6.57 / 167
37004421 00	14.96 / 380	14.96 / 380	13.38 / 340	14.21 / 361	13.39 / 340	11.81 / 300	.98 / 25	4.92 / 1.25	7.68 / 195	8.54 / 217
37005316 00	19.68 / 500	11.81 / 300	18.11 / 460	18.94 / 481	10.24 / 260	8.66 / 200	.98 / 25	4.92 / 1.25	5.71 / 145	6.57 / 167
37006316 00	23.12 / 600	11.81 / 300	22.04 / 560	22.83 / 580	10.24 / 260	8.66 / 200	.98 / 25	5.90 / 1.50	5.71 / 145	6.57 / 167
37006421 00	23.12 / 600	14.93 / 380	22.04 / 560	22.83 / 580	13.38 / 340	11.81 / 300	.98 / 25	5.90 / 1.50	7.68 / 195	8.54 / 217