

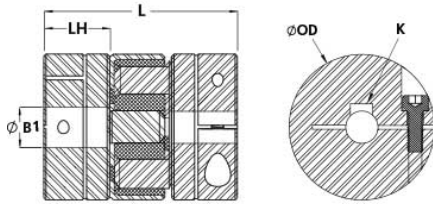

MJCC70-24-A

Ruland MJCC70-24-A, 24mm Jaw Coupling Hub, Aluminum, Clamp Style With Keyway, 69.9mm OD, 33.0mm Length



Description

Ruland MJCC70-24-A is a clamp zero-backlash jaw coupling hub with a 24mm bore, 8mm keyway, 69.9mm OD, and 93.3mm length. It is a component in a three-piece design consisting of two aluminum hubs and an elastomeric insert called the spider creating a lightweight low inertia coupling capable of speeds up to 8,000 RPM. This three-piece design allows for a highly customizable coupling that easily combines clamp or set screw hubs with inch, metric, keyed, and keyless bores. Spiders are available in three durometers allowing the user to tailor coupling performance to their application. Ruland jaw couplings have a balanced design for reduced vibration at high speeds. Hardware is metric and tests beyond DIN 912 12.9 standards for maximum torque capabilities. MJCC70-24-A is machined from bar stock that is sourced exclusively from North American mills and is RoHS3 and REACH compliant. It is manufactured in our Marlborough, MA factory under strict controls using proprietary processes.

Product Specifications

Bore (B1)	24 mm	Keyway (K)	8 mm
B1 Max Shaft Penetration	33.0 mm	Outer Diameter (OD)	2.750 in (69.9 mm)
Bore Tolerance	+0.03 mm / -0.00 mm	Hub Width (LH)	33.0 mm
Length (L)	3.674 in (93.3 mm)	Recommended Shaft Tolerance	+0.000 mm / -0.013 mm
Key Width (K1)	8 mm	Key Height (K1)	7 mm
Keyway 1 Height (T1)	27.3 mm	Keyway 1 Width Tolerance	+0.018 mm / -0.018 mm
Keyway 1 Height Tolerance	+0.2 mm / 0 mm	Forged Clamp Screw	M8
Number of Screws	1 ea	Screw Material	Alloy Steel
Screw Finish	Black Oxide	Hex Wrench Size	6.0 mm
Seating Torque	39 Nm	Torque Specifications	Torque ratings vary with insert selection
Misalignment	Misalignment ratings vary with insert selection	Maximum Speed	8,000 RPM
Moment of Inertia	$2.333^{-4} \text{ kg-m}^2$	Full Bearing Support Required?	Yes
Recommended Inserts	JD44/70-98R , JD44/70-92Y	Zero-Backlash?	Yes
Balanced Design	Yes	Fail Safe?	Yes
Weight (lbs)	0.724861	Temperature	-10°F to 180°F (-23°C to 82°C)
Material Specification	2024-T351 Aluminum Bar	Finish	Bright
Finish Specification	Bright, No Plating	Manufacturer	Ruland Manufacturing
Country of Origin	USA	UPC	65432940699
UNSPC	31163011	Tariff Code	8483.60.8000
Note 1	Stainless steel hubs are available upon request.		
Note 2	Performance ratings are for guidance only. The user must determine suitability for a particular application.		
Note 3	Torque ratings for the couplings are based on the physical limitations/failure point of the spiders. Under normal/typical conditions the hubs are capable of holding up to the nominal torque of the spiders. Please consult technical support for more assistance.		