



FAG

SES528-L

Plummer block housing

Split plummer block housing for various bearing designs. The SNV series will be replaced by the new SES series in 2022.

Technical information

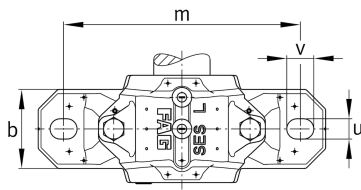

Main Dimensions & Performance Data

D	250 mm	Outside diameter bearing
a	500 mm	Length base
h ₁	302 mm	Height
g	205 mm	Width housing body
K	98 mm	Width bearing seat
≈m	40.6 kg	Weight

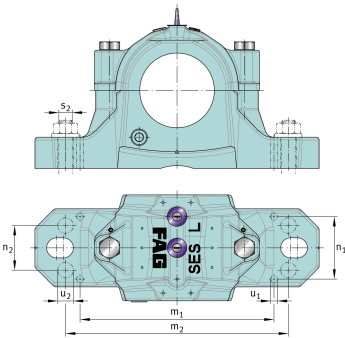
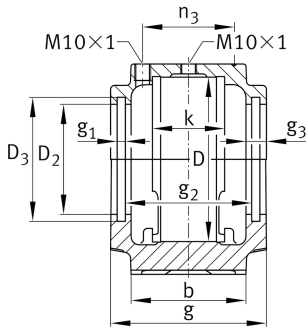
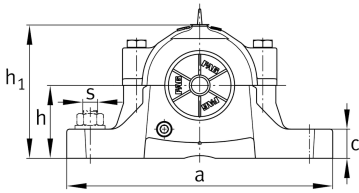

Dimensions

b	150 mm	Width base
c	50 mm	Height base
h	150 mm	Base to shaft centerline height
m	420 mm	Distance fixing bore
s	31.75 mm	Screw size
s	M30	Size of fixing screws
u	35 mm	Width slot
v	42 mm	Length slot
D 2	177.5 mm	Diameter sealing
D 3	187.5 mm	Diameter sealing groove
D 5	184.2 mm	Outside diameter sealing labyrinth
g 1	6 mm	Width sealing groove
g 2	183 mm	Distance sealing
g 3	15 mm	Wall thickness
g 4	40 mm	Distance oil lubrication
m 1	360 mm	Distance holes aligned pins m1
n 3	124 mm	Distance lubrication
n 4	185 mm	Distance lubrication sealing
u 1	12 mm	Bore diameter u1
u 2	26 mm	Bore diameter u2