

För icke direkt toleranssatta mått gäller toleransklass
General tolerances if not otherwise stated

NOM DIM MM		TOL CLASS		
From	To	A	B	C
(1)	6	±0.05	±0.1	±0.2
(6)	30	±0.1	±0.2	±0.5
(30)	100	±0.15	±0.3	±0.8
(100)	300	±0.2	±0.5	±1.2
(300)	1000	±0.3	±0.8	±2

Hål / Holes H13

Skarpa kanter brutna där ej annat anges.
No sharp edges unless otherwise specified.

Övriga generella toleranser enligt ritning 4100-4644.
Additional general tolerances in accordance with drawing 4100-4644.

LASERMÄRKNING/LASER MARKING:

TEXTFONT: GEN-ISO

Datumkod / Date code "YYYYYY"

Serienummer / Serial number "XXXXXXX"

Rev	Change order	Change: A = Added W = Was D = Deleted C = Changed	Date	Sign
-----	--------------	---	------	------

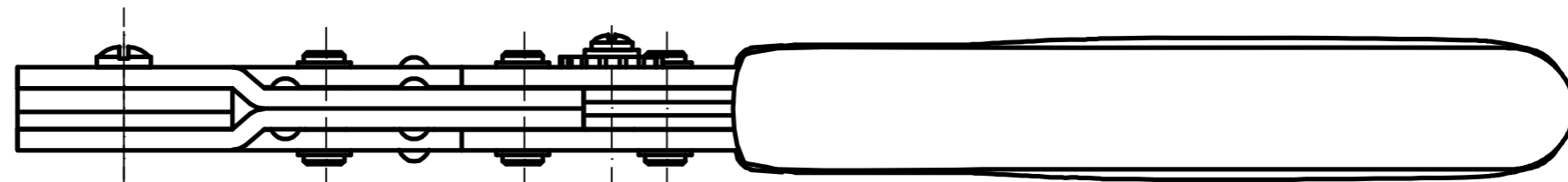

4100-3851

4100-3964

4100-2668

4101-1402

A - A

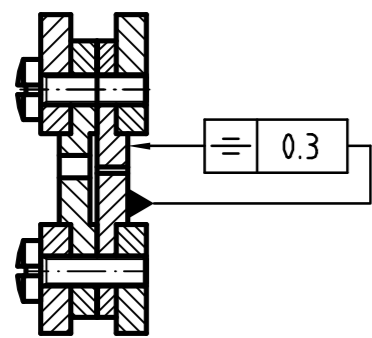

4x 4100-0101

4100-0451

2x 4100-0112



683-1611
Made in Sweden

1.5 2.5 6

XXXXXXX
YYYYYYY

4100-6689

4101-1403



4101-2610
4101-2614
4100-3776
4101-6494 G - placering position B

4100-0010
4100-0021
4100-0027

FÖRSPÄNNING / PRELOAD: 200 ± 40 N

Packas enligt förpackningsritning 4101-2725
Packed according to drawing 4101-2725

Material		Behandling/Treatment			Status Frisläppt	
Konstr./Design SE	Ritad/Drawn SE	Datum/Date 2009-05-18	Skala/Scale 1:1	Kontr./Checked MAHA	Godk./Approved NE	Anne/Blank
Benämning/Denomination KRIMPVERKTYG 683-1611 CRIMPING TOOL					Vikt/Weight,gram 0.643 g	Art grp 012
					Ritn nr./Drawing no 43003720	REV 000