

Verpackt in Gurtverpackung - *Tape on Reel Packaging*
 Verpackungseinheit: 260 Stück - *Packaging unit: 260 pcs*

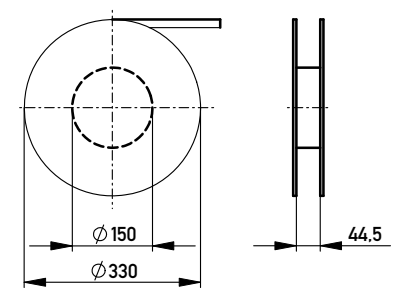

Abspulrichtung - *Reel off Direction* →

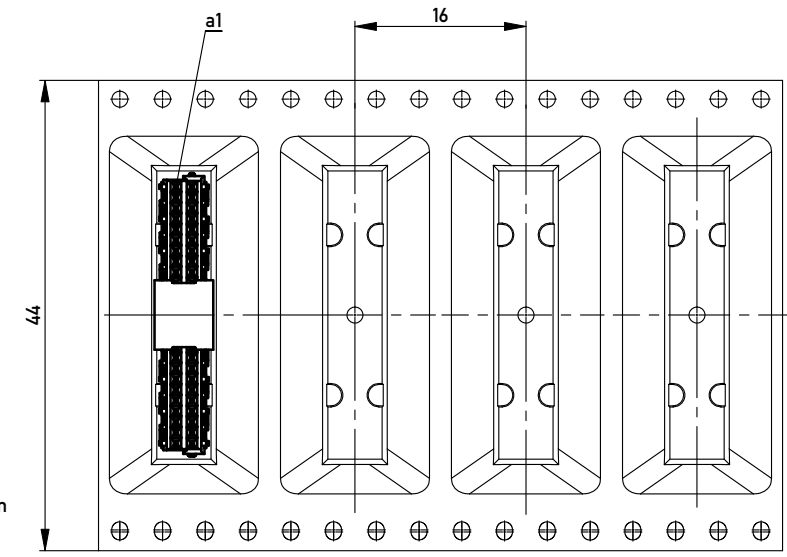
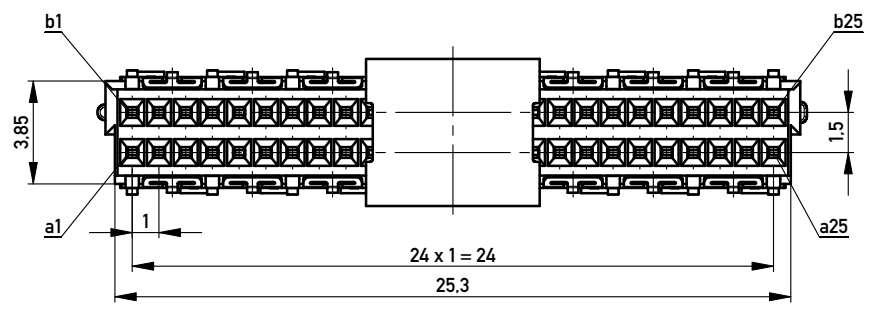

Leiterplatten-Layout Vorschlag / PCB-Layout Proposal

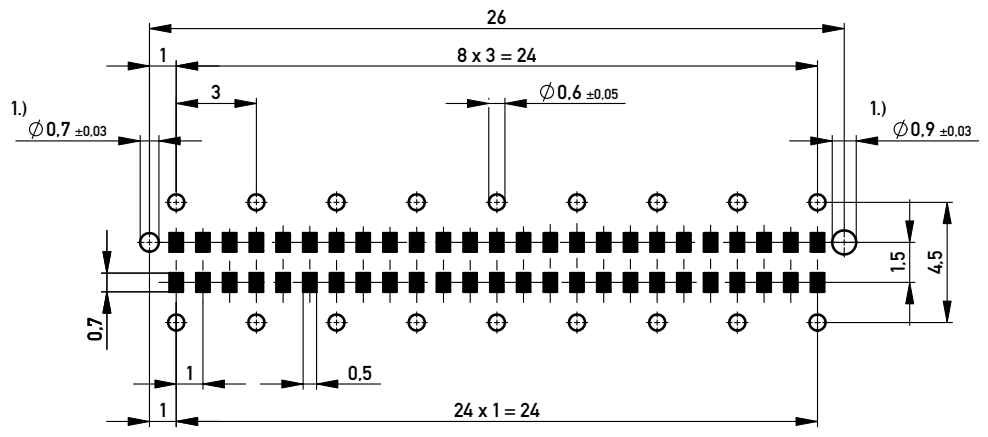

1.) Durchmesser des Bohrers / *Drill tool*

Anforderungsstufe 1
Performance Level 1

Kontaktbereich vergoldet
Mating Area gold plating

Anschlussbereich verzinkt 4-6µm
Terminal Area 4-6µm tin plating

Koplanarität der Anschlüsse ≤ 0.1mm
Coplanarity Area of Termination ≤ 0.1mm

Information: All rights reserved. Only for Information. To ensure that this is the latest version of this drawing, please contact one of the ERNI companies before using.	Tolerances All Dimensions in mm	Scale 5:1	Designation Federleiste 10mm THR, 50 polig Female 10mm THR, 50 contacts
	Subject to modification without prior notice. Drawing will not be updated.		
d Index	28.09.2010 Date	www.ERNI.com	1 A3
		Class MSPEED	

Copyright by ERNI GmbH
 Proprietary notice pursuant to ISO 16016 to be observed.