

FYTWK 20 YTH

This bearing unit will be discontinued at the end of 2019, and new unit series F2BC is already available as its replacement.

Compliance with standard	ISO
Housing material	Composite for the SKF Food Line
Sealing solution	Multiple seals

Dimensions

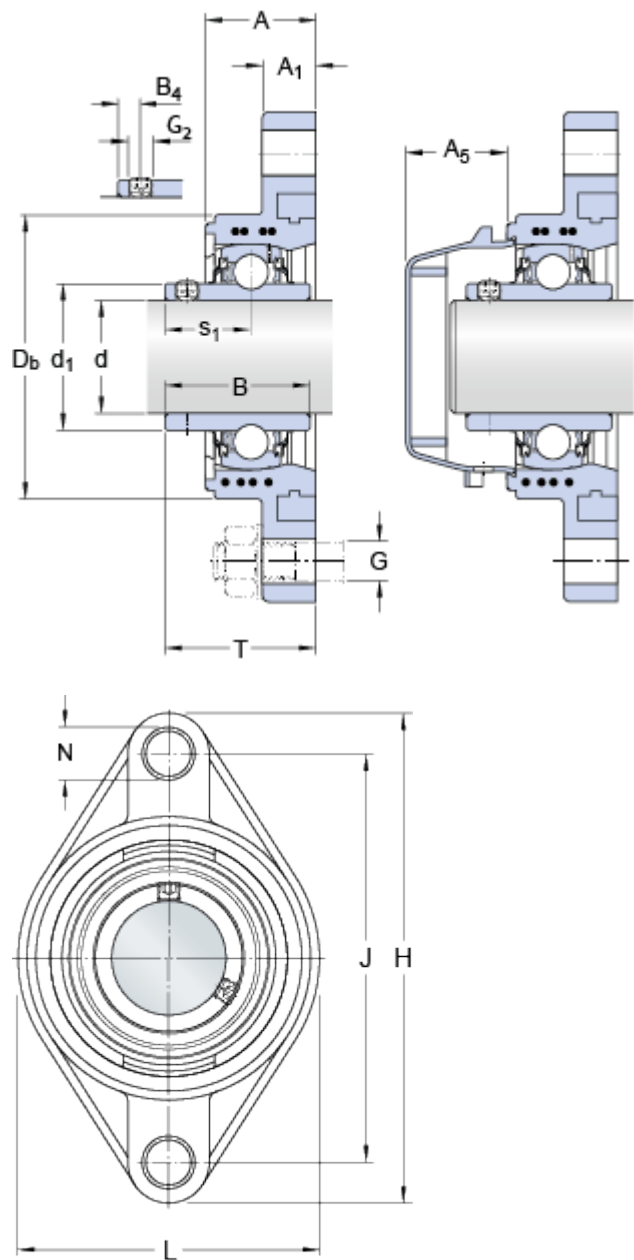

d	20	mm
d ₁	≈ 28.2	mm
D _b	59	mm
A	29.5	mm
A ₁	15	mm
A ₅	26	mm
B	31	mm
B ₄	4.5	mm
J	90	mm
H	112	mm
L	60.5	mm
N	12.3	mm
s ₁	18.3	mm
T	37.3	mm

Calculation data

Basic dynamic load rating	C	10.8	kN
Basic static load rating	C ₀	6.55	kN
Fatigue load limit	P _u	0.28	kN
Limiting speed		5000	r/min
(with shaft tolerance h6)			

Mass

Mass bearing unit	0.24	kg	
Mounting information			
Thread grub screw	G ₂	M6x0.75	
Hexagonal key size for grub screw	N	3	mm
Recommended tightening torque for grub screw		4	N·m
Recommended diameter for attachment bolts, mm	G	10	mm
Recommended diameter for attachment bolts, inch	G	0.375	in
Included products			
Housing		FYTWK 504 Y	
Bearing		YAR 204-2RF/HV	
Associated products			
End cover		ECW 204	