



FAG

29416-E1-XL

Axial spherical roller bearing

Axial spherical roller bearing 294..-E1-XL, no flanging ring

X-life

Technical information

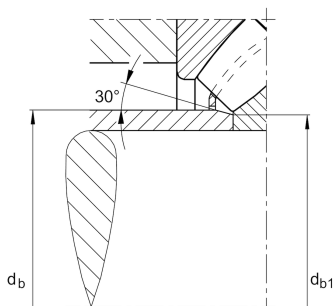
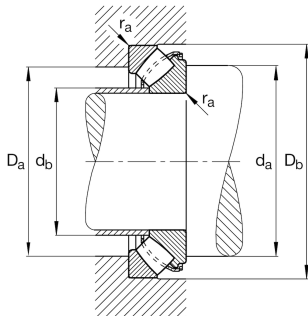
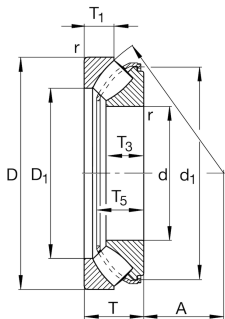

Your current product variant

Heat treatment	-ZZ	Standard
Locating feature, shaft washer	Without	
Handling thread holes	Without	
Constricted width and inclination variation	Standard	
Test certificate	Without	

Main Dimensions & Performance Data

d	80 mm	Bore diameter
D	170 mm	Outside diameter
T	54 mm	Height
C _a	720,000 N	Basic dynamic load rating, axial
C _{0a}	1,720,000 N	Basic static load rating, axial
C _{ua}	199,000 N	Fatigue load limit, axial
n _G	4,350 1/min	Limiting speed
n _{gr}	2,140 1/min	Reference speed
≈m	5.32 kg	Weight



Mounting dimensions

$d_{a\ min}$	125 mm	Minimum diameter shaft shoulder
$D_{a\ max}$	141 mm	Maximum diameter of housing shoulder
$D_{b\ min}$	173 mm	Minimum bore diameter housing
$d_{b\ max}$	88 mm	Maximum distance sleeve
$r_{a\ max}$	2.1 mm	Maximum recess radius







Dimensions

D_1	112.5 mm	Bore diameter housing washer
d_1	150.9 mm	Rip diameter shaft washer
r_{min}	2.1 mm	Minimum chamfer dimension
T_1	26.5 mm	Height of the housing washer
T_3	35 mm	Height of the shaft washer
T_5	48.5 mm	Distance shaft washer - cage
A	50 mm	Distance of the center point

Temperature range

T_{min}	-30 °C	Operating temperature min.
T_{max}	200 °C	Operating temperature max.

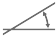
Characteristics

-  F_r Radial load
-  F_a Axial load in one direction
-  Grease Lubrication
-  Oil Lubrication
-  Not sealed
-  Static angular error and misalignment
-  Dynamic angular error and misalignment