

FEATURES

- Copper body material for high conductivity and easy crimping
- Tin plating for resistance to corrosion
- Added strength and excellent conductivity
- Vinyl insulation for electrical insulation and terminal protection
- Colour coded insulation for easy identification of terminal size
- Expanded insulation entry for easy wire insertion

RS PRO Insulated Ring Terminal, M5 Stud Size, 1.5mm² to 2.5mm² Wire Size, Blue

RS Stock No.: 613-9312



RS Professionally Approved Products bring to you professional quality parts across all product categories. Our product range has been tested by engineers and provides a comparable quality to the leading brands without paying a premium price.

Product Description

From RS PRO a high-quality insulated crimp ring terminal, also known as a ring connector or cable lug. Ring crimp terminals are used for connecting an electrical cable or wire to a stud or a post on an electrical component such as a battery terminal. This ring terminal is made from highly conductive copper and then tin plated for maximum electrical conductivity and corrosion resistance. A colour coded vinyl insulation provides protection to the terminal and aids quick identification of the terminal size. Once correctly crimped onto a wire or cable this ring terminal will provide a secure and reliable electrical connection.

General Specifications

Insulation	Insulated
Insulation Material	Vinyl
Colour	Blue
Contact Material	Copper
Contact Plating	Tin
Stud Size	M5
Application	Wide range of industries for connecting wires to electrical components. Applications include wiring in industrial control systems and industrial machines, automotive applications, communication equipment, power supplies and domestic appliances.

Electrical Specifications

Maximum Electrical Rating	75°C 600V Max.
Maximum Electrical Current	14 AWG: 30A, 16 AWG: 18A

Mechanical Specifications

Thickness	0.8mm
Overall Length	22.8mm
Inner Ring Diameter	5.3mm
Outer Ring Diameter	8.5mm
Maximum Wire Size	2.5mm ²
Minimum Wire Size	1.5mm ²
Maximum Wire Size (AWG)	14AWG
Minimum Wire Size (AWG)	16AWG

Operation Environment Specifications

Maximum Operating Temperature	150°C
-------------------------------	-------

Approvals

Compliance/Certifications	UL
---------------------------	----

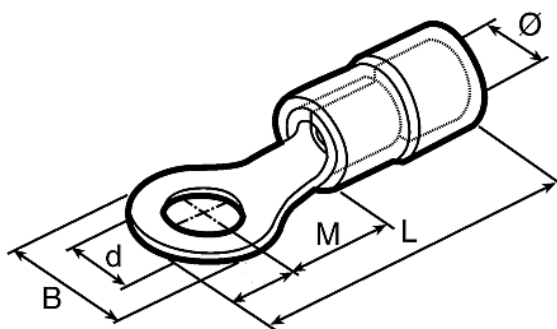

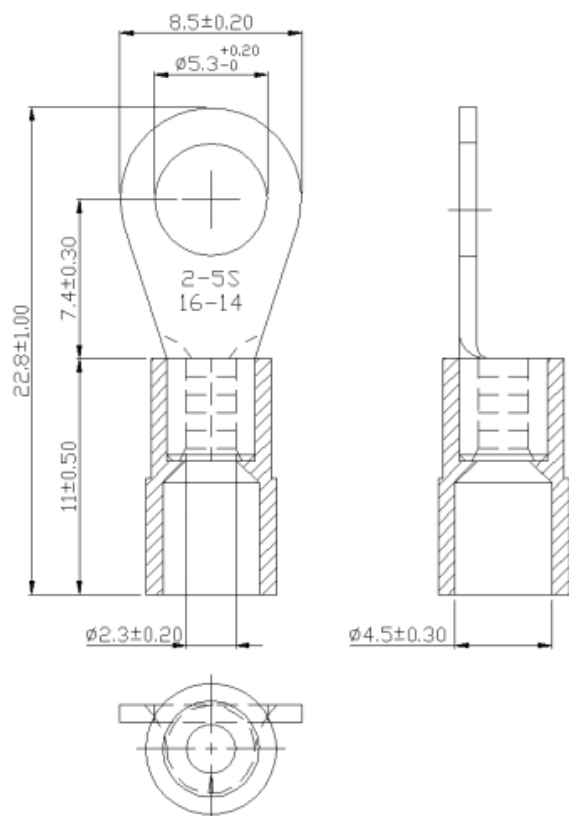

MAXIMUM ELECTRIC CURRENT:

A.W.G.	16	14
AMP.	18	30



MAXIMUM ELECTRICAL RATING: 105°C 600 VOLTS MAX.

INSULATION MATERIAL: VINYL

INSULATION COLOR: 16-14A.W.G.: BLUE

TERMINAL MATERIAL: COPPER

WIRE RANGE A.W.G. mm ²	ITEM NO.		STUD SIZE		DIMENSION inch(mm)						
	BRAZED SEAM	BUTTED SEAM	d2		W	F	L	E	D	d1	T
16-14 A.W.G. 1.5-2.5 mm ²	613-9312		#10	0.209	0.335	0.307	0.898	0.433	0.177	0.091	0.031
				5.3	8.5	7.8	22.8	11	4.500	2.3	0.8

Wire Size	Colour	Stud Size	Replacement Stock Number
0.5 to 1.5 mm ²	Red	M4	613-9249
1.5 to 2.5 mm ²	Blue	M4	613-9508
1.5 to 2.5 mm ²	Blue	M5	613-9312
4 to 6 mm ²	Yellow	M6	613-9413
0.5 to 1.5 mm ²	Red	M4	613-9479
1.5 to 2.5 mm ²	Blue	M4	613-9435