

NOTES

Packaging:  
per 100 pieces.

Corrosion resistance:  
24 hours exposure to salt spray

ASSEMBLY VIEW

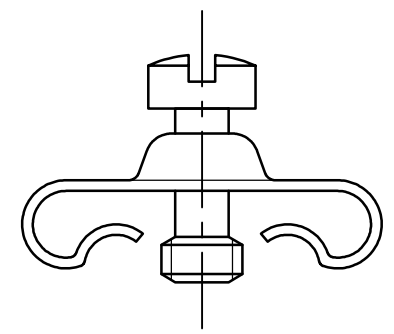

|             |            |
|-------------|------------|
| Part number | 863008AT   |
| Part number | 863008ATLF |



Copyright FCI.

NOTE: RoHS INFORMATIONS

- The "LF" products meet European union Directives and other country regulations as described in GS-22-008.
- Plating Sn (pure bright ) over copper
- Packaging spec: see GS-14-920

| rev | ecn no    | dr  | date       |
|-----|-----------|-----|------------|
| B   | -         | JOU | 2003/01/28 |
| C   | LS05-0026 | MPE | 2005/07/08 |
| D   | LS06-0097 | LGO | 2006/07/28 |
| -   | -         | -   | -          |
| -   | -         | -   | -          |
| -   | -         | -   | -          |

|                    |         |                                       |                                   |                  |              |
|--------------------|---------|---------------------------------------|-----------------------------------|------------------|--------------|
| www.fciconnect.com |         | surface<br>ISO 1302                   | tolerance std<br>ISO 406 ISO 1101 | projection<br>A3 | mm           |
|                    |         | TOLERANCES UNLESS OTHERWISE SPECIFIED |                                   | size             | Scale        |
| Dr                 | JOUBERT | 1994/07/01                            | ANGULAR                           | 0.X              | ±0.1         |
| Eng                | PESSON  | 1994/07/01                            | LINEAR                            | 0.XX             | ±0.1         |
| Chr                | LEGARE  | 1994/07/01                            | 0.XX' ±2"                         | 0.XXX            | ±0.1         |
| Appr               | LEGARE  | 1994/07/01                            | Product family                    |                  | ECN          |
|                    |         |                                       |                                   | D-SUB            | LS06-0097    |
|                    |         |                                       |                                   | Spec ref         | -            |
| FCI                |         | MALE SCREW LOCKS                      |                                   | dwg no           | Rev.         |
|                    |         |                                       |                                   | C01-8655-0653    | D            |
|                    |         | catalog no                            |                                   | CUSTOMER         | sheet 1 of 1 |