

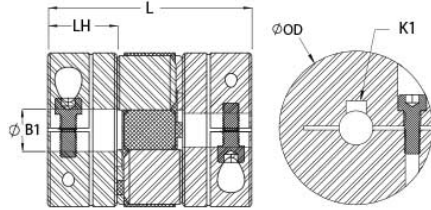

MJCC80-32-A

Ruland MJCC80-32-A, 32mm Jaw Coupling Hub, Aluminum, Clamp Style With Keyway, 79.4mm OD, 40.4mm Length



Description

Ruland MJCC80-32-A is a clamp zero-backlash jaw coupling hub with a 32mm bore, 10mm keyway, 79.4mm OD, and 111.2mm length. It is a component in a three-piece design consisting of two aluminum hubs and an elastomeric insert called the spider creating a lightweight low inertia coupling capable of speeds up to 8,000 RPM. This three-piece design allows for a highly customizable coupling that easily combines clamp or set screw hubs with inch, metric, keyed, and keyless bores. Spiders are available in three durometers allowing the user to tailor coupling performance to their application. Ruland jaw couplings have a balanced design for reduced vibration at high speeds. Hardware is metric and tests beyond DIN 912 12.9 standards for maximum torque capabilities. MJCC80-32-A is machined from bar stock that is sourced exclusively from North American mills and is RoHS3 and REACH compliant. It is manufactured in our Marlborough, MA factory under strict controls using proprietary processes.

Product Specifications

Bore (B1)	32 mm	Keyway (K)	10 mm
Outer Diameter (OD)	3.125 in (79.4 mm)	Bore Tolerance	+0.03 mm / -0.00 mm
Hub Width (LH)	40.4 mm	Length (L)	4.379 in (111.2 mm)
Recommended Shaft Tolerance	+0.000 mm / -0.013 mm	Key Width (K1)	10 mm
Key Height (K1)	8 mm	Keyway 1 Height (T1)	35.3 mm
Keyway 1 Width Tolerance	+0.018 mm / -0.018 mm	Keyway 1 Height Tolerance	+0.2 mm / 0 mm
Forged Clamp Screw	M8	Number of Screws	1 ea
Screw Material	Alloy Steel	Screw Finish	Black Oxide
Hex Wrench Size	6.0 mm	Seating Torque	39 Nm
Torque Specifications	Torque ratings vary with insert selection	Misalignment	Misalignment ratings vary with insert selection
Maximum Speed	8,000 RPM	Moment of Inertia	4.680 ⁻⁴ kg-m ²
Full Bearing Support Required?	Yes	Recommended Inserts	JD50/80-98R , JD50/80-92Y
Zero-Backlash?	Yes	Balanced Design	Yes
Fail Safe?	Yes	Weight (lbs)	1.086769
Temperature	-10°F to 180°F (-23°C to 82°C)	Material Specification	2024-T351 Aluminum Bar
Finish	Bright	Finish Specification	Bright, No Plating
Manufacturer	Ruland Manufacturing	Recommended Gap Between Hubs	Rating Coming Soon
Country of Origin	USA	UPC	65432940709
UNSPC	31163011	Tariff Code	8483.60.8000

- Note 1** Stainless steel hubs are available upon request.
- Note 2** Performance ratings are for guidance only. The user must determine suitability for a particular application.
- Note 3** Torque ratings for the couplings are based on the physical limitations/failure point of the spiders. Under normal/typical conditions the hubs are capable of holding up to the nominal torque of the spiders. Please consult technical support for more assistance.

Prop 65 **WARNING** This product can expose you to the chemical Ethylene Thiourea, known to the State of California to cause cancer and birth defects or other reproductive harm. For more information go to

