

Features

- Full Text OLED Display
- i23 Smart Application Suite
- Event Logging
- Software for Commissioning, Logging and Troubleshooting
- Automatic Reset
- Fire mode
- Built in I²t Motor Overload Protection
- Optional Remote Display Keypad
- Suitable for single and 3-phase motors

RS PRO VMX-agility 80A-195A

RS Stock No.: 206-106, 206-108, 206-109, 206-111, 206-112



RS Professionally Approved Products bring to you professional quality parts across all product categories. Our product range has been tested by engineers and provides a comparable quality to the leading brands without paying a premium price.

Product Description

Agile Soft-Starter:

- Reduce mechanical stress on your motor
- Suitable for fixed speed applications with the following pre-set applications built in:
Agitator, Centrifugal Compressor Reciprocating Compressor, Rotary Screw Compressor, Rotary Vane Compressor, Scroll Compressor, Conveyor Loaded, Conveyor Unloaded, Crusher, Fan High Inertia, Fan Low Inertia, Grinder, Mill, Mixer, Moulding M/C, Press Flywheel, Submersible Pump, Centrifugal Pump, Rotodynamic Pump, Positive Displacement Pump, Reciprocating Pump, Rotary Pump, Pump Jack, Saw Band, Saw Circular, Screen Vibrating, Shredder, Woodchipper

General Specifications

Device Type	3-phase AC Semiconductor Agile Motor Controller
Function	SoftStarter; Fixed Speed Control; Motor Control
Current (400V / TC10)	80A, 106A, 132A, 160A, 195A
Power Rating (400V / TC10)	45kW, 55kW, 75kW, 90kW, 110kW
Screen	OLED
External Keypad - options	Yes - IP54 or IP65 via Cat5e/Cat6
Bypass	Internally Bypassed
Communications	Modbus RTU
Data Logging	Event Logging
Automatic Reset	Can be used to attempt restart following fault
Upload / Download	Via USB Memory Stick
Motor Protection	Full I ² t Motor Overload with Thermal Memory
Languages	English, French, German, Spanish, Portuguese, Italian.

Mechanical Specifications

Overall Dimensions	H296mm x W147mm x D237mm
Weight	6kg
Mounting Type	Panel

Electrical Specifications

Supply Phases	3-phase. Single-phase selectable.
Supply Voltage	200VAC, 208VAC, 230VAC, 400VAC, 460VAC, 600VAC *
Supply Frequency	45-65 Hz
Control Voltage	24VDC standard, 110 / 230VAC with optional power supply *
Input / Outputs	2 x Programmable Digital Inputs 2 x Programmable Digital Outputs
Rated Starting Capability	Trip Class 10 - 3 x Motor Current for 23 secs - 3.5 x Motor Current for 17 secs Trip Class 20 - 4 x Motor Current for 19 secs Trip Class 30 - 4 x Motor Current for 29 secs
Connection	In-Line
Terminal Type	Cage Clamp

*+10% / -15%

Operation Environment Specifications

Ambient Temperature	-20°C to +40°C up to +60°C with derating
Storage Temperature	-20°C to +70°C
Altitude	1000m above sea level. 2000m with derating

Protection Category

IP Rating	IP20 (with fingerguards)
------------------	--------------------------

Approvals

Standards	CE, UL, cUL
Legislation	<p>Directives:</p> <p>2014/35/EU - Electrical equipment designed for use within certain voltage limits [Low Voltage Directive - LVD].</p> <p>2014/30/EU - Electromagnetic compatibility [EMC]</p> <p>2011/65/EU - Restriction of the use of certain hazardous substances in electrical and electronic equipment [RoHS] and amending Commission Delegated Directive (EU) 2015/863 with effect from 22 July 2019.</p> <p>Harmonised Standards:</p> <p>EN 60947-4-2:2012 - Low Voltage switchgear and controlgear. Part 4: Controlgear and motor-starters. Section 2. AC Semiconductor motor controllers and starters.</p> <p>EN IEC 63000: 2018 - Technical documentation for the assessment of electrical and electronic products with respect to RoHS.</p>
Environmental	Products comply to RoHS and REACH

Dimension Drawing

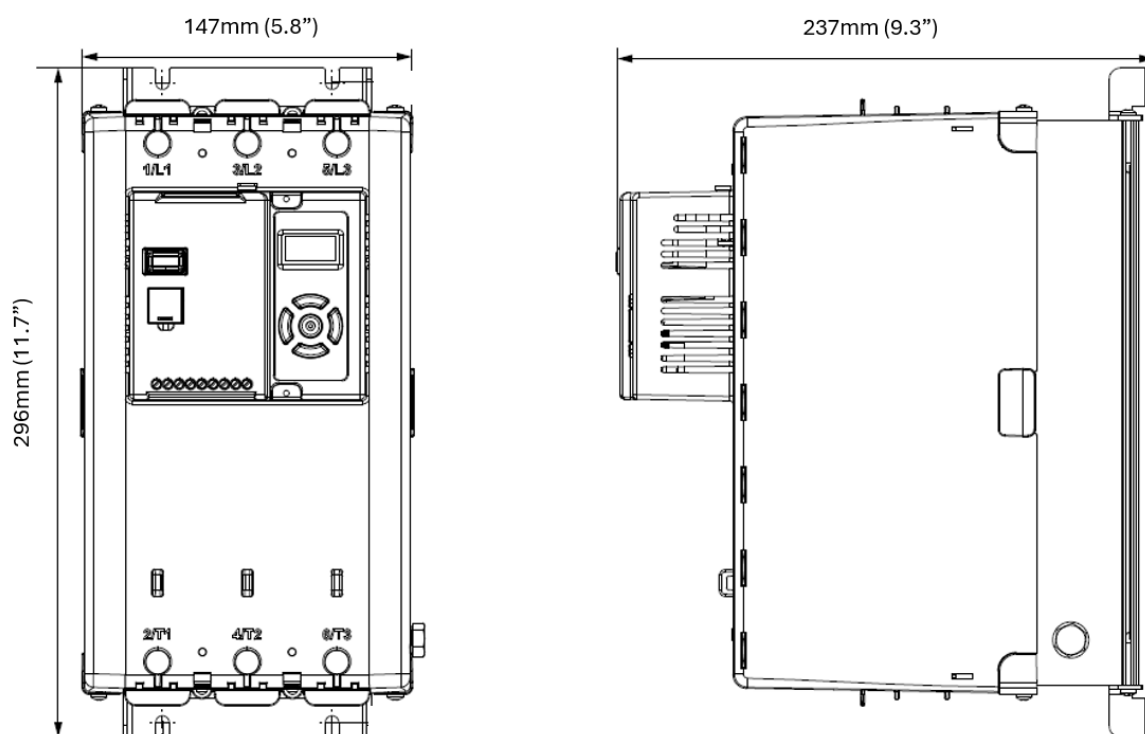

Rated Power and Current

Step 1 - Select the application from the list and follow that column down.	Typical Applications	Default Agitator Compressor (Rotary Vane, Unloaded) Conveyor (Unloaded) Bow Thruster (Zero Pitch) Fan (Low Inertia <85A) Feeder (Screw) Lathe Machines Mixer (Unloaded) Moulding Machine Plastic and Textile Machines Pump - Submersible (Centrifugal, Rotodynamic) Saw (Band) Transformers or Voltage Regulators	Heavy Compressor (Cebtrifugal, Reciprocating, Rotary Screw) Ball Mill Bow Thruster (Loaded) Conveyor (Loaded) Grinder Hammer Mill Mills (Flour etc..) Mixer (Loaded) Pelletisers Press, Flywheel Positive Displacement Pump (Reciprocating, Rotary) Pump Jack Rolling Mill Roots Blower Saw (Circular) Screen - Vibrating Tumblers	Crusher Shredder Wood Chipper Fan (High Inertia >85A)							
		<div>VMX-agility is not suitable for very high inertia loads such as centrifuges, loaded crushers or start times >30s.</div>									
Step 2 - Confirm the rated starting capability of the soft start against the application.	Trip Class Rated Starting Capability Max Starts per Hour with Optional Cooling Fan	Trip Class 10 3x Motor Current - 23secs 3.5x Motor Current - 17secs 5 starts/hour See below	Trip Class 20 4x Motor Current - 19secs 5 starts/hour See below	Trip Class 30 4x Motor Current - 29secs 5 starts/hour -							
Step 3 - Consider the operating environment and make the model selection on a higher amp rating.	Height Above Sea Level	Standard operating height is 1000m, for every 100m increase motor Amps/kW by 1%, up to 2000m. Example: For a 20A motor at 1500m make model selection based on 21A (5% higher)									
	Operating Temperature	Standard operating temperature is 40degC, for every 1degC above, increase motor Amps/kW by 2%, up to 60degC. Example: For a 20A motor at 50degC make model selection based on 24A (20% higher)									
	Increased Starts per Hour	Fit optional fan to increase maximum starts per hour. 206-106 to 206-108 up to 40 starts/hour 206-109 up to 30 starts/hour, 206-111 up to 20 starts/hour, 206-112 up to 10 starts/hour									
Step 4 - Select your motor Voltage and Horsepower/kW and select model.	Motor Rating							Select Model 5 starts/hour @ 40°C	Select Model 5 starts/hour @ 40°C	Select Model 5 starts/hour @ 40°C	
	I ₀ A	kW			FLA A						
		230V	400V	500V		230V	440V	600V			
	66	18.5	37	45	65	20	50	60	See Size 1	206-106 (80A)	206-108 (106A)
	80	22	45	55	77	25	60	75	206-106 (80A)	206-108 (106A)	206-109 (132A)
	106	30	55	75	100	30	75	100	206-108 (106A)	206-109 (132A)	206-111 (160A)
	132	37	75	90	125	40	100	125	206-109 (132A)	206-111 (160A)	206-112 (195A)
	160	45	90	110	156	60	125	150	206-111 (160A)	206-112 (195A)	
	195	55	110	132	192	60	150	200	206-112 (195A)		

VMX-agility is not suitable for very high inertia loads such as centrifuges, loaded crushers or start times >30s.