



FAG

SES526-L

Plummer block housing

Split plummer block housing for various bearing designs. The SNV series will be replaced by the new SES series in 2022.

Technical information

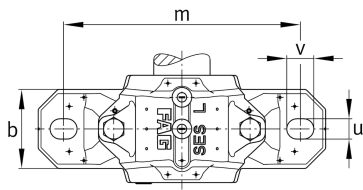

Main Dimensions & Performance Data

D	230 mm	Outside diameter bearing
a	445 mm	Length base
h ₁	290 mm	Height
g	190 mm	Width housing body
K	90 mm	Width bearing seat
≈m	33 kg	Weight

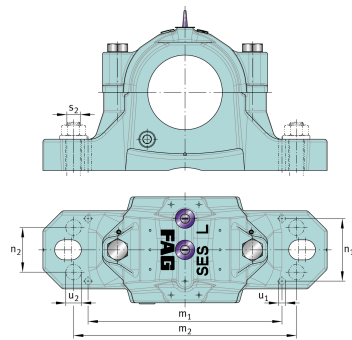
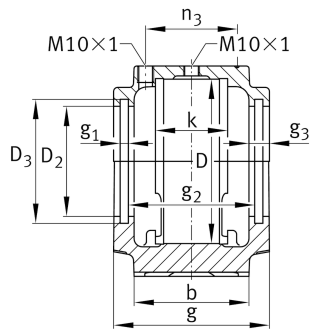
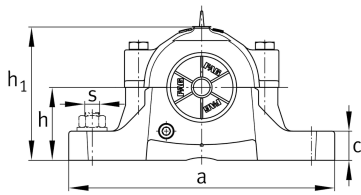

Dimensions

b	130 mm	Width base
c	50 mm	Height base
h	150 mm	Base to shaft centerline height
m	380 mm	Distance fixing bore
s	25.4 mm	Screw size
s	M24	Size of fixing screws
u	28 mm	Width slot
v	35 mm	Length slot
D ₂	167.5 mm	Diameter sealing
D ₃	177.5 mm	Diameter sealing groove
D ₅	174.7 mm	Outside diameter sealing labyrinth
g ₁	6 mm	Width sealing groove
g ₂	168 mm	Distance sealing
g ₃	15 mm	Wall thickness
g ₄	46 mm	Distance oil lubrication
m ₁	328 mm	Distance holes aligned pins m1
n ₃	122 mm	Distance lubrication
n ₄	170 mm	Distance lubrication sealing
u ₁	10 mm	Bore diameter u1
u ₂	22 mm	Bore diameter u2