



**FAG**

## SES216-L

### Plummer block housing

Split plummer block housing for various bearing designs. The SNV series will be replaced by the new SES series in 2022.

## Technical information

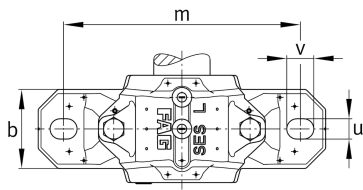

### Main Dimensions & Performance Data

D	140 mm	Outside diameter bearing
a	315 mm	Length base
h <sub>1</sub>	177 mm	Height
g	120 mm	Width housing body
K	58 mm	Width bearing seat
≈m	8.9 kg	Weight

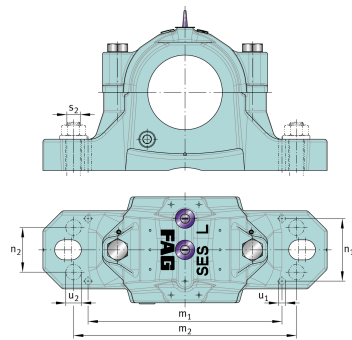
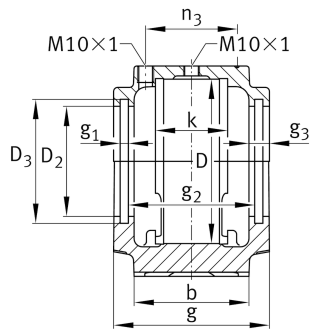
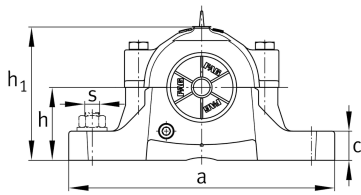

## Dimensions

b	90 mm	Width base
c	32 mm	Height base
h	95 mm	Base to shaft centerline height
m	260 mm	Distance fixing bore
s	19.05 mm	Screw size
s	M20	Size of fixing screws
u	22 mm	Width slot
v	28 mm	Length slot
D 2	108 mm	Diameter sealing
D 3	116.5 mm	Diameter sealing groove
D 5	114.2 mm	Outside diameter sealing labyrinth
g 1	5 mm	Width sealing groove
g 2	102 mm	Distance sealing
g 3	13 mm	Wall thickness
g 4	36 mm	Distance oil lubrication
m 1	218 mm	Distance holes aligned pins m1
n 3	77 mm	Distance lubrication
n 4	106 mm	Distance lubrication sealing
u 1	8 mm	Bore diameter u1
u 2	18 mm	Bore diameter u2