



PRODUCT DATASHEET

Rebecca series

last update 19/9/2014

DETAILS

Product Number	CA14557_REBECCA-RGB-WW
Family	Rebecca
Type	Assembly
Color	white
Diameter	33,3 mm
Height	29,9 mm
Style	round
Optic Material	PMMA
Holder Material	HRPC
Fastening	tape
Status	ready
ROHS Compliant	Yes
Date Updated	19/09/2014



OPTICAL PROPERTIES

	Viewing	Light	Effi-		
LED	Angle	Beam	ciency	cd/lm	Connector
XM-L RGB	38 deg	Very Wide	69 %	0.980	-

Relative intensity of CA14557_REBECCA-**RGB-WW**_(XM-L RGB(W))

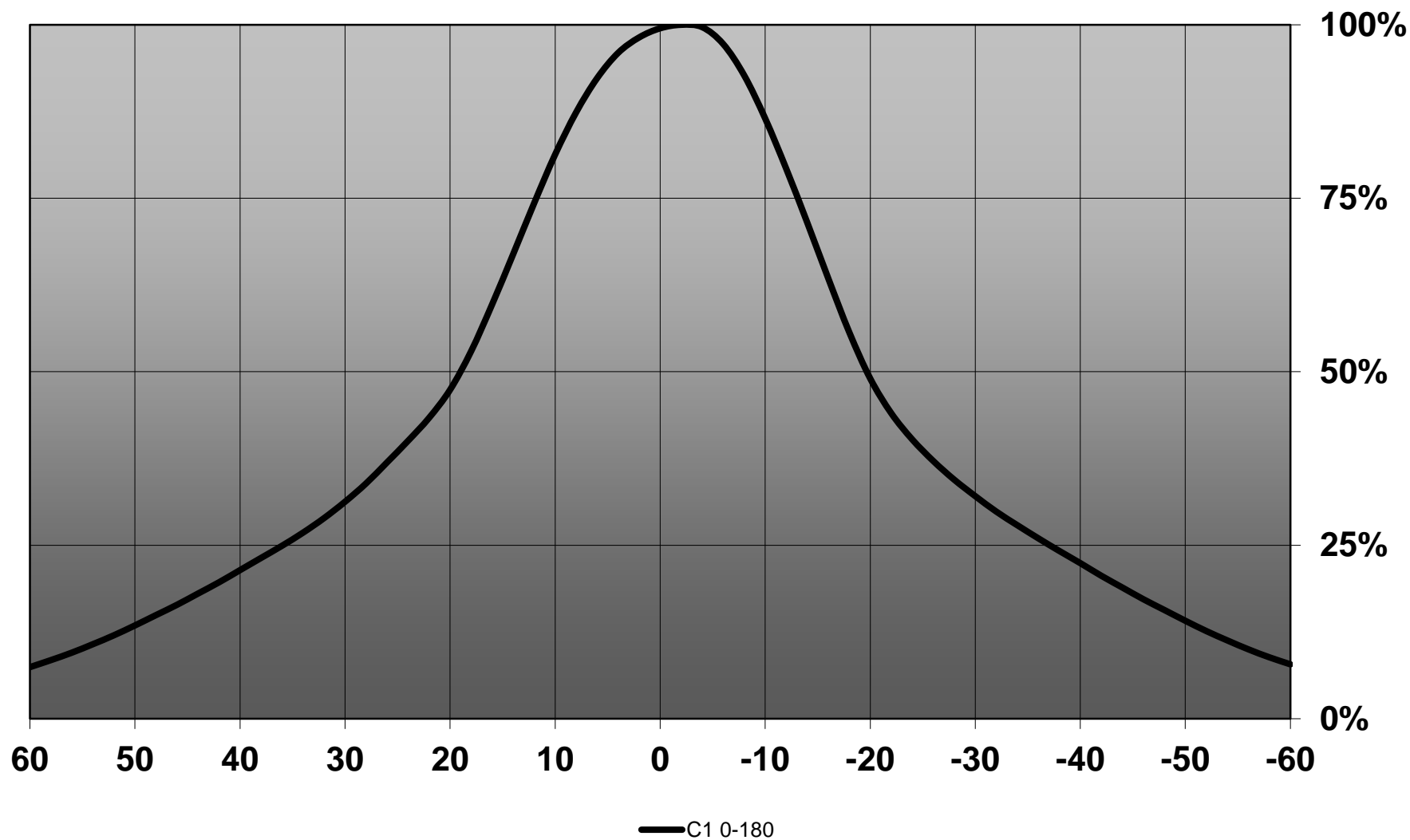

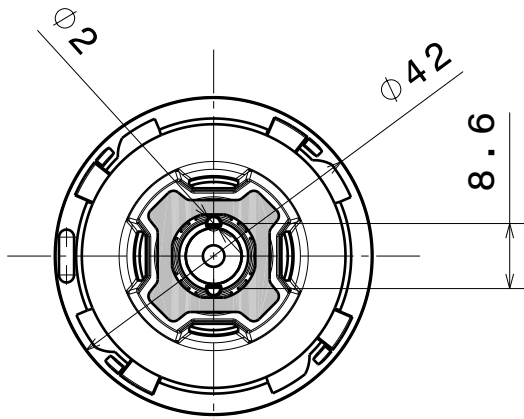

Bottom view

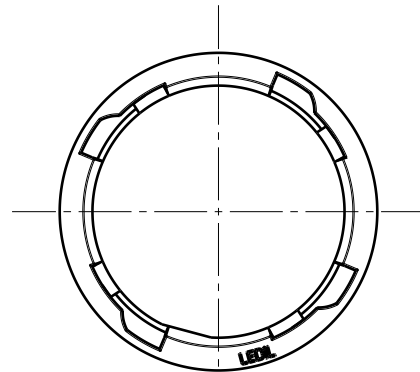

Top view

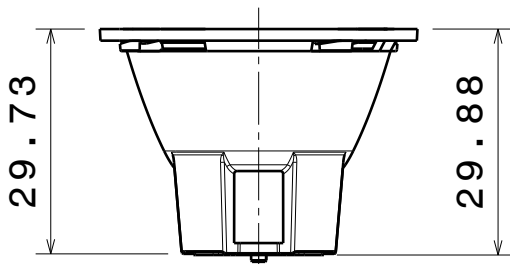

Front view

INDEX	PART NO	DESCRIPTION	MATERIAL	COLOUR
1	C14524	REBECCA-RZ-WW	PMMA	
2	C13910	REBECCA-RGB-HLD	PC	white
3	C11269	HEIDI-TAPE	adhesive foam tape	

Tolerances if not otherwise shown
According to DIN ISO 2768-1
Linear measures:
Up to 30mm class M, otherwise class C.
According to DIN ISO 2768-2
Form and position: class L

LEDiL

Ledil Oy
Salorankatu 10
FIN 24240 SALO
Finland

THIRD ANGLE PROJECTION:

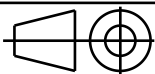

DRAWING TITLE

CA14557_REBECCA-RGB-WW MechanicalDrawing

This drawing is the property
of LEDiL Oy. It may not be
reproduced, copied or
communicated without a written
agreement with LEDiL Oy."

SIZE

A4

PART NUMBER

CA14557

SCALE

1:1

WEIGHT

-

SHEET

1/1

NOTE: The typical divergence will be changed by different color, chip size and chip position tolerance. The typical total divergence is the full angle measured where the luminous intensity is half of the peak value.

GENERAL INFORMATION

- Product series especially designed & optimized for series of LEDs.
- Special care taken to make light distribution as uniform as possible.
- Fastening to heat sink with a PU foam adhesive tape of automotive grade. Please find fastening details by clicking link: http://www.ledil.com/datasheets/DataSheet_TAPE.pdf

NOTE 1: We advise customer to ensure the suitability and sufficiency of the bond in the end product. For example, mechanical stress, vibration and holes on the surface of the circuit board weaken the strength of the tape.

NOTE 2: Assembly to the surface must be made straight, so the tape bonds constant and balanced with fastening surface. Slanted assembly might cause unbalanced bond to the surface. All surfaces where tape is applied must be clean, dry and free from grease and dirt.

If cleaning of PCB surfaces is needed, please follow strictly the cleaning instructions of your LED manufacturer - this is important as cleaning shall under no circumstances damage LEDs or other electronics components on the PCB.

Further note that optical components shall not be cleaned with any chemicals - only micro fiber cloth may be used to remove fingerprints or other traces from handling.