

2600 series

Power rocker switches

Distinctive features and specifications



- Three rocker shapes : plain, V-shaped or concave
- Various rocker colours
- Frame with protection guard on 2600LP models
- Illuminated or non-illuminated
- UL, CSA, VDE and NF (EN 61058-1) approved

ELECTRICAL SPECIFICATIONS

- Max. current/voltage rating with resistive load and approved ratings : see table below.
- Initial contact resistance : 10mΩ max.
- Insulation resistance : 1.000 MΩ min. at 500VDC
- Dielectric strength : 2.500 Vrms 50 Hz min. between terminals
3.000 Vrms 50 Hz min. between terminals and metal panel
- Electrical life : 10.000 cycles at full load

| FUNCTIONS | APPROVED RATINGS | | | | DIRECT CURRENT | |
|---------------------|--|--|----------------------------|----------------------------|----------------|--------|
| | CSA (double pole) | UL (double pole) | VDE | NF | 24 VDC | 12 VDC |
| | CSA 22-2 | UL 1054 | EN 61058-1 | EN 61058-1 | | |
| ON - OFF ON - ON | 1/6 HP 125VAC 16A 125VAC 16A 250VAC 1/3 HP 250VAC | 1/6 HP 125VAC 16A 125VAC 16A 250VAC 1/3 HP 250VAC | 10(4)A 250VAC T 85/55 | - | 10A | 15A |
| ON - OFF - ON | 10A 125VAC 10A 250VAC 1/6 HP 125/250VAC | 10A 125VAC 10A 250VAC 1/6 HP 125/250VAC | L1 option 10(4)A 250VAC | L1 option 10(4)A 250VAC | 8A | 10A |
| ON - ON - ON | - | - | - | - | 5A | 8A |
| OTHERS | 10A 125VAC 10A 250VAC 1/6 HP 250VAC | - | L1 option 10(4)A 250VAC | L1 option 10(4)A 250VAC | 8A | 10A |

MATERIALS

- Case : melamine/polyester
- Frame : polyamide
- Actuator : polyamide
- Contacts :
- A : silver
- C : copper, silver plated

GENERAL SPECIFICATIONS

- Panel thickness : 0,8 mm to 4 mm (.031 to .157)
- Operating temperature :
 - silver contacts (A) : -20°C to +85°C
 - silver plated contacts (C) : -10°C to +55°C

AGENCY APPROVALS



EN 61058-1 EN 61058-1

Availability : consult factory for details of approved models.

Marking : approved models are standard marked.

2600 series

Power rocker switches

Overview

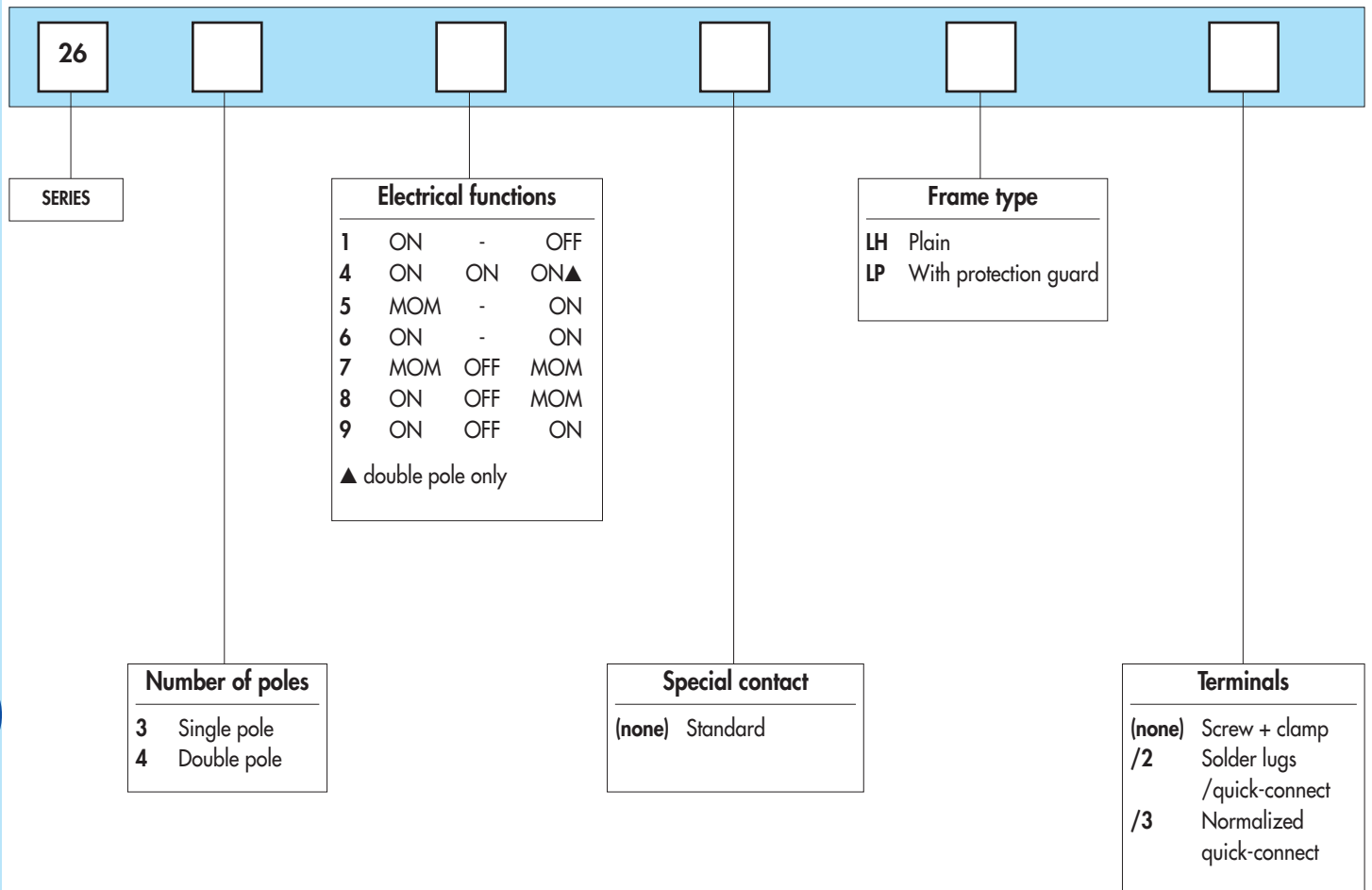

ABOUT THIS SERIES

On the following pages, you will find successively :

- model structure of switches
- options in the same order as in above chart

Dimensions : first dimensions are in mm while inches are shown as bracketed numbers.



Sealing boot U21 50 available to protect the switches against dust and water. See section H.



NOTICE : please note that not all combinations of above numbers are available. Refer to the following pages for further information.



2600 series

Power rocker switches

Overview

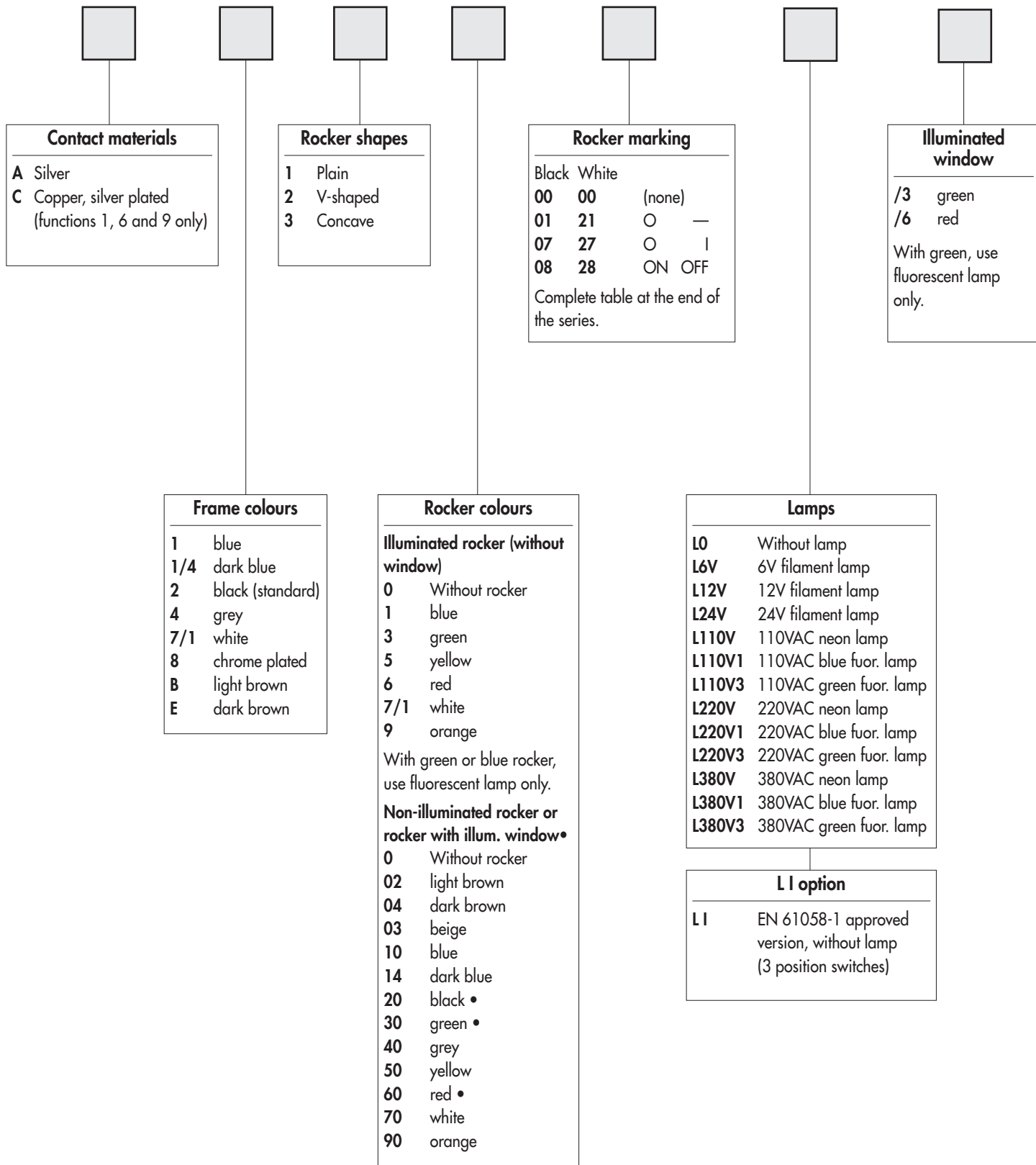

D



Packaging unit : 20 pieces per type and colour.

2600 series

Power rocker switches

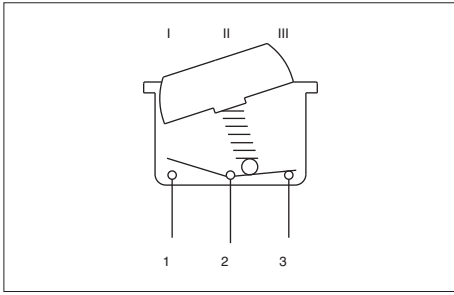

- Model 2600LP with protection guard
- 1 and 2 pole configurations

2640LH

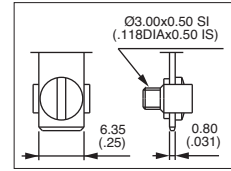

2640LH/2

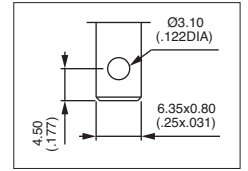

MODEL STRUCTURE

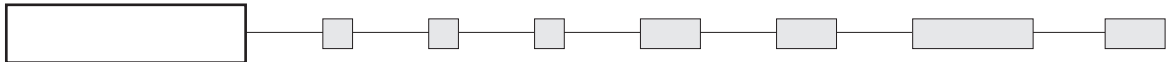

2600LH - single pole



Screw term. + clamp Solder lug/ quick-connect

| | III A2-A1 | II A2-A3 | I |
|--------|--------------|-------------|-----|
| 2631LH | 2631LH/2 | ON - | OFF |
| 2645LH | 2645LH/2 | MOM - | ON |
| 2636LH | 2636LH/2 | ON - | ON |
| 2637LH | 2647LH/2 | MOM OFF | MOM |
| 2638LH | 2638LH/2 | ON OFF | MOM |
| 2639LH | 2639LH/2 | ON OFF | ON |

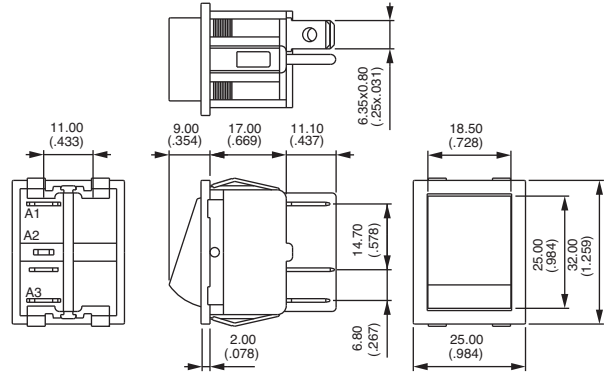

2600LH - double pole



Screw term. + clamp Solder lug/ quick-connect

| | III A2-A1 B5-B4 | II A2-A3 B5-B6 | I |
|---------|-----------------------|----------------------|-----|
| 2641LH | 2641LH/2 | ON - | OFF |
| 2644LH* | 2644LH/2* | ON ON | ON |
| 2645LH | 2645LH/2 | MOM - | ON |
| 2646LH | 2646LH/2 | ON - | ON |
| 2647LH | 2647LH/2 | MOM OFF | MOM |
| 2648LH | 2648LH/2 | ON OFF | MOM |
| 2649LH | 2649LH/2 | ON OFF | ON |

* Function 4 : SP in DP case, see end of catalogue.

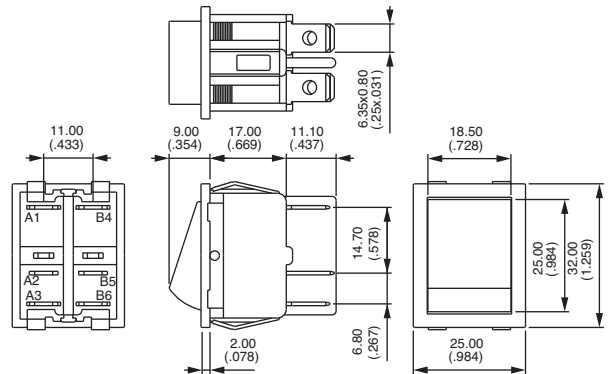

2600LP - with protection guard - single pole



Screw term. + clamp Solder lug/ quick-connect

| | III A2-A1 | II A2-A3 | I |
|--------|--------------|-------------|-----|
| 2631LP | 2631LP/2 | ON - | OFF |
| 2635LP | 2635LP/2 | MOM - | ON |
| 2636LP | 2636LP/2 | ON - | ON |
| 2637LP | 2637LP/2 | MOM OFF | MOM |
| 2638LP | 2638LP/2 | ON OFF | MOM |
| 2639LP | 2639LP/2 | ON OFF | ON |

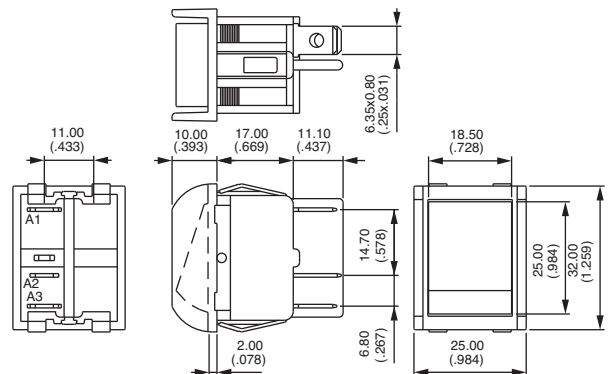



2600 series

Power rocker switches

2600LP - with protection guard - double pole



| | III | II | I |
|------------------------------|------------------|-------------|---|
| | A2-A1 | A2-A3 | |
| | B5-B4 | B5-B6 | |
| Screw term. + clamp | | | |
| Solder lug/ quick-connect | | | |
| 2641LP | 2641LP/2 | ON - OFF | |
| 2644LP* | 2644LP/2* | ON ON ON | |
| 2645LP | 2645LP/2 | MOM - ON | |
| 2646LP | 2646LP/2 | ON - ON | |
| 2647LP | 2647LP/2 | MOM OFF MOM | |
| 2648LP | 2648LP/2 | ON OFF MOM | |
| 2649LP | 2649LP/2 | ON OFF ON | |

* Function 4 : SP in DP case, see end of catalogue.

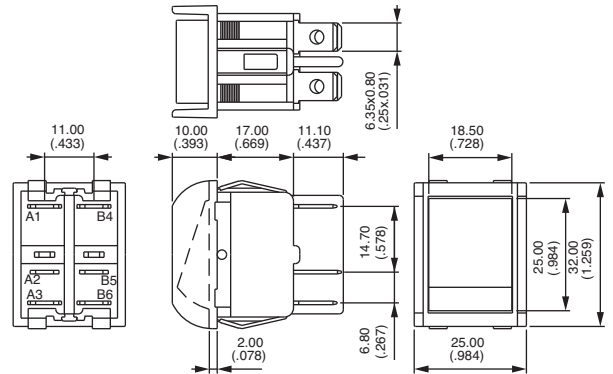

PANEL CUT-OUT

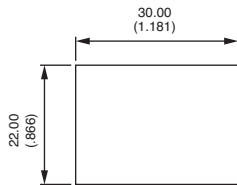

TERMINAL OPTION

Specify after LH or LP.

/3 Normalized quick-connect terminals 6,35 x 0,8 (.250 x .031)

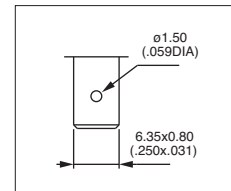

2600 series

Power rocker switches

OPTIONS



CONTACT MATERIALS

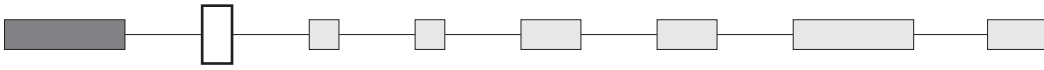

- A Silver
- C Copper, silver plated (available with functions 1, 6 and 9 only)

FRAME COLOURS

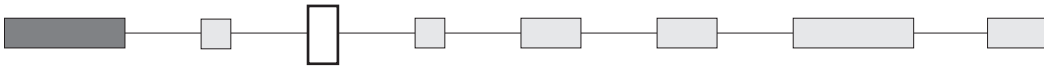

- 1 Blue
- 1/4 Dark blue
- 2 Black (standard)
- 4 Grey
- 7/1 White
- 8 Chrome plated
- B Light brown
- E Dark brown



This option has UL approval only.

ROCKER SHAPES

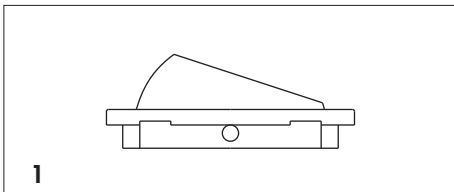
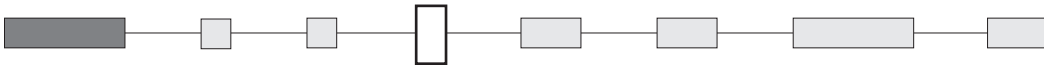

1

Plain

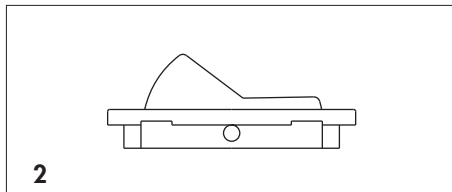

2

V-shaped

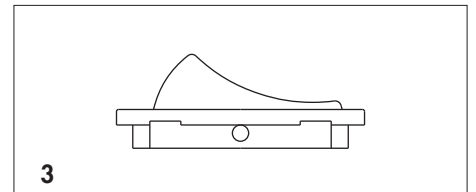

3

Concave



2600 series

Power rocker switches

ROCKER COLOURS

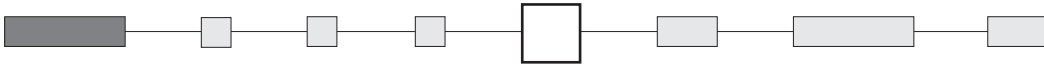

For illuminated switches

| | Without rocker | Blue* | Green* | Yellow | Red | White | Orange |
|---------------------|----------------|----------|----------|----------|----------|------------|----------|
| Plain rocker P/N | - | U881 | U883 | U885 | U886 | U887 | U889 |
| V-shaped rocker P/N | - | U861 | U863 | U865 | U866 | U867 | U869 |
| Concave rocker P/N | - | U871 | U873 | U875 | U876 | U877 | U879 |
| Colour code | 0 | 1 | 3 | 5 | 6 | 7/1 | 9 |

* With green or blue rocker, use fluorescent lamp only.

For non-illuminated switches or switches with illuminated window (•)

| | Without rocker | Light brown | Dark brown | Beige | Blue | Dark blue | Black | Green | Grey | Yellow | Red | White | Orange |
|---------------------|----------------|-------------|------------|-----------|-----------|-----------|------------|------------|-----------|-----------|------------|-----------|-----------|
| Plain rocker P/N | - | U1250B | U1250BF | U1250 | U1251 | U1251/4 | U1252 | U1253 | U1254 | U1255 | U1256 | U1257 | U1259 |
| V-shaped rocker P/N | - | U1270B | U1270BF | U1270 | U1271 | U1271/4 | U1272 | U1273 | U1274 | U1275 | U1276 | U1277 | U1279 |
| Concave rocker P/N | - | U1260B | U1260BF | U1260 | U1261 | U1261/4 | U1262 | U1263 | U1264 | U1265 | U1266 | U1267 | U1269 |
| Colour code | 0 | 02 | 04 | 03 | 10 | 14 | 20• | 30• | 40 | 50 | 60• | 70 | 90 |

Complete box with one of above colour codes.

To order rockers separately, use their P/N (U....) and complete box with code 0.

Rockers with illuminated windows (codes 20, 30, 60) : part numbers on request.

ROCKER MARKING

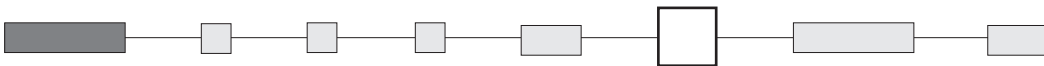

| MARKING \ COLOUR | MARKING | | | | | | | | | | | | |
|------------------|---------|----|--------|----|----|-----------|------|------|------|----|-------|--------|--|
| | - | ○ | A M | ○ | ○ | OFF ON | STOP | STOP | STOP | | ○ | △ ▽ | |
| Black | 00 | 01 | 02 | 06 | 07 | 08 | 03 | 04 | 05* | 40 | 43* | 46 | |
| Red | 00 | 11 | 12 | 16 | 17 | 18 | 13 | 14 | 15* | 41 | 44* | 47 | |
| White | 00 | 21 | 22 | 26 | 27 | 28 | 23 | 24 | 25* | 42 | 45* | 48 | |

* Not available on V-shaped rockers

Special markings and marking on rockers with illuminated window : consult factory.

2600 series

Power rocker switches

OPTIONS
● ● ●

LAMP

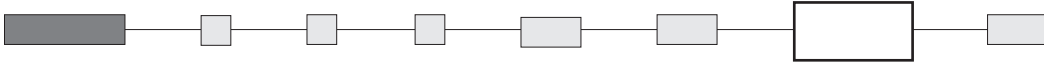

| | |
|--------|---|
| L0 | Non-illuminated switch |
| L6V | Filament lamp 6V |
| L12V | Filament lamp 12V |
| L24V | Filament lamp 24V |
| L110V | Neon lamp 110VAC |
| L110V1 | BLUE fluorescent lamp 110VAC |
| L110V3 | Green fluorescent lamp 110VAC |
| L220V | Neon lamp 220VAC |
| L220V1 | BLUE fluorescent lamp 220VAC |
| L220V3 | Green fluorescent lamp 220VAC |
| L380V | Neon lamp 380VAC |
| L380V1 | BLUE fluorescent lamp 380VAC |
| L380V3 | Green fluorescent lamp 380VAC |
| LI | EN61058-1 approved version without lamp (3 position switches) |

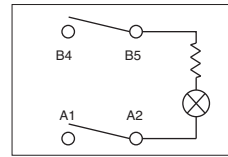

For illuminated models, the lamp is always connected between center terminals 2 and 5.



Lamps L380V, L380V1 and L380V3 are not UL/CSA approved.

ILLUMINATED WINDOW

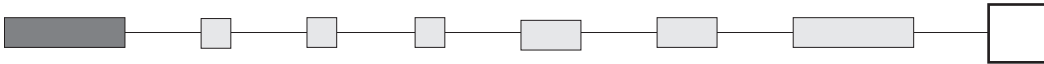

For black, green and red rockers only

/3 Green
/6 Red

With green, use fluorescent lamp only.
No marking available on illuminated windows.

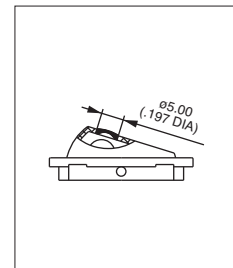

D