

### RASEY25-XL-N

Plummer block housing unit

Plummer block housing units RASEY, cast iron housing, radial insert ball bearing with grub screws in inner ring, R seals

X-life

#### Technical information

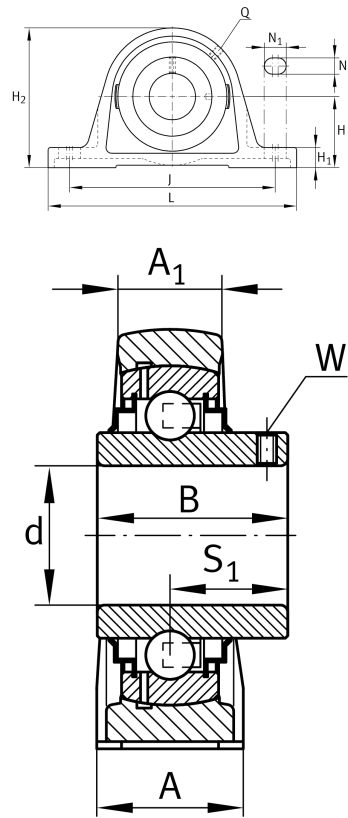

#### Your current product variant

Material	GG	Grey cast iron
Groove	N	Cast iron housing with undercut slot for end caps

#### Main Dimensions & Performance Data

d	25 mm	Bore diameter
L	130 mm	Length total
H 2	70 mm	Height
≈m	0.7 kg	Weight

#### Mounting dimensions

J	102.5 mm	Distance fixing bore
N	11 mm	Width (slot)
N 1	19 mm	Length (slot)



Dimensions

H	36.5 mm	Distance shaft axis
A	36 mm	Width (base)
A <sub>1</sub>	21 mm	Width (head)
H <sub>1</sub>	14.5 mm	Heigth (base)
B	34.1 mm	Width
S <sub>1</sub>	19.8 mm	Distance of raceway to locking collar
Q	M6	Connection thread for lubrication

Additional information

ASE05	Housing
GYE25-XL-KRR-B	Bearing designation
KASK05	Protecting cap

Temperature range

T <sub>min</sub>	-20 °C	Operating temperature min.
T <sub>max</sub>	120 °C	Operating temperature max.