

Plexo™ Switches and two-ways

Cat. Nos.: 0 695 11/12/13/15/16/19/21/24/25/26/30/31/32/38
 0 696 11/12/13/15/19/25/26/27/29
 0 697 10/11/12/13/14/15/16/17/18/51/52/53/54/55/56/58
 0 698 11/12/17/51/52/55/56
 0 707 11/26/27

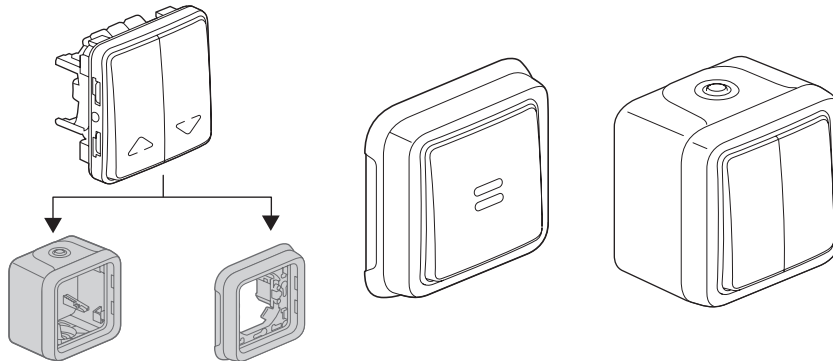

1. USE

Weatherproof wiring devices system intended for residential and professional technical premises (garages, cellars, car parks, workshops and industrial kitchens, etc.) as well as outdoor environments (patios, terraces, gardens, camping sites, etc.).
 Lighting control mechanisms with or without indicating (lights) or signalling (marking) components.

2. RANGE

2 versions : grey and white		References
Configurable		0 695 11/12/13/15/16/19/21/25/26/30/31/32/38 0 696 11/12/13/15/19/25/26/27/29 0 707 11/26/27
Surface-mounting complete		0 697 10/11/12/13/14/15/16/17/18 0 697 51/52/53/54/55/56/58
Flush-mounting complete		0 698 11/12/17 0 698 51/52/55/56

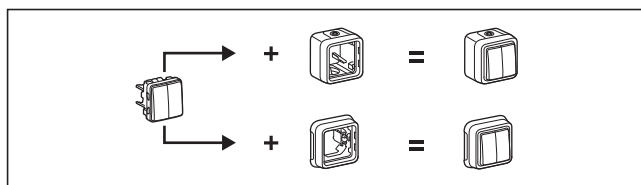

3. PREPARATION

3.1 Surface-mounting

- By screwing the base box onto the support using 2 screws Ø 3-4 mm max.

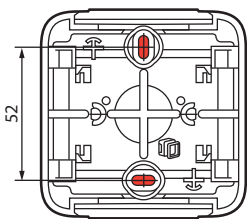

3. PREPARATION (continued)

3.2 Flush-mounting

- Frame dismantling

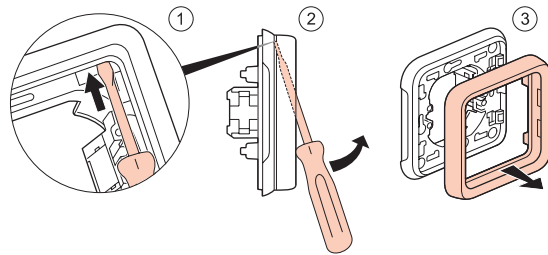

- By screwing onto a flush-mounting box

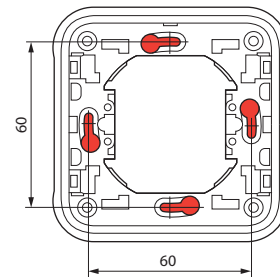

- By claws onto a flush-mounting box

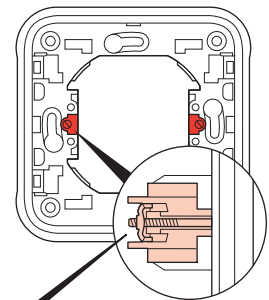

Possibility to place claws:

Cat. No. 0 849 00 or Cat. No. 0 849 01 (long claw)

- By face plate using 4 screws Ø 4 mm

Piercing of support material for diameter 60-70 mm using cylinder saw or punch.

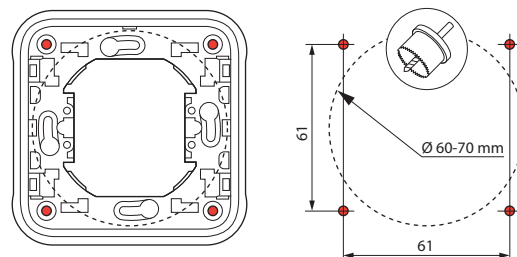

4. OVERALL DIMENSIONS (mm)

■ Configurable

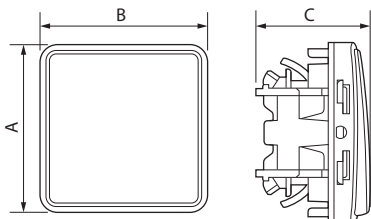

■ Surface-mounting

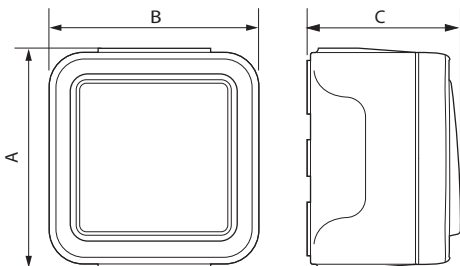

■ Flush-mounting

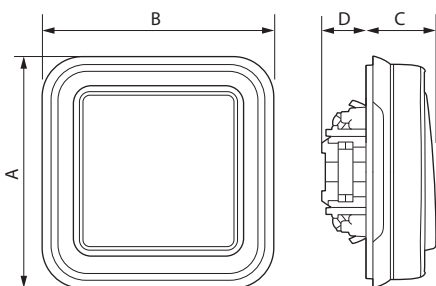

	A	B	C	D
Configurable	64	64	40	-
Surface-mounting	84	80	57	-
Flush-mounting	86	86	23	19

5. CONNECTION

■ Connection to conductors

• 1 break

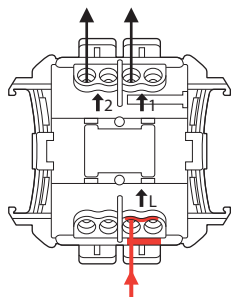

• 2 breaks

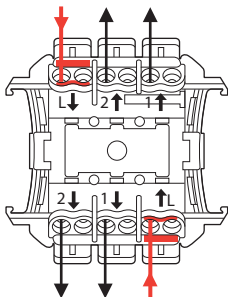

5. CONNECTION (continued)

■ Connection to conductors

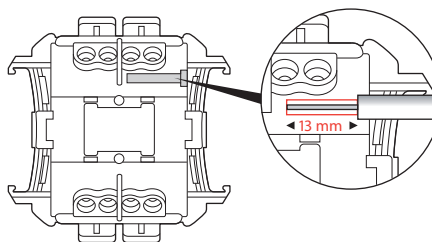

Type of terminals: automatic
Terminal capacity: 1.5 mm² - 2.5 mm² (1 or 2 conductors)
Stripping length: 13 mm

6. TECHNICAL CHARACTERISTICS

■ 6.1 Protection index

Protection against solid bodies and liquids: IP 55
Protection against impact: IK 07

■ 6.2 Material characteristics

Box, support: PP reinforced
Front plate, rocker: ABS
Entry gland, cover plate: PP + SEBS
Mechanism: PC
UV resistant
Resistance to salt spray: 7 days (168 h)
Self-extinguishing:
+ 850°C / 30 s for insulating components holding in place live parts.
+ 650°C / 30 s for the other insulating components.

■ 6.3 Electrical characteristics

Current: 10 AX
6 AX for Cat. Nos. 0 695 15 - 0 696 15
Voltage: 250 V~
Frequency: 50 Hz

■ 6.4 Climatic characteristics

Storage temperature: - 25° C to + 70° C
Use temperature: - 20° C à + 40° C

7. CLEANING

Surface cleaning with dry cloth or cloth dipped in soapy water.
Do not use acetone, tar remover or trichloroethylene.

Caution: A test should be carried out before using any specific cleaners.

9. STANDARDS AND APPROVALS

Compliance with standards of installation and manufacturing.
Refer to e. catalogue.