

Flat, lightweight and lubrication-free

Lubrication-free linear modules – drylin® SLT

The low profile, the lateral lead screw arrangement and a striking design, are just some of the reasons why the drylin® SLT linear module was honoured with the 2014 IF Award. Technically, the system impresses with ball bearing mounted trapezoidal or high helix thread lead screws for motorised or manual operation. The basis of the SLT series is the drylin® T miniature guide in sizes 12 and 15.

- Low-profile structure through lateral lead screw arrangement
- Lubrication-free, corrosion-resistant, lightweight
- Variable pitch
- Adjustable drylin® T miniature carriage
- Lead screw arrangement can be selected either left or right

Typical application areas

- Format adjustments
- Laboratory and medical technology
- Optical equipment



Quick delivery

Detailed information about delivery time online.



max. +60°C
Min. -40°C



Stroke lengths 300mm-600mm

More dimensions upon request.



Product finder

► www.igus.co.uk/slt-productfinder



In accordance with EU Directive 2011/65/EU (RoHS 2)
Restriction (of the use of certain) hazardous substances

Shaft end supports/
carriages made of
anodised aluminium

Ball bearing supported
lead screws

Lead screw arrangement
left or right of the carriage

Self-locking trapezoidal
thread or fast adjustment
with high helix thread

drylin® T miniature
carriage with individual
clearance adjustment

Lead screws of steel
or stainless steel

Hard-anodised drylin® T
miniature guide rail

Hand wheel, position
indicator and lead screw
clamp as accessories
► Page 1419



Can be configured
as ready-to-connect
linear axis with
motor and initiators

► www.igus.co.uk/drylinE



2013

With ball bearing supported lead screw



Order key

SLT-BB-0412-ER-S0015RG-xxx

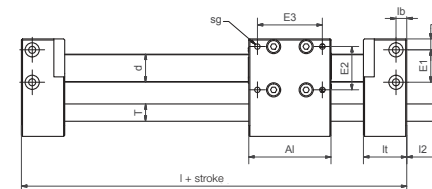
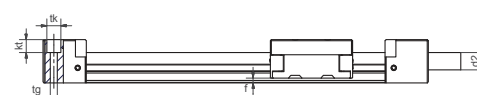
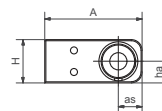
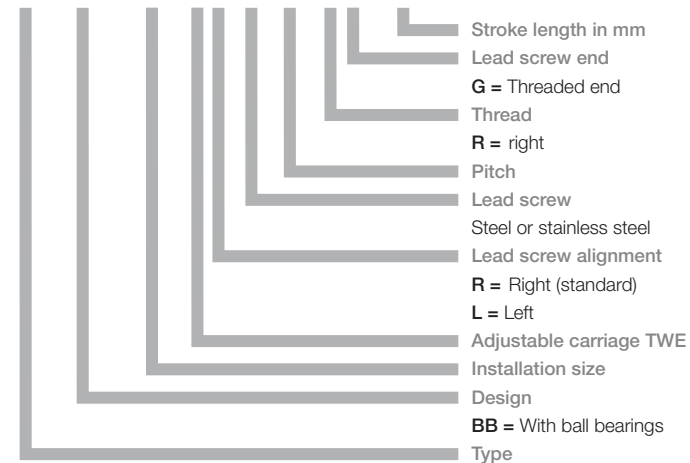

Lead screw alignment left

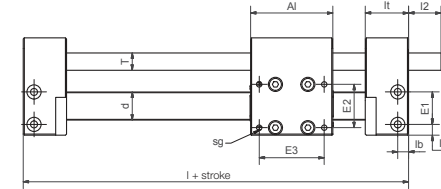

Lead screw alignment right

Technical data and dimensions [mm]

Part No.	Pitch	Max. stroke length	Weight		Max. static load capacity		Max. rpm	Max. speed
			[kg]	additional (per 100mm) [kg]	axial [N]	radial [N]		
SLT-BB-0412	Tr08x1.5	300	0.15	0.06	100	200	1,000	1.5
	Sg08x15	300	0.15	0.06	25	100	600	9.0
SLT-BB-0415	Tr12x3	600	0.40	0.12	200	400	1,000	4.5
	Sg12x25	600	0.40	0.12	50	200	300	7.5

Part No.	A	Al	H	E1	E2	E3	I	I2	d2	ha	sg	tk	kt	tg	f	lb	lt	d	T	as
SLT-BB-0412	45	38	20	15	20	30	78	15	-	10	M3-7	6.5	6	M4	2.2	5	20	13	Tr08x1.5	11
SLT-BB-0415	58	45	30	19	25	35	89	17	12	15	M3-13	8	4.5	M5-15	2.8	6.5	22	17	Tr12x3	16

Also see econ chapter ► Page 1365