

Features

- Maximum operating pressure is 35 bar.
- Operating temperature range -20°C to +100°C.
- Material: Brass / Steel with Nickel Plated Finish
- Single Shut Off (One side is with valve)
- Flow 660 l/min
- British Profile DN5.5
- Compatible with:
TST SWING COUPLING P
PCL 60
PARKER - RECTUS 19

RS PRO Pneumatic Quick Connect Coupling

RS Stock No.: 0325495



RS PRO is the own brand of RS. The RS PRO Seal of Approval is your assurance of professional quality, a guarantee that every part is rigorously tested, inspected, and audited against demanding standards. Making RS PRO the Smart Choice for our customers.

Product Description

RS PRO Series 19 Quick Connect Couplings

Pneumatic quick-connect coupling connectors are found across industry in pneumatic systems as diverse as robotic assembly lines and other equipment.

- Maximum operating pressure is 35 bar.
- Operating temperature range -20°C to +100°C.
- Material: Brass / Steel with Nickel Plated Finish
- Single Shut Off (One side is with valve)
- Flow 660 l/min
- British Profile DN5.5
- Compatible with:
TST SWING COUPLING P
PCL 60
PARKER - RECTUS 19

Specifications

Manufacturer Series	019
Coupling Type	Quick Connect Coupling Plug
Connection Standard	DN 5.5 British Profile
Connection Standard Compatible With	TST SWING COUPLING P; PCL 60; PARKER-RECTUS 19
Minimum Operating Temperature	-20°C
Maximum Operating Temperature	+100°C
Maximum Operating Pressure	35bar
Flow	660 l/min
Flow Direction & Sealing	Through Type Coupling
Material	Steel
Finish	Nickel Plated
Connection Type	Threaded
Thread Size	3/8 in
Thread Standard	G
Thread Gender	Female
Coupling Gender	Male
Threaded Connection	G 3/8 in Female
Seal material	N/A
Hose Barb Connection	N/A

Specifications

Plug Profile Serie 019

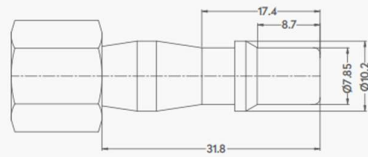

Dimensions (mm)

SW	L	ØD
19	47	-

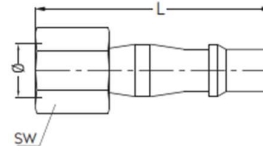

Materials

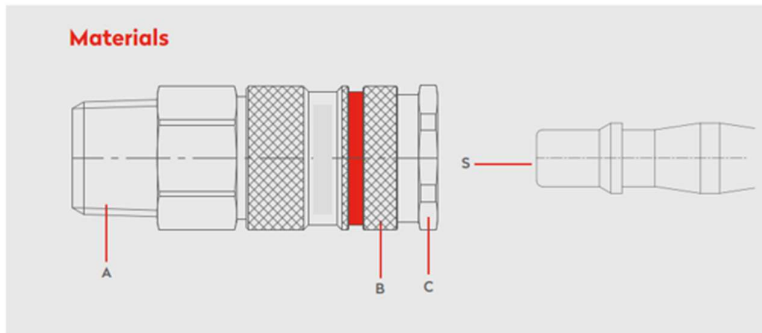

Material Code

A = Steel Nickel Plated
B = Steel Nickel Plated
C = Brass Nickel Plated
S = Steel Nickel Plated

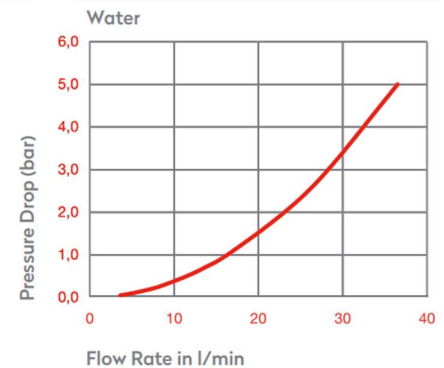
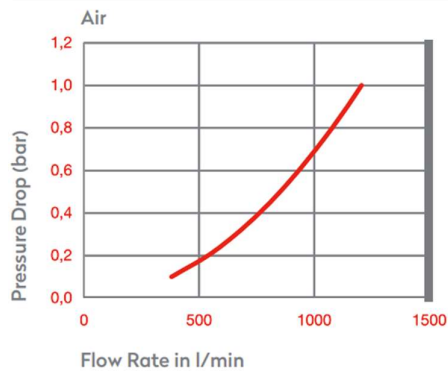

Series 19 Quick Connect Couplings



0 - 35 bar
(0-508 PSI)



-20° to +100°C (NBR)
-4° to +212°F

**Shut Off
Type**

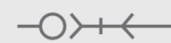

OM 300 - 00750
OM 100 - 01000
OM 250 - 00500

FLOW

660 lt/min

DN

5.5 mm