

AS SHOWN 2461726-1

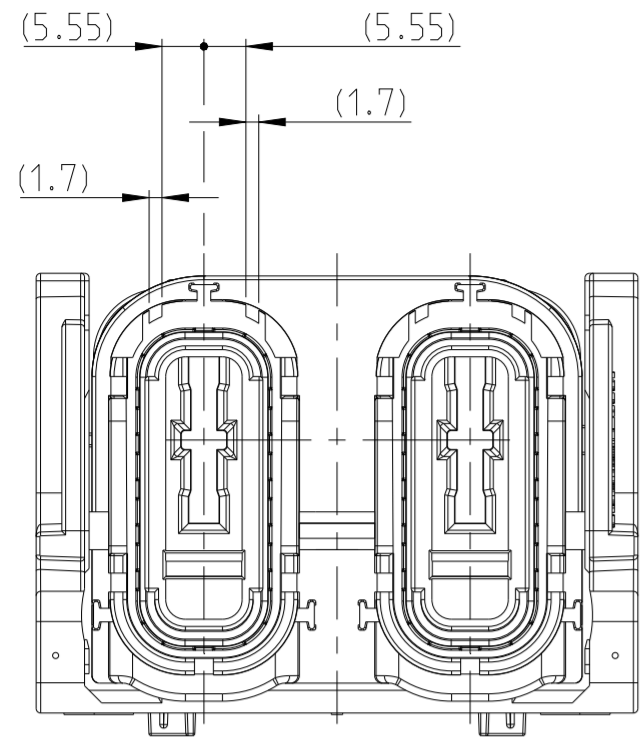

AS SHOWN 2461726-1  
CODING A  
Kodierung A

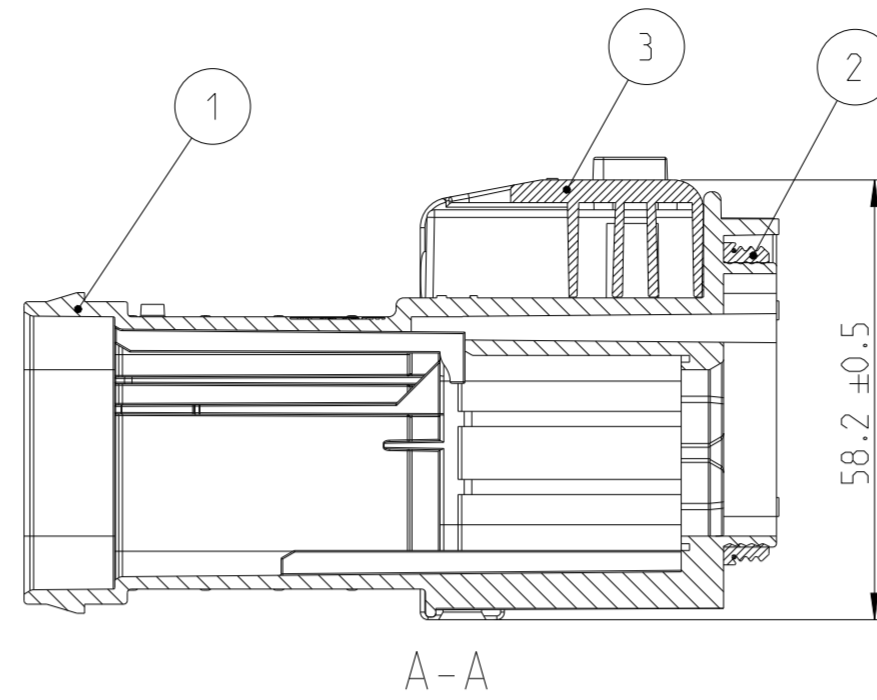
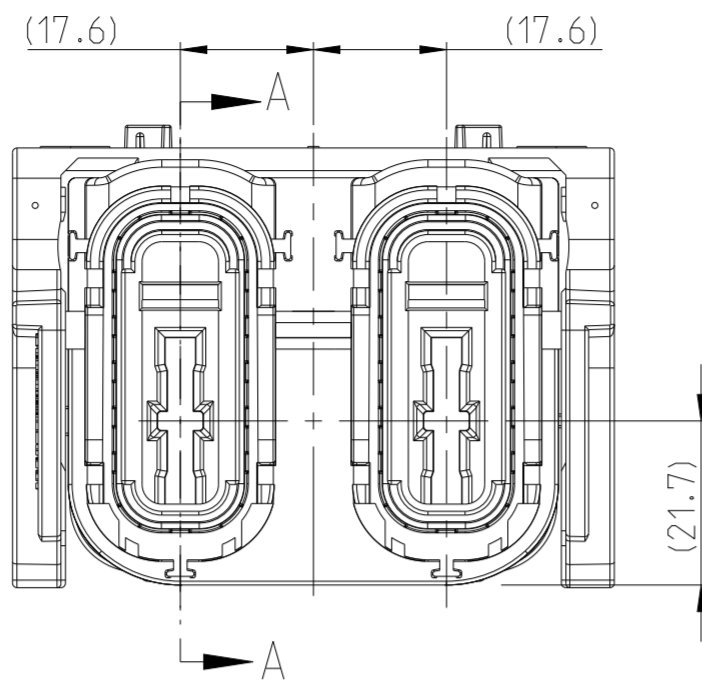

REVISIONS					
P	LTR	DESCRIPTION	DATE	DWN	APVD
B1		E-24-220694: NOTE ADDED	13SEP2024	MF	PW
C		E-25-231556: PRODUCT IMPROVEMENT	08JAN2025	MF	PW
D		E-25-238065: MATERIAL CHANGE	19FEB2025	MF	PW
D1		ECR-25-264499: Note Change	04DEC2025	MF	PW

NOTES  
Bemerkungen

- 1 TE-CONNECTIVITY ORDER-NUMBER  
TE-Connectivity Bestellnummer
- 2 PRODUCTION DATE  
Produktionsdatum
- 3 TE-LOGO  
TE-Logo
- 4 MATERIAL MARKING  
Materialkennzeichnung
- 5 CONTACT CAVITY NUMBERING  
Kammernummerierung
- 6 DIFFERENT CODINGS  
Unterschiedliche Kodierungen
- 7 SUITABLE TO COUNTERPART PN 2461733  
Passend zu Gegenstueck PN 2461733
- 8 DELIVERY CONDITION IN CLOSED POSITION  
Lieferzustand in geschlossenem Zustand
- 9 MALFUNCTION CAUSED BY LACQUER IS NOT COVERED BY TE WARRANTY.  
Funktionsbeeinträchtigung durch Lackieren liegt nicht im Einfluss und Gewährleistungsumfang von TE
- 10 PACKED INTERLAYERED IN CORRUGATED SHIPPING BOX  
Verpackt in Lagen angeordnet im Versandkarton
- 11 NECESSARY ACCESSORIES BASED ON CABLE SIZE SEE FOLLOWING CUSTOMER DRAWINGS:  
Notwendige Accessoires abhängig von der Kabelgröße, siehe folgende Kundenzeichnungen

D1 TERMINAL POSITION ASSURANCE 2461739 and 2461740  
Kontaktlagensicherung 2461739 and 2461740

CABLE SEAL 2461743  
Kabeldichtung 2461743

COVER 2461742  
Schutzkappe 2461742

STRAIN RELIEF 2461741  
Zugentlastung 2461741

DELIVERY CONDITION: 8  
Lieferzustand

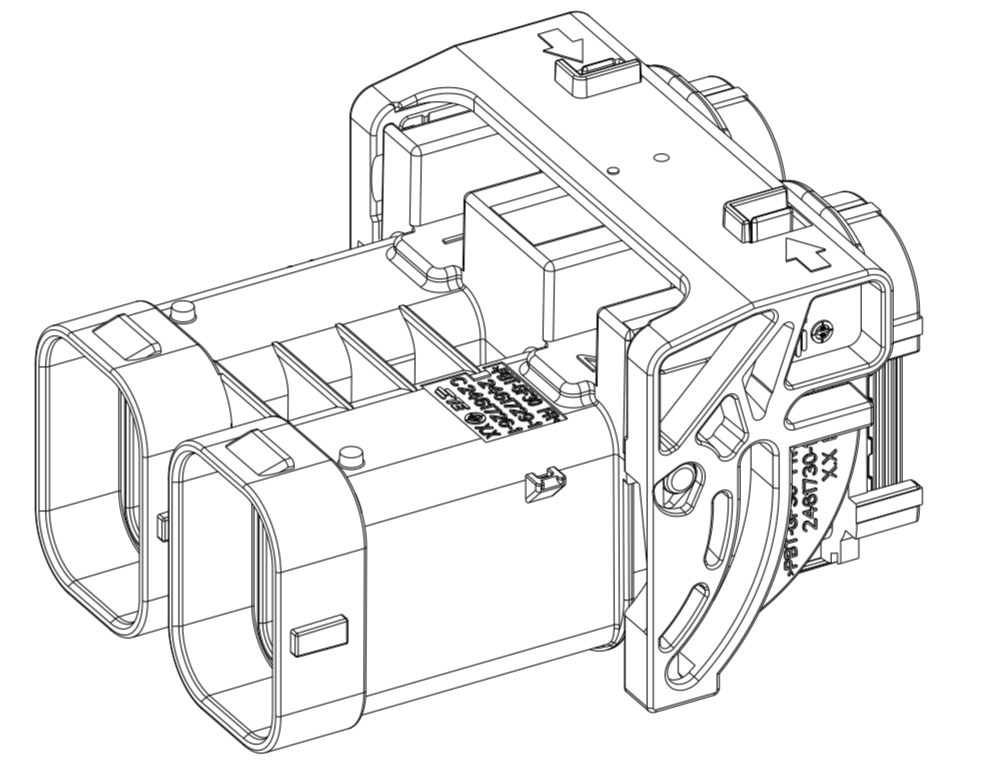

LEVER IN LOCKED POSITION  
Hebel in Verriegelungsstell

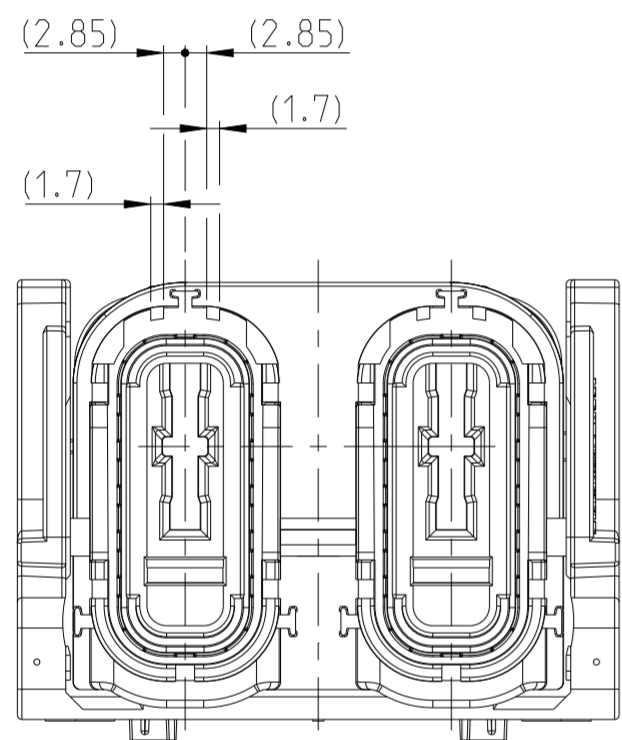

AS SHOWN 2461726-2  
CODING B  
Kodierung B

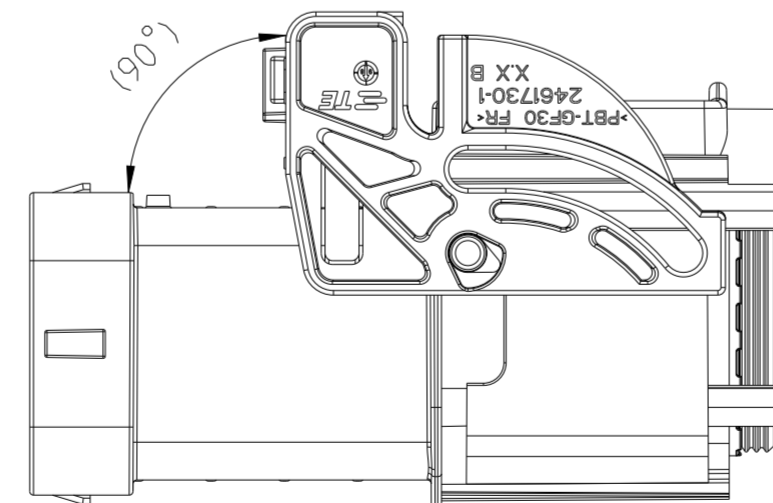
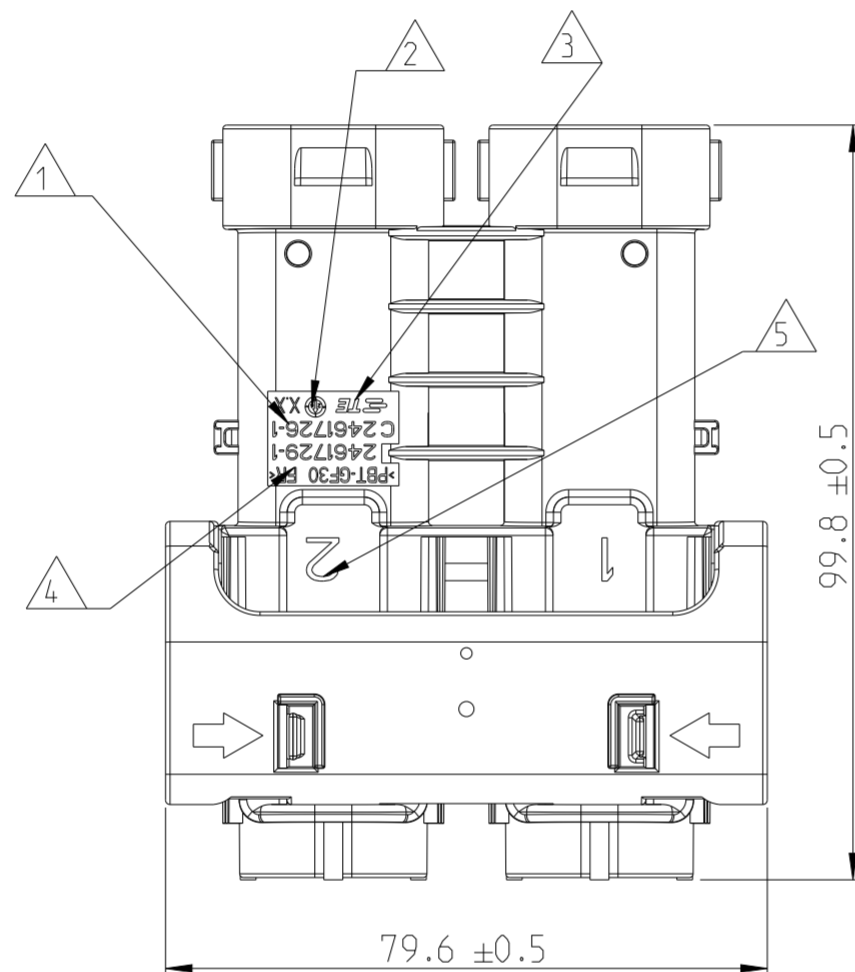

PRE-LOCKING POSITION  
Vorraststellung

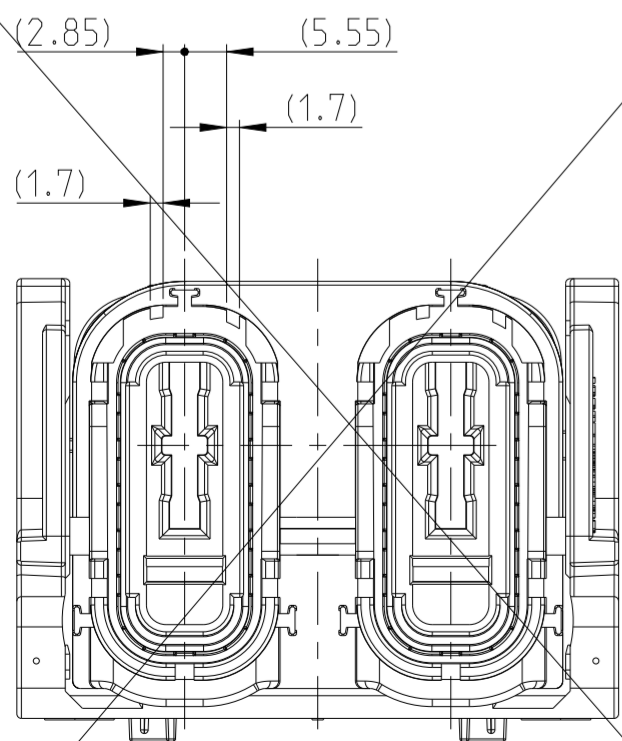

AS SHOWN 2461726-3  
CODING C  
Kodierung C

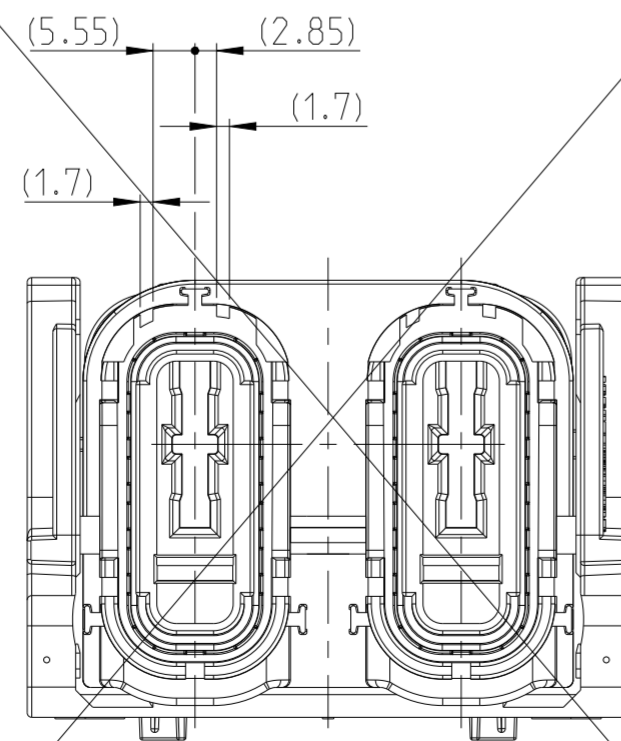

AS SHOWN 2461726-4  
CODING D  
Kodierung D

DIMENSION AND TOLERANCES ACCORDING TO:  
Bemaßungen und Toleranzen gemäß:

DIN ISO 20457  
DIN EN ISO 8015 (A0) - DIN EN ISO 291  
DIN EN ISO 14405-1/-2/-3

QTY	REQD	PER ASSY	DESCRIPTION	MATERIAL	COLOUR	ITEM NO
1	1	1	LEVER,2POS,PCON21,REC HSG,180° Hebel,2pol.,PCON21,Buchsengeh,180°	PBT-GF30 FR	RED Rot	3
2	2	2	PERIPHERAL SEAL,PCON21 Radialdichtung,PCN21	SILICON	YELLOW Gelb	2
1	-	-	2POS,PCON21,REC HSG ASSY,SLD,COD D,180° 2pol.,PCON21,Buchsengeh Assy,ged,COD D,180°	PBT-GF30 FR		1
-	1	-	2POS,PCON21,REC HSG ASSY,SLD,COD C,180° 2pol.,PCON21,Buchsengeh Assy,ged,COD C,180°	PBT-GF30 FR		1
-	-	1	2POS,PCON21,REC HSG ASSY,SLD,COD B,180° 2pol.,PCON21,Buchsengeh Assy,ged,COD B,180°	PBT-GF30 FR	EMERALD GREEN Smaragdgruen	1
-	-	1	2POS,PCON21,REC HSG ASSY,SLD,COD A,180° 2pol.,PCON21,Buchsengeh Assy,ged,COD A,180°	PBT-GF30 FR	BLACK Schwarz	1
0-4	0-3	0-2	0-1	DESCRIPTION		
REVISION OF EACH ASSY NO (WHEN BLANK, USE DWG REVISION)						
143.7	143.7	143.7	143.7	WEIGHT OF EACH ASSY NO [g]		
PARTS LIST						

THIS DRAWING IS A CONTROLLED DOCUMENT.

DIMENSIONS: mm	TOLERANCES UNLESS OTHERWISE SPECIFIED: 0 PLC ± 1 PLC ±0.1 2 PLC ±0.01 3 PLC ±0.001 4 PLC ±0.0001 ANGLES ±	FINISH -
MATERIAL SEE TABLE siehe Tabelle		

DWN M. Floesser 14DEC2023	CHK P. Wrobel 14DEC2023	APVD F. Eltrop 15DEC2023	NAME 2POS,PCON21,REC HSG ASSY,SLD,180DEG 2pol.,PCON21,Buchsengeh. Assy,ged.180grad
108-94935	114-97587	114-97587	RESTRICTED TO -
114-97587	114-97587	114-97587	RESTRICTED TO -
CUSTOMER DRAWING	SCALE 1:1	SHEET 1 OF 1	REV D1

