

E37411

THERMOWELL, D6/WELD-IN/G1/2 conical/L=50

Accessories

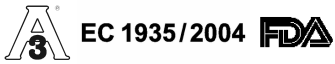
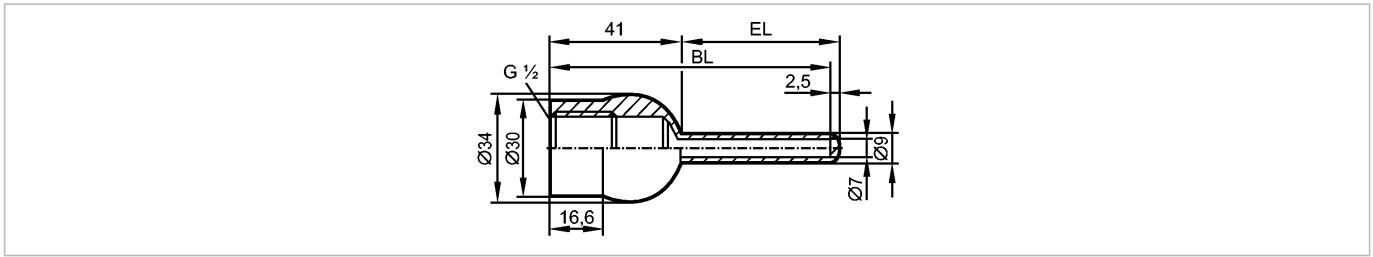

Product characteristics

Welding thermowell for temperature sensors

Ø 6 mm

Environment

Pressure rating [bar] 300

Mechanical data

Process connection ball Ø 34 mm

for units with process connection G1/2 with sealing cone

Installation length EL [mm] 49

Bore Length BL [mm] 87

Design for temperature sensors with installation length EL = 50 mm

Housing materials stainless steel 316L / 1.4404

Surface characteristics Ra / Rz of the wetted part(s) ≤ 0.6 / -

Weight [kg] 0.16

Remarks

Pack quantity [piece] 1