

214-0734 = ROX1S 1R0 5%  
214-0740 = ROX1S 1R2 5%  
214-0756 = ROX1S 1R5 5%  
214-0762 = ROX1S 1R8 5%  
214-0778 = ROX1S 2R2 5%  
214-0784 = ROX1S 2R7 5%  
214-0807 = ROX1S 3R3 5%  
214-0813 = ROX1S 3R9 5%  
214-0829 = ROX1S 4R7 5%  
214-0835 = ROX1S 5R6 5%  
214-0841 = ROX1S 6R8 5%  
214-0863 = ROX1S 8R2 5%  
214-0879 = ROX1S 10R 5%  
214-0885 = ROX1S 12R 5%  
214-0891 = ROX1S 15R 5%  
214-0908 = ROX1S 18R 5%  
214-0920 = ROX1S 22R 5%  
214-0936 = ROX1S 27R 5%  
214-0942 = ROX1S 33R 5%  
214-0958 = ROX1S 39R 5%  
214-0964 = ROX1SJ47R  
214-0970 = ROX1SJ56R  
214-0986 = ROX1SJ68R  
214-0992 = ROX1SJ82R  
214-1002 = ROX1SJ100R  
214-1018 = ROX1SJ120R  
214-1024 = ROX1SJ150R  
214-1030 = ROX1SJ180R  
214-1046 = ROX1SJ220R  
214-1052 = ROX1SJ270R  
214-1068 = ROX1SJ330R  
214-1074 = ROX1SJ390R  
214-1096 = ROX1SJ470R  
214-1103 = ROX1SJ560R  
214-1119 = ROX1SJ680R  
214-1125 = ROX1SJ820R  
214-1131 = ROX1SJ1K0  
214-1153 = ROX1SJ1K2  
214-1169 = ROX1SJ1K5  
214-1175 = ROX1SJ1K8  
214-1181 = ROX1SJ2K2  
214-1197 = ROX1SJ2K7  
214-1210 = ROX1SJ3K3  
214-1226 = ROX1SJ3K9  
214-1232 = ROX1SJ4K7  
214-1248 = ROX1SJ5K6  
214-1254 = ROX1SJ6K8  
214-1260 = ROX1SJ8K2  
214-1276 = ROX1SJ10K  
214-1282 = ROX1SJ12K  
214-1298 = ROX1SJ15K  
214-1305 = ROX1SJ18K  
214-1311 = ROX1SJ22K  
214-1327 = ROX1SJ27K  
214-1333 = ROX1SJ33K  
214-1349 = ROX1SJ39K  
214-1355 = ROX1SJ47K  
214-1377 = ROX1SJ56K  
214-1383 = ROX1SJ68K  
214-1399 = ROX1SJ82K  
214-1406 = ROX1SJ100K  
214-1412 = ROX1SJ120K  
214-1434 = ROX1SJ150K  
214-1440 = ROX1SJ180K  
214-1456 = ROX1SJ220K  
214-1462 = ROX1SJ270K  
214-1478 = ROX1SJ330K  
214-1484 = ROX1SJ390K  
214-1490 = ROX1SJ470K  
214-1507 = ROX1SJ560K  
214-1513 = ROX1SJ680K  
214-1529 = ROX1SJ820K  
214-1535 = ROX1SJ1M0  
214-1541 = ROX2SJ1R0  
214-1557 = ROX2SJ1R2  
214-1563 = ROX2SJ1R5  
214-1579 = ROX2SJ1R8  
214-1591 = ROX2SJ2R2  
214-1608 = ROX2SJ2R7  
214-1614 = ROX2SJ3R3  
214-1620 = ROX2SJ3R9  
214-1636 = ROX2SJ4R7  
214-1658 = ROX2SJ5R6  
214-1664 = ROX2SJ6R8  
214-1670 = ROX2SJ8R2  
214-1686 = ROX2SJ10R  
214-1692 = ROX2SJ12R  
214-1715 = ROX2SJ15R  
214-1721 = ROX2SJ18R  
214-1737 = ROX2SJ22R  
214-1743 = ROX2SJ27R  
214-1759 = ROX2SJ33R  
214-1765 = ROX2SJ39R  
214-1771 = ROX2SJ47R  
214-1787 = ROX2SJ56R  
214-1793 = ROX2SJ68R  
214-1800 = ROX2SJ82R  
214-1816 = ROX2SJ100R  
214-1822 = ROX2SJ120R  
214-1838 = ROX2SJ150R  
214-1844 = ROX2SJ180R  
214-1850 = ROX2SJ220R  
214-1872 = ROX2SJ270R  
214-1888 = ROX2SJ330R  
214-1894 = ROX2SJ390R  
214-1901 = ROX2SJ470R  
214-1917 = ROX2SJ560R  
214-1939 = ROX2SJ680R  
214-1945 = ROX2SJ820R  
214-1951 = ROX2SJ1K0  
214-1967 = ROX2SJ1K2  
214-1973 = ROX2SJ1K5  
214-1989 = ROX2SJ1K8  
214-1995 = ROX2SJ2K2  
214-2005 = ROX2SJ2K7  
214-2011 = ROX2SJ3K3  
214-2027 = ROX2SJ3K9  
214-2033 = ROX2SJ4K7  
214-2049 = ROX2SJ5K6  
214-2055 = ROX2SJ6K8  
214-2061 = ROX2SJ8K2  
214-2077 = ROX2SJ10K  
214-2083 = ROX2SJ12K  
214-2106 = ROX2SJ15K  
214-2112 = ROX2SJ18K  
214-2128 = ROX2SJ22K  
214-2134 = ROX2SJ27K  
214-2140 = ROX2SJ33K  
214-2162 = ROX2SJ39K  
214-2178 = ROX2SJ47K  
214-2184 = ROX2SJ56K  
214-2190 = ROX2SJ68K  
214-2207 = ROX2SJ82K  
214-2229 = ROX2SJ100K  
214-2235 = ROX2SJ120K  
214-2241 = ROX2SJ150K  
214-2257 = ROX2SJ180K  
214-2263 = ROX2SJ220K  
214-2279 = ROX2SJ270K  
214-2285 = ROX2SJ330K  
214-2291 = ROX2SJ390K  
214-2308 = ROX2SJ470K  
214-2314 = ROX2SJ560K  
214-2320 = ROX2SJ680K  
214-2336 = ROX2SJ820K  
214-2342 = ROX2SJ1M0  
214-2768 = ROX2SJ1K0  
214-2358 = ROX3SJ1R0  
214-2364 = ROX3SJ1R2  
214-2386 = ROX3SJ1R5  
214-2392 = ROX3SJ1R8  
214-2409 = ROX3SJ2R2  
214-2415 = ROX3SJ2R7  
214-2421 = ROX3SJ3R3  
214-2443 = ROX3SJ3R9  
214-2459 = ROX3SJ4R7  
214-2465 = ROX3SJ5R6  
214-2471 = ROX3SJ6R8  
214-2487 = ROX3SJ8R2  
214-2493 = ROX3SJ10R  
214-2500 = ROX3SJ12R  
214-2516 = ROX3SJ15R  
214-2522 = ROX3SJ18R  
214-2538 = ROX3SJ22R  
214-2544 = ROX3SJ27R  
214-2550 = ROX3SJ33R  
214-2566 = ROX3SJ39R  
214-2572 = ROX3SJ47R  
214-2588 = ROX3SJ56R  
214-2601 = ROX3SJ68R  
214-2617 = ROX3SJ82R  
214-2623 = ROX3SJ100R  
214-2639 = ROX3SJ120R  
214-2645 = ROX3SJ150R  
214-2667 = ROX3SJ180R  
214-2673 = ROX3SJ220R  
214-2689 = ROX3SJ270R  
214-2695 = ROX3SJ330R  
214-2702 = ROX3SJ390R  
214-2724 = ROX3SJ470R  
214-2730 = ROX3SJ560R  
214-2746 = ROX3SJ680R  
214-2752 = ROX3SJ820R  
214-2774 = ROX3SJ1K2  
214-2780 = ROX3SJ1K5  
214-2796 = ROX3SJ1K8  
214-2803 = ROX3SJ2K2  
214-2819 = ROX3SJ2K7  
214-2825 = ROX3SJ3K3  
214-2831 = ROX3SJ3K9  
214-2847 = ROX3SJ4K7  
214-2853 = ROX3SJ5K6  
214-2869 = ROX3SJ6K8  
214-2881 = ROX3SJ8K2  
214-2897 = ROX3SJ10K  
214-2904 = ROX3SJ12K  
214-2910 = ROX3SJ15K  
214-2926 = ROX3SJ18K  
214-2948 = ROX3SJ22K  
214-2954 = ROX3SJ27K  
214-2960 = ROX3SJ33K  
214-2976 = ROX3SJ39K  
214-2982 = ROX3SJ47K  
214-2998 = ROX3SJ56K  
214-3014 = ROX3SJ68K  
214-3020 = ROX3SJ82K  
214-3036 = ROX3SJ100K  
214-3042 = ROX3SJ120K  
214-3058 = ROX3SJ150K  
214-3064 = ROX3SJ180K  
214-3070 = ROX3SJ220K  
214-3086 = ROX3SJ270K  
214-3092 = ROX3SJ330K  
214-3109 = ROX3SJ390K  
214-3115 = ROX3SJ470K  
214-3121 = ROX3SJ560K  
214-3137 = ROX3SJ680K  
214-3143 = ROX3SJ820K  
214-3159 = ROX3SJ1M0



Series **ROX**

**FLAME PROOF POWER METAL OXIDE FILM RESISTORS**

**OUTLINE DIAGRAM**

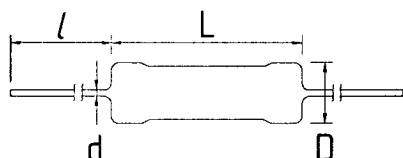

Dimension 'l' refers to loose packaged product only.

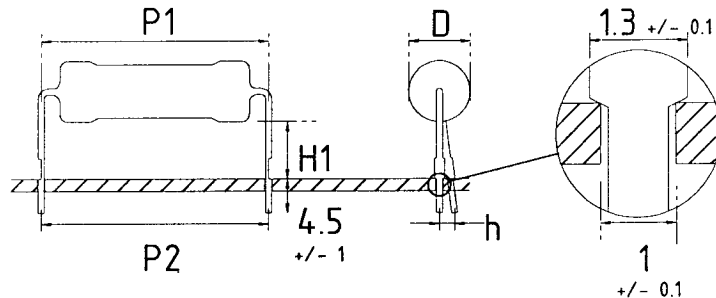

**DIMENSIONS**

**Standard Range Leaded**

Style	L ± 1	D	d nom	l min
ROX05	9	3 ± 0.5	0.7	25
ROX1	11	4 ± 0.5	0.7	25
ROX2	16	6 ± 1	0.8	35

**Standard Range Pre-formed**

P1 ± 0.5	P2 ± 2	H1	h max
12.5	12.5	7.5 ± 1.5	2.0
15	15	7.5 ± 1.5	2.0
20	20	7.5 ± 2.0	3.0

**"S" Range Leaded**

Style	L ± 1	D ± 0.5	d nom	l min
ROX05S	6.5	2.3	0.6	25
ROX1SS	6.5	2.3	0.6	25
ROX1S	9	3	0.7	25
ROX2S	11	4	0.8	25
ROX3S	15	5.5	0.8	35
ROX5S	25 ± 2	8.5 ± 1	0.8	35

**"S" Range Pre-formed**

P1 ± 0.5	P2 ± 2	H1	h max
10	10	7.5 ± 1.5	2.0
10	10	7.5 ± 1.5	2.0
12.5	12.5	7.5 ± 0.5	2.0
15	15	7.5 ± 1.5	2.9
20	20	7.5 ± 2.0	3.0
30	30	7.5 ± 2.0	3.0

**RATINGS AND CHARACTERISTICS**

	Units	ROX05	ROX1	ROX2	ROX05S	ROX1SS	ROX1S	ROX2S	ROX3S	ROX5S
Rated power @ 70 °C	Watts	0.5	1	2	0.5	1	1	2	3	5
Resistance range	ohms	0.1 - 75k	0.1 - 100	0.1 - 120	0.1 - 22k	1 - 200R	0.1 - 68k	0.1 - 68k	0.1 - 100	0.1 - 100
Tolerance	%	2% 5%								
Selection Series		E24								
Limiting Element Voltage	Volts	250	350	350	250	350	350	350	350	500
Maximum Overload voltage	Volts	400	600	600	400	400	600	600	600	800
Max Intermittent overload voltage	Volts	500	750	750	500	500	750	750	750	1500
Temperature coefficient	ppm/°C	± 300								
Operating Temperature Range	°C	-55 to +235								
Climatic category		55/235/56								
Dielectric strength	Volts	250	350	350	250	350	350	350	350	500
Insulation resistance	M ohms	1,000 Mohms								

**DERATING CURVE**  
ROX05 - ROX5S

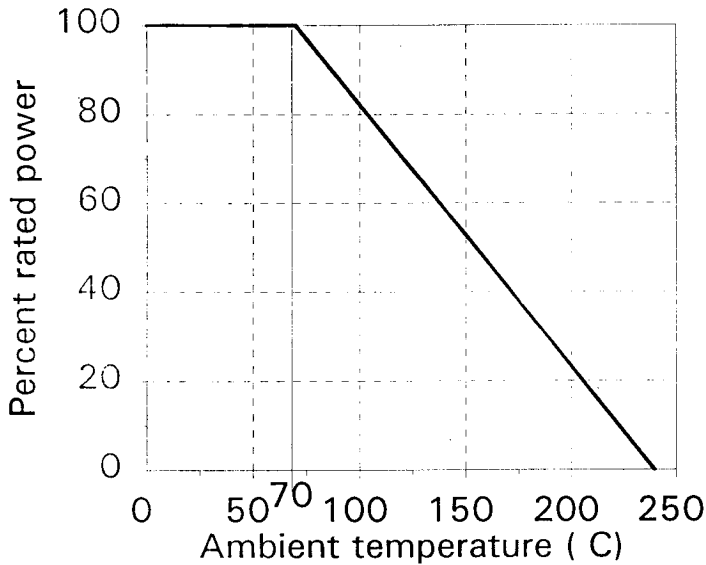

**TECHNOLOGY AND SUGGESTED APPLICATIONS**

The resistive element comprises a metal oxide film deposited on a ceramic former. The element is protected by a flameproof coating which will withstand overload conditions without flame or mechanical damage. They are recommended for use in applications such as line protection etc..

**MOUNTING**

The resistors are suitable for processing on automatic insertion equipment and cutting and bending machines.

**MARKING**

The resistors are marked with a four band colour code in accordance with IEC 62.

**ORDERING INFORMATION**

Orders for these components should include the following information :-

Type, tolerance and value  
e.g. ROX3S 5% 1k0

For preformed components add suffix "BL"  
e.g. ROX3S 5% 1k0 BL

**PERFORMANCE CHARACTERISTICS**

The evaluation of the performance characteristics is carried out with reference to IECQ Specifications QC 400 000 and QC 400 100

Long term tests ± (5% + 0.1ohm)		Short term tests ± (1% + 0.05ohm)	
Test ref		Test ref	
4.23	Climatic sequence	4.13	Overload
4.24	Damp heat, steady state	4.16	Robustness of terminations
4.25.1	Endurance at 70 °C	4.18	Resistance to soldering heat
4.25.3	Endurance at 200 °C	4.19	Rapid change of temperature
		4.22	Vibration

**CROSS REFERENCE & PACKAGING**

New style reference	Previous style reference	Quantity per ammo pack	Std. tape spacing * S ± 1	Component spacing c ± 0.5
ROX05	ROX0410	2,000	52	5
ROX1	ROX0512	1,000	52	5
ROX2	ROX0717	1,000	63	10
ROX05S	ROX0410S	2,000	52	5
ROX1SS	N/A	2,000	52	5
ROX1S	ROX0512S	2,000	52	5
ROX2S	ROX0717S	1,000	52	5
ROX3S	ROX0515	1,000	63	10
ROX5S	ROX0942S	500	63	10

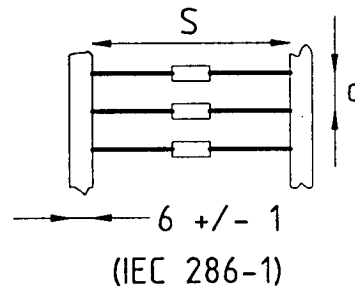

\* Other tape spacings available on request  
Other packaging styles are available on request

DS401/4



Italia House, Pass Street, Oldham,  
Gtr. Manchester, OL9 6HZ England.  
Telephone: 0161-624 0261 Fax: 0161-624 5109

Croster Electronics Ltd. reserve the right  
to change specifications without notice

