

FEATURES

- Light-weight aluminium alloy
- Suitable for cut to length applications
- Structural element type: Strut profile
- Compatible with support and connector accessories

RS PRO Strut, 30 x 30 mm, 6mm Groove, 3000mm Length

RS Stock No.: 761-3293



RS Professionally Approved Products bring to you professional quality parts across all product categories. Our product range has been tested by engineers and provides a comparable quality to the leading brands without paying a premium price.

Product Description

RS PRO Structural System 30mm x 30mm Profile 6 element, available in 1m, 2m and 3m lengths, compatible with Item Profile 6 range. RS PRO Structural System Profiles, compatible with Item Profile 5, Profile 6 and Profile 8, are suitable for general workplace furniture system construction, offering strong, light-weight, easily interchangeable elements in a variety of profile types

This range includes the following Aluminium Alloy Struts:

[761-3280](#) - 6mm Groove, 1000mm Length, Series Profile 6

[761-3284](#) - 6mm Groove, 2000mm Length, Series Profile 6

[761-3293](#) - 6mm Groove, 3000mm Length, Series Profile 6

General Specifications

Structural Element Type	Strut Profile
Number of Grooves	4
Material	Anodised Aluminium
Applications	Construction, Industrial equipment, Automotive manufacturing, Plumbing

Mechanical Specifications

Strut Profile	30mm x 30mm
Length	3000mm
Groove Size	6mm
Mass (G)	0.91kg/m
Moment of Inertia (I₂)	2.88cm ⁴
Section Modulus (W_x)	1.92cm ³

Compatible Accessories for Groove

Stock No.	Items
<u>767-5601</u> , <u>767-5604</u> , <u>767-5608</u>	End Caps
<u>767-5695</u> , <u>767-5718</u> , <u>767-5737</u> , <u>767-5715</u> , <u>767-5761</u> , <u>767-5692</u> , <u>767-5721</u> , <u>767-5709</u> , <u>767-5702</u>	Connector Bracket and Joint
<u>767-5727</u>	Floor Bracket
<u>767-5645</u> , <u>767-5642</u> , <u>767-5654</u> , <u>767-5667</u> , <u>767-5648</u> , <u>767-5651</u> , <u>767-5658</u> , <u>767-5660</u> , <u>767-5664</u> , <u>767-5673</u> , <u>767-5636</u>	T-Slot Nut
<u>767-5822</u> , <u>767-5686</u> , <u>767-5689</u>	Screws
<u>767-5711</u>	Cube Connector
<u>767-5730</u> , <u>767-5670</u> , <u>767-5676</u>	Universal Connector
<u>767-5686</u> , <u>767-5682</u>	T-Matic Connector
<u>767-5689</u>	Screw connector
<u>767-5695</u> , <u>767-5698</u>	Connection Angle
<u>767-5743</u>	Roller

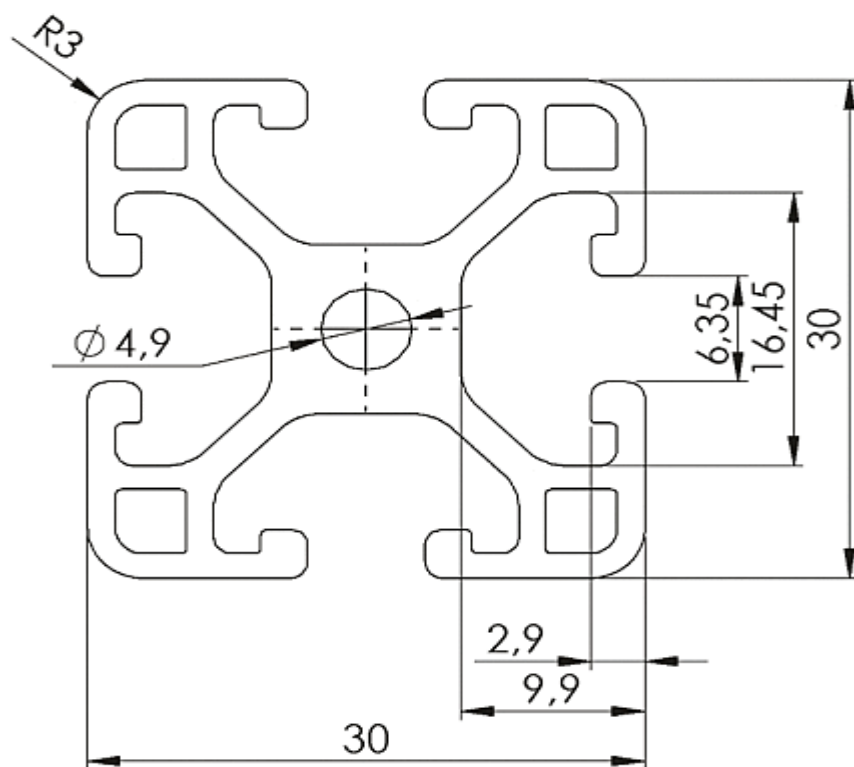

RS Article no.	40 Character Description	Profile Length
7613280	Profile 6 30x30 light 1m	1000mm
7613284	Profile 6 30x30 light 2m	2000mm
7613293	Profile 6 30x30 light 3m	3000mm