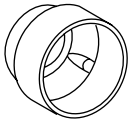
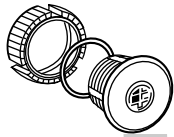
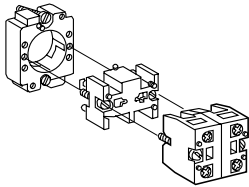

XB2B Accessories

ZB2BZ16

ZB2BZ17

ZB2BZ18

ZB2SZ3

ZB2BZ21

| Type | Description | Color | Catalog Number | |
|---------------------------|---|---|----------------|-----------|
| Boots | Silicon boot for rectangular push button w/indicator light | | ZB2BW008 | |
| | Silicon boot for rectangular push button w/o light | | ZB2BA008 | |
| Guards/Locks | 40 mm for Momentary Mushrooms (metal) | Blue | ZB2BZ1601 | |
| | | Black | ZB2BZ1602 | |
| | | Red | ZB2BZ1604 | |
| | 40 mm with finger cut-out for push-pull (metal) | Yellow | ZB2BZ1605 | |
| | | Blue | ZB2BZ1701 | |
| | | Black | ZB2BZ1702 | |
| | 40 mm with finger cut-out and 7mm holes for padlocking (metal) | Red | ZB2BZ1704 | |
| | | Yellow | ZB2BZ1705 | |
| | | Blue | ZB2BZ1801 | |
| | 60 mm mushroom guard (black plastic) no padlocking provision | Black | ZB2BZ1802 | |
| | | Red | ZB2BZ1804 | |
| | | Yellow | ZB2BZ1805 | |
| | | 60 mm guard for 40 mm T-T-R EMO button (yellow plastic) | | ZB2BZ1905 |
| | | Padlock attachment (makes flush operator inaccessible) | | ZB2BZ26 |
| | Closing plates 22 mm | Black plastic | | ZB2SZ3 |
| Gray plastic | | | ZB2 SZ4 | |
| Blue metallic | | | ZB2SZ2 | |
| Miscellaneous accessories | Adapter for mounting into 1 3/16" (30 mm) hole and used with 30 mm P.B. nameplate | | ZB2BZ41 | |
| | Adapter for mounting into 30 mm hole and use with XB2B nameplate | | ZB2BZ4 | |
| | Base only-for mounting contact blocks | | ZB2BZ009 | |
| | Add on push-on/push-off mechanism | | ZB2BZ21 | |
| | Bulb extractor for use with BA9s | | XBFX13 | |

Limited Availability
 For replacement use only.
 For new installations, use
 XB4 (page 37 - 72)