



RTUE80-XL

Take-up housing unit

Take-up housing units RTUE, cast iron housing, radial insert ball bearing with eccentric locking collar, R seals

X-life

Technical information

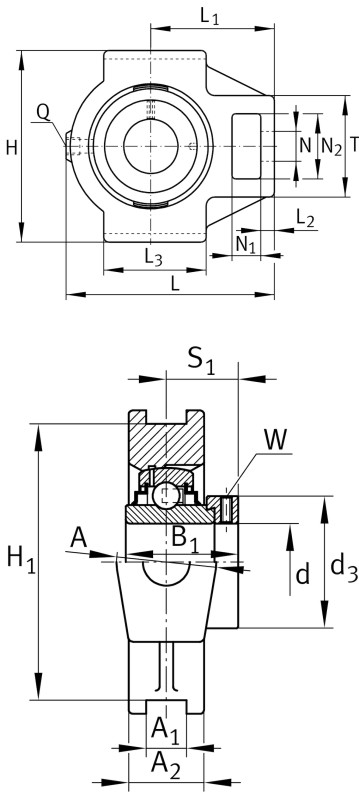

Your current product variant

Material	GG	Grey cast iron
----------	----	----------------

Main Dimensions & Performance Data

d	80 mm	Bore diameter
H	184 mm	Height
L	230 mm	Length total
B 1	70.7 mm	Locking collar total width
≈m	7.7 kg	Weight

Mounting dimensions

A 1	28 mm	Width guidance groove
H13		Width guidance groove clearance
H 1	165 mm	Distance guidance grooves
0.25 mm		Upper distance guidance groove tolerance
-0.25 mm		Lower distance guidance groove tolerance
N	41 mm	Fixing bore



Dimensions

L ₁	140 mm	Distance shaft axis
L ₂	20 mm	Length fixed link
L ₃	120 mm	Length guidance groove
A	70 mm	Width housing fixing side
N ₁	35 mm	Width recess
N ₂	70 mm	Height recess
S ₁	47.3 mm	Distance of raceway to locking collar
T	110 mm	Height housing fixing side
Q	M6	Connection thread for lubrication
A ₂	50 mm	Width housing

Additional information

TUE16	Housing
GE80-XL-KRR-B	Bearing designation

Temperature range

T _{min}	-20 °C	Operating temperature min.
T _{max}	120 °C	Operating temperature max.