

## Type L14 - Straight Coupling

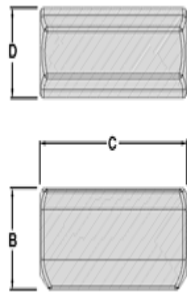

Type	Pipe Reference	Dimension (mm)								Weight (kg)
	A	B	C	D	E	F	G	H		
L14-6	6	50	100	42.5					0.18	
L14-7	7	59	130	53					0.33	
L14-8	8	65	148	60					0.37	

Designed to give an in-line joint between tubes of the same size. Frequently used to allow full pipes to be used in railing applications.

Note: It is not advisable to join the upper and lower rails of a railing within the same bay.