

REVISONS		DATE	DWN	APVD
P	LTR	DESCRIPTION		
5		REVISED	07DEC2010	RB RN

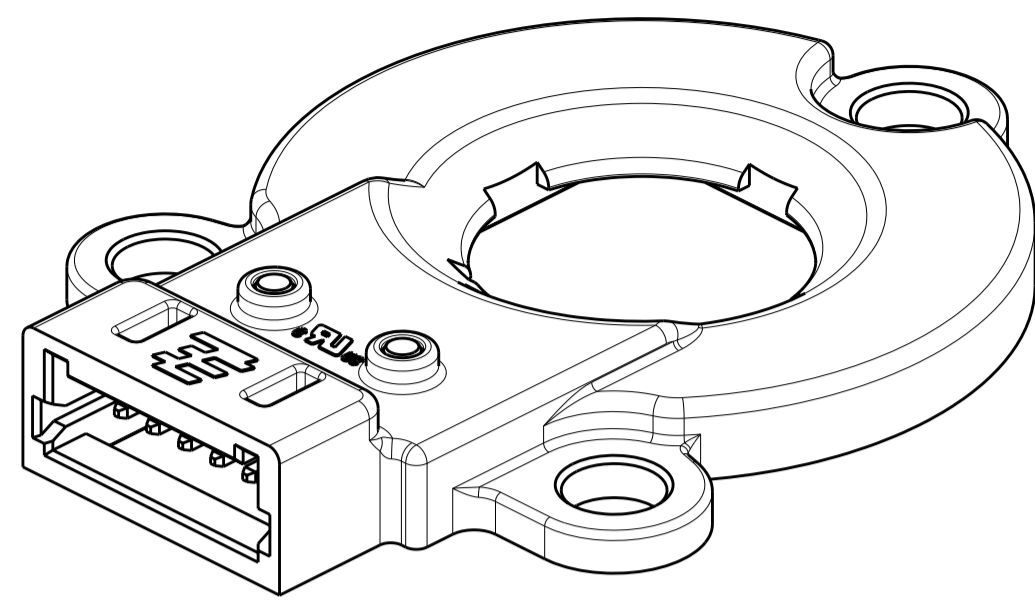

2106946-1

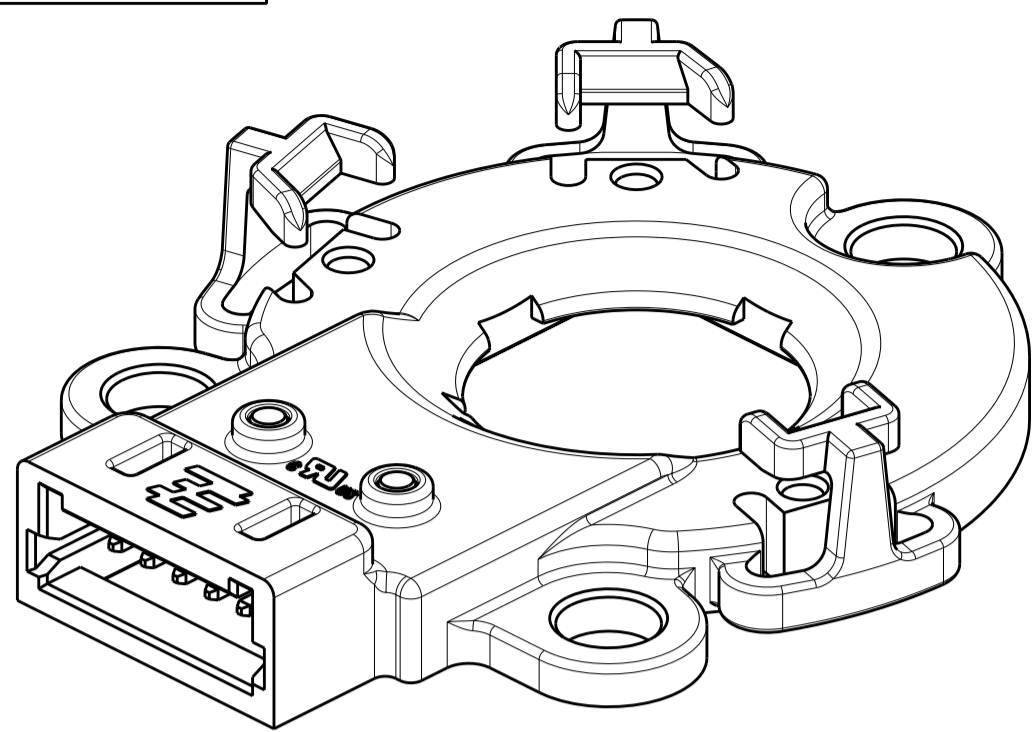

2106946-2

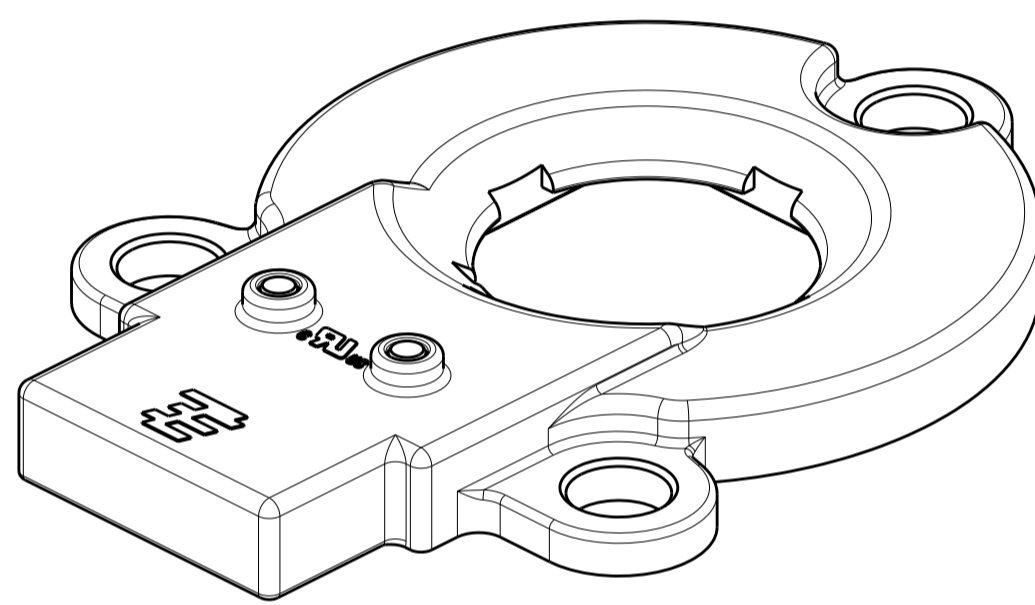

2106946-3

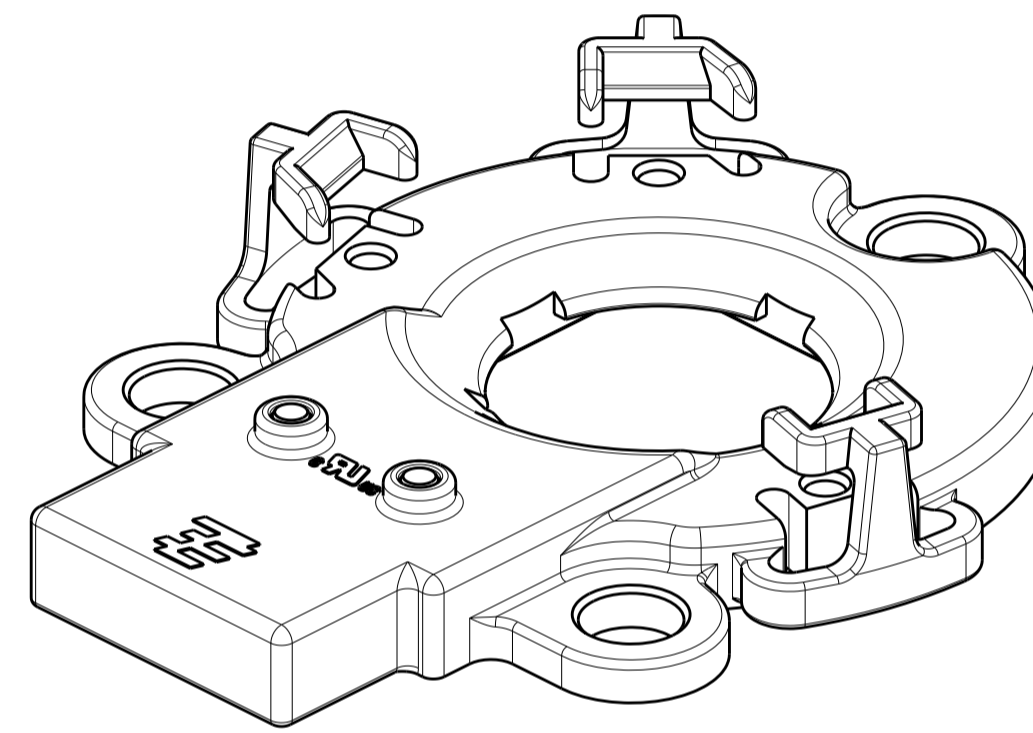

2106946-4

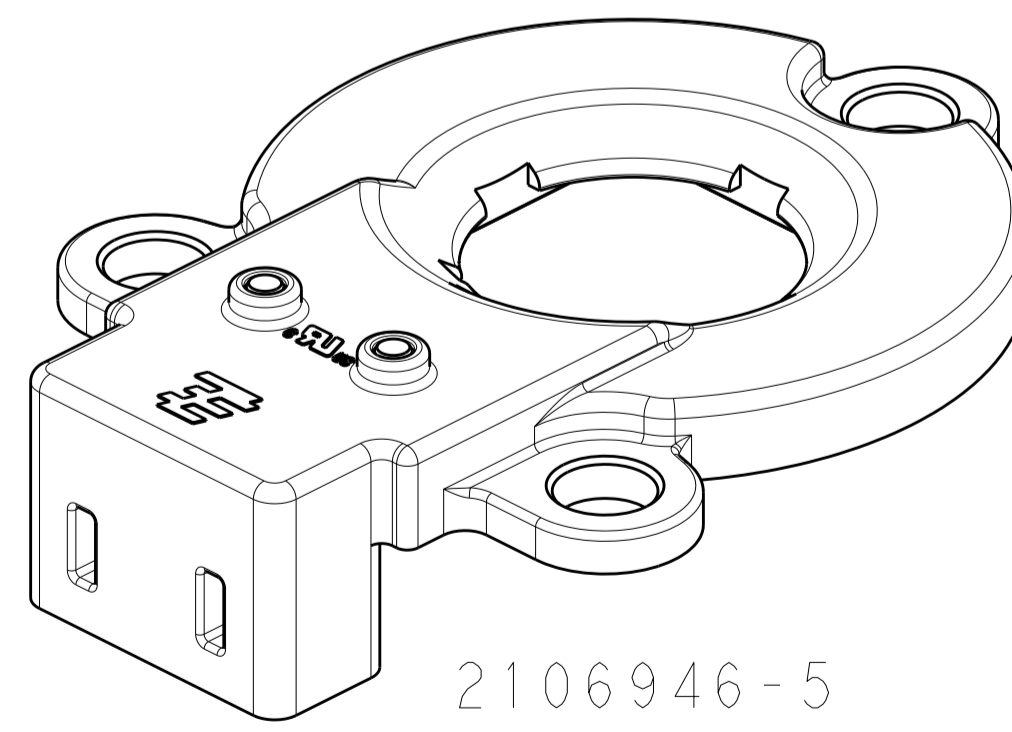

2106946-5

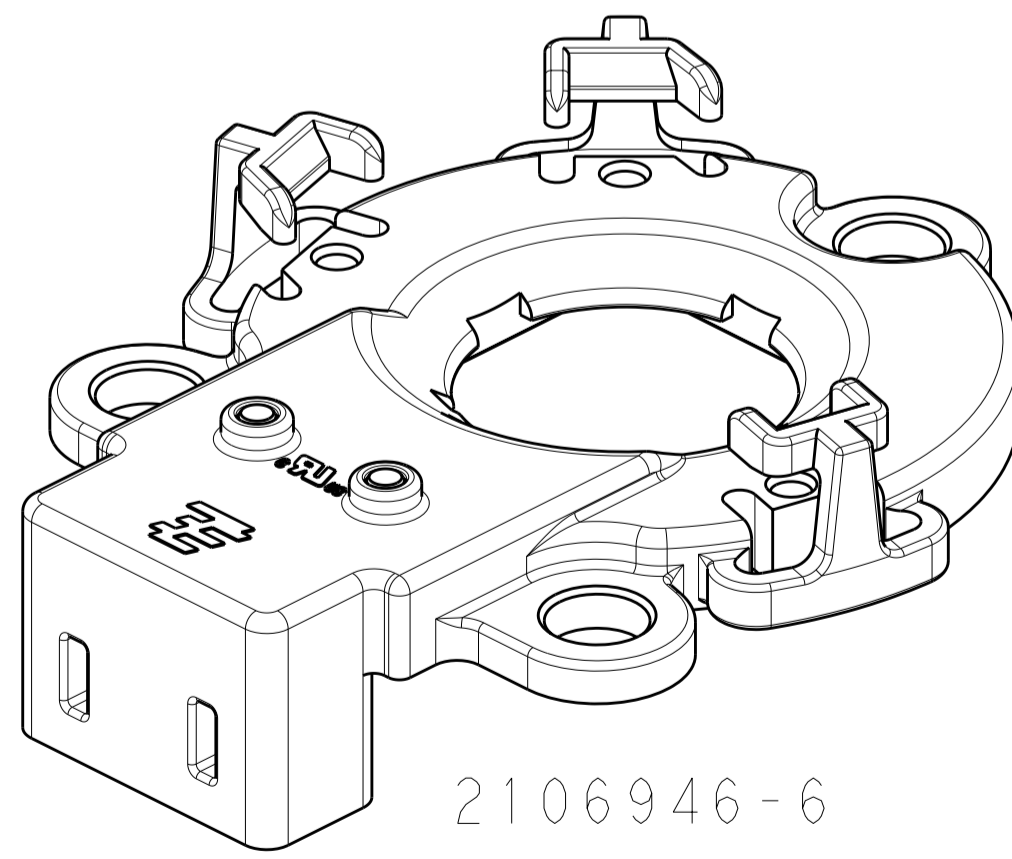

2106946-6

- 1. MATERIALS AND FINISH:  
 -HOUSING: PBT-GF  
 -CONTACTS: COPPER ALLOY  
 FINISH: TIN AND SILVER OVER NICKEL
- 2. PRODUCT TO COMPLY WITH DIRECTIVE 2002/95/EC (ROHS)
- 3. PRODUCT HAS NOT COMPLETED VALIDATION TESTING
- 4. RECOMMENDED SCREW SIZE: #4 OR M3  
 SCREW DOWN TORQUE: 0.28 N-M (2.5 IN-LBF) TO  
 0.45 N-M (4.0 IN-LBF)
- 5. SCREWS FROM FERROUS METALS (OTHER THAN STAINLESS STEEL) SHOULD BE ZINC PLATED OR HAVE AN EQUIVALENT PROTECTIVE COATING
- 6. RECOMMENDED TE MATING CONNECTOR  
 -HOUSING: 353908-6  
 -CONTACT: 353907-1
- 7. REFER TO CREE® XLAMP® MP-L™ SOLDERING AND HANDLING APPLICATION NOTE AVAILABLE ON THE CREE WEBSITE
- 8. CENTER OF THE LED PACKAGE NOT OPTICAL CENTER
- 9. PADS SHOULD BE SMOOTH AND FLAT. PADS TO BE PLATED WITH 2.54 MICRONS [100 μin] MIN HAL TIN

TYCO ELECTRONICS  
 CONFIDENTIAL  
 AND PROPRIETARY

PROPOSED DESIGN  
 NOT PRODUCTION TOOLED

DESIGN IS SUBJECT TO  
 CHANGE WITHOUT NOTICE

SOCKET ASSEMBLY, LED TO INVERTED WIRE, W/ OPTICS LATCH	2106946-6
SOCKET ASSEMBLY, LED TO INVERTED WIRE, W/O OPTICS LATCH	2106946-5
SOCKET ASSEMBLY, LED TO BOARD W/ OPTICS LATCH	2106946-4
SOCKET ASSEMBLY, LED TO BOARD, W/O OPTICS LATCH	2106946-3
SOCKET ASSEMBLY, LED TO WIRE, W/ OPTICS LATCH	2106946-2
SOCKET ASSEMBLY, LED TO WIRE, W/O OPTICS LATCH	2106946-1
DESCRIPTION	PART NO.

THIS DRAWING IS A CONTROLLED DOCUMENT FOR TYCO ELECTRONICS CORPORATION. IT IS SUBJECT TO CHANGE AND THE CONTROLLING ENGINEERING ORGANIZATION SHOULD BE CONTACTED FOR THE LATEST REVISION.		DWN ARJUN 17MAR2010	Tyco Electronics Corporation Harrisburg, PA 17105-3608	
DIMENSIONS: mm		CHK R. NARANG 26MAR2010	NAME ASSEMBLY, SOLDERLESS LED SOCKET TYPE CM	
TOLERANCES UNLESS OTHERWISE SPECIFIED: 0 PLC ± 1 PLC ± 2 PLC ±0.13 3 PLC ± 4 PLC ± ANGLES ±2° FINISH		APVD -	PRODUCT SPEC 108-2439	RESTRICTED TO -
MATERIAL		APPLICATION SPEC 114-13281	SIZE A200779	DRAWING NO C-2106946
1		WEIGHT -	SCALE 4:1	SHEET 1 OF 9 REV 5
CUSTOMER DRAWING				

THIS DRAWING IS UNPUBLISHED. RELEASED FOR PUBLICATION 20  
 © COPYRIGHT 20 BY TYCO ELECTRONICS CORPORATION. ALL INTERNATIONAL RIGHTS RESERVED.

LOC	DIST	REVISIONS			
P	LTR	DESCRIPTION	DATE	DWN	APVD
-	-	SEE SHEET 1	-	-	-

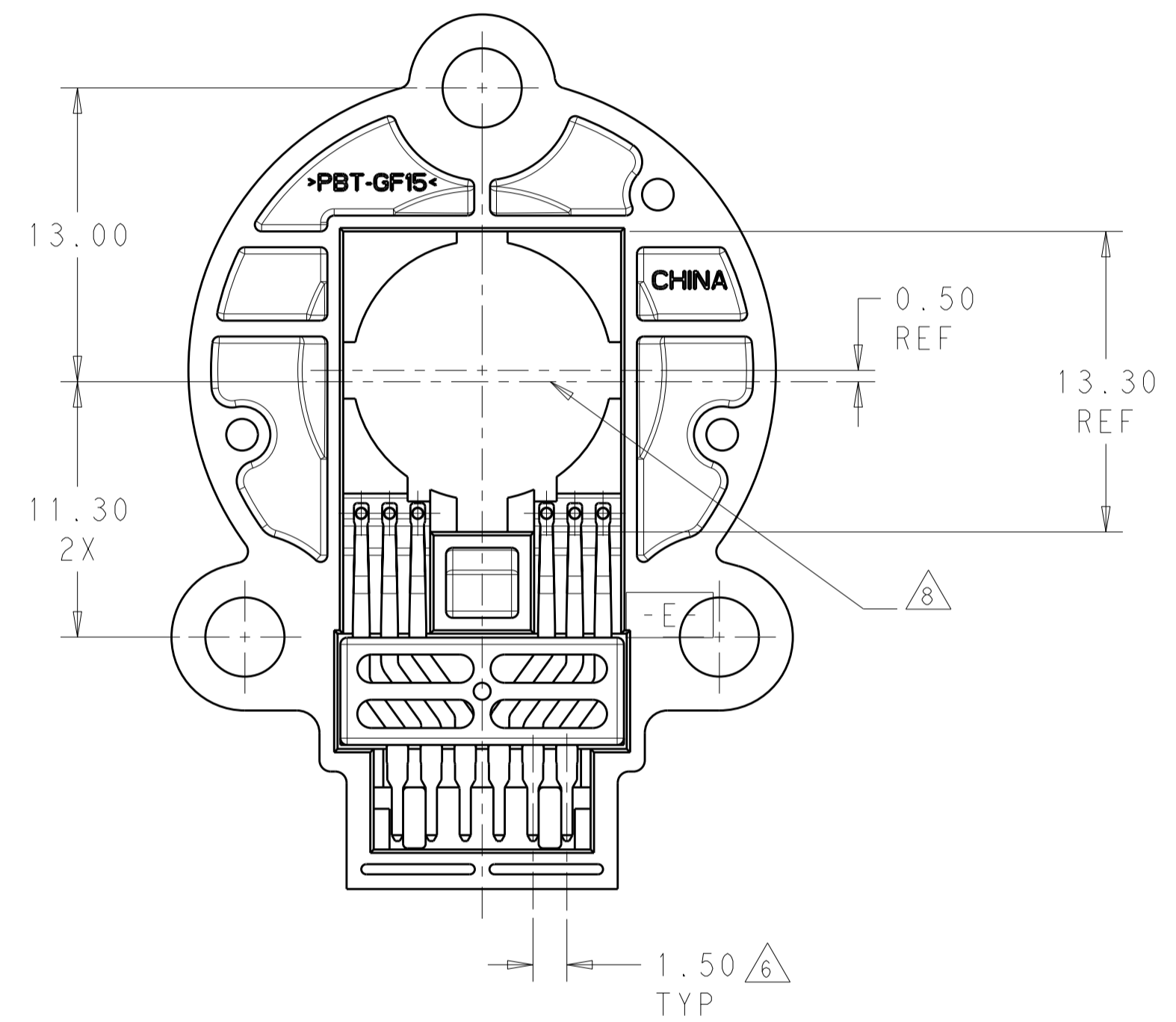
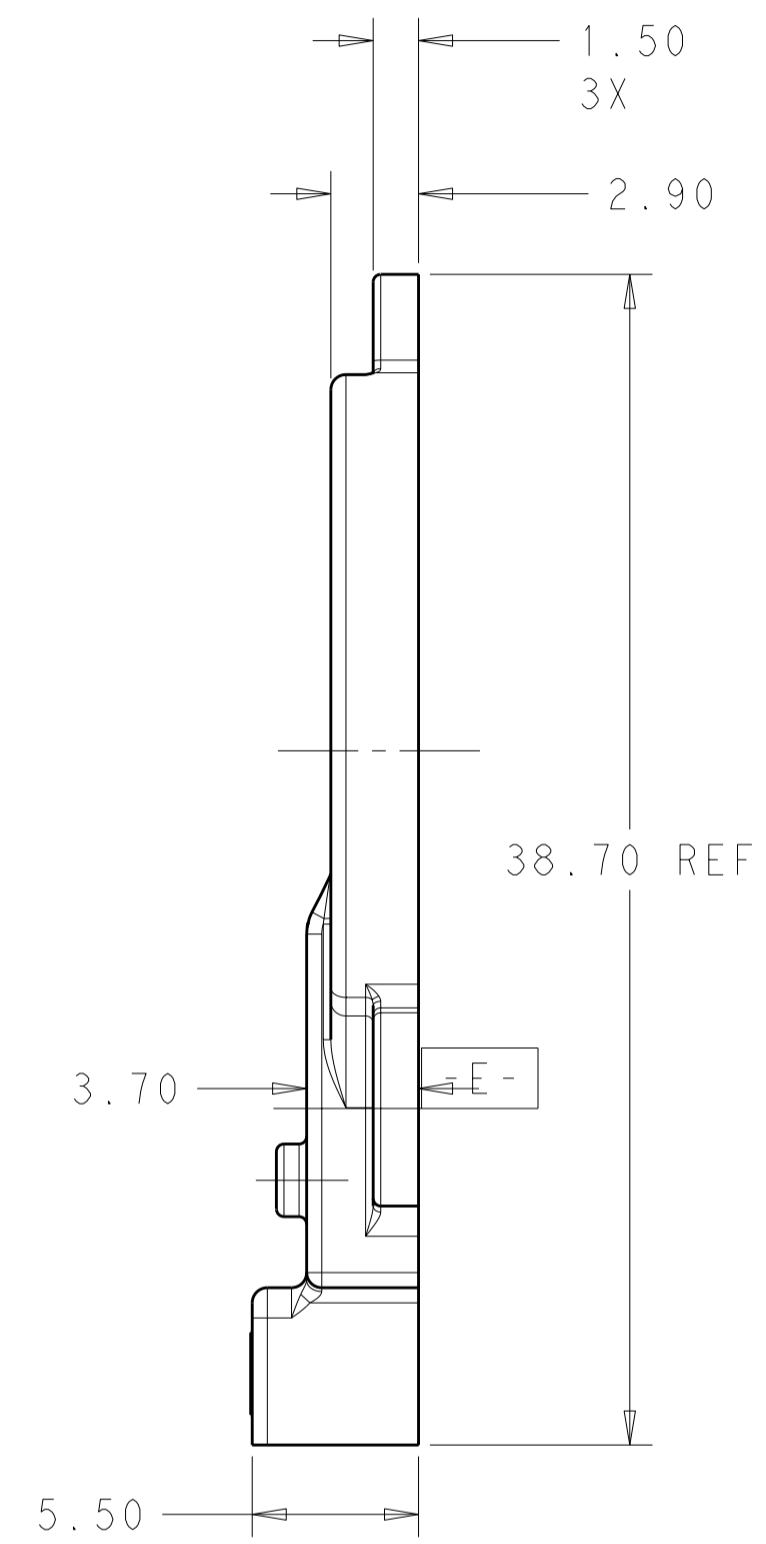
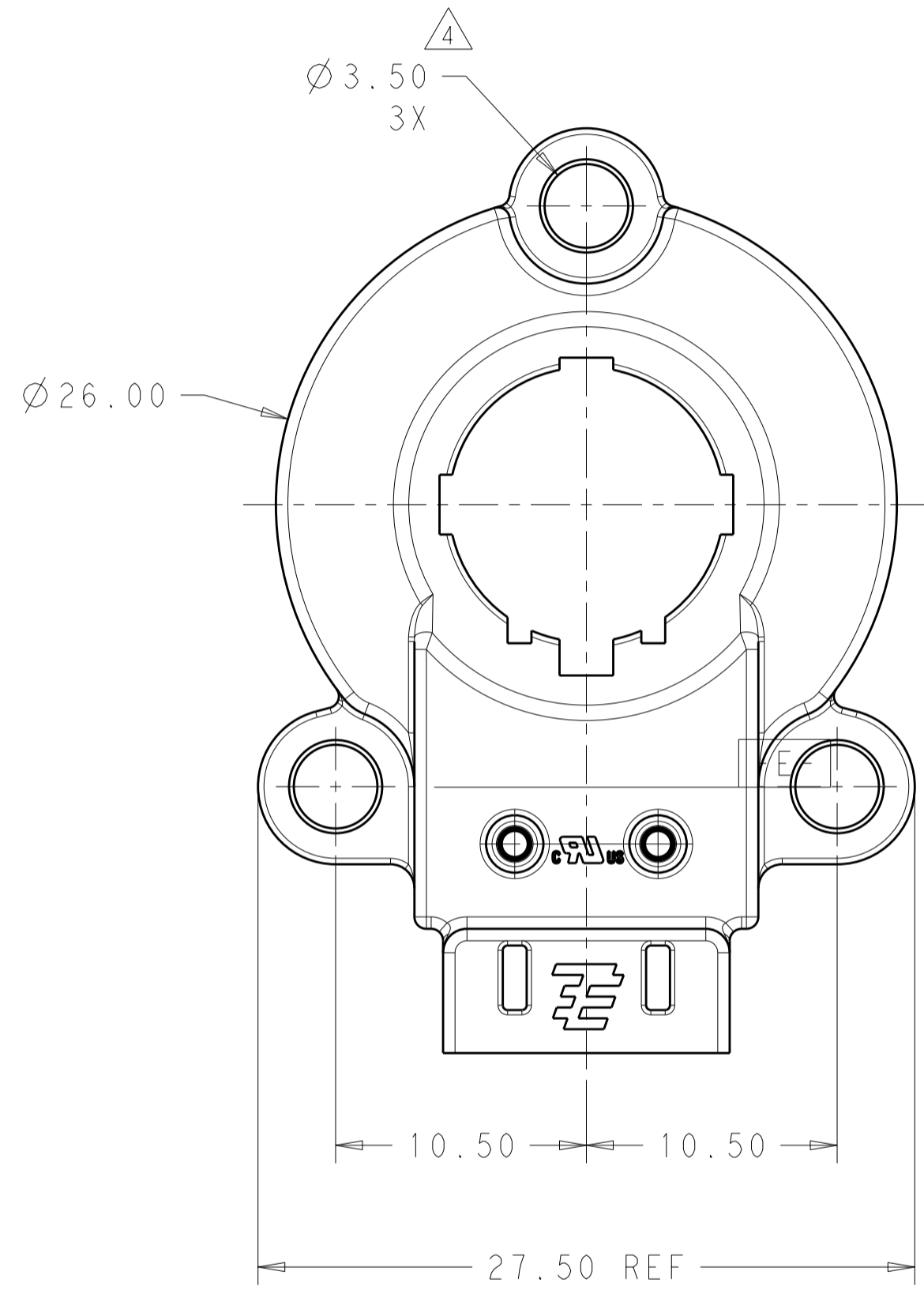

TYCO ELECTRONICS  
 CONFIDENTIAL  
 AND PROPRIETARY

PROPOSED DESIGN  
 NOT PRODUCTION TOOLED

DESIGN IS SUBJECT TO  
 CHANGE WITHOUT NOTICE

2106946-1 SHOWN

THIS DRAWING IS A CONTROLLED DOCUMENT FOR TYCO ELECTRONICS CORPORATION. IT IS SUBJECT TO CHANGE AND THE CONTROLLING ENGINEERING ORGANIZATION SHOULD BE CONTACTED FOR THE LATEST REVISION.		DWN ARJUN 17MAR2010	Tyco Electronics Corporation Harrisburg, PA 17105-3608	
DIMENSIONS: mm		CHK R. NARANG 26MAR2010	NAME ASSEMBLY, SOLDERLESS LED SOCKET TYPE CM	
TOLERANCES UNLESS OTHERWISE SPECIFIED: 0 PLC ± 1 PLC ± 2 PLC ±0.13 3 PLC ± 4 PLC ± ANGLES ±2° FINISH		APVD -	PRODUCT SPEC 108-2439	RESTRICTED TO -
MATERIAL -		APPLICATION SPEC 114-13281	SIZE A200779	DRAWING NO C-2106946
-		WEIGHT -	SCALE 4:1	SHEET 2 OF 9 REV 5
-		CUSTOMER DRAWING	-	

THIS DRAWING IS UNPUBLISHED. RELEASED FOR PUBLICATION 20  
 © COPYRIGHT 20 BY TYCO ELECTRONICS CORPORATION. ALL INTERNATIONAL RIGHTS RESERVED.

LOC		DIST		REVISIONS			
P	LTR	DESCRIPTION	DATE	DWN	APVD		
-	-	SEE SHEET 1	-	-	-		

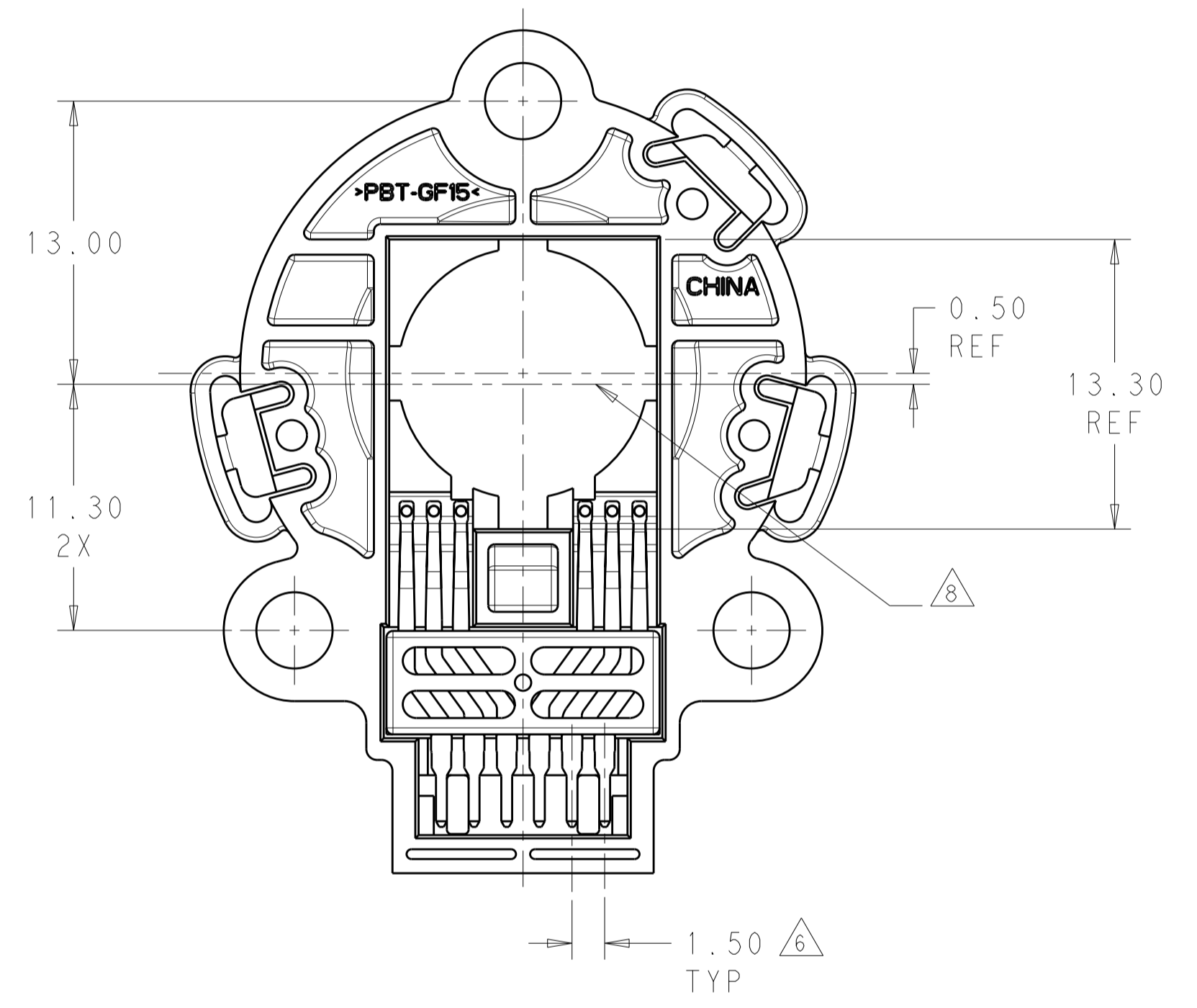
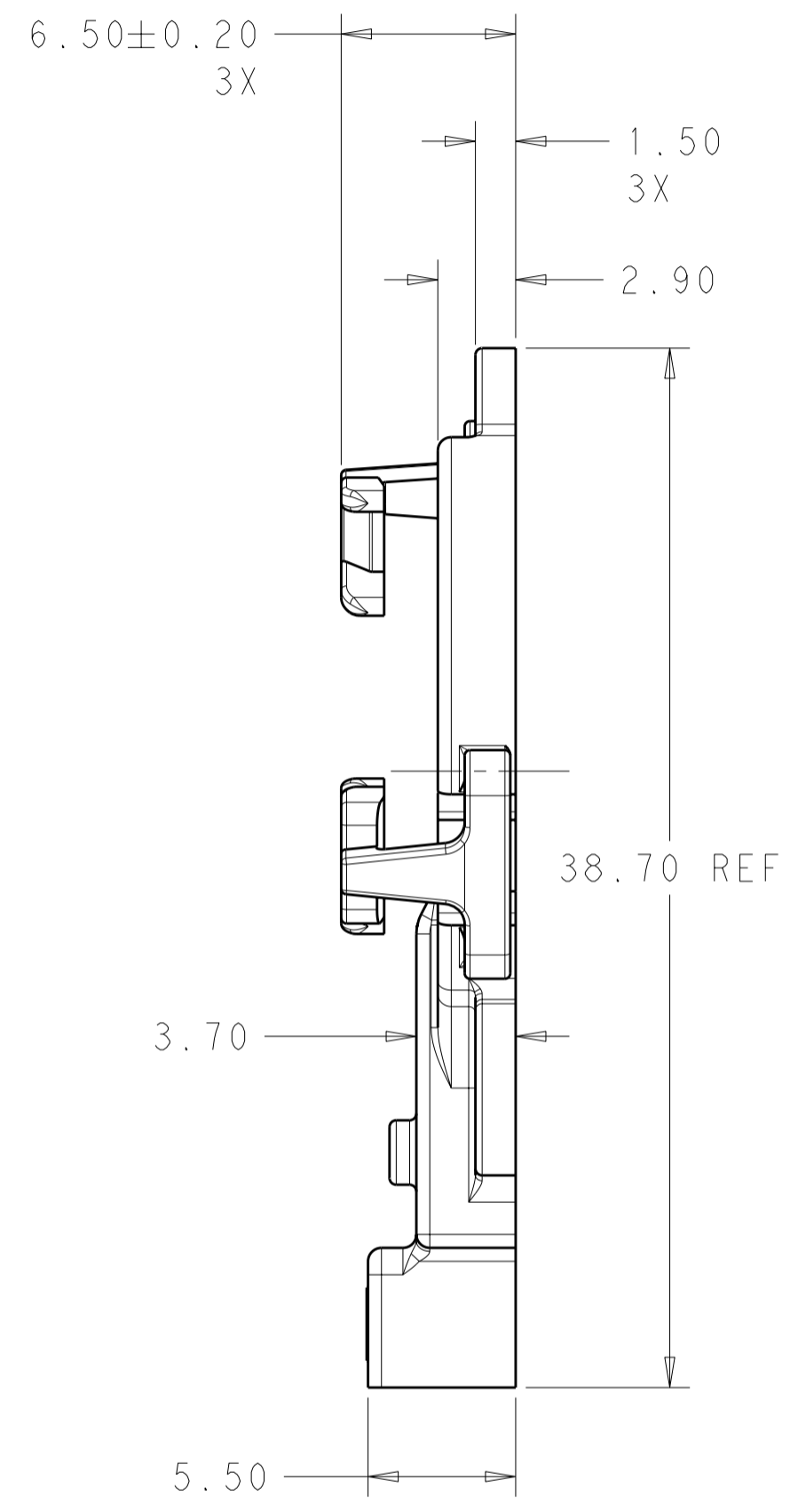
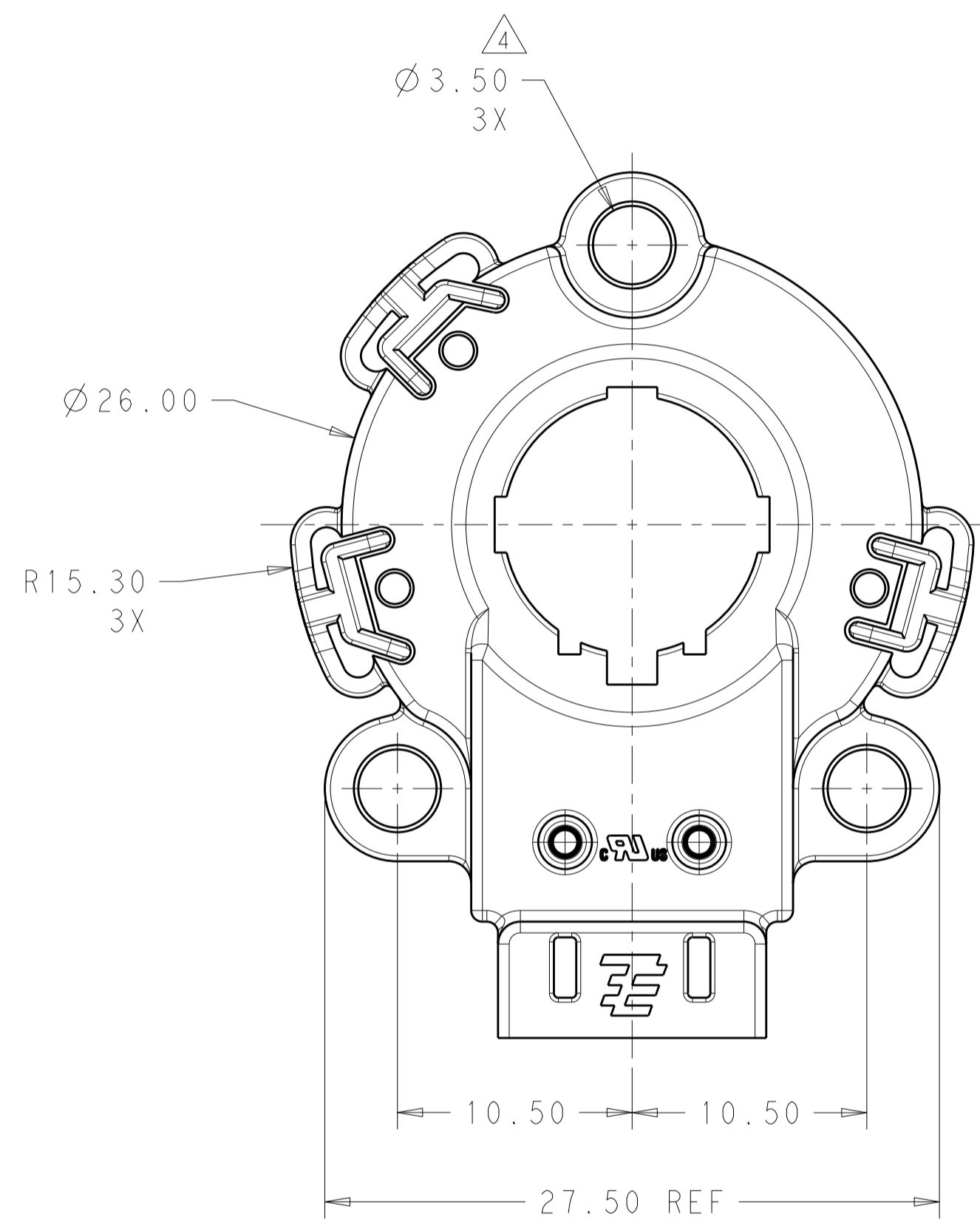

TYCO ELECTRONICS  
 CONFIDENTIAL  
 AND PROPRIETARY

PROPOSED DESIGN  
 NOT PRODUCTION TOOLED

DESIGN IS SUBJECT TO  
 CHANGE WITHOUT NOTICE

2106946-2 SHOWN

THIS DRAWING IS A CONTROLLED DOCUMENT FOR TYCO ELECTRONICS CORPORATION. IT IS SUBJECT TO CHANGE AND THE CONTROLLING ENGINEERING ORGANIZATION SHOULD BE CONTACTED FOR THE LATEST REVISION.		DWN ARJUN 17MAR2010	Tyco Electronics Corporation Harrisburg, PA 17105-3608	
DIMENSIONS: mm		CHK R. NARANG 26MAR2010	NAME ASSEMBLY, SOLDERLESS LED SOCKET TYPE CM	
TOLERANCES UNLESS OTHERWISE SPECIFIED: 0 PLC ± 1 PLC ± 2 PLC ±0.13 3 PLC ± 4 PLC ± ANGLES ±2° FINISH		APVD -	PRODUCT SPEC 108-2439	RESTRICTED TO -
MATERIAL -		APPLICATION SPEC 114-13281	SIZE A200779	DRAWING NO C-2106946
		WEIGHT -	SCALE 4:1	SHEET 3 OF 9
		CUSTOMER DRAWING	REV 5	

THIS DRAWING IS UNPUBLISHED. RELEASED FOR PUBLICATION 20  
 © COPYRIGHT 20 BY TYCO ELECTRONICS CORPORATION. ALL INTERNATIONAL RIGHTS RESERVED.

LOC		DIST		REVISIONS			
P	LTR	DESCRIPTION	DATE	DWN	APVD		
-	-	SEE SHEET 1	-	-	-		

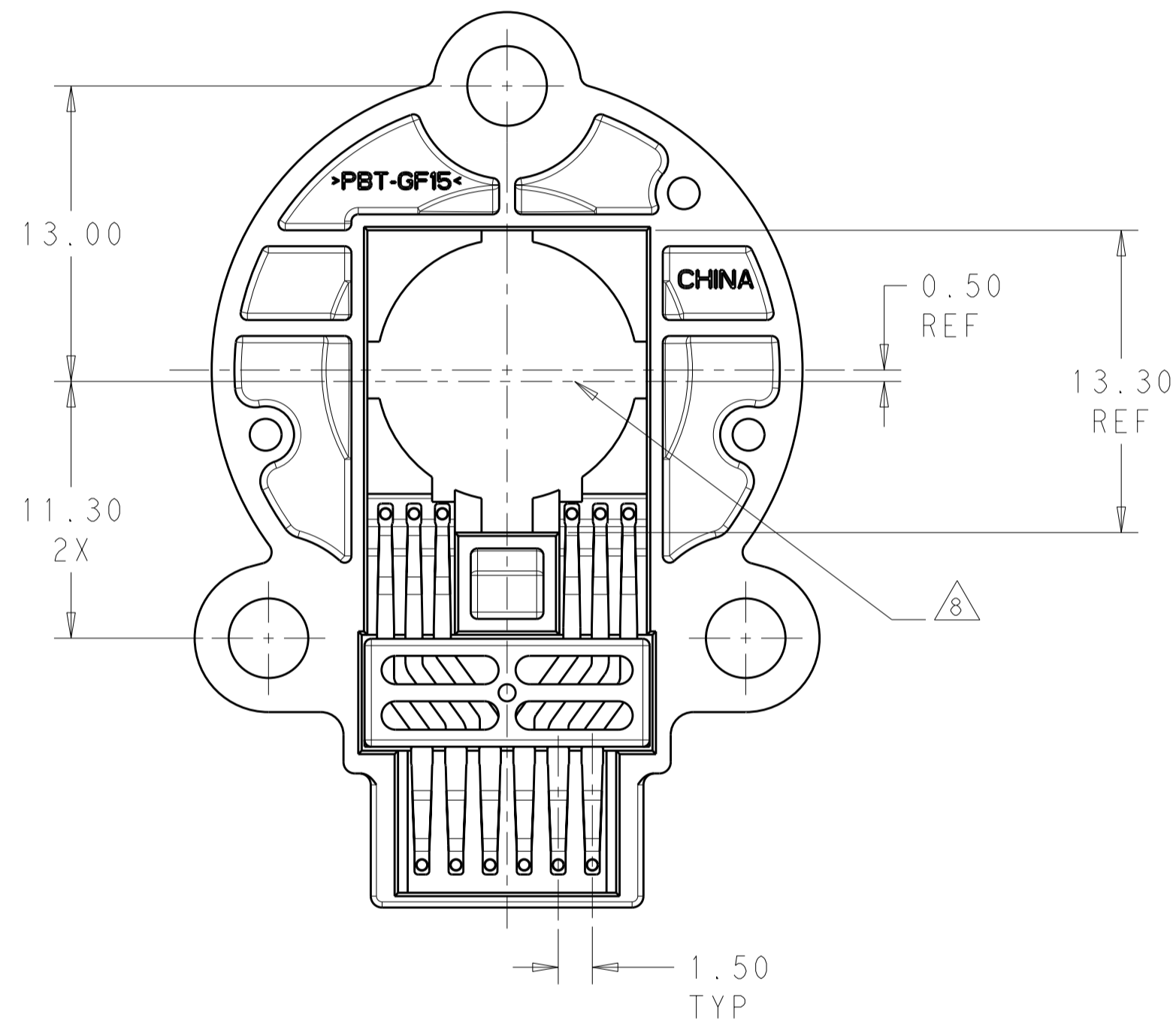
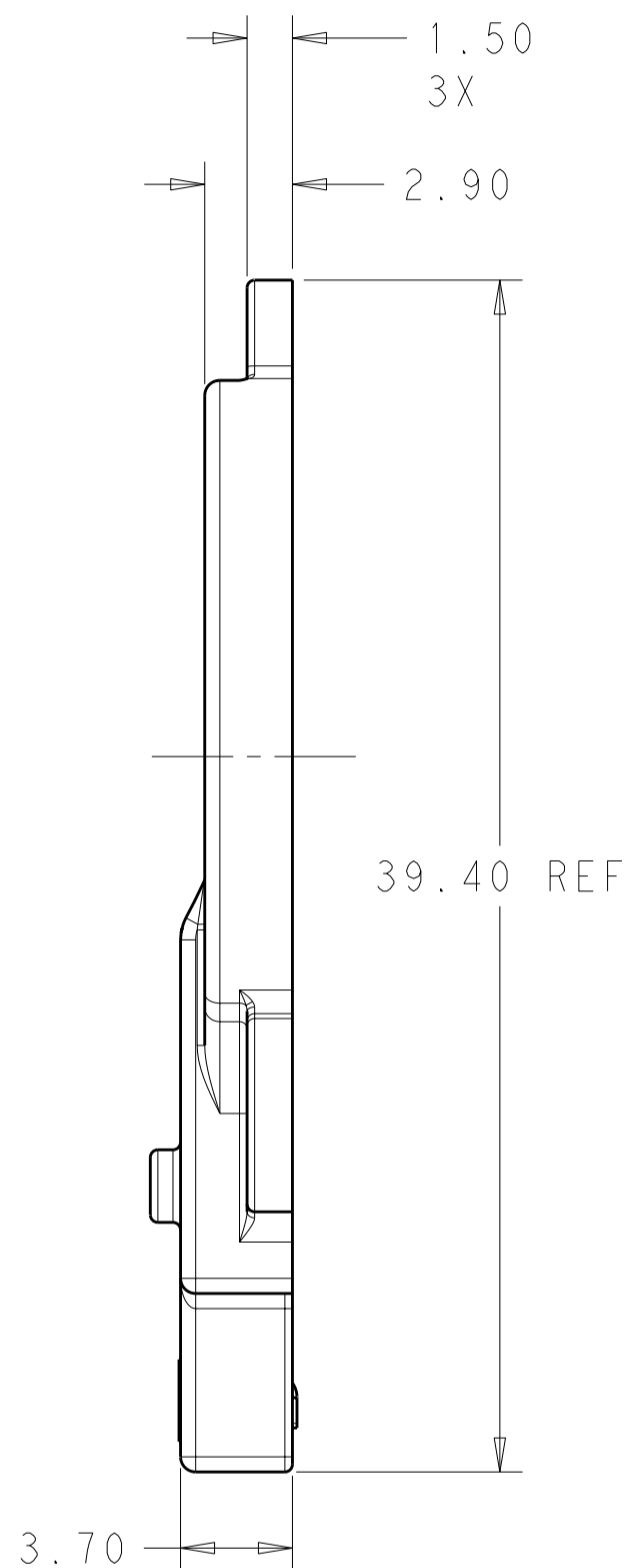
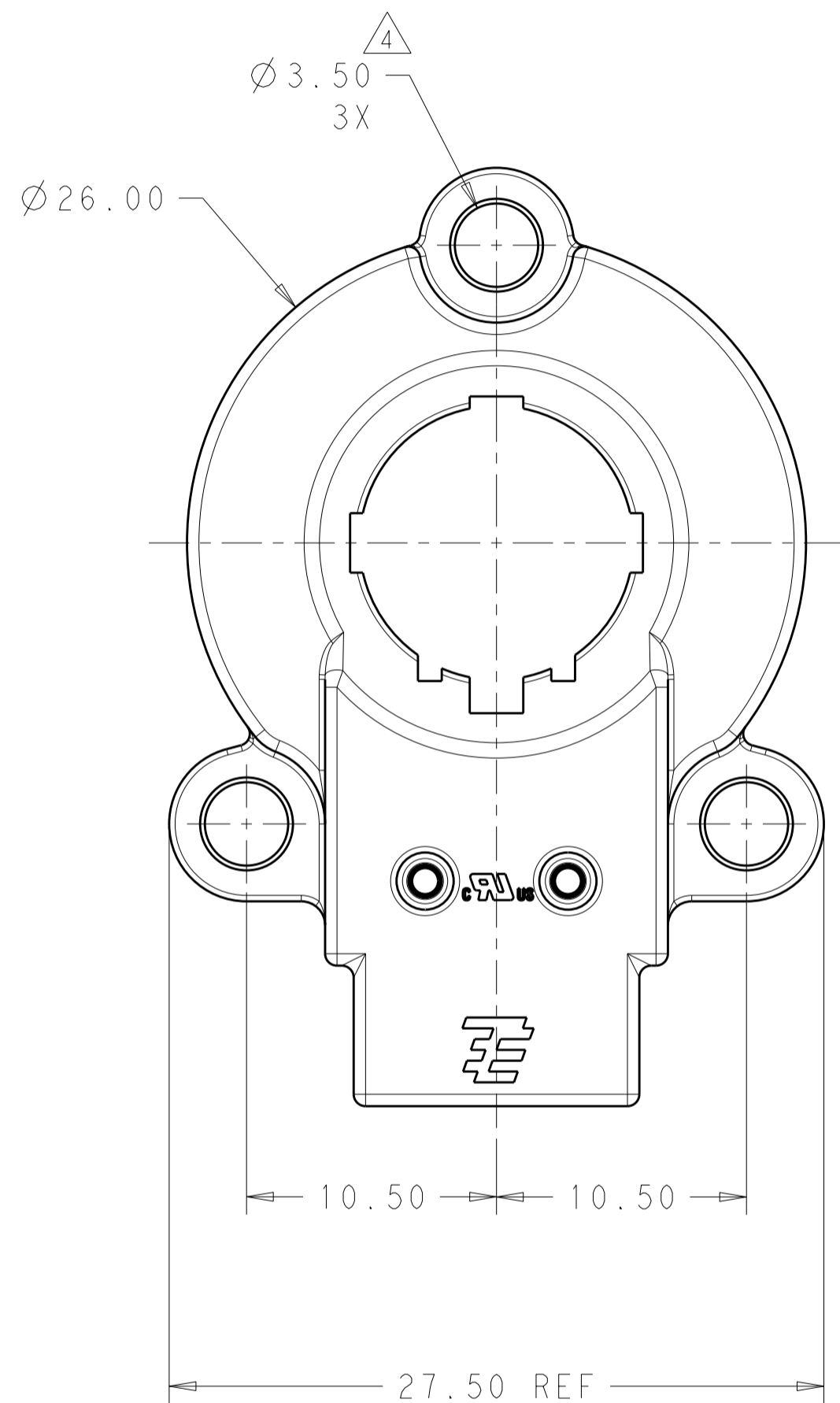

TYCO ELECTRONICS  
 CONFIDENTIAL  
 AND PROPRIETARY

PROPOSED DESIGN  
 NOT PRODUCTION TOOLED

DESIGN IS SUBJECT TO  
 CHANGE WITHOUT NOTICE

2106946-3 SHOWN

THIS DRAWING IS A CONTROLLED DOCUMENT FOR TYCO ELECTRONICS CORPORATION. IT IS SUBJECT TO CHANGE AND THE CONTROLLING ENGINEERING ORGANIZATION SHOULD BE CONTACTED FOR THE LATEST REVISION.		DWN ARJUN 17MAR2010	Tyco Electronics Corporation Harrisburg, PA 17105-3608	
		CHK R. NARANG 26MAR2010	NAME ASSEMBLY, SOLDERLESS LED SOCKET TYPE CM	
DIMENSIONS: mm		APVD -	RESTRICTED TO -	
TOLERANCES UNLESS OTHERWISE SPECIFIED:		PRODUCT SPEC 108-2439	SIZE A200779	
0 PLC ±-		APPLICATION SPEC 114-13281	DRAWING NO C-2106946	
1 PLC ±-		WEIGHT -	SCALE 4:1	
2 PLC ±0.13		CUSTOMER DRAWING	SHEET 4 OF 9	
3 PLC ±-			REV 5	
4 PLC ±-				
ANGLES ±2°				
FINISH				

THIS DRAWING IS UNPUBLISHED. RELEASED FOR PUBLICATION 20  
 © COPYRIGHT 20 BY TYCO ELECTRONICS CORPORATION. ALL INTERNATIONAL RIGHTS RESERVED.

LOC		DIST		REVISIONS			
P	LTR	DESCRIPTION	DATE	DWN	APVD		
-	-	SEE SHEET 1	-	-	-		

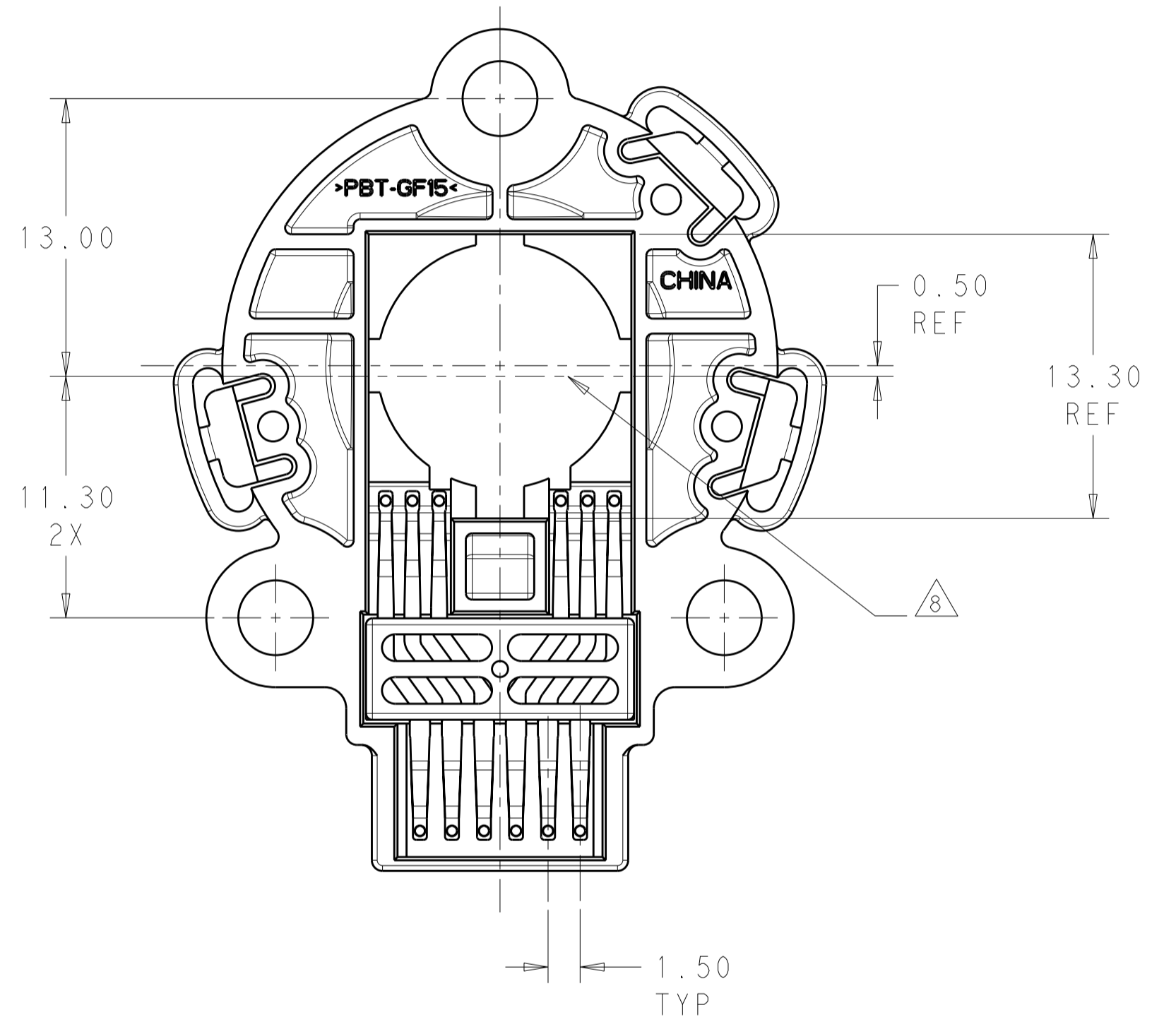
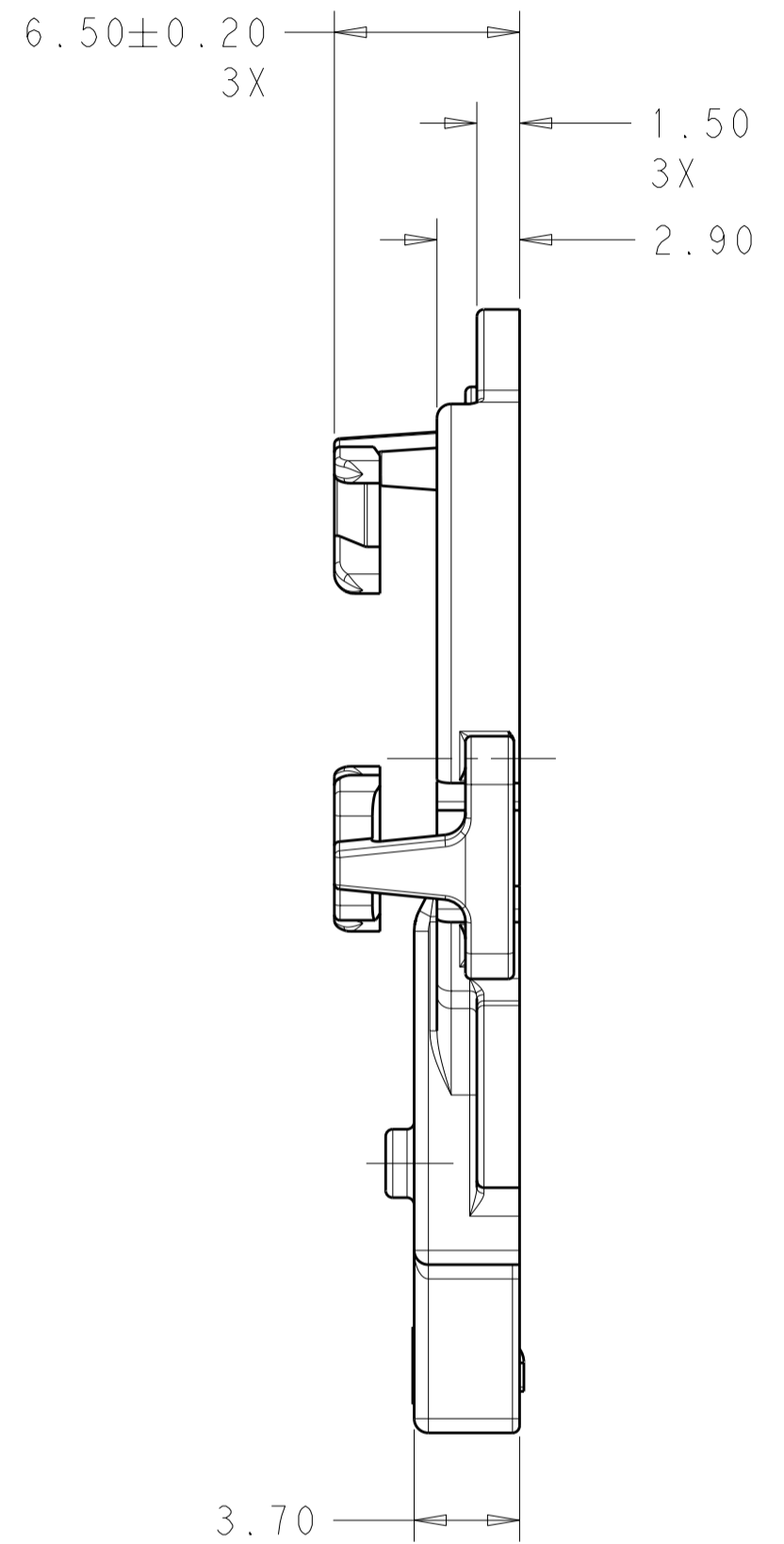
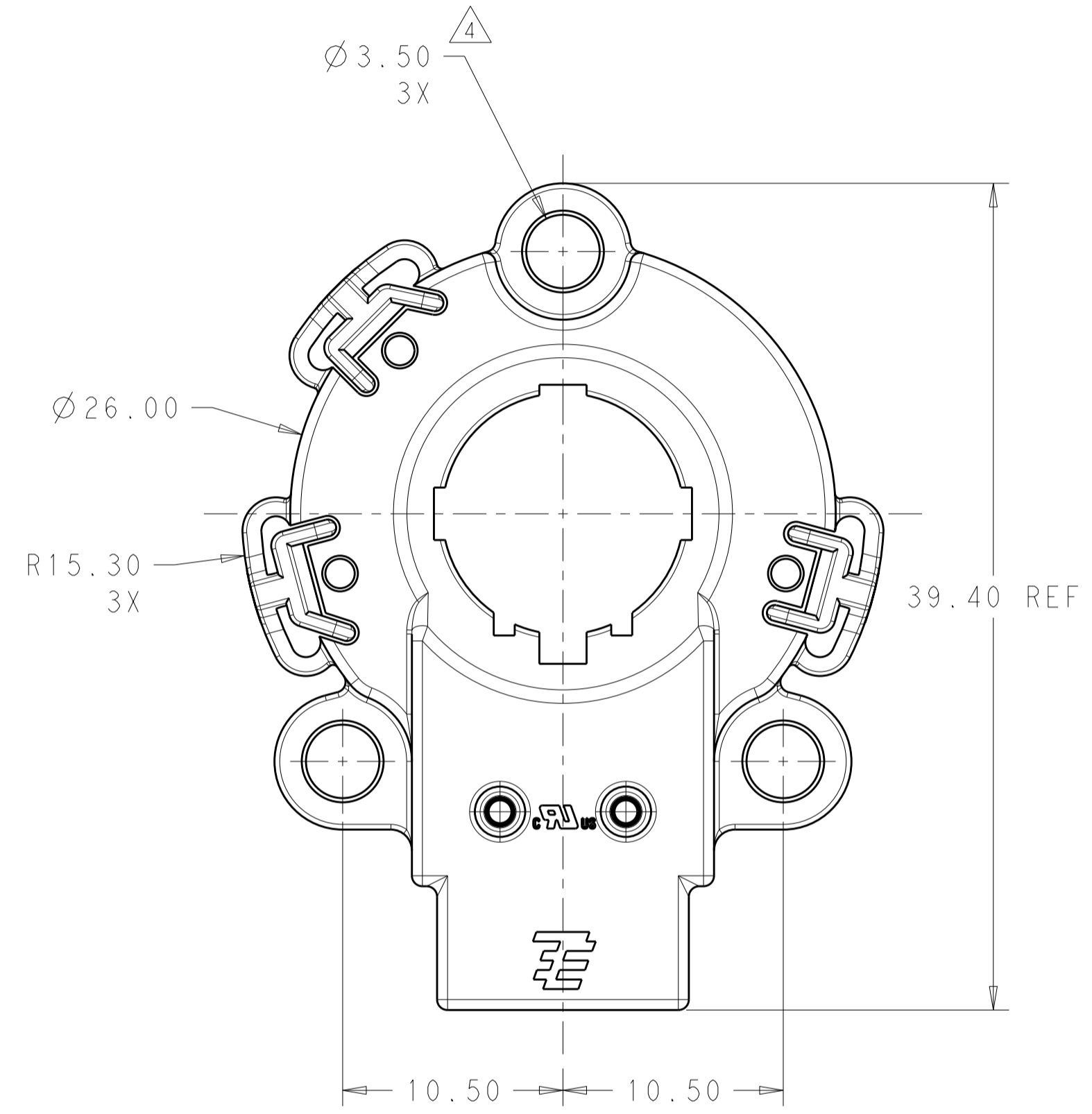

TYCO ELECTRONICS  
 CONFIDENTIAL  
 AND PROPRIETARY

PROPOSED DESIGN  
 NOT PRODUCTION TOOLED

DESIGN IS SUBJECT TO  
 CHANGE WITHOUT NOTICE

2106946-4 SHOWN

THIS DRAWING IS A CONTROLLED DOCUMENT FOR TYCO ELECTRONICS CORPORATION. IT IS SUBJECT TO CHANGE AND THE CONTROLLING ENGINEERING ORGANIZATION SHOULD BE CONTACTED FOR THE LATEST REVISION.		DWN ARJUN 17MAR2010	Tyco Electronics Corporation Harrisburg, PA 17105-3608	
		CHK R. NARANG 26MAR2010	NAME ASSEMBLY, SOLDERLESS LED SOCKET TYPE CM	
DIMENSIONS: mm		APVD -	SIZE A200779	
TOLERANCES UNLESS OTHERWISE SPECIFIED: 0 PLC ± 1 PLC ± 2 PLC ±0.13 3 PLC ± 4 PLC ± ANGLES ±2° FINISH		PRODUCT SPEC 108-2439 APPLICATION SPEC 114-13281 WEIGHT -	DRAWING NO C-2106946 RESTRICTED TO -	
MATERIAL -		CUSTOMER DRAWING	SCALE 4:1	SHEET 5 OF 9 REV 5

THIS DRAWING IS UNPUBLISHED. RELEASED FOR PUBLICATION 20  
 © COPYRIGHT 20 BY TYCO ELECTRONICS CORPORATION. ALL INTERNATIONAL RIGHTS RESERVED.

LOC	DIST	REVISIONS			
P	LTR	DESCRIPTION	DATE	DWN	APVD
-	-	SEE SHEET 1	-	-	-

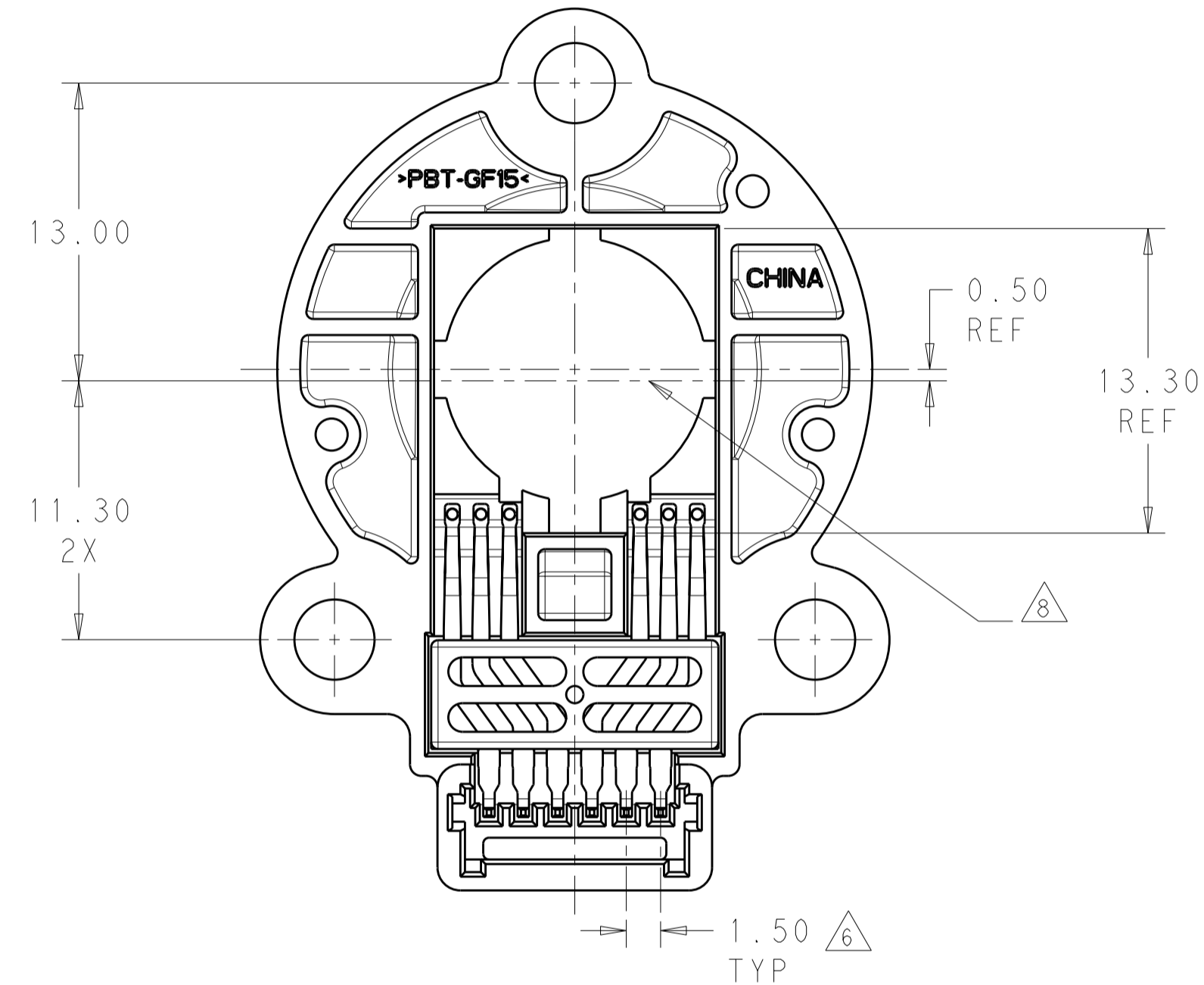
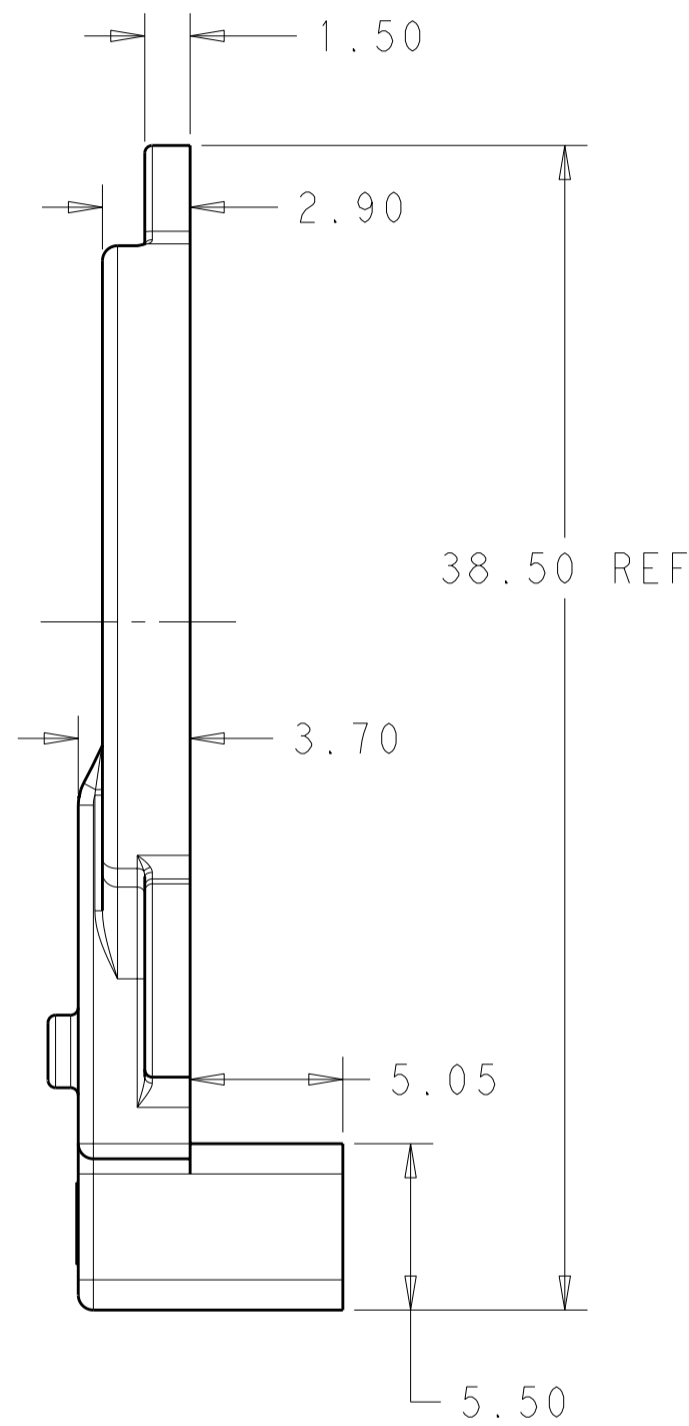
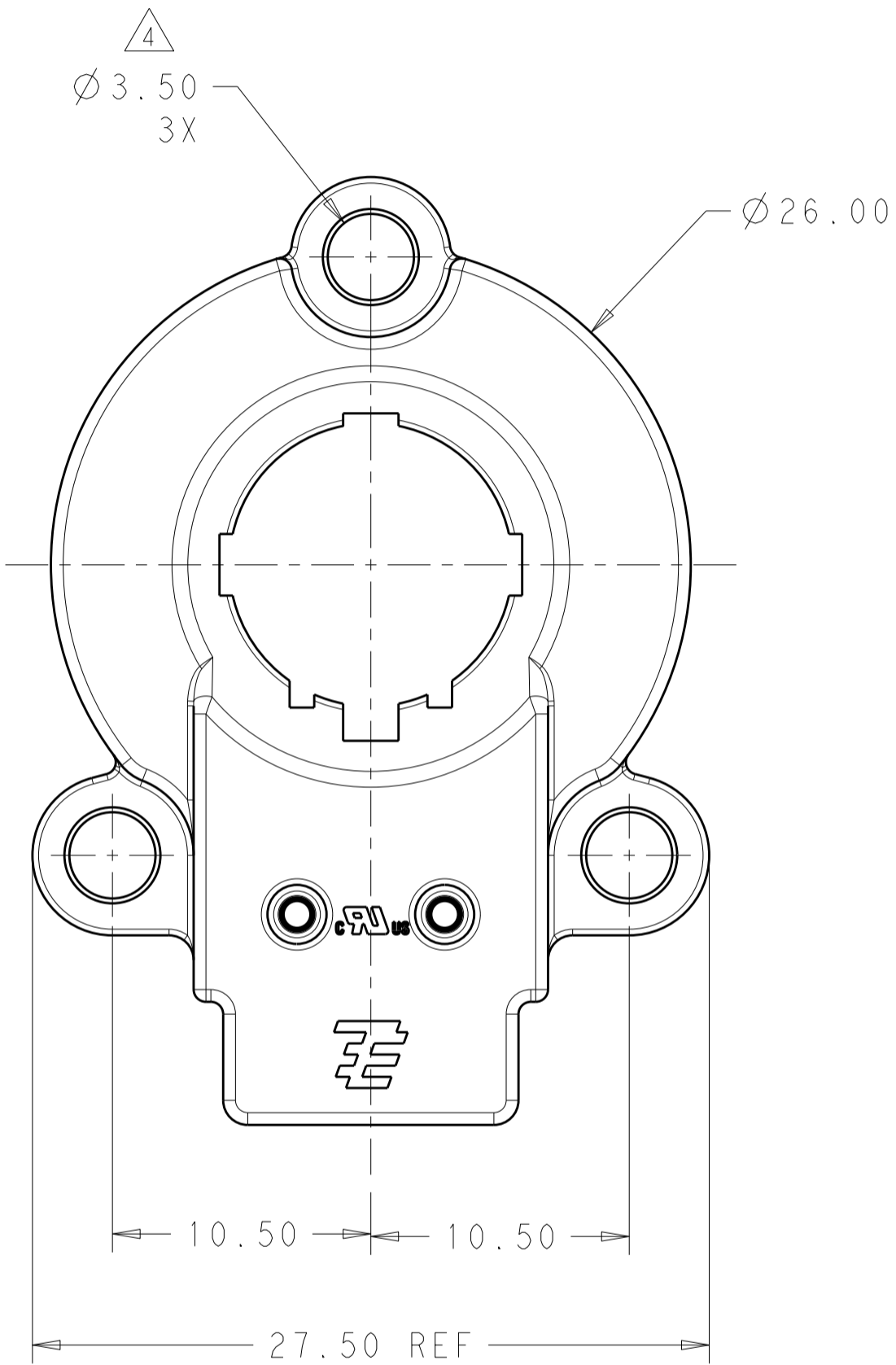

TYCO ELECTRONICS  
 CONFIDENTIAL  
 AND PROPRIETARY

PROPOSED DESIGN  
 NOT PRODUCTION TOOLED

DESIGN IS SUBJECT TO  
 CHANGE WITHOUT NOTICE

2106946-5 SHOWN

THIS DRAWING IS A CONTROLLED DOCUMENT FOR TYCO ELECTRONICS CORPORATION. IT IS SUBJECT TO CHANGE AND THE CONTROLLING ENGINEERING ORGANIZATION SHOULD BE CONTACTED FOR THE LATEST REVISION.		DWN ARJUN 17MAR2010	Tyco Electronics Corporation Harrisburg, PA 17105-3608	
DIMENSIONS: mm		CHK R. NARANG 26MAR2010	NAME ASSEMBLY, SOLDERLESS LED SOCKET TYPE CM	
TOLERANCES UNLESS OTHERWISE SPECIFIED: 0 PLC ± 1 PLC ± 2 PLC ±0.13 3 PLC ± 4 PLC ± ANGLES ±2° FINISH		APVD -	PRODUCT SPEC 108-2439	RESTRICTED TO -
MATERIAL -		APPLICATION SPEC 114-13281	SIZE A200779	DRAWING NO C-2106946
-		WEIGHT -	SCALE 4:1	SHEET 6 OF 9 REV 5
-		CUSTOMER DRAWING	-	

THIS DRAWING IS UNPUBLISHED. RELEASED FOR PUBLICATION 20  
 © COPYRIGHT 20 BY TYCO ELECTRONICS CORPORATION. ALL INTERNATIONAL RIGHTS RESERVED.

LOC		DIST		REVISIONS			
P	LTR	DESCRIPTION	DATE	DWN	APVD		
-	-	SEE SHEET 1	-	-	-		

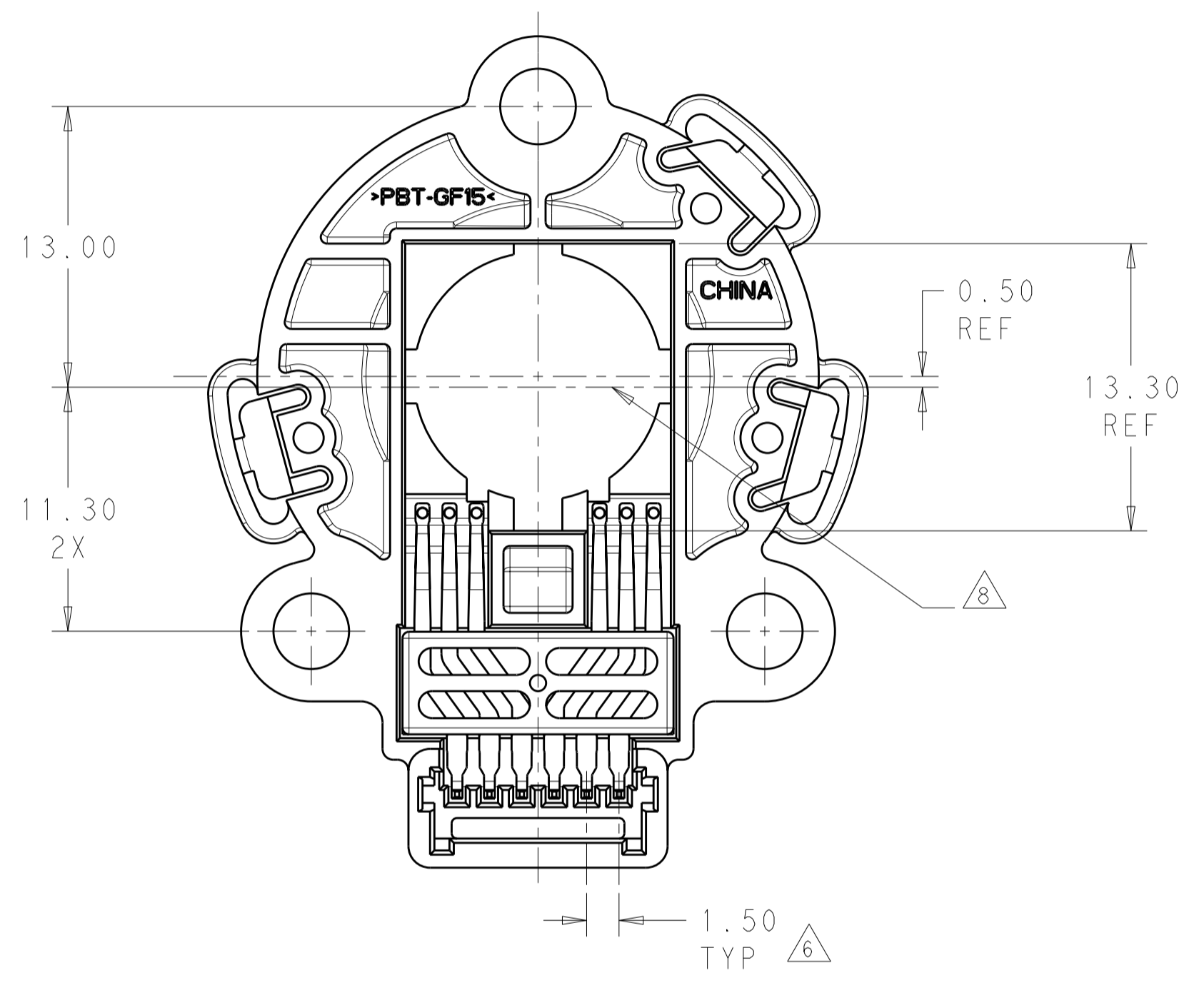
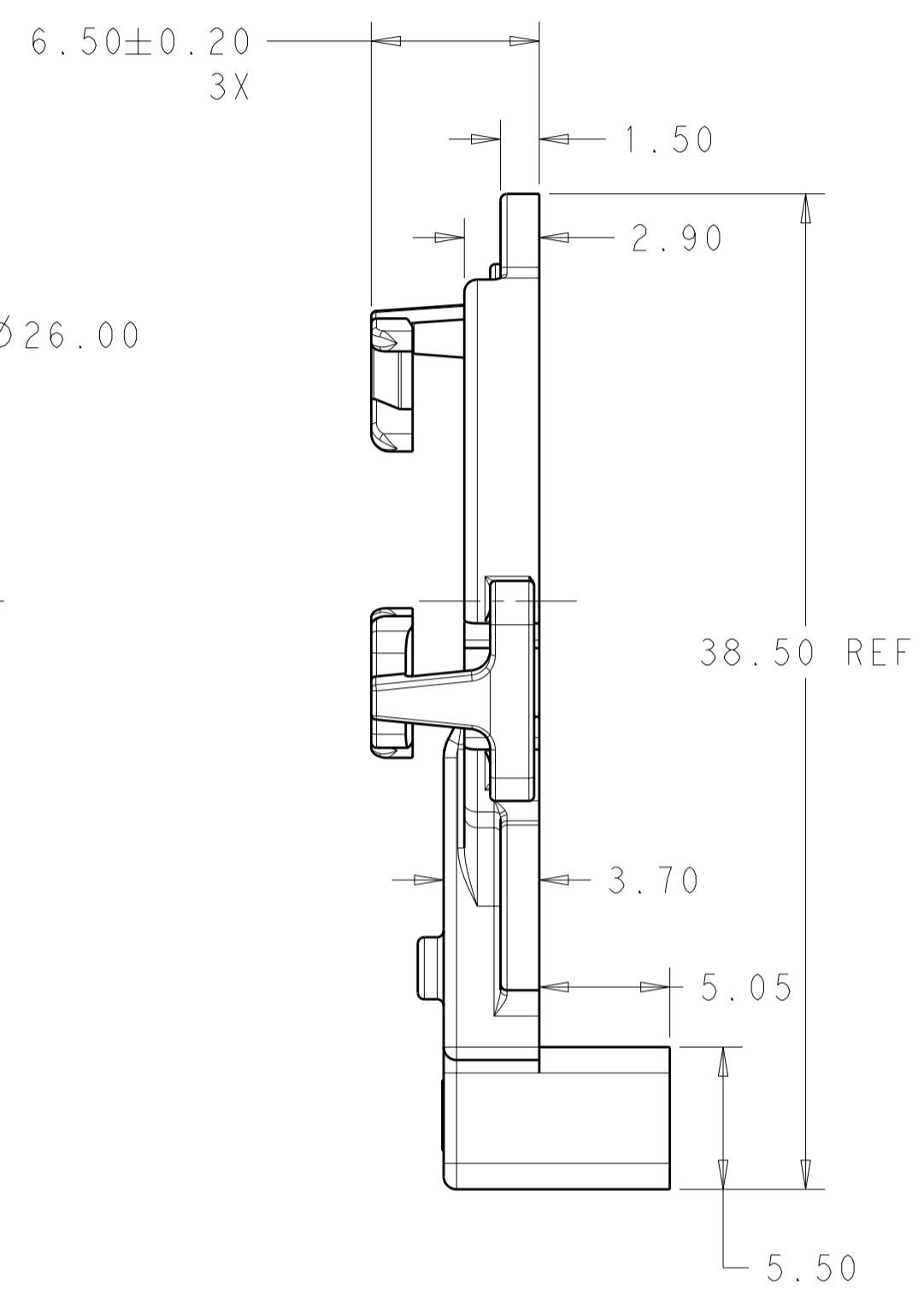
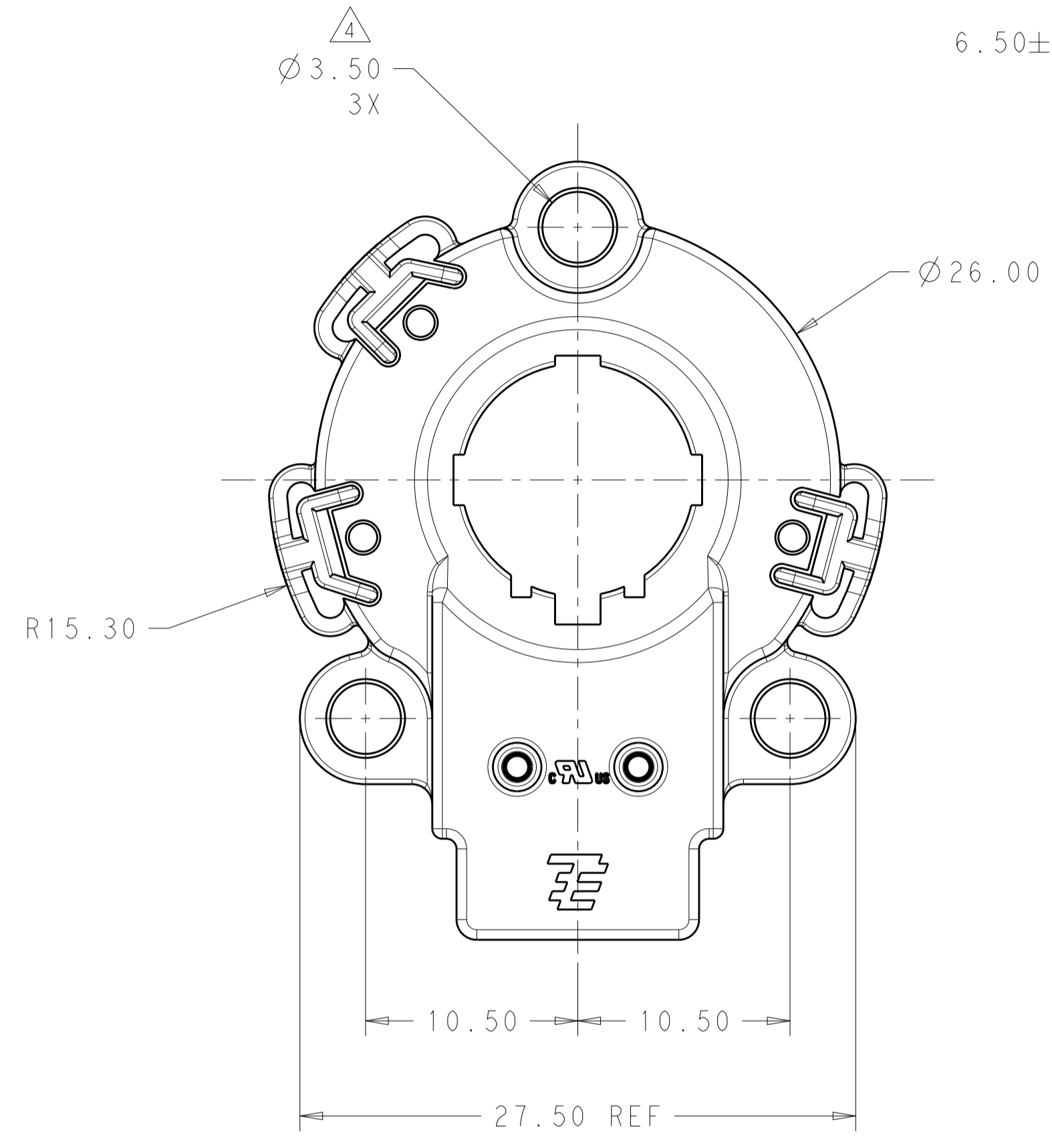

TYCO ELECTRONICS  
 CONFIDENTIAL  
 AND PROPRIETARY

PROPOSED DESIGN  
 NOT PRODUCTION TOOLED

DESIGN IS SUBJECT TO  
 CHANGE WITHOUT NOTICE

2106946-6 SHOWN

THIS DRAWING IS A CONTROLLED DOCUMENT FOR TYCO ELECTRONICS CORPORATION. IT IS SUBJECT TO CHANGE AND THE CONTROLLING ENGINEERING ORGANIZATION SHOULD BE CONTACTED FOR THE LATEST REVISION.		DWN ARJUN 17MAR2010	Tyco Electronics Corporation Harrisburg, PA 17105-3608	
DIMENSIONS: mm		CHK R. NARANG 26MAR2010	NAME ASSEMBLY, SOLDERLESS LED SOCKET TYPE CM	
TOLERANCES UNLESS OTHERWISE SPECIFIED: 0 PLC ±- 1 PLC ±- 2 PLC ±0.13 3 PLC ±- 4 PLC ±- ANGLES ±2° FINISH		APVD -	PRODUCT SPEC 108-2439	RESTRICTED TO -
MATERIAL -		APPLICATION SPEC 114-13281	SIZE A200779	DRAWING NO C-2106946
		WEIGHT -	SCALE 4:1	SHEET 7 OF 9 REV 5
		CUSTOMER DRAWING		

THIS DRAWING IS UNPUBLISHED. RELEASED FOR PUBLICATION 20  
 © COPYRIGHT 20 BY TYCO ELECTRONICS CORPORATION. ALL INTERNATIONAL RIGHTS RESERVED.

LOC		DIST		REVISIONS				
P	LTR	DESCRIPTION	DATE	DWN	APVD			
-	-	SEE SHEET 1	-	-	-			

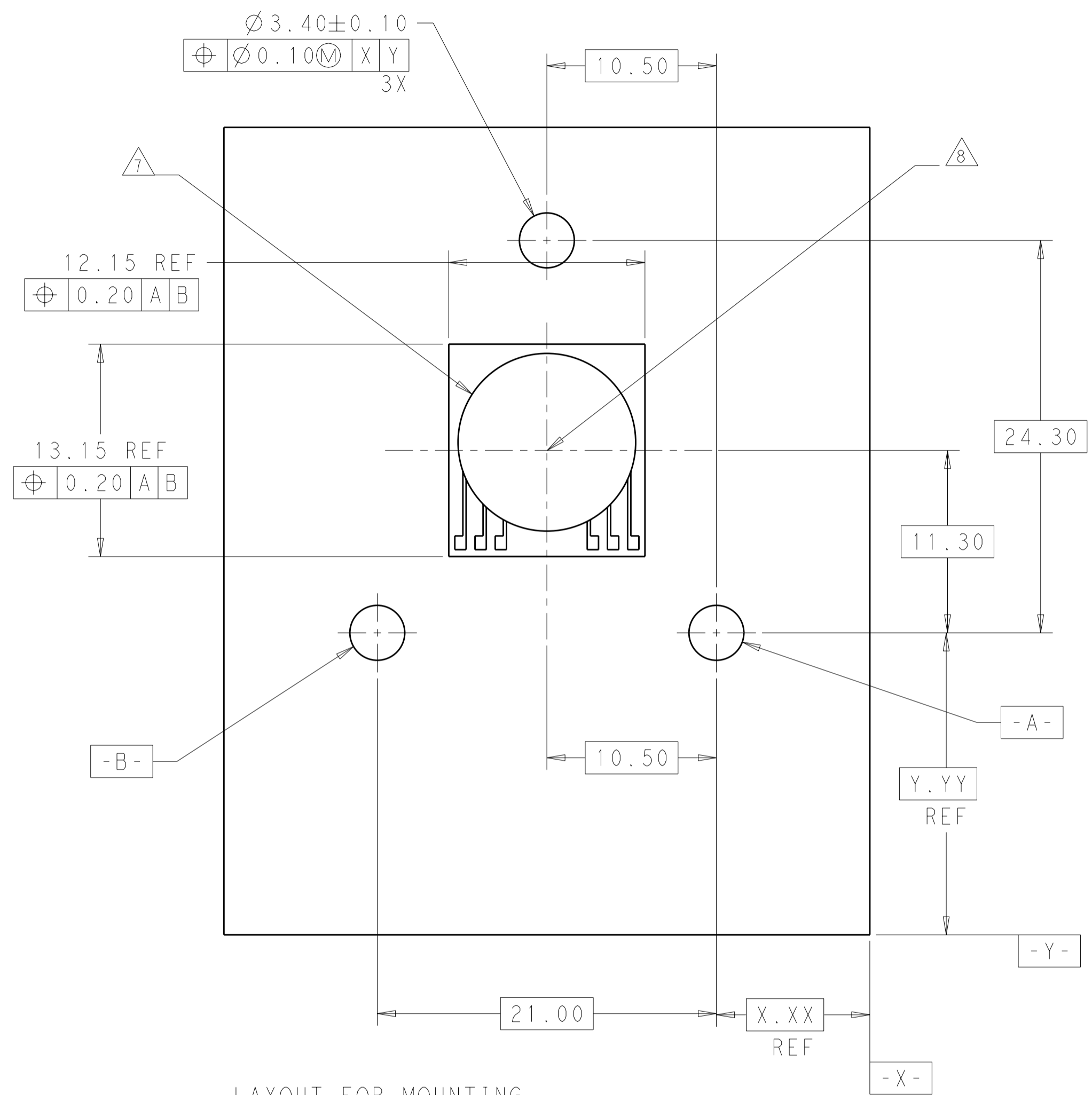

LAYOUT FOR MOUNTING  
 2106946-1 AND 2106946-2  
 ON A PC BOARD

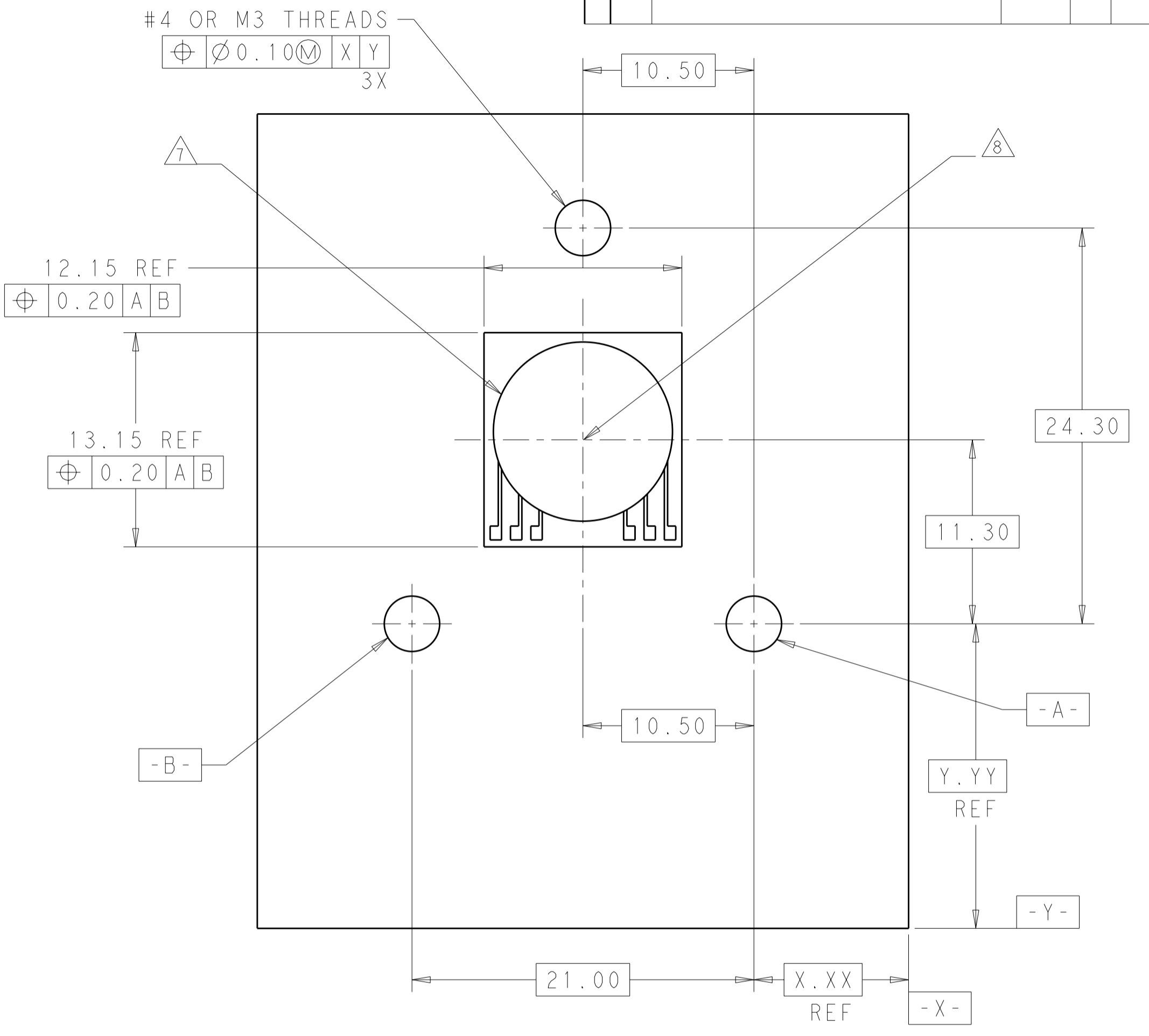

LAYOUT FOR MOUNTING  
 2106946-1 AND 2106946-2  
 ON A HEAT SINK

TYCO ELECTRONICS  
 CONFIDENTIAL  
 AND PROPRIETARY

PROPOSED DESIGN  
 NOT PRODUCTION TOOLED

DESIGN IS SUBJECT TO  
 CHANGE WITHOUT NOTICE

THIS DRAWING IS A CONTROLLED DOCUMENT FOR TYCO ELECTRONICS CORPORATION IT IS SUBJECT TO CHANGE AND THE CONTROLLING ENGINEERING ORGANIZATION SHOULD BE CONTACTED FOR THE LATEST REVISION.		DWN ARJUN 17MAR2010	Tyco Electronics Corporation Harrisburg, PA 17105-3608	
DIMENSIONS: mm		CHK R. NARANG 26MAR2010	NAME ASSEMBLY, SOLDERLESS LED SOCKET TYPE CM	
TOLERANCES UNLESS OTHERWISE SPECIFIED: 0 PLC ± 1 PLC ± 2 PLC ±0.13 3 PLC ± 4 PLC ± ANGLES ±2° FINISH		APVD -	PRODUCT SPEC 108-2439	RESTRICTED TO -
MATERIAL -		APPLICATION SPEC 114-13281	SIZE A200779	DRAWING NO C-2106946
		WEIGHT -	SCALE 4:1	SHEET 8 OF 9
		CUSTOMER DRAWING	REV 5	



THIS DRAWING IS UNPUBLISHED. RELEASED FOR PUBLICATION 20  
 © COPYRIGHT 20 BY TYCO ELECTRONICS CORPORATION. ALL INTERNATIONAL RIGHTS RESERVED.

LOC	DIST	REVISIONS			
P	LTR	DESCRIPTION	DATE	DWN	APVD
-	-	SEE SHEET 1	-	-	-

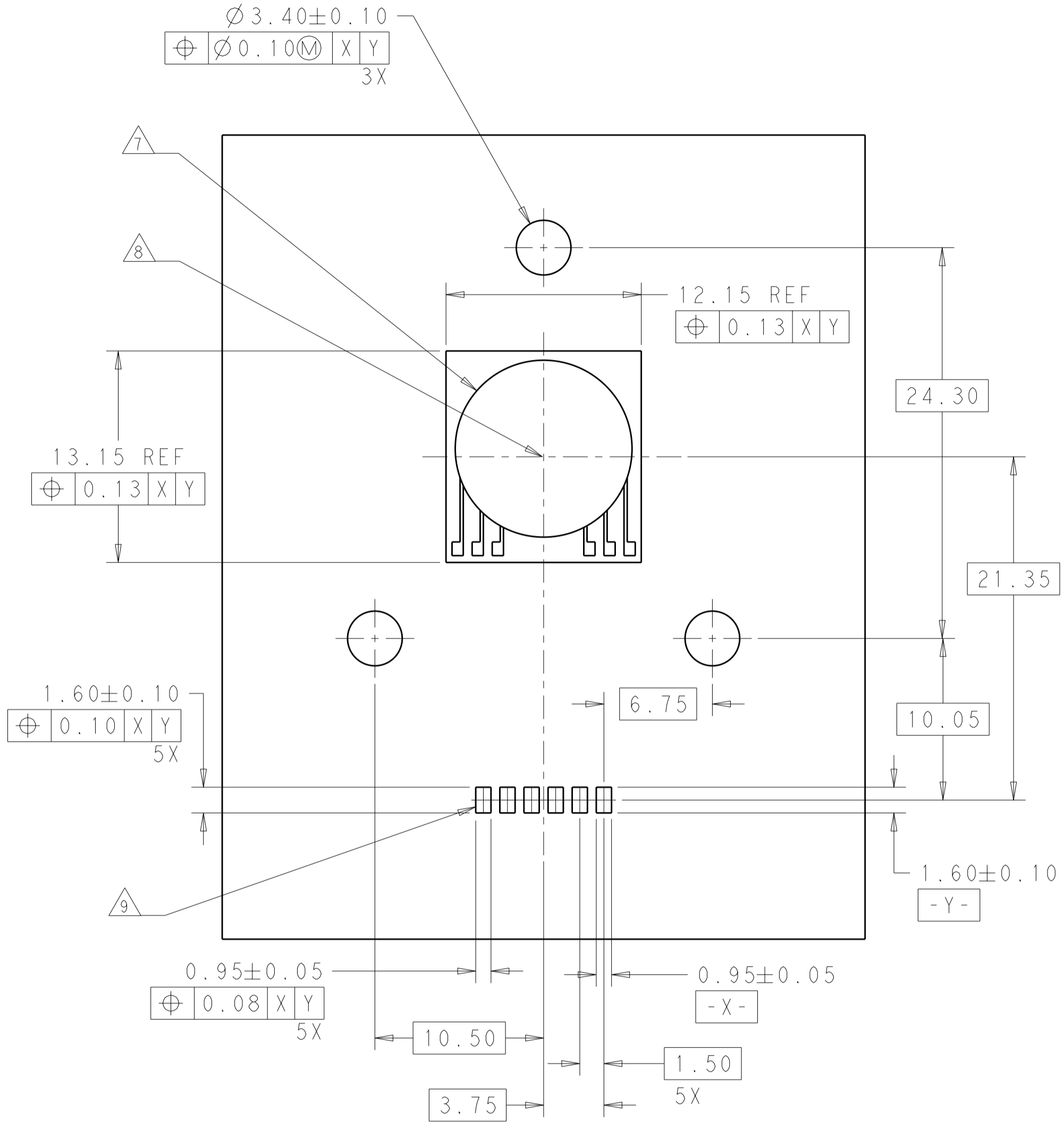

LAYOUT FOR MOUNTING  
 2106946-3 AND 2106946-4  
 ON A PC BOARD

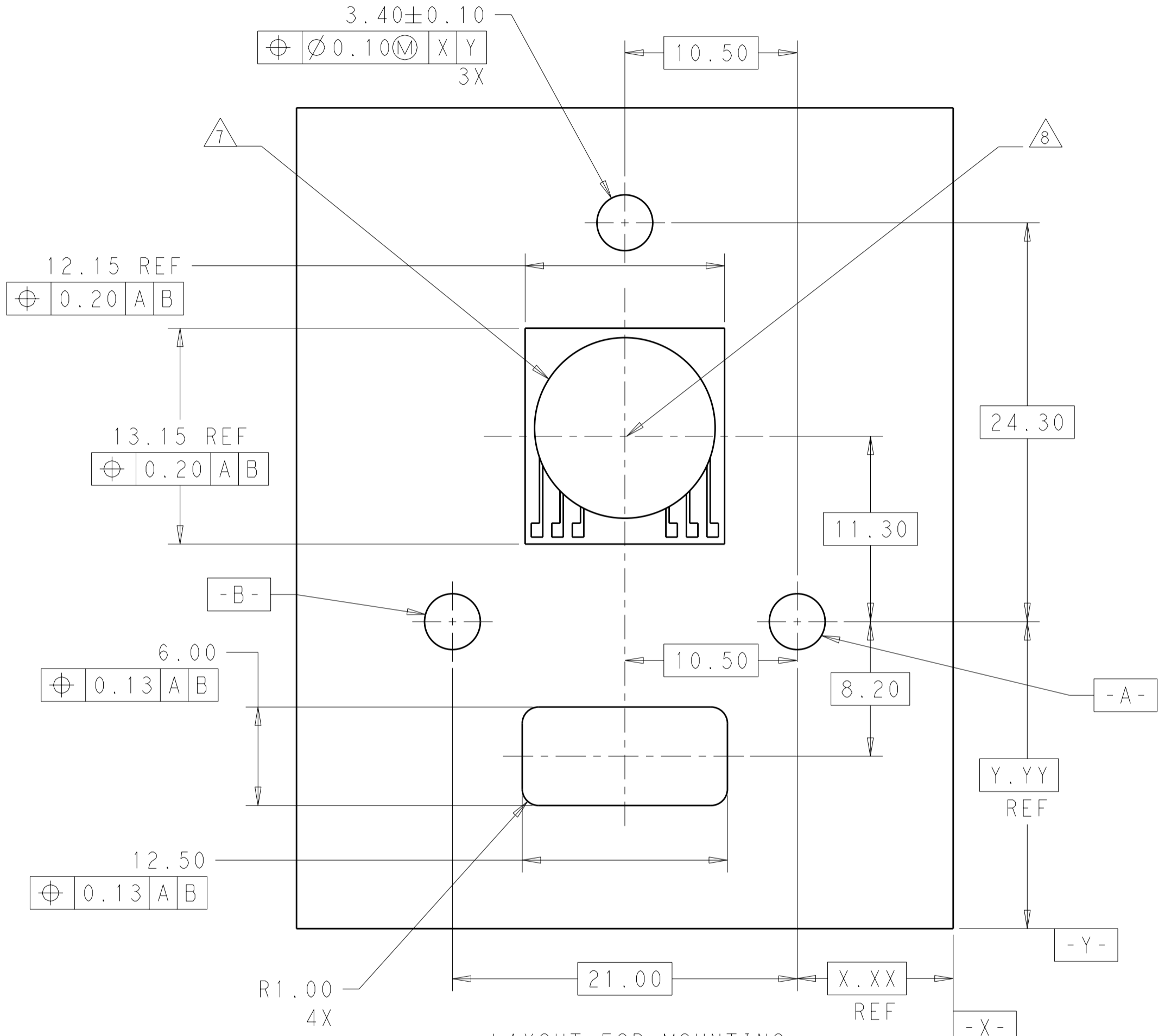

LAYOUT FOR MOUNTING  
 2106946-5 AND 2106946-6

TYCO ELECTRONICS  
 CONFIDENTIAL  
 AND PROPRIETARY

PROPOSED DESIGN  
 NOT PRODUCTION TOOLED

DESIGN IS SUBJECT TO  
 CHANGE WITHOUT NOTICE

THIS DRAWING IS A CONTROLLED DOCUMENT FOR TYCO ELECTRONICS CORPORATION. IT IS SUBJECT TO CHANGE AND THE CONTROLLING ENGINEERING ORGANIZATION SHOULD BE CONTACTED FOR THE LATEST REVISION.		DWN ARJUN 17MAR2010	Tyco Electronics Corporation Harrisburg, PA 17105-3608	
		CHK R. NARANG 26MAR2010	NAME ASSEMBLY, SOLDERLESS LED SOCKET TYPE CM	
DIMENSIONS: mm		APVD -	SIZE A200779	
TOLERANCES UNLESS OTHERWISE SPECIFIED: 0 PLC ± 1 PLC ± 2 PLC ±0.13 3 PLC ± 4 PLC ± ANGLES ±2° FINISH		PRODUCT SPEC 108-2439	DRAWING NO C-2106946	
MATERIAL -		APPLICATION SPEC 114-13281	RESTRICTED TO -	
		WEIGHT -	SCALE 4:1 SHEET 9 OF 9 REV 5	
		CUSTOMER DRAWING		