



ACCESSORI per TWS - BABY - OVOLUX

BASETTA - con O-Ring e guarnizione di base



PA 6.6

TWS BS

■ TWSBS 27760 RS 411-0381

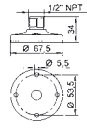

Kg. 0,03

PROLUNGA (h. 10 cm. - sovrapponibile) - con O-Ring e due guance a scatto amovibili



PA 6.6

TWS PR

■ TWSPR 27761 RS 411-0397

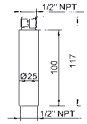

Kg. 0,03

BASE A PARETE 1 FILETTO - con O-Ring e guarnizione di base

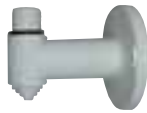

PA 6.6

TWS BP 1

■ TWSBP1 27762 RS 411-0410

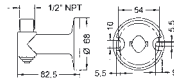

Kg. 0,04

BASE A PARETE 2 FILETTI - con O-Ring e guarnizione di base



PA 6.6

TWS BP 2

■ TWSBP2 27763 RS 411-0426

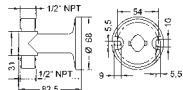

Kg. 0,05

1 PR + 1 BS - con O-Ring, guarnizione di base e due guance a scatto amovibili

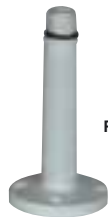

PA 6.6

TWS KIT

■ TWSKIT 27764 RS 411-0432

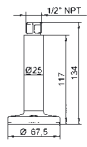

Kg. 0,06

PROLUNGA FLESSIBILE ACCIAIO



N TWS PF2



Kg. 0,26

■ NTWSPF2 27696 RS 411-0448

BOX DI GIUNZIONE

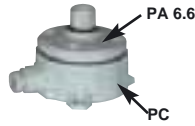

PA 6.6

PC

TWS BOX PG9

■ TWSBOXPG9 27777 RS 411-0460

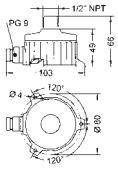

Kg. 0,1

PROLUNGA ACCIAIO INOX (h. 400 mm) con O-Ring



TWS KIT INOX L/400

■ TWSKITINOXL400 27767 RS 411-0498

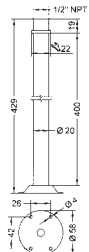

Kg. 0,28

PROLUNGA ACCIAIO INOX (h. 200 mm) con O-Ring



TWS KIT INOX L/200

■ TWSKITINOXL200 27766 RS 411-0482

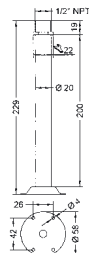

Kg. 0,18

PROLUNGA ACCIAIO INOX (h. 100 mm) con O-Ring



TWS KIT INOX L/100

■ TWSKITINOXL100 27765 RS 411-0476 Kg. 0,14

