

## Housing - HC-B 16-SMLD-67/O2PG21 - 1673724

Please be informed that the data shown in this PDF Document is generated from our Online Catalog. Please find the complete data in the user's documentation. Our General Terms of Use for Downloads are valid (<http://phoenixcontact.com/download>)



Box mounting base, with single locking latch, height 67 mm, with a support 2x Pg21, with a protective cover



### Key Commercial Data

Packing unit	10 pc
GTIN	 4 017918 152475
Weight per Piece (excluding packing)	427.0 g
Custom tariff number	85389099
Country of origin	Germany
Note	Made to Order (non-returnable)

### Technical data

#### Dimensions

Height	67 mm
Width	57 mm
Length	117 mm

#### Ambient conditions

Degree of protection of housing (IP)	IP65 (When plugged in)
	IP54 (mit geschlossenem Schutzdeckel)
Ambient temperature (operation)	-40 °C ... 125 °C

#### General

Note	For contact inserts HC-B16, BB32, BBB40, D40, DD72, HS6, M, K
Type	B16
Housing type	Box mounting bases
Locking type	With single locking latch
No. of cable outlets	2
Cable exit	Lateral
Screw connection	none

# Housing - HC-B 16-SMLD-67/O2PG21 - 1673724

## Technical data

### General

Type of the screw connection	2x Pg21
Protective cover	Yes
Housing material	Aluminum die-cast
Housing surface material	Powder-coated, gray
Seal material	NBR
Material lock	Stainless steel, handle: PA
Material grip body interlock	PA
Material, protective cover	Polyamide

## Classifications

### eCl@ss

eCl@ss 4.0	27140816
eCl@ss 4.1	27140816
eCl@ss 5.0	27143424
eCl@ss 5.1	27143424
eCl@ss 6.0	27143424
eCl@ss 7.0	27440209
eCl@ss 8.0	27440202

### ETIM

ETIM 2.0	EC000437
ETIM 3.0	EC000437
ETIM 4.0	EC000437
ETIM 5.0	EC000437

### UNSPSC

UNSPSC 6.01	31261502
UNSPSC 7.0901	31261502
UNSPSC 11	31261502
UNSPSC 12.01	31261502
UNSPSC 13.2	31261502

## Approvals

### Approvals

---

Approvals

EAC

---

# Housing - HC-B 16-SMLD-67/O2PG21 - 1673724

## Approvals

Ex Approvals

---

Approvals submitted

---

Approval details

EAC
-----

## Drawings

Dimensional drawing

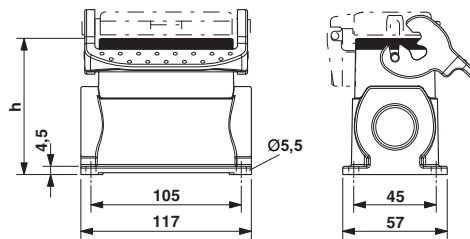

Dimensional drawing; h = 67 mm