



FAG

SES520-617-L [↗](#)

Plummer block housing

Split plummer block housing for various bearing designs. The SNV series will be replaced by the new SES series in 2022.

Technical information

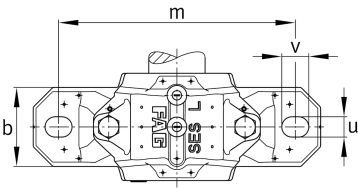

Main Dimensions & Performance Data

D	180 mm	Outside diameter bearing
a	380 mm	Length base
h ₁	218 mm	Height
g	160 mm	Width housing body
K	70 mm	Width bearing seat
≈m	17.1 kg	Weight

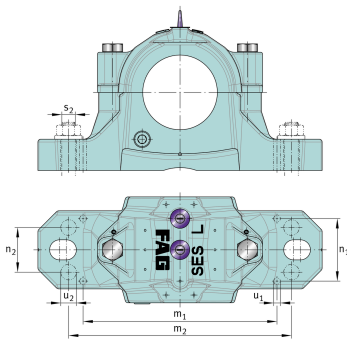
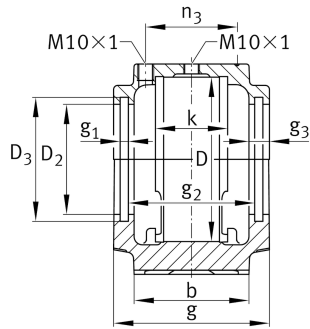
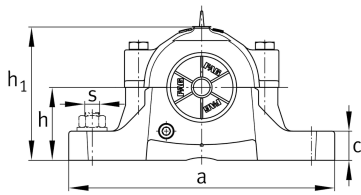

Dimensions

b	110 mm	Width base
c	40 mm	Height base
h	112 mm	Base to shaft centerline height
m	320 mm	Distance fixing bore
s	22.225 mm	Screw size
s	M24	Size of fixing screws
u	26 mm	Width slot
v	32 mm	Length slot
D 2	137.5 mm	Diameter sealing
D 3	147.5 mm	Diameter sealing groove
D 5	144.7 mm	Outside diameter sealing labyrinth
g 1	6 mm	Width sealing groove
g 2	140 mm	Distance sealing
g 3	14 mm	Wall thickness
g 4	37 mm	Distance oil lubrication
m 1	270 mm	Distance holes aligned pins m1
n 3	99 mm	Distance lubrication
n 4	145 mm	Distance lubrication sealing
u 1	8 mm	Bore diameter u1
u 2	18 mm	Bore diameter u2