

Pin Strips

PST 1,0/...-3,5 with a 3.5 mm Pitch and PST 1,3/...-5,0 with a 5.0 mm Pitch

The PST 1,0/...-3,5 and PST 1,3/...-5,0 pin strips, as appropriate base strips, represent a logical supplement to the plug-in solutions of the COMBICON compact range. They are compatible with conventional pin strips and, made of high-temperature resistant material, they are ideal for use in the reflow solder process (THR). Both pin strips are also available in bar magazines on request.

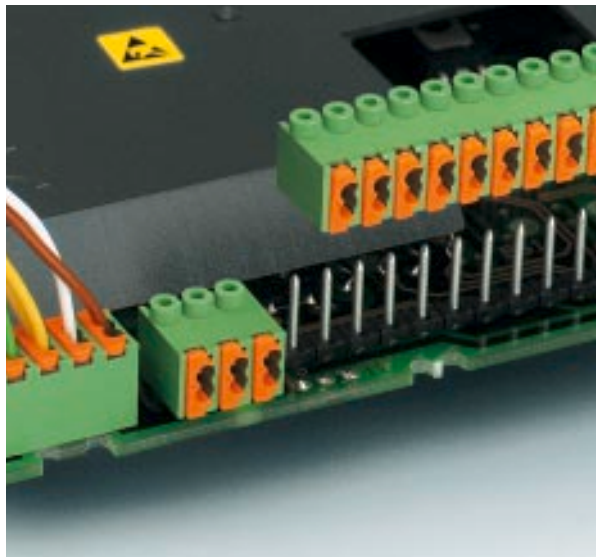

COMBICON Select

The COMBICON search engine with CAD downloading



COMBICON Select – the printed circuit board connection software supports your workflow from the PCB and housing layout to the ordering process with:

- Systematic and fast selection of products
- Universal Internet aided engineering with extensive CAD downloading
- Easy-to-use e-shopping functions.

<http://select.phoenixcontact.com>

Pin Strip PST 1,0/...-3,5 3.5 mm Pitch



Description	No. of pos.	Dim. a [mm]	Type	Order No.	Pcs./Pkt.
Pin strip, 3.5 mm pitch, color: black					
	2	3.5	PST 1,0/2-3,5	19 45 09 6	50
	3	7	PST 1,0/3-3,5	19 45 10 6	
	4	10.5	PST 1,0/4-3,5	19 45 11 9	
	5	14	PST 1,0/5-3,5	19 45 12 2	
	6	17.5	PST 1,0/6-3,5	19 45 13 5	
	7	21	PST 1,0/7-3,5	19 45 14 8	
	8	24.5	PST 1,0/8-3,5	19 45 15 1	
	9	28	PST 1,0/9-3,5	19 45 16 4	
	10	31.5	PST 1,0/10-3,5	19 45 17 7	
	11	35	PST 1,0/11-3,5	19 45 18 0	
	12	38.5	PST 1,0/12-3,5	19 45 19 3	
	13	42	PST 1,0/13-3,5	19 45 20 3	
	14	45.5	PST 1,0/14-3,5	19 45 21 6	
	15	49	PST 1,0/15-3,5	19 45 22 9	
	16	52.5	PST 1,0/16-3,5	19 45 23 2	

Technical data

Dimensions	
Pitch	[mm]
Hole diameter	[mm]
Pin dimensions	[mm]x[mm]

see description

3.5

1.2

∅ 1

Technical data in accordance with IEC/ DIN VDE

Insulating material group	-
Surge voltage category / contamination class	-/-
Rated voltage	[V]
Rated surge voltage	[kV]
Nominal current / cross section	[A]
Maximum load current / cross section	[A]

	IIIa	III / 2	II / 2
	160	250	250
	2.5	2.5	2.5

Insulating material

Inflammability class in acc. with UL 94

PA

V0

Approval data (UL/CUL and CSA)

Nominal voltage / current / conductor sizes	UL/CUL: [V]/[A]/AWG
	CSA: [V]/[A]/AWG

applied for
applied for

1) The maximum current depends on the plug used. The lower value of the two for plug and pin strip is the deciding factor.

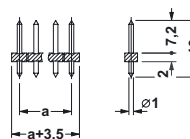
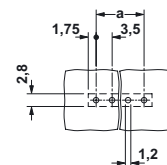

Pin Strip
PST 1,3/...-5,0
5.0 mm Pitch

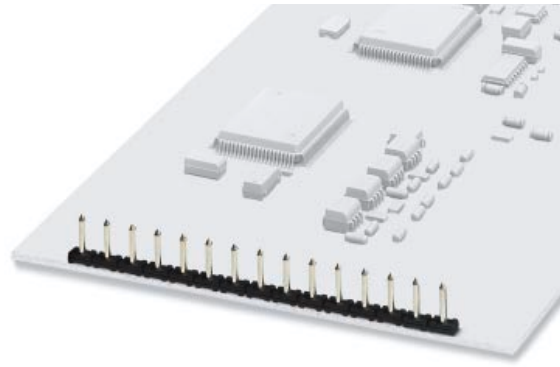

Description	No. of pos.	Dim. a [mm]	Type	Order No.	Pcs./Pkt.
Pin strip, 5.0 mm pitch, color: black	2	5	PST 1,3/2-5,0	19 33 18 9	50
	3	10	PST 1,3/3-5,0	19 33 19 2	
	4	15	PST 1,3/4-5,0	19 33 20 2	
	5	20	PST 1,3/5-5,0	19 33 21 5	
	6	25	PST 1,3/6-5,0	19 33 22 8	
	7	30	PST 1,3/7-5,0	19 33 23 1	
	8	35	PST 1,3/8-5,0	19 33 24 4	
	9	40	PST 1,3/9-5,0	19 33 25 7	
	10	45	PST 1,3/10-5,0	19 33 26 0	
	11	50	PST 1,3/11-5,0	19 33 27 3	
	12	55	PST 1,3/12-5,0	19 33 28 6	
	13	60	PST 1,3/13-5,0	19 33 29 9	
	14	65	PST 1,3/14-5,0	19 33 30 9	
	15	70	PST 1,3/15-5,0	19 33 31 2	
	16	75	PST 1,3/16-5,0	19 33 32 5	

Technical data				
Dimensions		see description		
Pitch	[mm]	5.0		
Hole diameter	[mm]	1.5		
Pin dimensions	[mm]x[mm]	Ø 1.3		
Technical data in accordance with IEC/ DIN VDE				
Insulating material group	-		IIIa	
Surge voltage category / contamination class	-/-	III / 3	III / 2	II / 2
Rated voltage	[V]	250	400	400
Rated surge voltage	[kV]	4	4	4
Nominal current / cross section	[A]		10 ¹⁾	
Maximum load current / cross section	[A]		10 ¹⁾	
Insulating material		PA		
Inflammability class in acc. with UL 94		V0		
Approval data (UL/CUL and CSA)				
Nominal voltage / current / conductor sizes	UL/CUL: [V]/[A]/AWG CSA: [V]/[A]/AWG	applied for applied for		

¹⁾ The maximum current depends on the plug used. The lower value of the two for plug and pin strip is the deciding factor.

