

supply manifold
PAL-1/2-6
Part number: 9496

FESTO

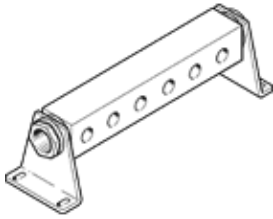

Data sheet

Feature	Value
Assembly position	Any
Max. number of valve positions	6
Product weight	1,370 g
Mounting type	With mounting bracket
Pneumatic connection, port 1	G3/4
Materials note	Conforms to RoHS
Material of connecting plate	Aluminium Anodised