

3-PHASE LINE-SIDE TERMINAL, F. 3-PHASE  
BUSBAR, CONNECTION FROM ABOVE

General technical data:		
product brand name		SIRIUS
Product designation		Three-phase feeder terminal
Design of the product		Size S2
Size of the circuit-breaker		S2
Protection class IP on the front		IP20
Insulation voltage with degree of pollution 3 Rated value	V	690
Ambient temperature		
• during storage	°C	-50 ... +80
• during operation	°C	-20 ... +60
Ampacity maximum	A	108
Installation/ mounting/ dimensions:		
Width	mm	54
Height	mm	59
Depth	mm	44
Connections/ Terminals:		
Type of electrical connection for main current circuit		screw-type terminals
Type of connectable conductor cross-section		
• for main contacts		
— solid		1x (10 ... 50 mm <sup>2</sup> )
— stranded		1x (10 ... 50 mm <sup>2</sup> )
• for AWG conductors for main contacts		1x (8 ... 0)
Certificates/ approvals:		
Certificate of suitability		CE / UL / CSA / CCC

General Product Approval	Declaration of Conformity	Test Certificates	Shipping Approval
--------------------------	---------------------------	-------------------	-------------------



[spezielle Prüfbescheinigung](#)  
n



**other**

[Bestätigungen](#)

[Umweltbestätigung](#)



**Further information**

**Information- and Downloadcenter (Catalogs, Brochures,...)**

<http://www.siemens.com/industrial-controls/catalogs>

**Industry Mall (Online ordering system)**

<http://www.siemens.com/industrymall>

**Cax online generator**

<http://support.automation.siemens.com/WW/CAXorder/default.aspx?lang=en&mlfb=3RV19355A>

**Service&Support (Manuals, Certificates, Characteristics, FAQs,...)**

<https://support.industry.siemens.com/cs/ww/en/ps/3RV19355A>

**Image database (product images, 2D dimension drawings, 3D models, device circuit diagrams, EPLAN macros, ...)**

[http://www.automation.siemens.com/bilddb/cax\\_de.aspx?mlfb=3RV19355A&lang=en](http://www.automation.siemens.com/bilddb/cax_de.aspx?mlfb=3RV19355A&lang=en)

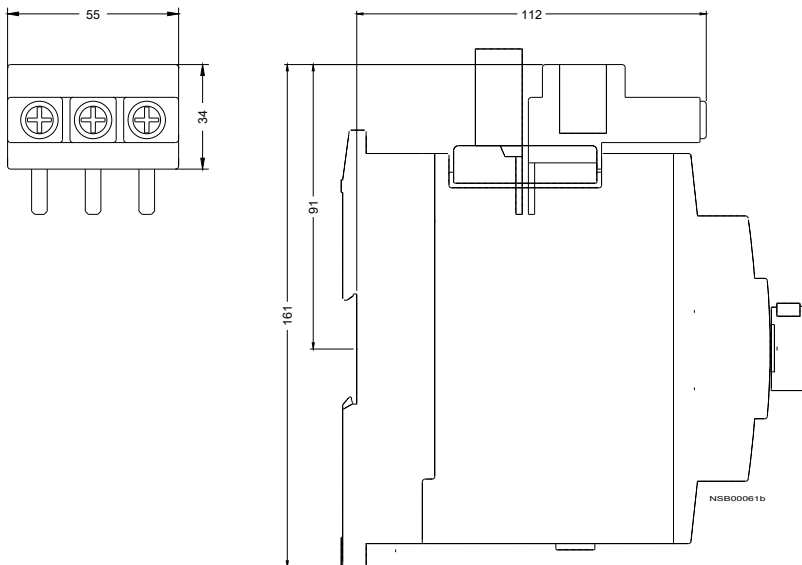

last modified:

20.07.2015