

DETAILS

Product Number	CN10861_IRIS
Family	Iris
Type	Pack
Color	black
Diameter	38 mm
Height	28.5 mm
Style	round
Optic Material	PMMA
Holder Material	PC
Fastening	screw, glue
Status	ready
ROHS Compliant	Yes
Date Updated	15/04/2015

OPTICAL PROPERTIES

LED	Viewing	Light	Effi-		Connector
	Angle	Beam	ciency	cd/lm	
Luxeon 5258	sim: 11	Spot	sim: 89 %	sim: 17.800	-
Z5M1/Z5M2	7 deg	Spot	83 %	40.400	-
XHP50	10 deg	Spot	87 %	11.100	-
Ostar Lighting	11 deg	Spot	90 %	sim: 0.000	-
MC-E	12 deg	Spot	90 %	17.500	-
LUXEON MZ	12 deg	Spot	82 %	15.840	-
Duris S10	15 deg	Spot	81 %	7.100	-
LUXEON M	16 deg	Spot	87 %	9.100	-
MHD-E/G	17 deg	Spot	91 %	5.700	-



Relative intensity of CN10861_IRIS_(Z5M1)

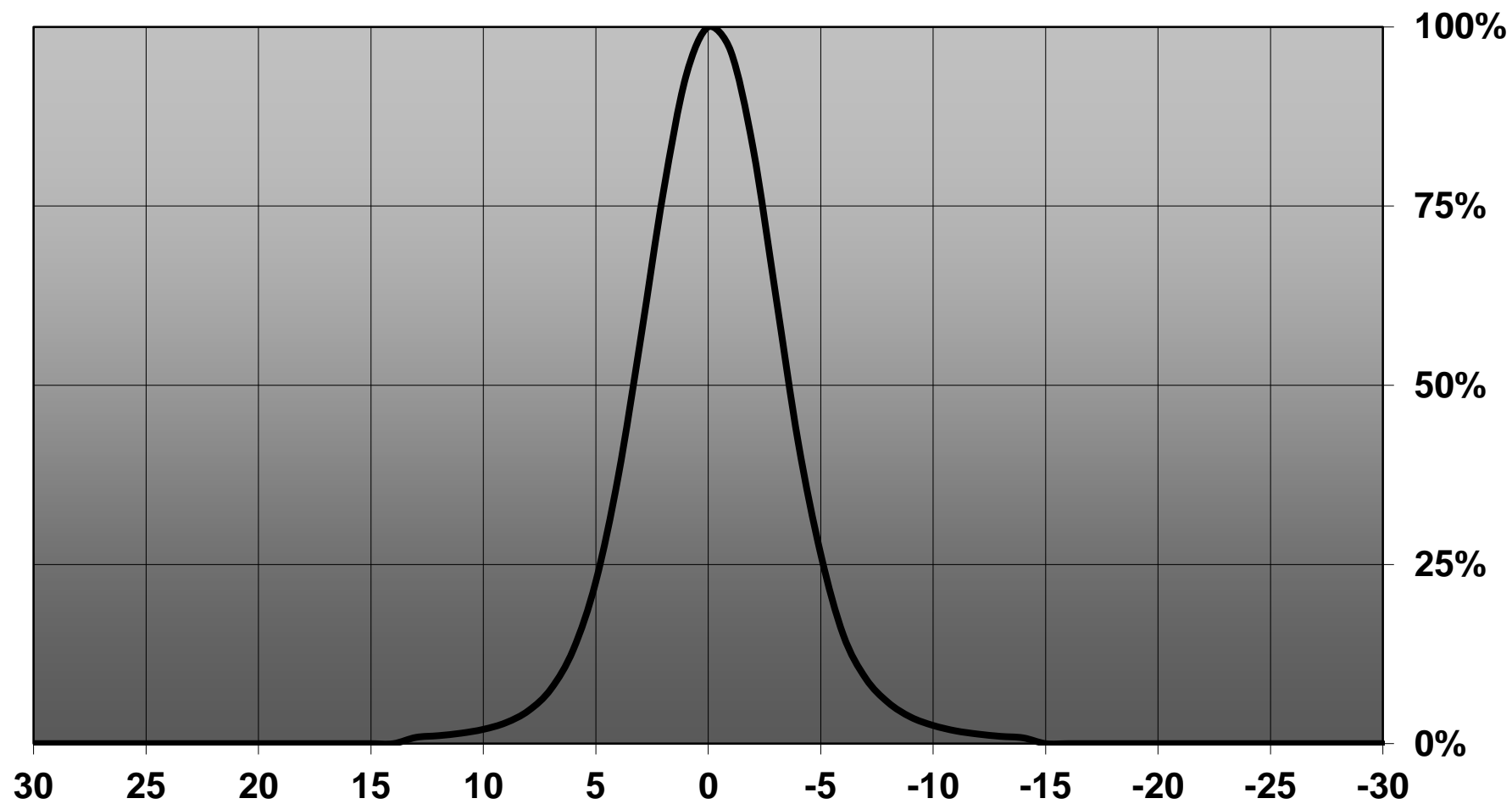

Relative intensity of CN10861_IRIS_(Duris_S10)

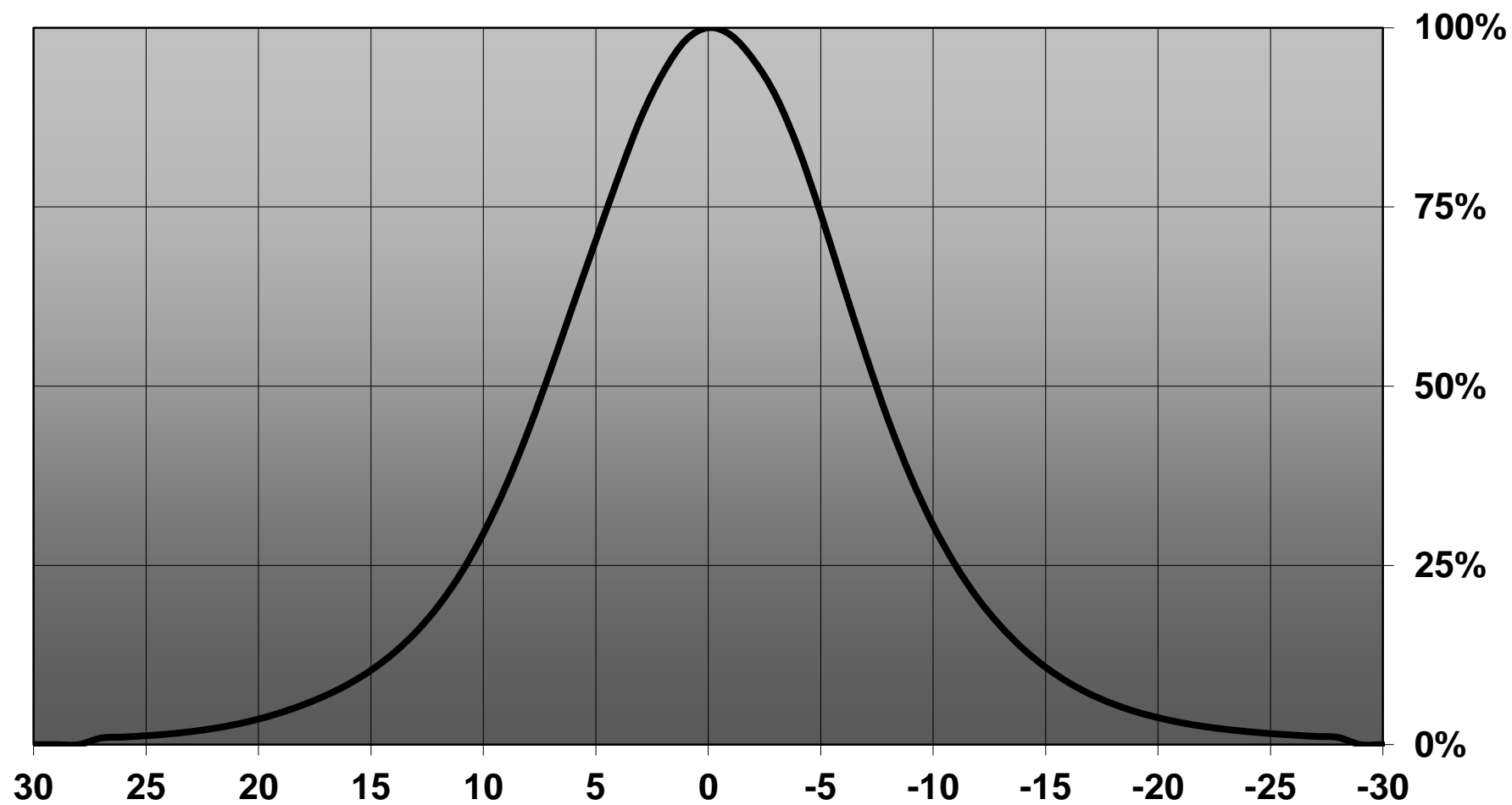

D C B A

4

4

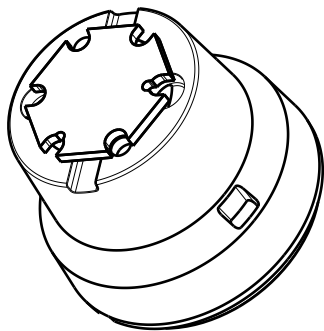

Isometric view

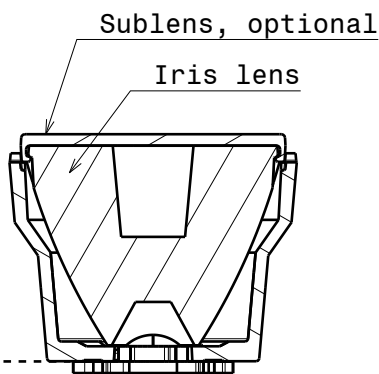

Section view A-A

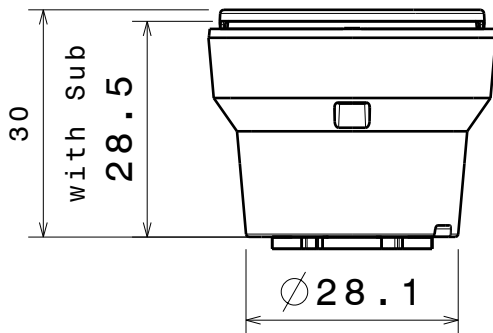

Front view

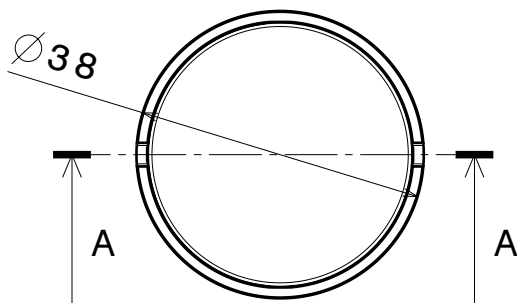

Top view

Materials:
Lens PMMA
Holder PC

3

2

2

This drawing is our property.
It can't be reproduced
or communicated without
our written agreement.



Ledil Oy
Salorankatu 10
FIN-24100 SALO
Finland

DRAWING TITLE

Datasheet Iris MC/ Ostar assy

DRAWN BY

DATE

a

13.4.2012

CHECKED BY

DATE

x

x

13.4.2012

SIZE

A4

DRAWING NUMBER

-

REV

1

DESIGNED BY

DATE

SCALE

1:1

WEIGHT (g)

SHEET

1/1

1

1

D

A

Luminaire: LEDiL Oy CN10861_IRIS_(CREE_XHP50_WARM_WHITE)

Lamps: 1 x CREE_XHP50_WARM_WHITE_195.088lm@250mA_P=1.40004W_I=0.2499A

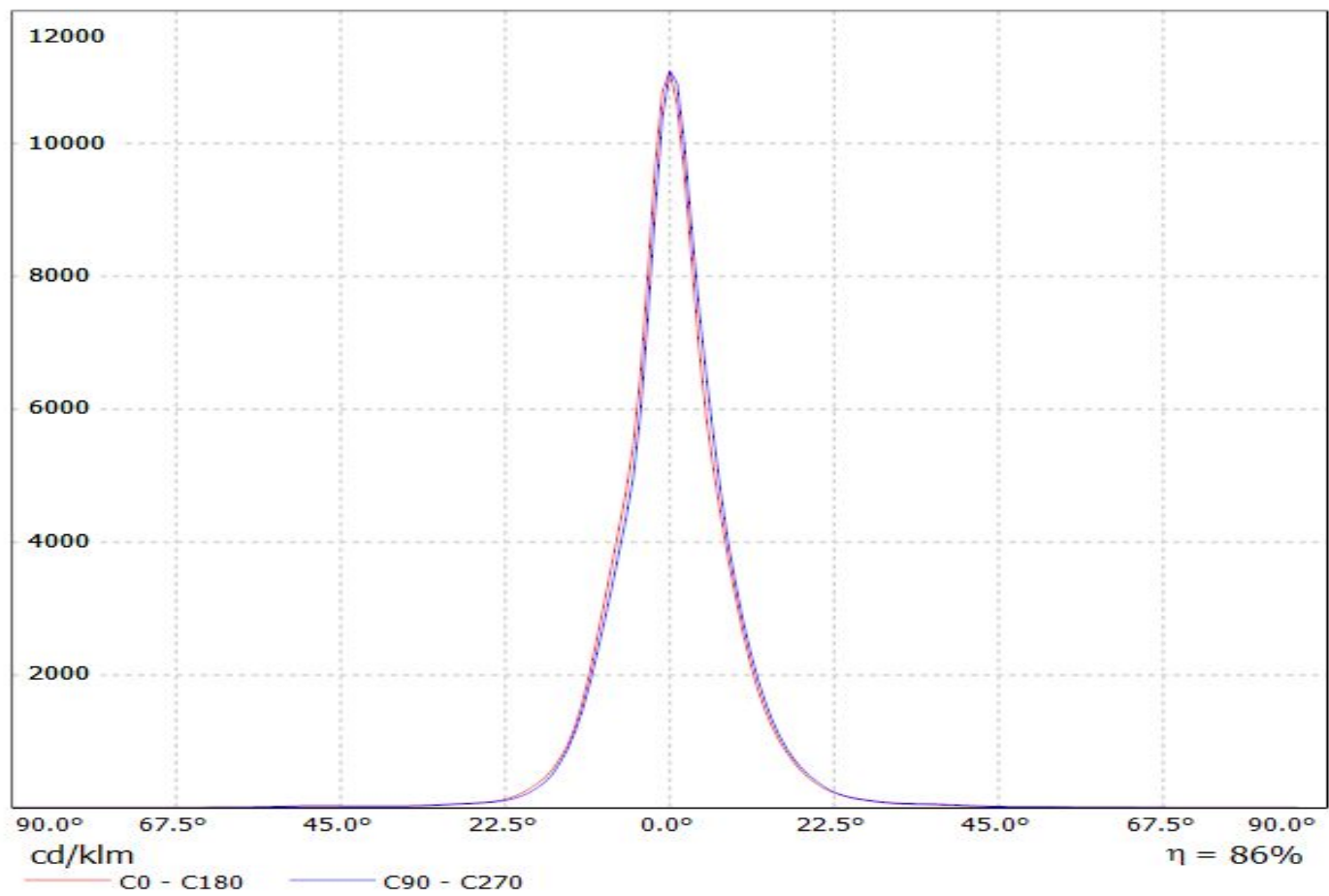

Luminaire: Ledil Oy CN10861_IRIS_(Luxeon MZ) Efficiency=82%
Lamps: 1 x Luxeon MZ 259.83lm @ 250mA CCT= P=2.75W I=250mA

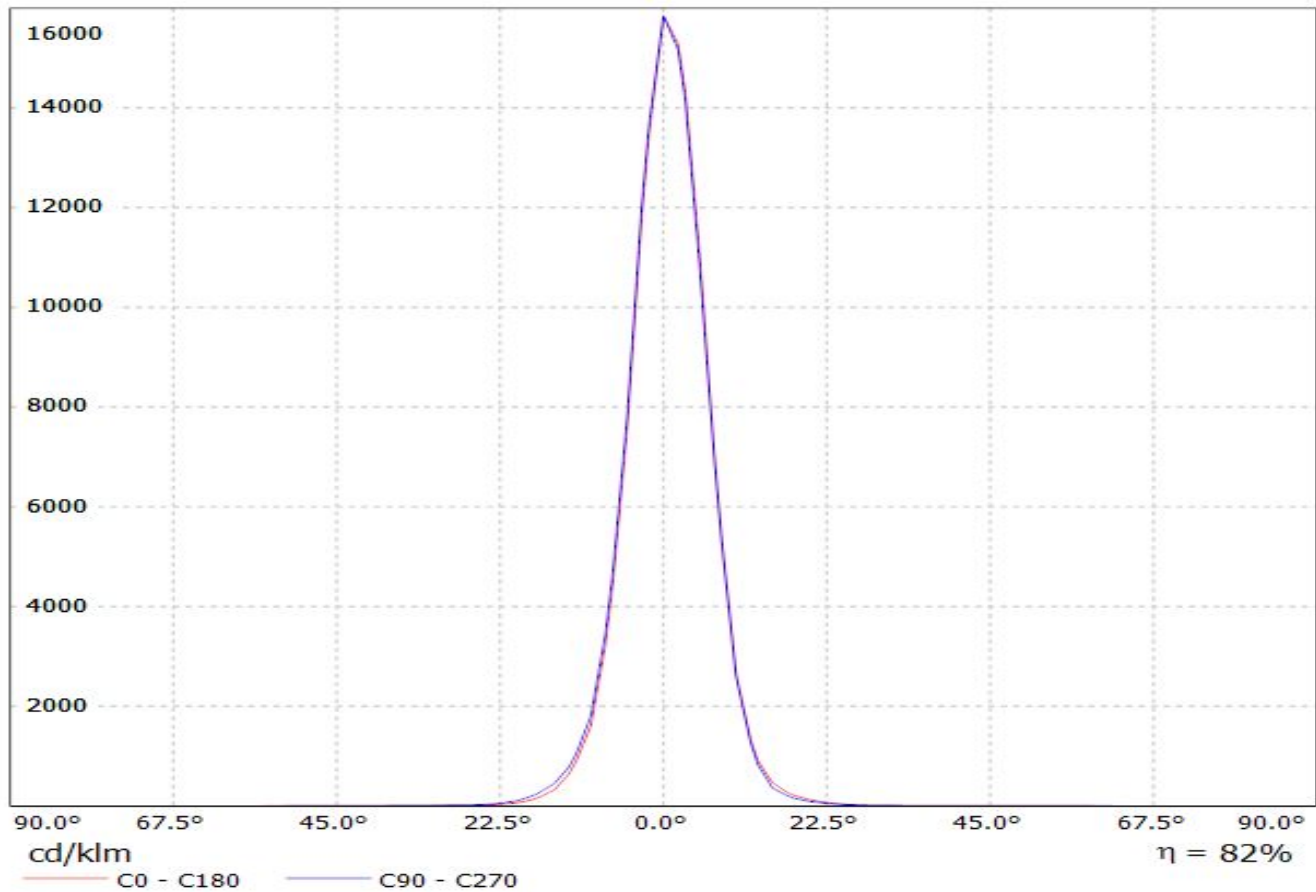

Luminaire: Ledil Oy CN10861-IRIS (Luxeon M 362lm @ 250mA) Efficiency=83%
Lamps: 1 x Luxeon M 362lm @ 250mA

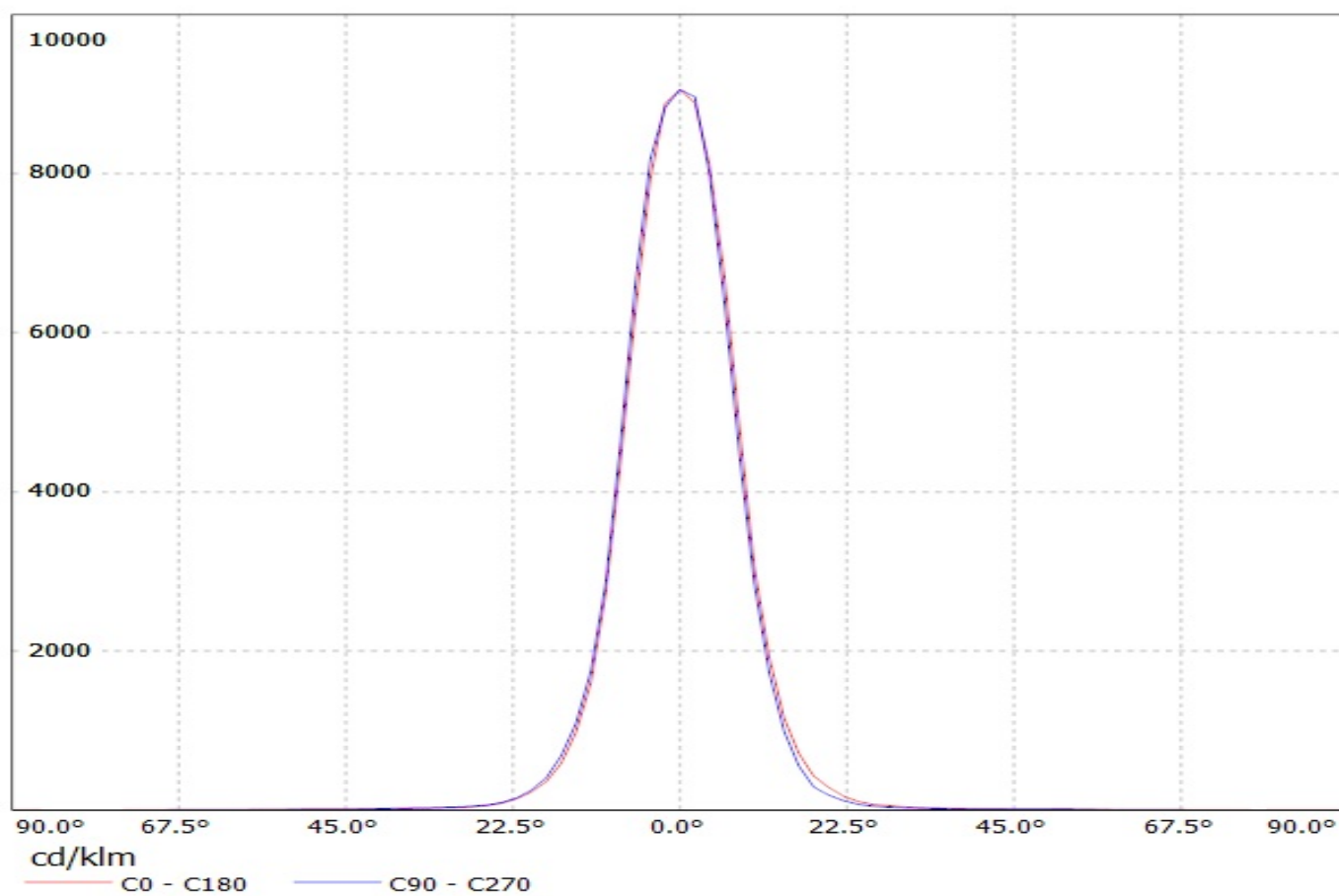

Luminaire: Ledil CN10861 IRIS_(MHD-G)
Lamps: 1 x MHD-G_528.91lm@100mA_P=3.0W_I=0.100A

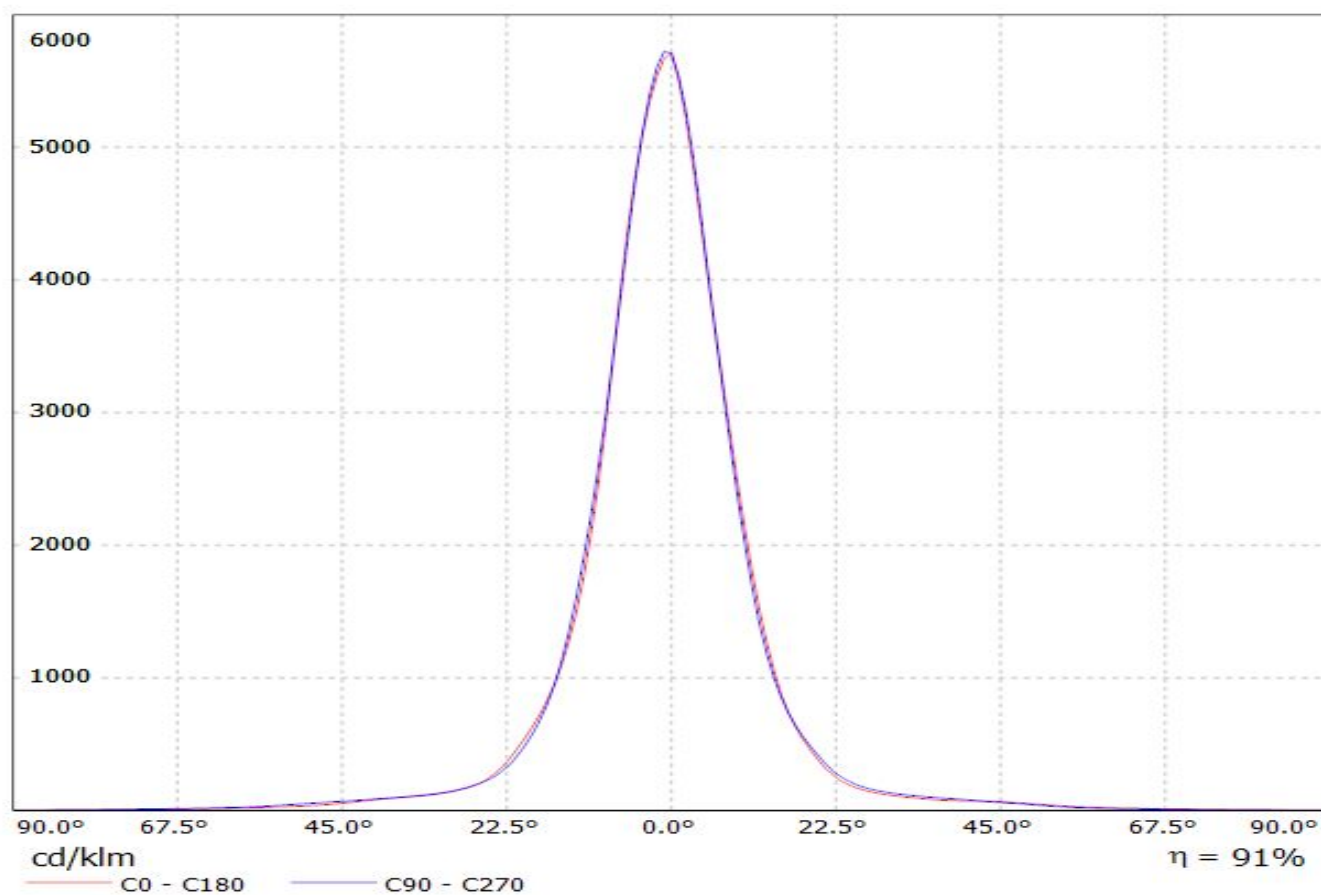

Luminaire: LEDiL Oy CN10861_IRIS_(CREE_XHP50_WARM_WHITE)

Lamps: 1 x CREE_XHP50_WARM_WHITE_195.088lm@250mA_P=1.40004W_I=0.2499A

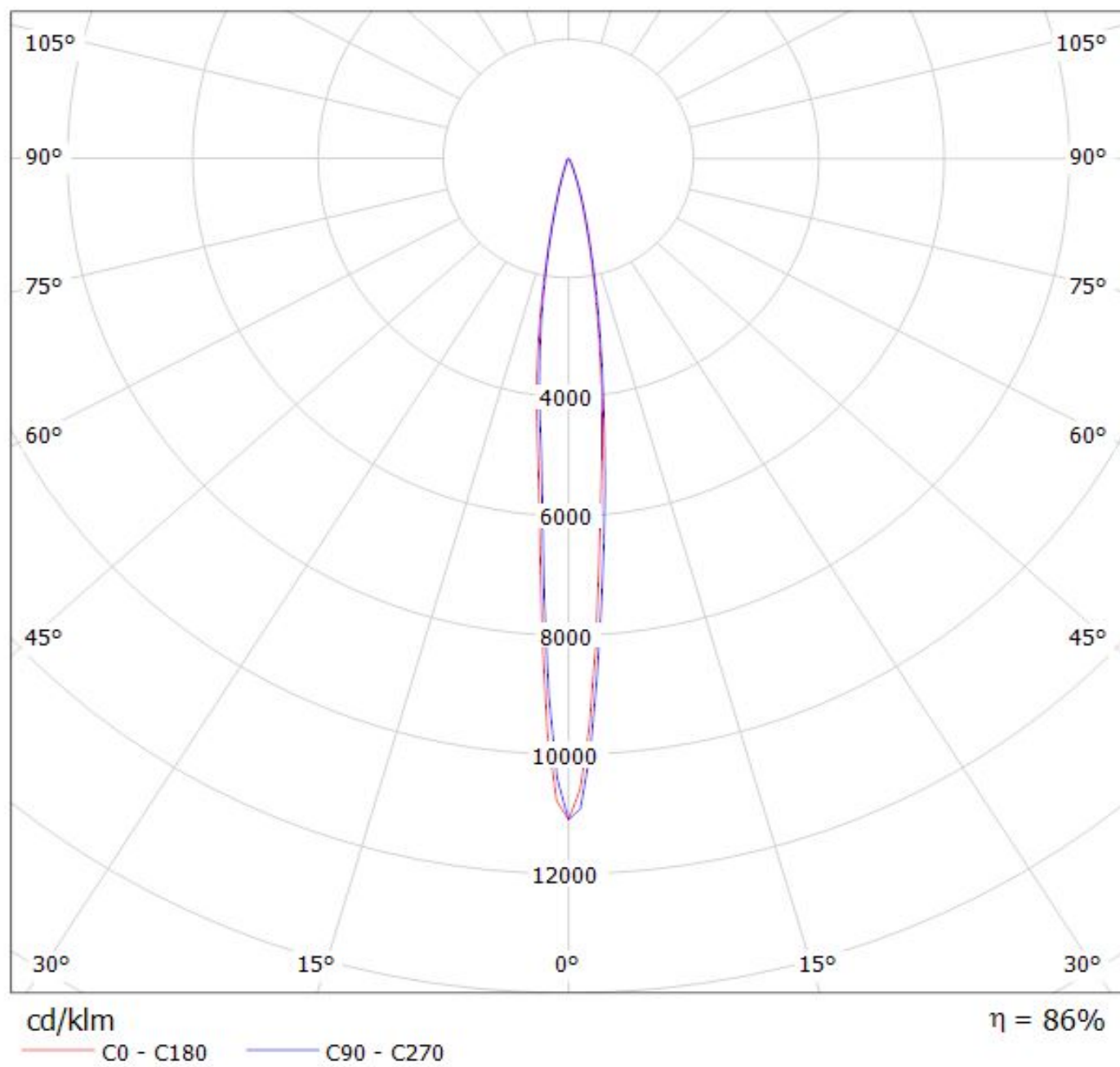

Luminaire: Ledil Oy CN10861_IRIS_(Luxeon MZ) Efficiency=82%
Lamps: 1 x Luxeon MZ 259.83lm @ 250mA CCT= P=2.75W I=250mA

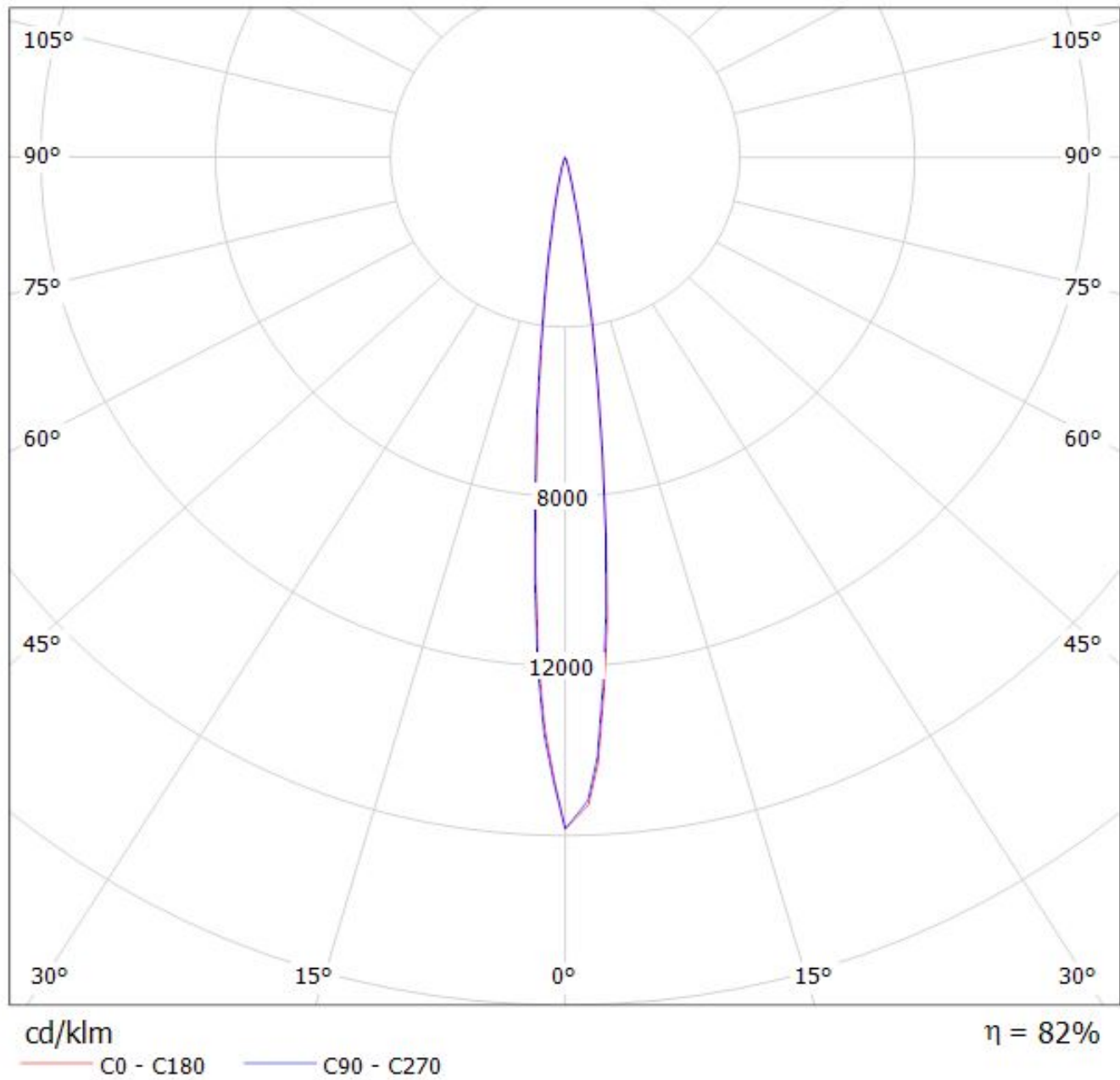

Luminaire: Ledil Oy CN10861-IRIS (Luxeon M 362lm @ 250mA) Efficiency=83%
Lamps: 1 x Luxeon M 362lm @ 250mA

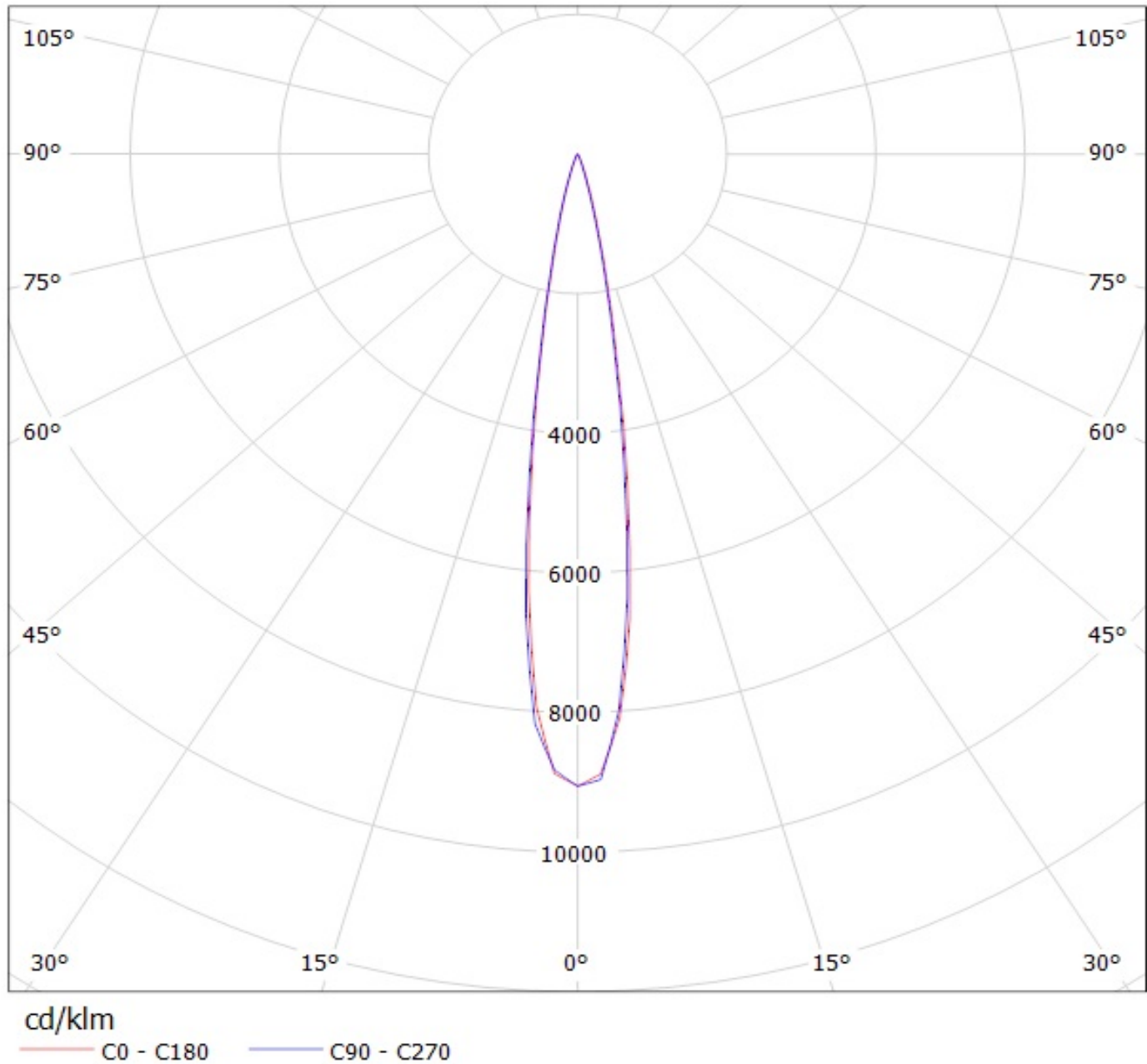

Luminaire: Ledil CN10861_IRIS_(MHD-G)
Lamps: 1 x MHD-G_528.91lm@100mA_P=3.0W_I=0.100A

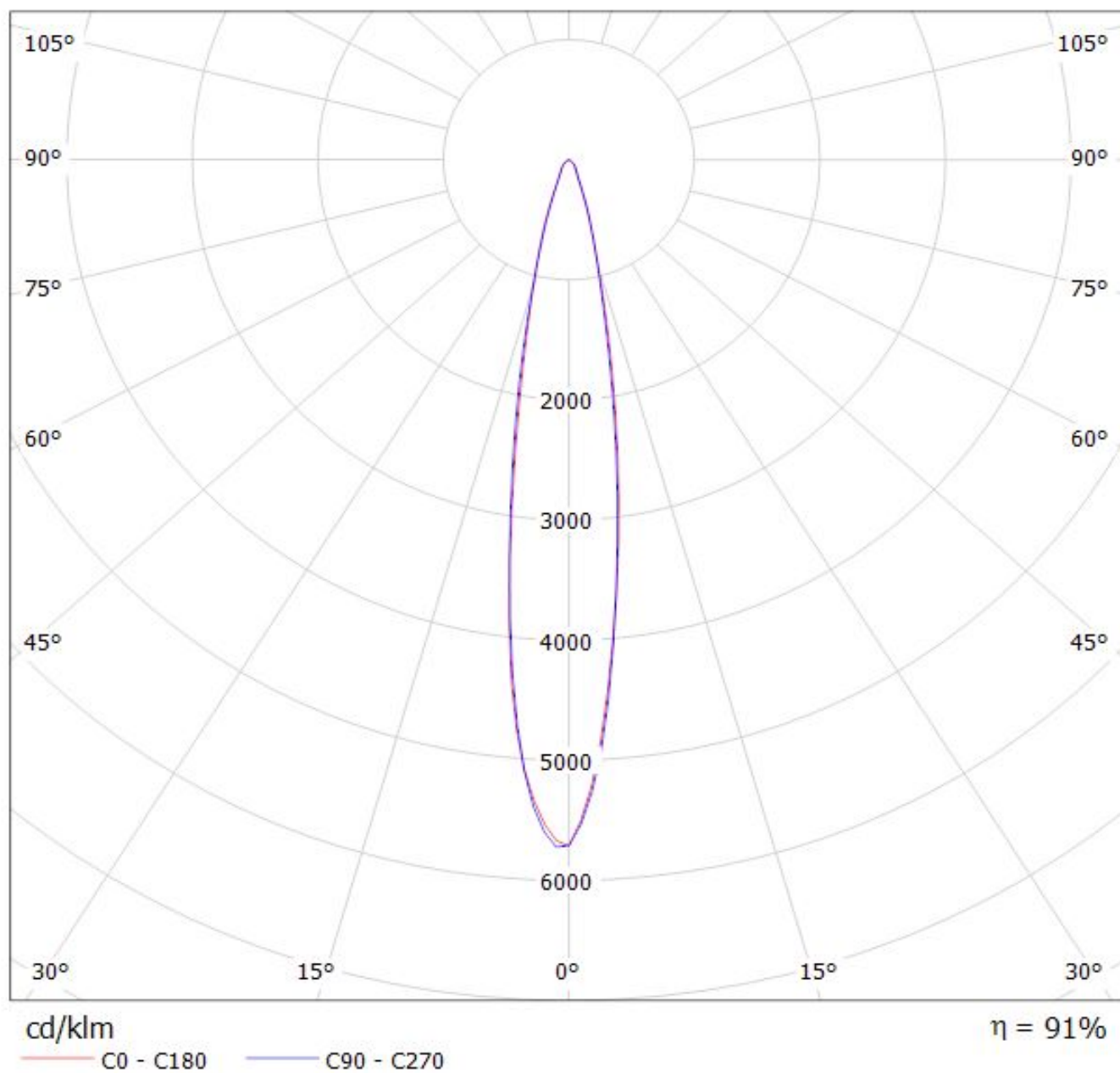

NOTE: The typical divergence will be changed by different color, chip size and chip position tolerance. The typical total divergence is the full angle measured where the luminous intensity is half of the peak value.

GENERAL INFORMATION

- Product series especially designed & optimized for series of LEDs.
- Special care taken to make light distribution as uniform as possible.
- Fastening to PCB with appropriate adhesive. By clicking link below you can find Ledil recommended glue options.
http://www.ledil.com/datasheets/DataSheet_GLUES.pdf

NOTE 1: We advise customer to ensure the suitability and sufficiency of the bond in the end product. For example, mechanical stress, vibration and holes on the surface of the circuit board weaken the strength of the glue.

NOTE 2: All surfaces where glue is applied must be clean, dry and free from grease and dirt. If cleaning of PCB surfaces is needed, please follow strictly the cleaning instructions of your LED manufacturer -this is important as cleaning shall under no circumstances damage LEDs or other electronics components on the PCB.

Further note that optical components shall not be cleaned with any chemicals - only micro fiber cloth may be used to remove fingerprints or other traces from handling.