

## Panel feed-through terminal block - VDFK 6/K GNYE - 0711069

Please be informed that the data shown in this PDF Document is generated from our Online Catalog. Please find the complete data in the user's documentation. Our General Terms of Use for Downloads are valid (<http://phoenixcontact.com/download>)



The illustration shows version VDFK 6/K in gray

Panel feed-through terminal block, Connection method: Screw connection, Solder connection, Cross section: 0.2 mm<sup>2</sup> - 10 mm<sup>2</sup>, AWG 24 - 8, Width: 10 mm, Color: green-yellow



### Key commercial data

|                                      |   |
|--------------------------------------|---|
| Packing unit                         | 50 pc   |
| Minimum order quantity               | 50 pc   |
| GTIN                                 | <br>4 017918 105518 |
| Weight per Piece (excluding packing) | 7.8 g   |
| Custom tariff number                 | 85369010  |
| Country of origin                    | Poland  |

### Technical data

#### General

|   |              |
|---|--------------|
| Number of levels                        | 1            |
| Number of connections                   | 2            |
| Color                                   | green-yellow |
| Insulating material                     | PA           |
| Inflammability class according to UL 94 | V2           |
| Rated surge voltage                     | 6 kV         |
| Pollution degree                        | 3            |
| Surge voltage category                  | III          |
| Insulating material group               | I            |
| Nominal current I <sub>N</sub>          | 57 A         |
| Nominal voltage U <sub>N</sub>          | 500 V        |
| Open side panel                         | nein         |
| Number of positions                     | 1            |

#### Dimensions

# Panel feed-through terminal block - VDFK 6/K GNYE - 0711069

## Technical data

### Dimensions

|       |       |
|-------|-------|
| Width | 10 mm |
|-------|-------|

### Connection data

|   |                      |
|---|----------------------|
| Connection side   | Outside              |
| Connection method   | Screw connection     |
| Conductor cross section solid min.  | 0.2 mm <sup>2</sup>  |
| Conductor cross section solid max.  | 10 mm <sup>2</sup>   |
| Conductor cross section stranded min.   | 0.2 mm <sup>2</sup>  |
| Conductor cross section stranded max.   | 6 mm <sup>2</sup>    |
| Conductor cross section AWG/kcmil min.  | 24                   |
| Conductor cross section AWG/kcmil max   | 8                    |
| Conductor cross section stranded, with ferrule without plastic sleeve min.              | 0.25 mm <sup>2</sup> |
| Conductor cross section stranded, with ferrule without plastic sleeve max.              | 6 mm <sup>2</sup>    |
| Conductor cross section stranded, with ferrule with plastic sleeve min.                 | 0.25 mm <sup>2</sup> |
| Conductor cross section stranded, with ferrule with plastic sleeve max.                 | 6 mm <sup>2</sup>    |
| 2 conductors with same cross section, solid min.  | 0.2 mm <sup>2</sup>  |
| 2 conductors with same cross section, solid max.  | 4 mm <sup>2</sup>    |
| 2 conductors with same cross section, stranded min.                                     | 0.2 mm <sup>2</sup>  |
| 2 conductors with same cross section, stranded max.                                     | 4 mm <sup>2</sup>    |
| 2 conductors with same cross section, stranded, ferrules without plastic sleeve, min.   | 0.25 mm <sup>2</sup> |
| 2 conductors with same cross section, stranded, ferrules without plastic sleeve, max.   | 2.5 mm <sup>2</sup>  |
| 2 conductors with same cross section, stranded, TWIN ferrules with plastic sleeve, min. | 0.5 mm <sup>2</sup>  |
| 2 conductors with same cross section, stranded, TWIN ferrules with plastic sleeve, max. | 4 mm <sup>2</sup>    |
| Stripping length  | 9 mm                 |
| Internal cylindrical gage   | A5                   |
| Screw thread  | M4                   |
| Tightening torque, min  | 1.5 Nm               |
| Tightening torque max   | 1.8 Nm               |
| Connection side   | Inside               |
| Connection method   | Solder connection    |

## Classifications

### eCl@ss

|            |          |
|------------|----------|
| eCl@ss 4.0 | 27141131 |
| eCl@ss 4.1 | 27141131 |
| eCl@ss 5.0 | 27141134 |

# Panel feed-through terminal block - VDFK 6/K GNYE - 0711069

## Classifications

### eCl@ss

|            |          |
|------------|----------|
| eCl@ss 5.1 | 27141134 |
| eCl@ss 6.0 | 27141134 |
| eCl@ss 7.0 | 27141134 |
| eCl@ss 8.0 | 27141134 |

### ETIM

|          |          |
|----------|----------|
| ETIM 2.0 | EC001283 |
| ETIM 3.0 | EC001283 |
| ETIM 4.0 | EC001283 |
| ETIM 5.0 | EC001283 |

### UNSPSC

|               |          |
|---------------|----------|
| UNSPSC 6.01   | 30211811 |
| UNSPSC 7.0901 | 39121410 |
| UNSPSC 11     | 39121410 |
| UNSPSC 12.01  | 39121410 |
| UNSPSC 13.2   | 39121410 |

## Approvals

### Approvals

#### Approvals

CSA / UL Recognized / KEMA-KEUR / cUL Recognized / IECCEB CB Scheme / cULus Recognized

#### Ex Approvals

#### Approvals submitted

### Approval details

|   |       |
|---|-------|
|  |       |
| mm <sup>2</sup> /AWG/kcmil  | 26-8  |
| Nominal current I <sub>N</sub>  | 50 A  |
| Nominal voltage U <sub>N</sub>  | 300 V |

# Panel feed-through terminal block - VDFK 6/K GNYE - 0711069

## Approvals

|                            |      |
|----------------------------|------|
| UL Recognized              |      |
| mm <sup>2</sup> /AWG/kcmil | 26-8 |

|                            |       |
|----------------------------|-------|
| KEMA-KEUR                  |       |
| mm <sup>2</sup> /AWG/kcmil | 6     |
| Nominal current IN         | 41 A  |
| Nominal voltage UN         | 500 V |

|                            |      |
|----------------------------|------|
| cUL Recognized             |      |
| mm <sup>2</sup> /AWG/kcmil | 26-8 |

|                            |       |
|----------------------------|-------|
| IECEE CB Scheme            |       |
| mm <sup>2</sup> /AWG/kcmil | 6     |
| Nominal current IN         | 41 A  |
| Nominal voltage UN         | 500 V |

|                  |  |
|------------------|--|
| cULus Recognized |  |
|------------------|--|

## Drawings

# Panel feed-through terminal block - VDFK 6/K GNYE - 0711069

Dimensioned drawing

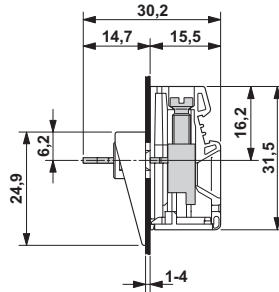

Drilling diagram

