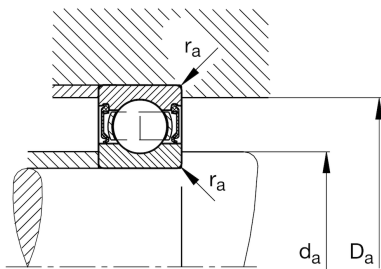
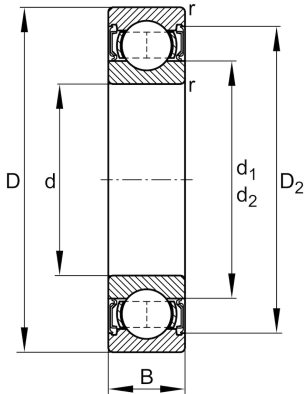

**FAG****S6200-2RSR-HLC**

Deep groove ball bearing

Schaeffler ID:
0554299470000Deep groove ball bearing S62...-2RSR,
corrosion-resistant materials, single row,
seals, steel sheet metal cage

Technical information

**Main Dimensions & Performance Data**

d	10 mm	Bore diameter
D	30 mm	Outside diameter
B	9 mm	Width
C_r	4.350 N	Basic dynamic load rating, radial
C_{0r}	1.910 N	Basic static load rating, radial
C_{ur}	121 N	Fatigue load limit, radial
n_G	15.200 1/min	Limiting speed
	31 g	Weight

Mounting dimensions

$d_{a \min}$	14,2 mm	Minimum diameter shaft shoulder
$D_{a \max}$	25,8 mm	Maximum diameter of housing shoulder
$r_{a \max}$	0,6 mm	Maximum fillet radius

Dimensions

r_{\min}	0,6 mm	Minimum chamfer dimension
D_2	25,28 mm	Caliber diameter outer ring
d_2	15,3 mm	Caliber diameter inner ring

Temperature range

T_{\min}	-30 °C	Operating temperature min.
T_{\max}	100 °C	Operating temperature max.

Calculation factors

f_0	10,5	Calculation factor
-------	------	--------------------