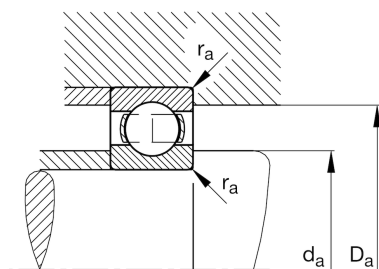
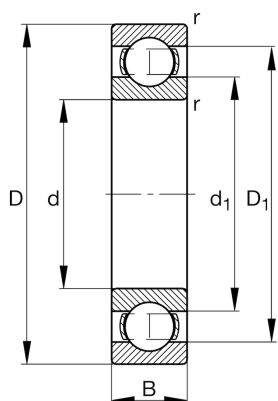

**FAG****6220-C3**

Deep groove ball bearing

Schaeffler ID:
0167216670030Deep groove ball bearing 62, single row,
steel sheet metal cage

Technical information

**Main Dimensions & Performance Data**

d	100 mm	Bore diameter
D	180 mm	Outside diameter
B	34 mm	Width
C_r	130,000 N	Basic dynamic load rating, radial
C_{0r}	93,000 N	Basic static load rating, radial
C_{ur}	5,500 N	Fatigue load limit, radial
n_G	5,000 1/min	Limiting speed
n_{gr}	4,800 1/min	Reference speed
	3.12 kg	Weight

Mounting dimensions

$d_{a \min}$	112 mm	Minimum diameter shaft shoulder
$D_{a \max}$	168 mm	Maximum diameter of housing shoulder
$r_{a \max}$	2.1 mm	Maximum fillet radius

Dimensions

r_{\min}	2.1 mm	Minimum chamfer dimension
D_1	155.5 mm	Shoulder diameter outer ring
d_1	125.1 mm	Shoulder diameter inner ring

Temperature range

T_{\min}	-30 °C	Operating temperature min.
T_{\max}	150 °C	Operating temperature max.

Calculation factors

f_0	14.4	Calculation factor
-------	------	--------------------