

IVM 40/24-2 M LP

Dual-motor, mobile and robust middle class IVM 40/24-2 Lp industrial vacuum cleaner for fine and coarse solid matter. With Longopac emptying system for dust-free emptying.



Made in Germany



Order no.

9.989-909.0

Technical data

EAN code		4054278943923
Power supply	Ph / V / Hz	1 / 220 - 240 / 50 - 60
Air flow	l/s / m ³ /h	106 / 381.6
Vacuum	mbar / kPa	225 / 22.5
Container capacity	l	40
Rated input power	kW	2.3
Vacuumping type		Electric
Connection nominal diameter		DN 70
Accessory nominal diameter		DN 50 / DN 40
Sound pressure level	dB(A)	77
Main filter dust class		M
Filter area for main filter	m ²	1.5
Weight without accessories	kg	47
Weight incl. packaging	kg	49
Dimensions (L × W × H)	mm	680 × 655 × 1435

This machine requires instruction.

Equipment

Main filter	Star filter
Accessories included in the scope of delivery	no
Container emptying	Longopac®

■ Included in the scope of supply.



2 blower motors

- High suction power and robustness.

Longopac disposal system

- Safe, healthy working thanks to low-dust disposal.

Equipped with a large star filter

- For safely vacuuming solids and dusts up to dust class M.
- Also suitable for large quantities of dust.

ACCESSORIES FOR IVM 40/24-2 M LP

9.989-909.0

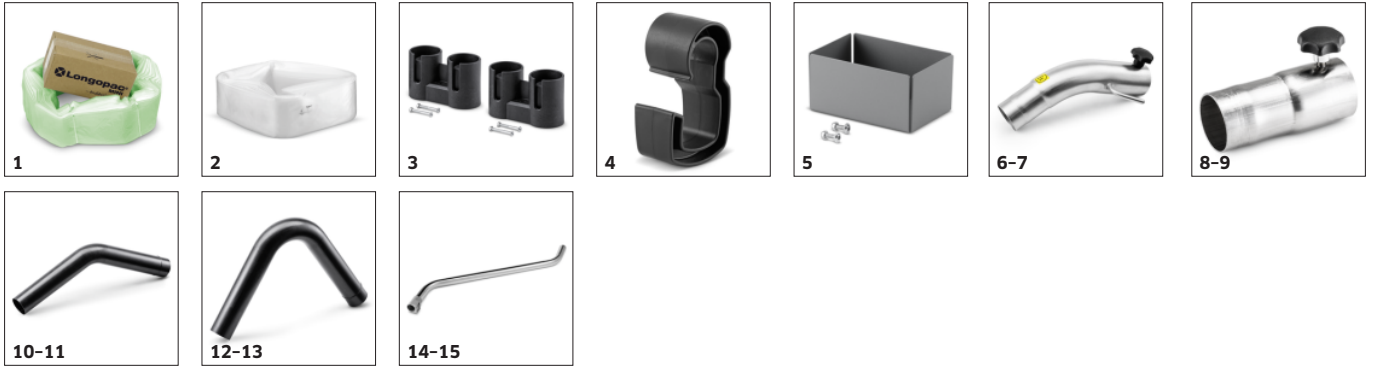

	Order no.	Description	
EMPTYING SUPPORTS			
Emptying bags			
Disposal bag Longopac PE biodegradable	1 9.990-260.0		■
Disposal bag Longopac PE Ø 357 mm 60 l 4x	2 6.907-506.0	22-metre long Longopac® continuous liner for Longopac disposal system.	■
OTHER ACCESSORIES			
Accessories holder completely	3 9.991-147.0		■
Power cable storage compartment	4 5.037-240.0	The power cord is stored on a hook attached to the tubular frame. The practical cord hook is suitable for a pipe diameter of 30 to 32 mm.	■
Accessories box completely	5 9.991-046.0		□
HANDLES			
Handle stainless steel AISI 304 DN40	6 9.989-896.0		□
Handle stainless steel AISI 304 DN50	7 9.989-897.0		□
Handle straight stainless steel AISI 304 DN40	8 9.989-898.0		□
Handle straight stainless steel AISI 304 DN50	9 9.989-899.0		□
Handle carbon 45° DN-F40	10 9.989-916.0		□
Handle carbon 45° DN-F50	11 9.989-917.0		□
Handle carbon 110° DN-F40	12 9.989-918.0		□
Handle carbon 110° DN-F50	13 9.989-919.0		□
SUCTION TUBES			
Suction tube stainless steel AISI 304 DN40	14 9.989-912.0		□

■ Included in the scope of supply. □ Available accessories.

ACCESSORIES FOR IVM 40/24-2 M LP

9.989-909.0

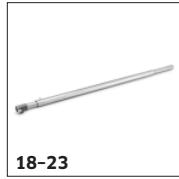
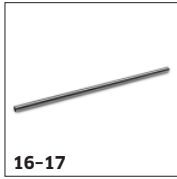

		Order no.	Description	
SUCTION TUBES				
Suction tube stainless steel AISI 304 DN50	15	9.989-913.0		<input type="checkbox"/>
Suction tube carbon 1500 mm DN-F40 conical	16	9.989-920.0		<input type="checkbox"/>
Suction tube carbon 1500 mm DN-F50 conical	17	9.989-921.0		<input type="checkbox"/>
Suction tube aluminium high temperature 1000 mm DN-F40	18	9.989-928.0		<input type="checkbox"/>
Suction tube aluminium high temperature 1000 mm DN-F50	19	9.989-929.0		<input type="checkbox"/>
Suction tube aluminium high temperature 2000 mm DN-F40	20	9.989-930.0		<input type="checkbox"/>
Suction tube aluminium high temperature 2000 mm DN-F50	21	9.989-931.0		<input type="checkbox"/>
Suction tube aluminium high temperature 3000 mm DN-F40	22	9.989-932.0		<input type="checkbox"/>
Suction tube aluminium high temperature 3000 mm DN-F50	23	9.989-933.0		<input type="checkbox"/>
ACCESSORY SETS				
Accessory kit for solids/dust				
Oven cleaning accessory kit Expert DN 50	24	9.989-938.0	Accessory kit for oven cleaning: ME hose 3 m (9.989-979.0), handle (9.989-899.0), suction tube (9.989-929.0), floor nozzle (9.989-935.0), reducer (9.989-712.0), adapter (9.993-011.0).	<input type="checkbox"/>
Oven cleaning accessory kit Expert DN 40	25	9.989-939.0	Accessory kit for oven cleaning: ME hose 3 m (9.989-976.0), handle (9.989-898.0), suction tube (9.989-928.0), floor nozzle (9.989-934.0), reducer (9.989-713.0), adapter (9.993-012.0).	<input type="checkbox"/>
Food accessory kit Expert DN 40	26	9.989-940.0	Food accessory kit DN 40: PU hose 3 m (9.989-970.0), handle (9.989-898.0), standard nozzle (9.989-838.0), brush (9.989-879.0), reducer (9.989-713.0), adapter (9.993-012.0).	<input type="checkbox"/>
Food accessory kit Expert DN 50	27	9.989-941.0	Food accessory kit: PU hose 3 m (9.989-973.0), handle (9.989-899.0), standard nozzle (9.989-844.0), brush (9.989-880.0), reducer (9.989-712.0), adapter (9.993-011.0).	<input type="checkbox"/>
Accessory kit for overhead cleaning Expert DN 40	28	9.989-942.0	Accessory kit DN 40 for overhead cleaning: suction tubes (9.989-920.0/9.993-008.0), handles (9.989-916.0/9.989-918.0), standard nozzle (9.989-838.0), brush (9.989-879.0), adapter (9.993-012.0).	<input type="checkbox"/>

■ Included in the scope of supply. □ Available accessories.

ACCESSORIES FOR IVM 40/24-2 M LP

9.989-909.0



	Order no.	Description		
ACCESSORY SETS				
Accessory kit for solids/dust				
Accessory kit for overhead cleaning DN 50 Expert	29	9.989-943.0	Accessory kit DN 50 for overhead cleaning: suction tubes (9.989-921.0/9.993-009.0), handles (9.989-917.0/9.989-919.0), standard nozzle (9.989-844.0), brush (9.989-880.0), adapter (9.993-011.0).	<input type="checkbox"/>
Professional dry floor cleaning set DN40	30	9.990-877.0	Professional dry floor cleaning set: adapter (9.990-874.0), hose (2.889-141.0), bend (2.889-172.0), 2 × suction tube (2.889-194.0), 3 × nozzles (6.906-958.0, 6.903-033.0, 6.902-105.0).	<input type="checkbox"/>
Advanced dry floor cleaning set DN40	31	9.990-893.0	Advanced dry floor cleaning set: EVA hose (9.990-923.0), handle (9.990-929.0), 2 × suction tube (9.990-933.0), floor nozzle (9.990-935.0), standard nozzle (9.980-773.0).	<input type="checkbox"/>
Advanced dry floor cleaning set DN50	32	9.990-894.0	Advanced dry floor cleaning set: EVA hose (9.990-924.0), handle (9.990-930.0), 2 × suction tube (9.990-934.0), floor nozzle (9.990-936.0), standard nozzle (9.980-761.0).	<input type="checkbox"/>
Accessories kit furnace Expert DN35	33	9.991-106.0	Accessory kit for oven cleaning: ME hose 3 m (9.989-976.0), handle (9.989-898.0), suction tube (9.989-928.0), floor nozzle (9.989-934.0), reducer (9.989-713.0), adapter (9.993-012.0).	<input type="checkbox"/>
NOZZLES				
Standard nozzles				
Standard nozzle silicone FDA blue DN-F40	34	9.989-835.0		<input type="checkbox"/>
Standard nozzle silicone FDA green DN-F40	35	9.989-836.0		<input type="checkbox"/>
Standard nozzle silicone FDA red DN-F40	36	9.989-837.0		<input type="checkbox"/>
Standard nozzle silicone FDA transparent DN-F40	37	9.989-838.0		<input type="checkbox"/>
Standard nozzle silicone FDA white DN-F40	38	9.989-839.0		<input type="checkbox"/>
Standard nozzle silicone FDA yellow DN-F40	39	9.989-840.0		<input type="checkbox"/>
Standard nozzle silicone FDA blue DN-F50	40	9.989-841.0		<input type="checkbox"/>
Standard nozzle silicone FDA green DN-F50	41	9.989-842.0		<input type="checkbox"/>
Standard nozzle silicone FDA red DN-F50	42	9.989-843.0		<input type="checkbox"/>

■ Included in the scope of supply. □ Available accessories.

ACCESSORIES FOR IVM 40/24-2 M LP

9.989-909.0



	Order no.	Description	
NOZZLES			
Standard nozzles			
Standard nozzle silicone FDA transparent DN-F50	43	9.989-844.0	<input type="checkbox"/>
Standard nozzle silicone FDA white DN-F50	44	9.989-845.0	<input type="checkbox"/>
Standard nozzle silicone FDA yellow DN-F50	45	9.989-846.0	<input type="checkbox"/>
Floor nozzles			
Floor nozzle stainless steel AISI 304 DN-F40 blue	46	9.989-861.0	<input type="checkbox"/>
Floor nozzle stainless steel AISI 316L DN-F50 blue	47	9.989-862.0	<input type="checkbox"/>
Floor nozzle stainless steel AISI 316L DN-F40 green	48	9.989-863.0	<input type="checkbox"/>
Floor nozzle stainless steel AISI 316L DN-F50 green	49	9.989-864.0	<input type="checkbox"/>
Floor nozzle stainless steel AISI 316L DN-F40 red	50	9.989-865.0	<input type="checkbox"/>
Floor nozzle stainless steel AISI 316L DN-F50 red	51	9.989-866.0	<input type="checkbox"/>
Floor nozzle stainless steel AISI 316L DN-F40 transparent	52	9.989-867.0	<input type="checkbox"/>
Floor nozzle stainless steel AISI 316L DN-F50 transparent	53	9.989-868.0	<input type="checkbox"/>
Floor nozzle stainless steel AISI 316L DN-F40 white	54	9.989-869.0	<input type="checkbox"/>
Floor nozzle stainless steel AISI 316L DN-F50 white	55	9.989-870.0	<input type="checkbox"/>
Floor nozzle stainless steel AISI 316L DN-F40 yellow	56	9.989-871.0	<input type="checkbox"/>

Available accessories.

ACCESSORIES FOR IVM 40/24-2 M LP

9.989-909.0



56-57



58-59



60-61



62-63

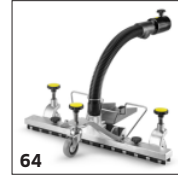

64



65-66



67-68



69-70

	Order no.	Description	
NOZZLES			
Floor nozzles			
Floor nozzle stainless steel AISI 316L DN-F50 yellow	57	9.989-872.0	<input type="checkbox"/>
Floor nozzle stainless steel AISI 316L DN-F40	58	9.989-914.0	<input type="checkbox"/>
Floor nozzle stainless steel AISI 316L DN-F50	59	9.989-915.0	<input type="checkbox"/>
Floor nozzle stainless steel 400 mm DN-F40	60	9.989-934.0	<input type="checkbox"/>
Floor nozzle stainless steel 400 mm DN-F50	61	9.989-935.0	<input type="checkbox"/>
Floor nozzle aluminium 400 mm DN-F40	62	9.989-936.0	<input type="checkbox"/>
Floor nozzle aluminium 400 mm DN-F50	63	9.989-937.0	<input type="checkbox"/>
Wide nozzles			
Lane nozzle set	64	9.991-032.0	<input type="checkbox"/>
Flexible crevice nozzles			
Crevice nozzle flexible silicone FDA DN-F50 transparent	65	9.989-847.0	<input type="checkbox"/>
Crevice nozzle flexible silicone FDA DN-F40 transparent	66	9.989-848.0	<input type="checkbox"/>
Surface nozzles			
Silicone surface nozzle FDA blue DN-F40	67	9.989-849.0	<input type="checkbox"/>
Silicone surface nozzle FDA blue DN-F50	68	9.989-850.0	<input type="checkbox"/>
Silicone surface nozzle FDA green DN-F40	69	9.989-851.0	<input type="checkbox"/>
Silicone surface nozzle FDA green DN-F50	70	9.989-852.0	<input type="checkbox"/>

Available accessories.

ACCESSORIES FOR IVM 40/24-2 M LP

9.989-909.0



71-72



73-74



75-76



77-78



79-80



81-82



83-84

	Order no.	Description	
NOZZLES			
Surface nozzles			
Silicone surface nozzle FDA red DN-F40	71	9.989-853.0	<input type="checkbox"/>
Silicone surface nozzle FDA red DN-F50	72	9.989-854.0	<input type="checkbox"/>
Silicone surface nozzle FDA transparent DN-F40	73	9.989-855.0	<input type="checkbox"/>
Silicone surface nozzle FDA transparent DN-F50	74	9.989-856.0	<input type="checkbox"/>
Silicone surface nozzle FDA white DN-F40	75	9.989-857.0	<input type="checkbox"/>
Silicone surface nozzle FDA white DN-F50	76	9.989-858.0	<input type="checkbox"/>
Silicone surface nozzle FDA yellow DN-F40	77	9.989-859.0	<input type="checkbox"/>
Silicone surface nozzle FDA yellow DN-F50	78	9.989-860.0	<input type="checkbox"/>
BRUSHES			
End brushes			
Brush FDA blue ø 75 mm DN-F40	79	9.989-873.0	<input type="checkbox"/>
Brush FDA blue ø 75 mm DN-F50	80	9.989-874.0	<input type="checkbox"/>
Brush FDA green ø 75 mm DN-F40	81	9.989-875.0	<input type="checkbox"/>
Brush FDA green ø 75 mm DN-F50	82	9.989-876.0	<input type="checkbox"/>
Brush FDA red ø 75 mm DN-F40	83	9.989-877.0	<input type="checkbox"/>
Brush FDA red ø 75 mm DN-F50	84	9.989-878.0	<input type="checkbox"/>

Available accessories.

ACCESSORIES FOR IVM 40/24-2 M LP

9.989-909.0



	Order no.	Description	
BRUSHES			
End brushes			
Brush FDA white ø 75 mm DN-F40	85	9.989-879.0	<input type="checkbox"/>
Brush FDA white ø 75 mm DN-F50	86	9.989-880.0	<input type="checkbox"/>
Brush FDA yellow ø 75 mm DN-F40	87	9.989-881.0	<input type="checkbox"/>
Brush FDA yellow ø 75 mm DN-F50	88	9.989-882.0	<input type="checkbox"/>
Cylinder brushes			
Cylinder brush ø 100 mm DN-F40	89	9.989-922.0	<input type="checkbox"/>
Cylinder brush ø 200 mm DN-F40	90	9.989-923.0	<input type="checkbox"/>
Cylinder brush ø 100 mm DN-F50	91	9.989-925.0	<input type="checkbox"/>
Cylinder brush ø 200 mm DN-F50	92	9.989-926.0	<input type="checkbox"/>
HOSES			
ME-Schläuche			
Hose ME DN40 3 m	93	9.989-976.0	<input type="checkbox"/>
Hose ME DN40 5 m	94	9.989-977.0	<input type="checkbox"/>
Hose without connection ME DN40 15 m	95	9.989-978.0	<input type="checkbox"/>
Hose ME DN50 3 m	96	9.989-979.0	<input type="checkbox"/>
Hose ME DN50 5 m	97	9.989-980.0	<input type="checkbox"/>
PVC			
Hose PVC DN40 3 m	98	9.989-962.0	<input type="checkbox"/>

Available accessories.

ACCESSORIES FOR IVM 40/24-2 M LP

9.989-909.0



98-101



102-103, 105



104



106-107



108-111



112-116

	Order no.	Description	
HOSES			
PVC			
Hose PVC DN40 5 m	99	9.989-963.0	<input type="checkbox"/>
Hose PVC DN50 3 m	100	9.989-964.0	<input type="checkbox"/>
Hose PVC DN50 5 m	101	9.989-965.0	<input type="checkbox"/>
EVA hoses			
Hose EVA DN40 3 m	102	9.989-982.0	<input type="checkbox"/>
Hose EVA DN40 5 m	103	9.989-983.0	<input type="checkbox"/>
Hose EVA DN50 3 m	104	9.989-984.0	<input type="checkbox"/>
Hose EVA DN50 5 m	105	9.989-985.0	<input type="checkbox"/>
Hose installation sets			
Hose connection kit, stainless steel AISI 304 DN40	106	9.989-986.0	<input type="checkbox"/>
		Hose connection kit in nominal width DN 40, made of stainless steel. Contents: 1 hose connection piece, 1 hose connection (rotating), 2 hose clamps, 2 hose end pieces (black), 1 flat bag (PE plastic).	
Hose connection kit, stainless steel AISI 304 DN50	107	9.989-987.0	<input type="checkbox"/>
		Hose connection kit in nominal width DN 50, made of stainless steel. Contents: 1 hose connection piece, 1 hose connection (rotating), 2 hose clamps, 2 hose end pieces (black), 1 flat bag (PE plastic).	
PU hoses			
Hose PU DN40 3 m	108	9.989-966.0	<input type="checkbox"/>
Hose PU DN40 5 m	109	9.989-967.0	<input type="checkbox"/>
Hose PU DN50 3 m	110	9.989-968.0	<input type="checkbox"/>
Hose PU DN50 5 m	111	9.989-969.0	<input type="checkbox"/>
Hose PU FDA DN40 3 m	112	9.989-970.0	<input type="checkbox"/>

Available accessories.

ACCESSORIES FOR IVM 40/24-2 M LP

9.989-909.0



112-116



117



119



120-122



123-124

	Order no.	Description	
HOSES			
PU hoses			
Hose PU FDA DN40 5 m	113	9.989-971.0	<input type="checkbox"/>
Hose PU FDA DN40 15 m	114	9.989-972.0	<input type="checkbox"/>
Hose PU FDA DN50 3 m	115	9.989-973.0	<input type="checkbox"/>
Hose PU FDA DN50 5 m	116	9.989-974.0	<input type="checkbox"/>
Hose PU FDA DN50 15 m	117	9.989-975.0	<input type="checkbox"/>
ME-PU-hoses			
Hose without connection ME DN50 15 m	118	9.989-981.0	<input type="checkbox"/>
ADAPTERS / REDUCERS / DISTRIBUTORS			
Accessories adapter			
Adapter DN70 auf Bajonett 2.0 elektr. leitend	119	9.990-874.0	<input type="checkbox"/>
Reducers/expanders			
Reducer in AISI 304 stainless steel DN50 to DN40	120	9.989-893.0	<input type="checkbox"/>
Stainless steel reducer DN 70 to DN 50	121	9.989-712.0	<input type="checkbox"/>
Stainless steel reducer DN 70 to DN 40	122	9.989-713.0	<input type="checkbox"/>
Distributor			
AISI 304 stainless steel manifold DN70 to DN50	123	9.989-894.0	<input type="checkbox"/>
AISI 304 stainless steel manifold DN70 to DN40	124	9.989-895.0	<input type="checkbox"/>

Available accessories.