

**PASEY60-XL-N**

Plummer block housing unit

Plummer block housing units PASEY, cast iron housing, radial insert ball bearing with grub screws in inner ring, P seals

X-life

Technical information

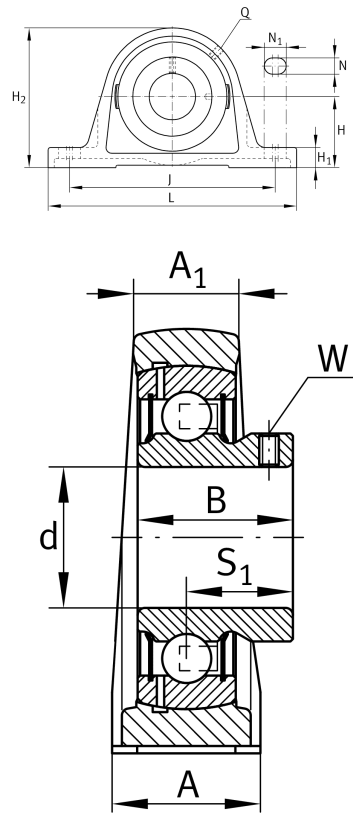

Your current product variant

Material	GG	Grey cast iron
Groove	N	Cast iron housing with undercut slot for end caps

Main Dimensions & Performance Data

d	60 mm	Bore diameter
L	240 mm	Length total
H 2	140 mm	Height
≈m	4.13 kg	Weight

Mounting dimensions

J	190 mm	Distance fixing bore
N	18 mm	Width (slot)
N 1	28 mm	Length (slot)



Dimensions

H	69.9 mm	Distance shaft axis
A	60 mm	Width (base)
A <sub>1</sub>	42 mm	Width (head)
H <sub>1</sub>	25 mm	Heigth (base)
B	47 mm	Width
S <sub>1</sub>	34 mm	Distance of raceway to locking collar
Q	M6	Connection thread for lubrication

Additional information

ASE12	Housing
GAY60-XL-NPP-B	Bearing designation
KASK12	Protecting cap

Temperature range

T <sub>min</sub>	-20 °C	Operating temperature min.
T <sub>max</sub>	120 °C	Operating temperature max.