

# Guided drive DFM-6/-10

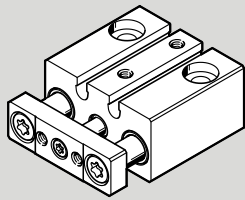

## FESTO

Festo SE & Co. KG  
Rüter Straße 82  
73734 Esslingen  
Germany  
+49 711 347-0  
www.festo.com

Instructions | Assembly

8082950  
2018-02f  
[8082952]



8082950

Translation of the original instructions

### 1 Further applicable documents

- All available documents for the product → [www.festo.com/pk](http://www.festo.com/pk).
- Assembly instructions for proximity sensor

### 2 Safety

#### 2.1 Safety instructions

- Before carrying out any work on the product, switch off the compressed air supply and secure it against being switched back on.
- Protect the positioning range from access.
- Keep foreign objects out of the positioning range.

#### 2.2 Intended use

Recording lateral forces on the yoke plate for clamping, press-fitting, feeding or as protection against rotation.

### 3 Further information

Characteristic curves and permissible limits → [www.festo.com/catalogue](http://www.festo.com/catalogue)  
Dimensions of guided drive → [www.festo.com/catalogue](http://www.festo.com/catalogue)  
Accessories (e.g. QS push-in fittings) → [www.festo.com/catalogue](http://www.festo.com/catalogue)

### 4 Product range overview

#### 4.1 Included in delivery

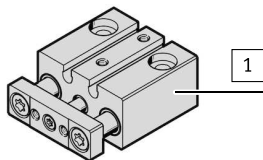

1 Guided drive (1x)

Fig. 1

#### 4.2 Not included in the delivery

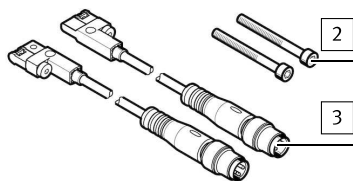

2 Screw (2x)  
3 Proximity sensor (2x)  
SMT-10G

Fig. 2

### 5 Mounting

#### 5.1 Assembly conditions

- Observe the characteristic curves and permissible limits → [www.festo.com/catalogue](http://www.festo.com/catalogue).
- Handle the guided drive in such a way that the guide rods and piston rod are not damaged.
- Ensure that the surfaces (H) and (I) are flat.
- Install the guided drive without deformation.

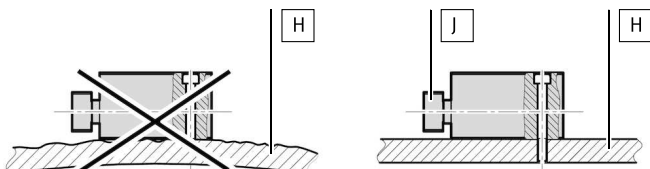

Fig. 3

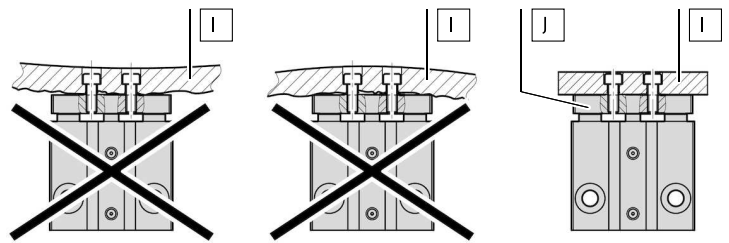

Fig. 4

#### 5.2 Assembly variants Flat from above

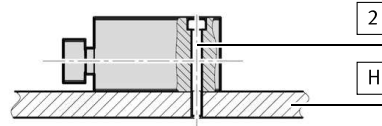

Fig. 5

#### Via end face

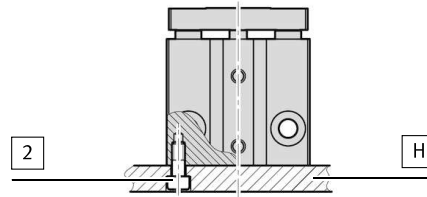

Fig. 6

### 5.3 Mounting

#### Select mounting accessories

- Use the following screws [2] depending on the assembly variant:

DFM	Flat from above	Via end face	Yoke plate (J)
6	M3	M3	M2.5
10	M3	M4	M3

Tab. 1 Mounting accessories

#### Assemble guide unit

- Position guided drive [1] on the assembly surfaces (H) and (I).
- Mount guided drive [1] using the screws [2].

#### 5.4 Assembly of the proximity sensors SMT-10G

##### Positioning the proximity sensors in the slots

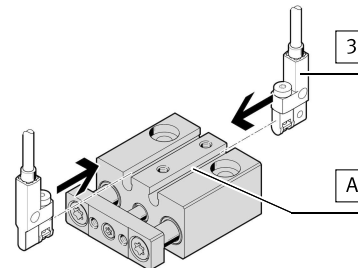

Fig. 7

- Align the proximity sensors [3] with the mounting attachment facing inwards.
- Slide the proximity sensors [3] into the slots (A).

#### Assembling the proximity sensors

Permitted QS push-in fittings (B): → [www.festo.com/catalogue](http://www.festo.com/catalogue)

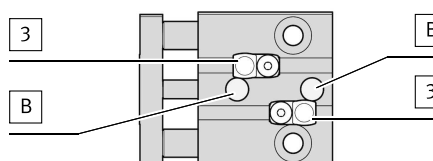

Fig. 8

- Mount the proximity sensors [3] → Further applicable documents.