

LOC	DIST	P	F	ZONE	LTR	REVISIONS	
						DESCRIPTION	DATE
CM	53					O RELEASED PER PR CM 90-28	2-26-90
						A REVISED PER CM-3286	2-7-91
						B REV PER EC 0730-3607-91	1-7-94
						C REV PER EC 0730-0156-94	8-24-94

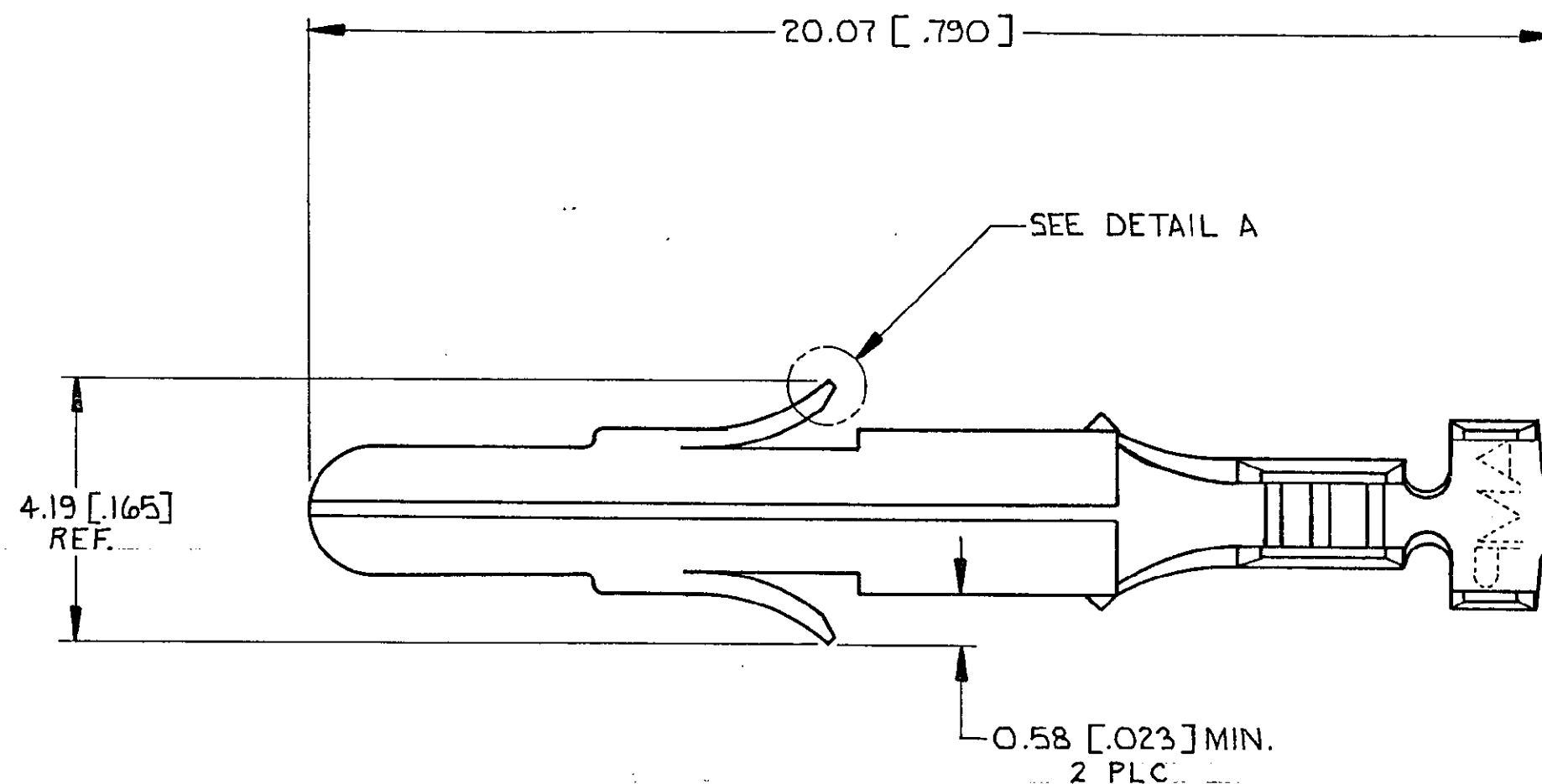

1 0.00076 - 0.00091 [.000030 - .000036] GOLD PLATE IN LOCALIZED GOLD PLATE AREA OVER 0.00127 [.000050] NICKEL UNDERPLATE ALL OVER. 0.00013 - 0.00020 [.000005 - .000008] GOLD FLASH ON REMAINDER OF CONTACT.

2. DIMENSIONS IN BRACKETS ARE IN INCHES.

3. WIRE RANGE: 0.05-0.15 mm<sup>2</sup> [30-26 AWG]  
INSULATION RANGE: 0.81-1.45 [0.32-.057] DIA.

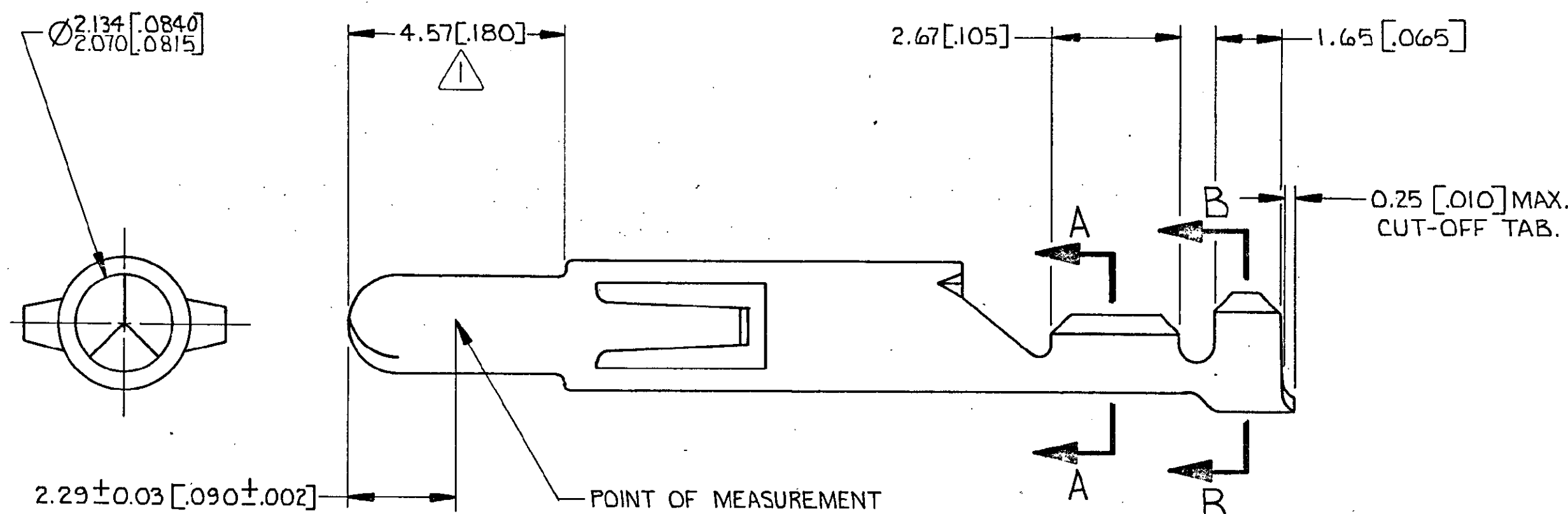

METRIC

△	0.30 [.012] PH BRZ	770672 -6
PRE-TIN	0.30 [.012] BRASS	770672 -1
FINISH	MATERIAL	PART NO

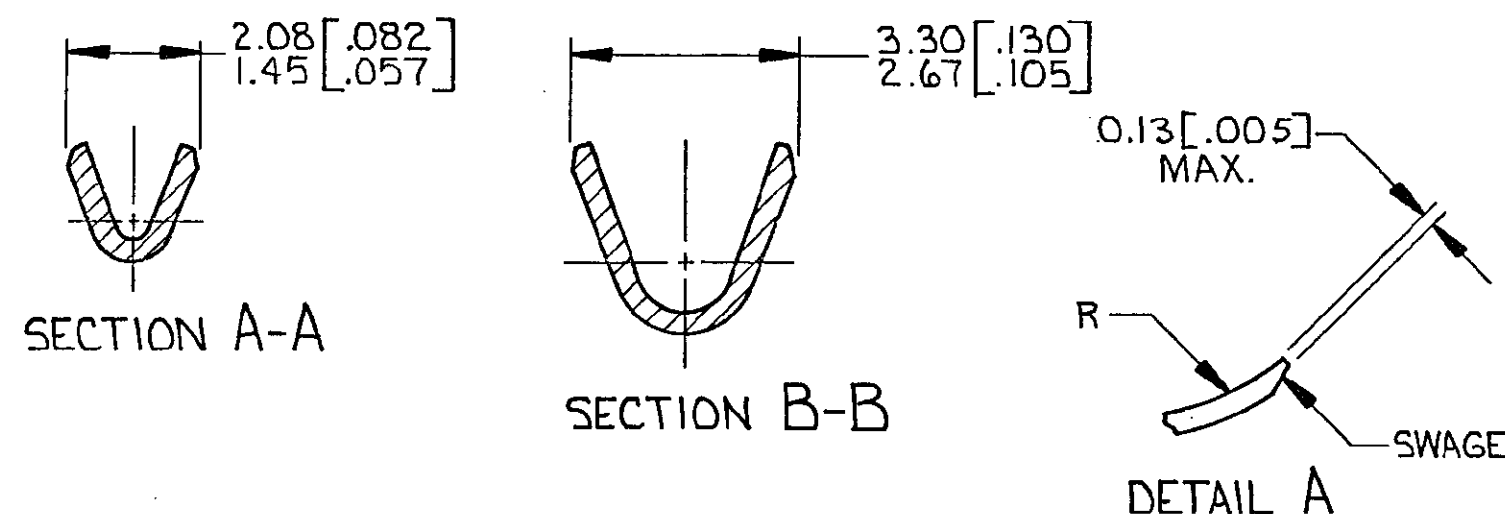

UNLESS OTHERWISE SPECIFIED  
DIMENSIONS ARE IN INCHES  
TOLERANCES ON  
2 PL DEC ±  
3 PL DEC ±0.13 [.005]  
ANGLES ±

MATERIAL  
SEE TABLE

FINISH  
SEE TABLE

DR P. Collins 2-26-90  
CHK R. Juring 3-2-90  
APPD M. Tull 3-2-90

PRODUCT SPEC

APPLICATION SPEC

WEIGHT

NAME

PIN, UNIVERSAL MATE-N-LOK,<sup>TM</sup>  
LOOSE PIECE

SIZE  
C

FSCM NO  
00779

DRAWING NO

770672

SCALE 10:1

SHEET 1 OF 1

CUSTOMER DRAWING