



5.5 V Supercapacitors for RTC hold-up and memory backup applications



KR family



KW family

Description

High capacitance 5.5 V coin cell supercapacitors in industry standard packages. High capacitance, 0.1 F to 1.5 F, enables critical functions to be continued or completed in a controlled manner during battery swap out or mains fail for systems up to 5.5 V.

The Eaton KR family is available in three industry standard mechanical packages, cylindrical style, horizontal mount and vertical mount, each with six capacitance values from 0.1 F to 1.5 F.

The KW family is available in cylindrical coin cell style with five capacitance values from 0.1 F to 1.0 F. The KW family is fully rated up to 85 °C.

Space saving

High energy density allows the use of small 11.5 mm to 21.5 mm diameter low profile packages with 5 mm to 8.5 mm thickness.

Low leakage current

Ultra-low leakage current levels make the Eaton coin cells ideal for battery powered equipment where loading needs to be minimized to prolong the operating time.

Environmentally friendly

The full line of KR family supercapacitors are RoHS compliant, lead free and present no disposal issues at end of life.

Applications

- Computer & peripherals
- DSL modems & routers
- Set top boxes
- White goods & kitchen appliances
- Copiers
- Electric utility meters
- HVAC controls



Powering Business Worldwide

| Specifications | Values |
|----------------------------------------------|-------------------------------------------------|
| Working voltage | 5.5 V |
| Surge voltage | 6.3 V |
| Nominal capacitance range | 0.1 F - 1.5 F |
| Maximum equivalent series resistance @ 1 kHz | 75 Ω to 30 Ω |
| Capacitance tolerance | -20% to +80% @ +20 °C |
| Operating temperature range | -25 °C to +70 °C (KR) -25 °C to +85 °C* (KW) |

* KR with voltage derating to 3.6 V @ +85 °C

Part numbering system

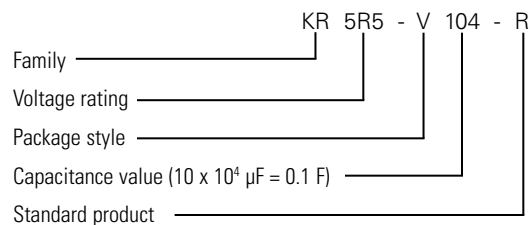

V Type

| Product family | Capacitance (F) | Diameter (mm) | Height (mm) |
|----------------|-----------------|---------------|-------------|
| KR | 0.1 - 0.47 | 11.5 | 5.0 |
| | 0.1 - 1.5 | 19.0 | 5.0 |

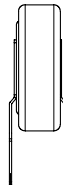
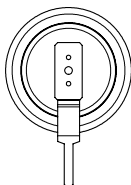

H Type

| Product family | Capacitance (F) | Diameter (mm) | Height (mm) |
|----------------|-----------------|---------------|-------------|
| KR | 0.1 - 0.47 | 11.5 | 5.0 |
| | 0.1 - 1.5 | 19.0 | 5.0 |

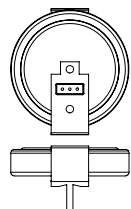

C Type

| Product family | Capacitance (F) | Diameter (mm) | Height (mm) |
|----------------|-----------------|---------------|-------------|
| KR | 0.1 - 0.47 | 11.5 | 5.0 |
| | 0.1 - 1.5 | 19.0 | 5.0 |
| KW | 0.1 - 0.33 | 13.5 | 8.3 |
| | 0.68 - 1.01 | 21.5 | 8.85 |

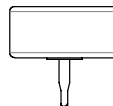
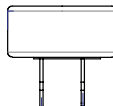

Tools & resources

- [KR Supercapacitors](#)
- [KW Supercapacitors](#)
- [Supercapacitor calculator](#)
- [Parametric search](#)
- [Cross reference search](#)
- [Inventory search](#)
- [Contact us](#)

Eaton
Electronics Division
1000 Eaton Boulevard
Cleveland, OH 44122
United States
Eaton.com/electronics

© 2020 Eaton
All Rights Reserved
Printed in USA
Publication No. 11073 BU-MC20051
March 2020

EATON
Powering Business Worldwide

Eaton is a registered trademark.

All other trademarks are property of their respective owners.

Follow us on social media to get the latest product and support information.

