



LED MODULE WITH INTEGRATED LED 230V AC, RED, SCREW TERMINAL, FOR FRONT PLATE MOUNTING

Figure similar

product brand name		SIRIUS ACT
Product designation		Commanding and signaling devices
Design of the product		LED module

General technical data:

<b>Product component</b>		
• diode		Yes
• lamp transformer		No
• Light source		Yes
• series resistor		No
<b>Insulation voltage</b>		
• Rated value	V	320
<b>Type of voltage</b>		
• of the operating voltage		AC
• for actuation		AC
<b>Consumed current maximum</b>	mA	20
<b>Degree of pollution</b>		3
<b>Vibration resistance</b>		
• acc. to IEC 60068-2-6		10 ... 500 Hz: 5g
<b>Surge voltage resistance Rated value</b>	kV	4
<b>Operating period typical</b>	h	100 000
<b>Protection class IP</b>		
• of the enclosure		IP40
• of the terminal		IP20
<b>Equipment marking</b>		
• acc. to DIN EN 61346-2		P

• acc. to DIN EN 81346-2		P
<b>Operating voltage 1</b>		
• with AC		
— at 50 Hz Rated value	V	230
— at 60 Hz Rated value	V	230
<b>Relative positive tolerance of the operating voltage</b>	%	15
<b>Relative negative tolerance of the operating voltage</b>	%	10

#### Connections/ Terminals:

<b>Type of electrical connection</b>		screw-type terminals
<b>Type of connectable conductor cross-section</b>		
• solid with core end processing		2x (0.5 ... 0.75 mm <sup>2</sup> )
• solid without core end processing		2x (1.0 ... 1.5 mm <sup>2</sup> )
• finely stranded with core end processing		2x (0.5 ... 1.5 mm <sup>2</sup> )
• finely stranded without core end processing		2x (1,0 ... 1,5 mm <sup>2</sup> )
• for AWG conductors		2x (18 ... 14)
<b>Tightening torque</b>		
• with screw-type terminals	N·m	0.8 ... 0.9

#### Lamp:

<b>Type of light source</b>		LED
<b>Color of the light source</b>		red

#### Ambient conditions:

<b>Ambient temperature</b>		
• during operation	°C	-25 ... +70
• during storage	°C	-40 ... +80

#### Installation/ mounting/ dimensions:

<b>Mounting type</b>		
• of modules and accessories		Front plate mounting
<b>Height</b>	mm	32
<b>Width</b>	mm	9.8
<b>Depth</b>	mm	23.4

#### Certificates/ approvals:

#### Further information

##### Information- and Downloadcenter (Catalogs, Brochures,...)

<http://www.siemens.com/industrial-controls/catalogs>

##### Industry Mall (Online ordering system)

<http://www.siemens.com/industrymall>

##### Cax online generator

<http://support.automation.siemens.com/WW/CAXorder/default.aspx?lang=en&mlfb=3SU14011BF201AA0>

##### Service&Support (Manuals, Certificates, Characteristics, FAQs,...)

<http://support.automation.siemens.com/WW/view/en/3SU14011BF201AA0/all>

##### Image database (product images, 2D dimension drawings, 3D models, device circuit diagrams, EPLAN macros, ...)

[http://www.automation.siemens.com/bilddb/cax\\_de.aspx?mlfb=3SU14011BF201AA0&lang=en](http://www.automation.siemens.com/bilddb/cax_de.aspx?mlfb=3SU14011BF201AA0&lang=en)

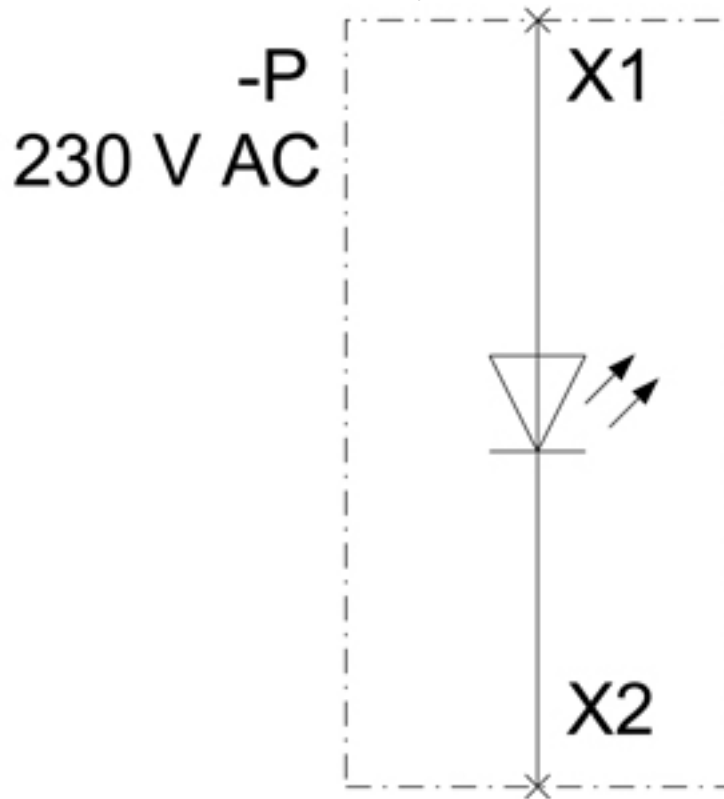
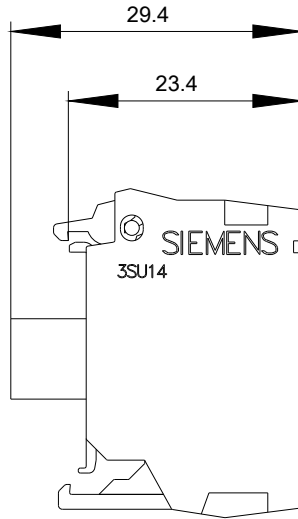
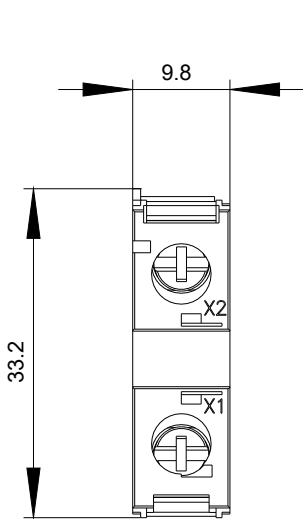

last modified:

09.03.2015