

Subminiature Fuse, 4.05 x 10 mm, Quick-Acting F, 250 VAC, 125 VDC



UL 248-14 · 250VAC · 125VDC · Quick-Acting F



Description

- Low Breaking Capacity

Standards

- UL 248-14
- CSA C22.2 no. 248.14

Approvals

- UL File Number: E42088

References

[Packaging Details](#)

Weblinks

[pdf-datasheet](#), [html-datasheet](#), [General Product Information](#), [Approvals](#), [CE declaration of conformity](#), [RoHS](#), [CHINA-RoHS](#), [REACH](#), [e-Shop](#), [SCHURTER-Stock-Check](#), [Distributor-Stock-Check](#), [Detailed request for product](#)

Technical Data

Rated Voltage	125 - 250 VAC, 125 VDC
Rated current	0.05 - 5 A
Breaking Capacity	50 A - 300 A
Characteristic	Quick-Acting F
Admissible Ambient Air Temp.	-40 °C to 85 °C
Material: Tube	Ceramic
Material: Axial Leads	Tin-Plated Copper
Unit Weight	0.6 g
Storage Conditions	0 °C to 60 °C, max. 70% r.h.
Product Marking	 , Rated current, Characteristic

Soldering Methods	Wave
Solderability	235 °C / 2 sec acc. to IEC 60068-2-20, Test Ta, method 1
Resistance to Soldering Heat	260 °C / 5 sec acc. to IEC 60068-2-20, Test Tb, method 1A

Dimension

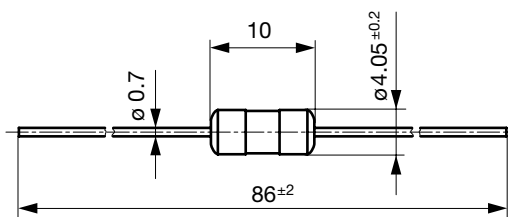
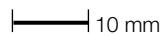

Pre-Arcing Time

Rated Current I_n 1.0 x I_n min. 2.0 x I_n max. 3.0 x I_n max.

0.05 A - 5 A	4 h	60 s	100 ms
--------------	-----	------	--------

Time-Current-Curves

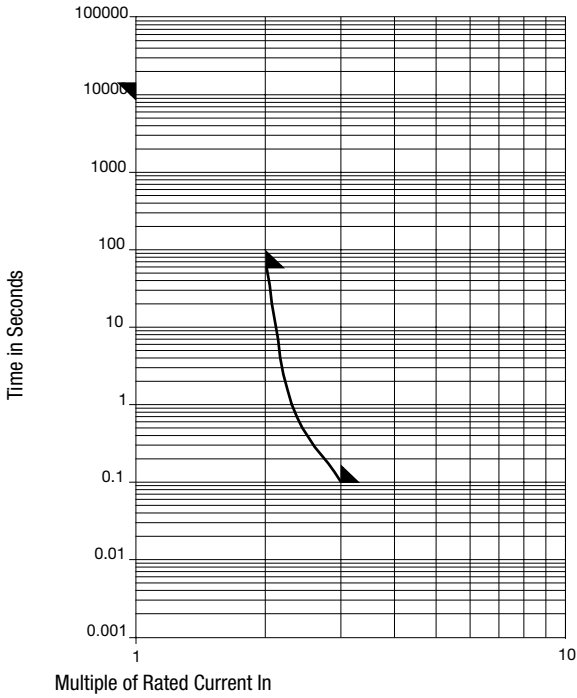

All Variants

Rated Current [A]	Rated Voltage [VAC]	Rated Voltage [VDC]	Breaking Capacity	Voltage Drop 1.0 In typ. [mV]	Melting I ² t 10.0 Intyp. [A ² s]	Order Number
0.08	250	125	1)	950	0.00039	● 7010.1760.xx
0.1	250	125	1)	875	0.00079	● 7010.1770.xx
0.125	250	125	1)	870	0.0013	● 7010.1780.xx
0.15	250	125	1)	545	0.0029	● 7010.1790.xx
0.2	250	125	1)	520	0.0071	● 7010.1910.xx
0.3	250	125	1)	920	0.021	● 7010.1920.xx
0.4	250	125	1)	725	0.057	● 7010.1930.xx
0.6	250	125	1)	205	0.059	● 7010.1810.xx
0.8	250	125	1)	150	0.095	● 7010.1820.xx
1.25	250	125	1)	125	0.29	● 7010.1840.xx
1.6	250	125	1)	135	0.48	● 7010.1850.xx
2	250	125	1)	110	0.95	● 7010.1860.xx
2.5	250	125	1)	145	1.2	● 7010.1870.xx
3	250	125	1)	220	1.8	● 7010.1880.xx
4	250	125	1)	130	3.4	● 7010.1890.xx
5	250	125	1)	105	7.7	● 7010.1900.xx

Most Popular.

Availability for all products can be searched real-time: <http://www.schurter.com/en/Stock-Check/Stock-Check-SCHURTER>

1) 50 A @ 250 VAC/DC / 300 A @ 125 VAC/DC

Packaging Unit

- .xx = .12 Plastic Bag (50 pcs.)
- .xx = .46 Taped 19 cm Reel (1000 pcs.)