

ISSUE NO:

- 3) SOLDERING TEMPERATURE AND TIME MUST BE 360°(3SEC) OR 400°(2SEC).
360°C(3秒)或400°C(2秒)
- 4) MEASURING THE DIMENSION OF THE SHAFT EXTENSION WHEN THE OTHER END OF THE SHAFT IS AGAINST THE REAR BRACKET END.
- 5) WHEN PRESS FITTING A GEAR,PULLEY OR ANYTHING ALIKE ONTO MOTOR OUTPUT SHAFT, DO PUSH THE OTHER SHAFT END VERTICALLY, DON'T PUSH THE REAR BRACKET.

2) PRODUCTS SHOULD BE WITH STAMPING 2116522H5F

2116522H5F
 LINE(位)
 YEAR(年)
 MONTH(月)
 DATE(日)

WINDING DESIGN TYPE

IF ANY SPECIAL REQUIREMENTS FROM CUSTOMERS THE STAMPINGS SHOULD BE UP TO THE REQUIREMENTS

DIRECTION OF ROTATION

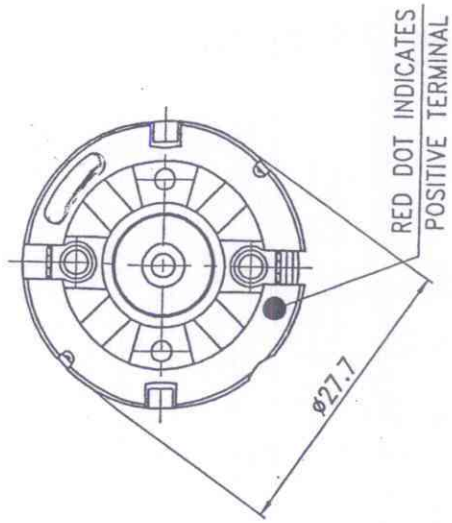
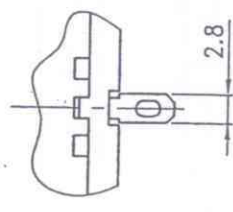
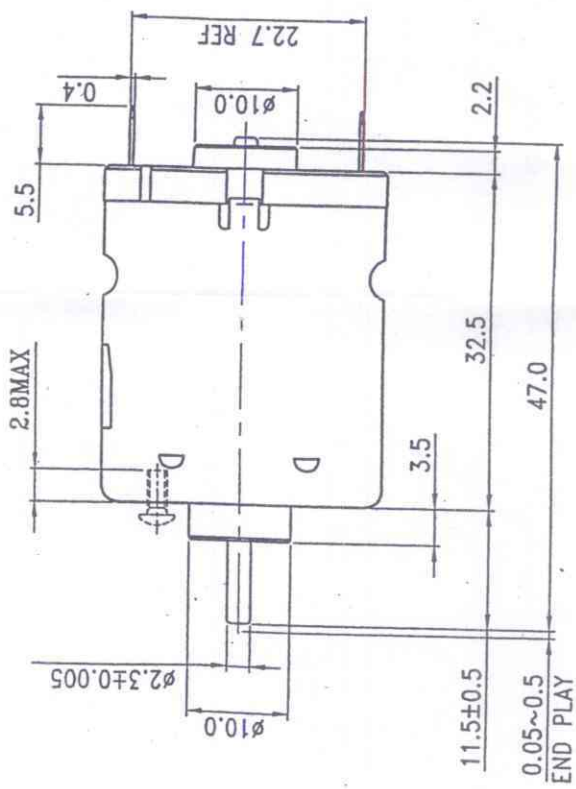
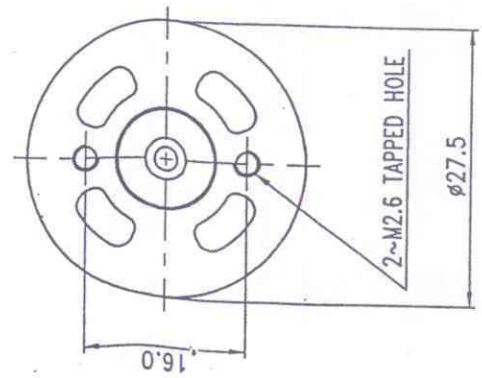

MFA/COMO DRILLS

MODEL NO. RE 360

REV 0
 TOLERANCE EXCEPT AS NOTED

IPL DECIMAL ±0.3
 2PL DECIMAL ±0.1
 ANGLE ±2°

DES'D	2005.8.25
CHK'D	/
APP'D	23/8/05
DO NOT SCALE DRAWING	
CUSTOMER NO.	SUN00106

CONFIRMED & ACCEPTED BY CUSTOMER
 Company, Chop & Signature

REV.	DES'D	APP'D	DATE

WAS

DATE:

MFA/COMO DRILLS

MOTOR PERFORMANCE CURVES AND CHARACTERISTICS:

RE 360

VOLTAGE: 12.0 V

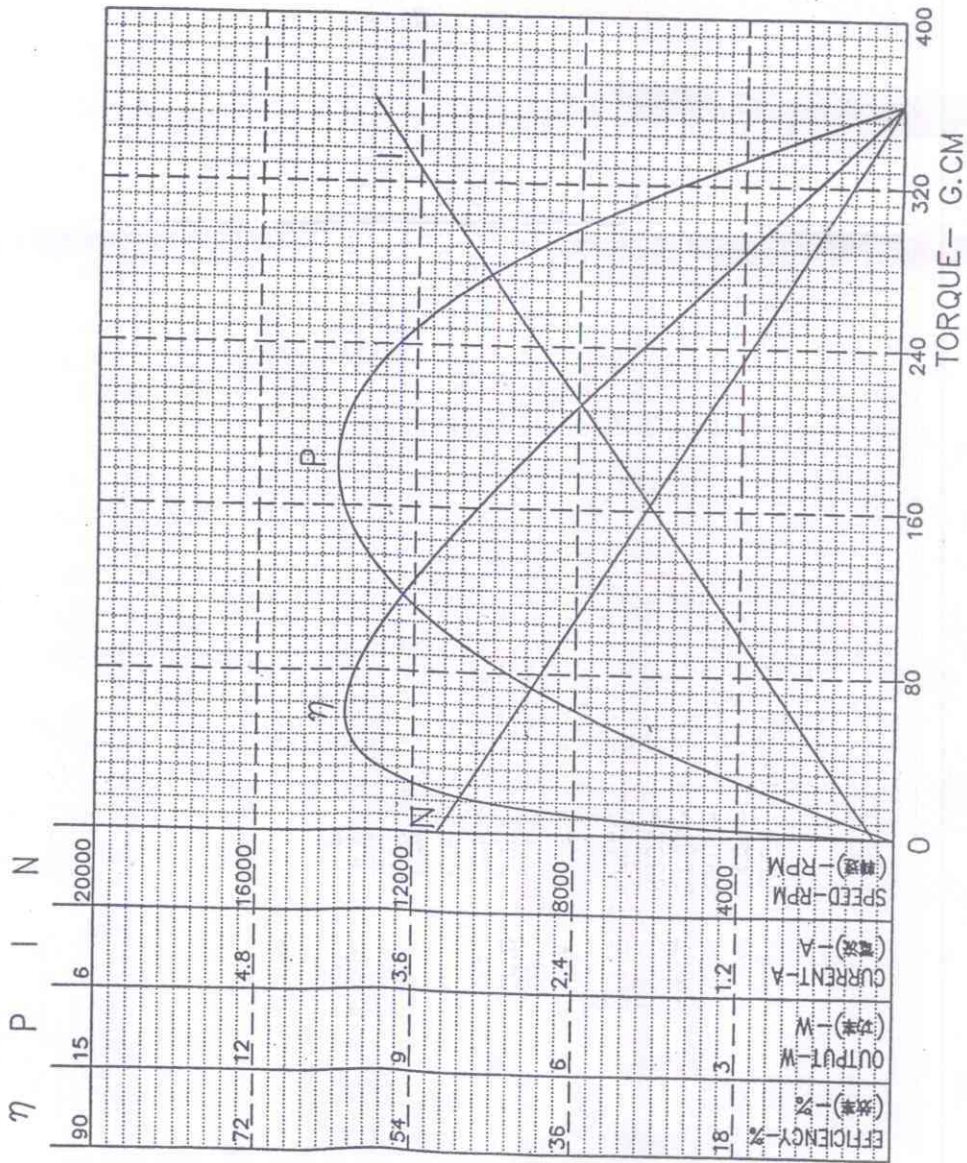

PERFORMANCE (性能)

AT NO LOAD (無負荷點)

SPEED (轉速) = 11370 RPM
CURRENT (電流) = 0.151 AMP

AT STALL EXTRAPOLATION (堵轉點)

TORQUE (力矩) = 360.0 G.CM
CURRENT (電流) = 3.952 AMP.

AT MAXIMUM EFFICIENCY (最大效率點)

EFFICIENCY (效率) = 61.94 %
SPEED (轉速) = 9511 RPM
TORQUE (力矩) = 58.8 G.CM
CURRENT (電流) = 0.772 AMP.
OUTPUT (功率) = 5.750 WATTS

AT MAXIMUM OUTPUT (最大輸出功率點)

SPEED (轉速) = 5685 RPM
TORQUE (力矩) = 180.0 G.CM
CURRENT (電流) = 2.051 AMP.
OUTPUT (功率) = 10.513 WATTS
EFFICIENCY (效率) = 42.70 %

THE CURVES REPRESENT THE THEORETICAL PERFORMANCE OF THE SAMPLE ONLY.

PREPARED BY: _____

REVIEWED BY: _____

APPROVED BY: _____