

Hybrid bearing – roll and slide

DryLin® W Hybrid bearings offer a unique combination of plain and roller bearings. At a defined installation position, the required driving torque reduces significantly due to the maintenance-free roller bearings. Shear forces and shock loads are absorbed by the plain bearing. The hybrid bearing is ideal for manual adjustments, especially in door slides.

- Shaft-mounted plastic rollers
- Liner made of iglidur® J
- Low drive force needed, friction: 0.04–0.05 μ
- Cost-effective
- Can be combined with 7 linear profile rails

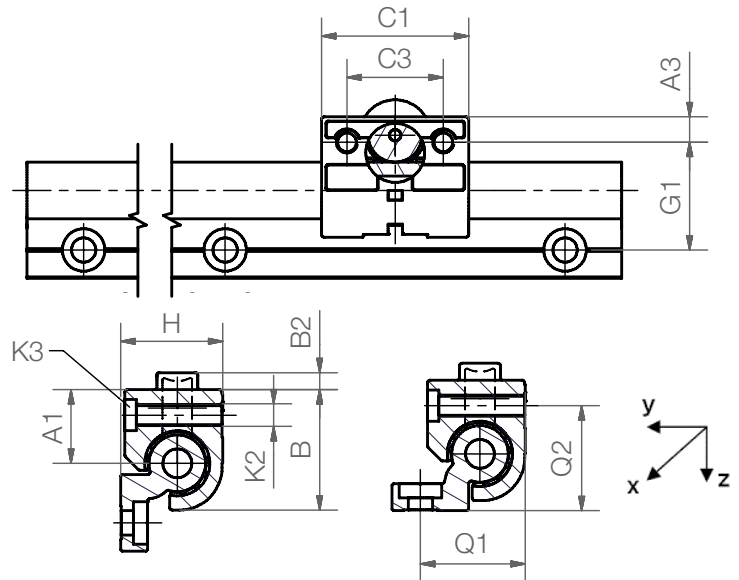
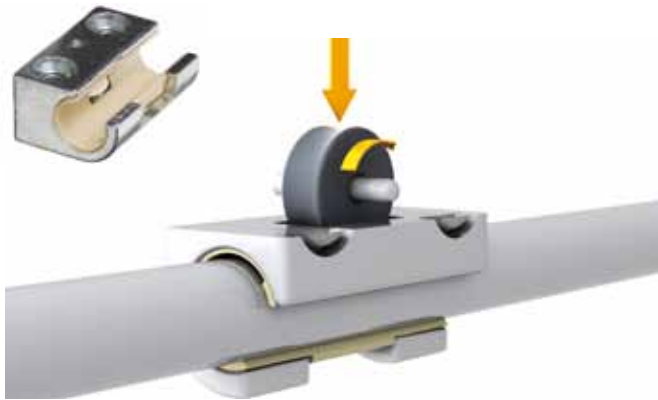

Shown installation position is not possible for combination of WJRM-01-10 with rail WS-10/WS-10-40/WS-10-80

DryLin® W Housing Bearing, Round – Load Data and Dimensions [mm]

Part number	Static load capacity C_0	Dyn. load capacity C_{z+} at total running distance (km)			$F \cdot v$
		10	100	200	
	[N]	[N]	[N]	[N]	max. [N · m/s]
WJRM-01-10	250	250	90	50	50
WJRM-01-16	400	400	140	70	80
WJRM-01-20	550	550	200	100	80

DryLin® W Housing Bearing – Load Data and Dimensions [mm]

Part number	Friction in +z direction	Weight [g]	B	B2	C1	C3	G1	A3	A1	K2	K3	Q1	Q2
WJRM-01-10	< 0.1	46	26	2.5	35	22	27	6.5	16.5	M6	M5	–	–
WJRM-01-16	< 0.1	131	34.5	5	48	30	33	9	25	M8	M6	32	28
WJRM-01-20	< 0.1	232	42.5	6	52	34	38	9	30	M8	M6	37	37



DryLin® W guide rail ► page 770

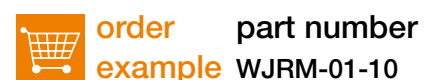



Adjustment of control panel unit



Adjustment of sliding door tool magazine



Adjustment of wood panel



Adjustment of camera mounting slide

► www.igus.co.uk/cam