

*Our Focus is in Plastics*

**Polymer Optics Ltd.**

6 Kiln Ride, Wokingham,  
Berks., RG40 3JL, England  
Tel/Fax: +44 (0) 1189 893341  
www.polymer-optics.co.uk

## 6 Degree LED Collimator 7 Cell Cluster Optic - Part No. 122

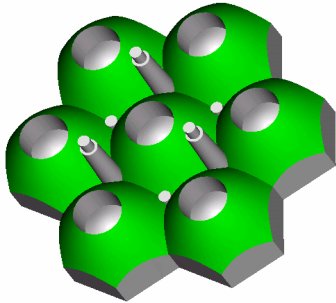

- Designed for LUXEON® I, III and K2 LED's
- High light collection efficiency of >85%
- Suitable for LUXEON® “Lambertian” and “Bat-wing” LED designs.
- Precision moulded in optical grade Polycarbonate for thermal stability and system durability
- Part of the Polymer Optics “Modular LED Optics”® range

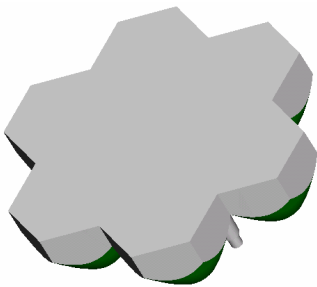

Typical dimensional tolerances  
to +/-0.2mm

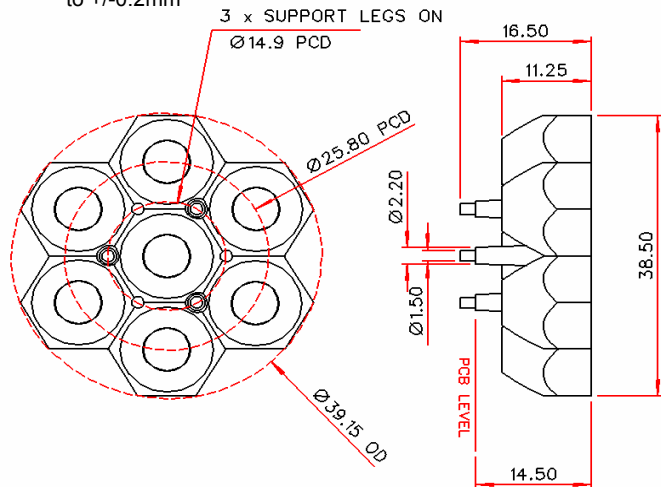

Polymer Optics Limited is a certified  
Lumileds-Future Partner

**Polymer Optics “Modular LED Optics”® design, based on a hexagonal format, allows maximum packing density and assembly flexibility**

**Polymer Optics “Cluster Optic”® arrays can be assembled together in a number of ways to meet the needs of a range of illumination applications**

**The 122 and 125 type “Cluster Optics”® can be mixed in the assembly to optimise the systems illumination distribution, and combined with other Polymer Optics custom cluster designs.**

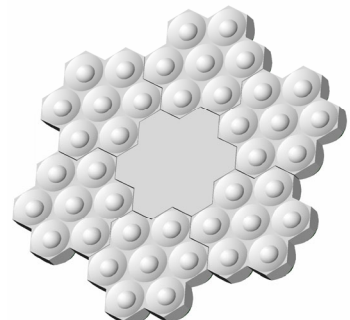

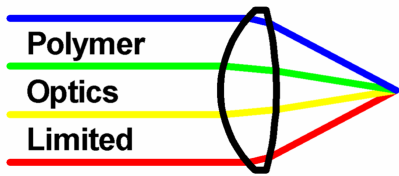

*Our Focus is in Plastics*

**Polymer Optics Ltd.**

6 Kiln Ride, Wokingham,  
Berks., RG40 3JL, England  
Tel/Fax: +44 (0) 1189 893341  
www.polymer-optics.co.uk

**6 Degree LED Collimator 7 Cell Cluster Optic - Part No. 122**

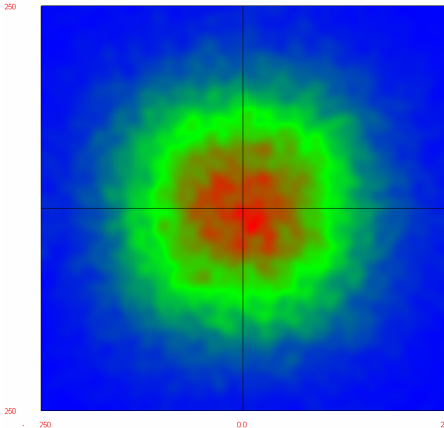

Raytrace Simulation of Typical Beam at 1m with 7 x 1W White LED's

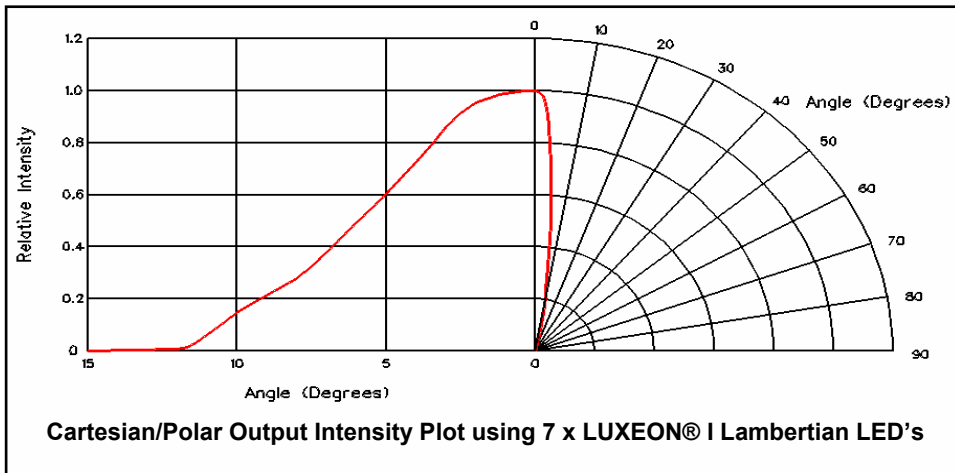
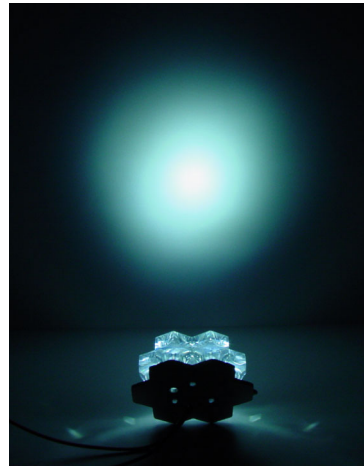

Typical illuminance values using 7 x 25 lumen white LUXEON® I Emitters = 15.5cd/lumen			
Range	0.5m	1m	2m
Illuminance	10,800 lux	2700 lux	675 lux

Performance values given are typical values and will vary dependant on LED binning, colour and drive profile

**Output beam is rendered homogeneous within only 100mm from front of optic. This gives excellent colour mixing with RGB LED mixes**